

SUPERIOR SELF STORAGE ADDITION

Wichita, Sedgwick County, Kansas

State of Kansas)
SS
Sedgwick County)

We, Ruggles & Bohm, P.A., Land Surveyors in aforesaid county and state, do hereby certify that, under the supervision of the undersigned, we have surveyed and platted "SUPERIOR SELF STORAGE ADDITION", Wichita, Sedgwick County, Kansas, and that the accompanying plat is a true and correct exhibit of the property surveyed, described as follows:

A tract in the South half of the Southeast Quarter of Section 3, Township 27 South, Range 1 West of the 6th P.M., Sedgwick County, Kansas, described as beginning at a point 677 feet North and 524.82 feet West of the Southeast corner of said Southeast Quarter; thence Northwesterly parallel with the Easterly right-of-way line of the Missouri Pacific Railroad, 824.42 feet to the North line of the South half of said Southeast Quarter; thence West along the North line of the South half of said Southeast Quarter, 342.5 feet to the Easterly right-of-way line of said Missouri Pacific Railroad; thence Southeasterly along said Railroad to a point 677 feet North of the South line of said Southeast Quarter; thence East parallel with the South line of said Southeast Quarter to the point of beginning.

All public easements and dedications are hereby vacated by virtue of K.S.A. 12-512b, as amended.

Ruggles & Bohm, P.A.

Land Surveyor

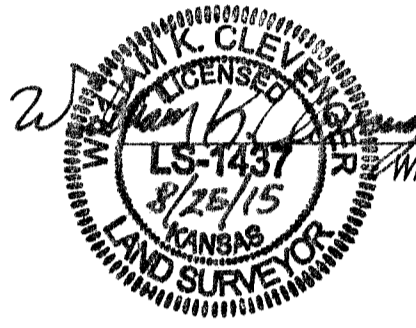

William K. Clevenger

Know all men by these presents that we, the undersigned, have caused the land described in the surveyor's certificate to be platted into a Lot and a Block to be known as "SUPERIOR SELF STORAGE ADDITION", Wichita, Sedgwick County, Kansas. The minimum pad elevation for this plat is as noted on the face of the plat. The drainage easement is hereby granted to the public as indicated for drainage purposes. A drainage plan has been developed for this plat and all drainage easements, rights-of-way, or reserves shall remain at established grades, or as modified with the approval of the City Engineer, and unobstructed to allow for the conveyance of stormwater.

Superior Self Storage of Wichita, LLC

Francis Hitschmann, Manager

State of Kansas)
SS
Sedgwick County)

The foregoing instrument acknowledged before me, this 21st day of September, 2015, by Francis Hitschmann, Manager of Superior Self Storage of Wichita, LLC, on behalf of the corporation.

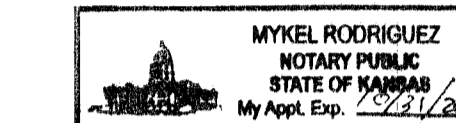

Mykel Rodriguez, Notary Public

My appointment expires 10/31/2016.

This plat of "SUPERIOR SELF STORAGE ADDITION", Wichita, Sedgwick County, Kansas, has been submitted to and approved by the Wichita-Sedgwick County Metropolitan Area Planning Commission, Wichita, Kansas.

Dated this ___ day of ___, 2015.

Wichita-Sedgwick County Metropolitan Area Planning Commission

Matthew J. Goolsby, Chair

W. David Barber, Secretary

This plat approved and all dedications shown hereon accepted by the City Council of the City of Wichita, Kansas, this ___ day of ___, 2015.

At the Direction of the City Council

Jeff Longwell, Mayor

Karen Sublett, City Clerk

Reviewed in accordance with K.S.A. 58-2005 on this ___ day of ___, 2015.

Tricia L. Robello, Deputy County Surveyor, Sedgwick County Kansas, LS #1246

Entered on transfer record this ___ day of ___, 2015.

Kelly B. Arnold, County Clerk

State of Kansas)
SS
Sedgwick County)

This is to certify that this plat has been filed for record in the office of the Register of Deeds, this ___ day of ___, 2015, at ___ o'clock ___ M., and is duly recorded.

Bill Meek, Register of Deeds

Tonya Buckingham, Deputy

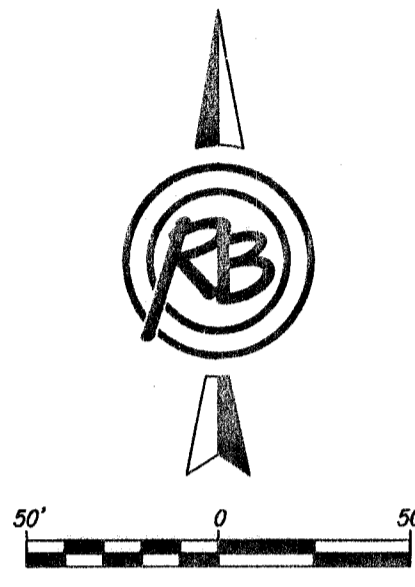
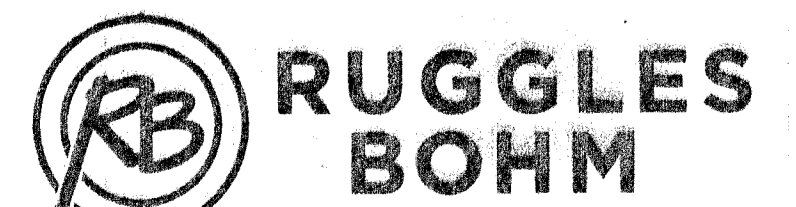

(A) = Assumed Kansas Zone South Grid Bearing
M = Measured
C = Calculated
D = Described
P = Platted (Superior Addition)
CM = Calculated from Measured

- SURVEY MARKER LEGEND
- 3/4" PINCHED IRON PIPE (FOUND - ORIGIN UNKNOWN)
 - 1/2" CAPPED REBAR (FOUND - ORIGIN UNKNOWN)
 - 5/8" REBAR (FOUND - ORIGIN UNKNOWN)
 - 5/8" CAPPED REBAR (FOUND - ORIGIN UNKNOWN)
 - 1/2" IRON PIPE (FOUND - ORIGIN UNKNOWN)
 - 5/8" REBAR WITH BAUGHMAN CAP (FOUND)
 - 1/2" REBAR WITH THIMBLE (FOUND - ORIGIN UNKNOWN)
 - 5/8" REBAR W/RUGGLES & BOHM CAP (SET)
 - BENCHMARK

PARCEL	SQ. FT.
LOT 1, BLOCK 1	219,367.5

BENCHMARK: RAILROAD SPIKE IN EAST FACE OF UTILITY POLE, 60' SOUTH OF THE NORTH LINE OF THE SE 1/4 OF THE SE 1/4 OF SEC. 3, T27S, R1W, AND 49' NORTHEAST OF THE NORTH RIGHT OF WAY OF THE KANSAS SOUTHWESTERN RAILROAD
ELEVATION = 1324.39 (NAVD88)

MINIMUM PAD ELEVATION FOR LOWEST OPENING = 1323.8 (NAVD88)

