

State of Kansas) SS  
Sedgwick County) We, Savoy Company, P.A., Surveyors in aforesaid county and state do hereby certify that, under the supervision of the undersigned, we have surveyed and platted "C & M WINTER ADDITION", Sedgwick County, Kansas and that the accompanying plat is a true and correct exhibit of the property surveyed, described as follows:

Parcel 1:  
That part of the SE1/4 of Sec. 7, Twp. 26-S, R-2-W of the 6th P.M., Sedgwick County, Kansas, described as Commencing at the S.E. Corner of said SE1/4; thence S88°27'41"W, along the South line of said SE1/4, 1768.12 feet to the Point of Beginning; thence S88°27'41"W, along the South line of said SE1/4, 810.25 feet to a point 60.00 feet East of the S.W. Corner of said SE1/4, 306.00 feet; thence N59°46'46"E, 497.98 feet; thence N01°32'19"W, 40.00 feet; thence N88°27'41"E, 375.00 feet; thence S01°32'19"E, 585.00 feet to the Point of Beginning.

Parcel 2:  
That part of the SE1/4 of Sec. 7, Twp. 26-S, R-2-W of the 6th P.M., Sedgwick County, Kansas, described as Beginning at the S.E. Corner of said SE1/4; thence S88°27'41"W, along the South line of said SE1/4, 1393.12 feet; thence N01°32'19"W, 585.00 feet; thence N88°27'41"E, 750.00 feet; thence S69°05'12"E, 175.00 feet; thence S48°30'59"E, 175.43 feet; thence S21°10'49"E, 87.67 feet; thence S87°59'07"E, 256.56 feet to a point 67.50 feet West of the East line of said SE1/4; thence N88°27'41"E, 67.50 feet to the East line of said SE1/4; thence S01°32'42"E, along the East line of said SE1/4, 300.00 feet to the Point of Beginning.

All Public easements and dedications being vacated by virtue of K.S.A. 12-512(b) as amended.

Date: \_\_\_\_\_  
Savoy Company, P.A.  
Mark A. Savoy PS #788

State of Kansas) SS  
Sedgwick County) Reviewed in accordance with K.S.A. 58-2005 on this \_\_\_\_\_ day of \_\_\_\_\_, 2017.

Deputy County Surveyor  
Sedgwick County, Kansas  
Tricia L. Robello, PS #1246

Know all men by these presents that we, the undersigned, have caused the land described in the surveyors certificate to be platted into Lots, Blocks and Streets to be known as "C & M WINTER ADDITION", Sedgwick County, Kansas. The streets are hereby dedicated to and for the use of the public. The utility easements are hereby granted as indicated for the construction and maintenance of all public utilities. No signs, light poles, private drainage systems, masonry trash enclosures or other structures shall be located within public utility easements. The Floodway Reserves are hereby reserved for floodway reserve purposes and shall be the responsibility of each Lot owner of "C & M WINTER ADDITION", until such time as the appropriate governing body elects to assume the responsibility for maintenance and improvements to the drainage. No buildings shall be constructed or placed on or within said Floodway Reserves. There shall not be any fill, change of grade, creation of channel, or any other work carried on in said Floodway Reserves without the permission of the Engineer for the appropriate governing body. A drainage plan has been developed for the plat and all drainage easements, rights-of-way, or reserves shall remain at established grades or as modified with the approval of the applicable City or County Engineer and unobstructed to allow for the conveyance of stormwater. FEMA floodplain and regulatory floodway boundaries are subject to periodic change and such change may affect the intended land use within the subdivision. Access control is hereby granted to the appropriate governing body as indicated on the face of the plat. The 50 foot vegetative Stream Buffer easement is hereby granted as indicated for a grassed buffer from the drainage way adjacent to the north of Blocks A and B. The minimum Building Pad Elevations for the lowest opening to structures shall be as indicated on the face of the plat.

Charles C. Winter Living Trust dated May 10, 2000

Co-Trustee  
Charles C. Winter  
Co-Trustee  
Margaret J. Winter

State of Kansas) SS  
Sedgwick County) The foregoing instrument acknowledged before me, this \_\_\_\_\_ day of \_\_\_\_\_, 2017, by Charles C. Winter and Margaret J. Winter Co-Trustees, of the Charles C. Winter Living Trust, dated May 10, 2000, on behalf of the Trust.

Notary Public  
My App't. Exp \_\_\_\_\_

This plat of "C & M WINTER ADDITION", Sedgwick County Kansas has been submitted to and approved by the Wichita-Sedgwick County Metropolitan Area Planning Commission, Wichita, Kansas. Dated this \_\_\_\_\_ day of \_\_\_\_\_, 2017

Wichita-Sedgwick County Metropolitan Area Planning Commission

Chairman  
David W. Foster  
Secretary  
Dale Miller

This plat approved and all dedications shown hereon, are hereby accepted by the Board of County Commissioners, Sedgwick County, Kansas, this day \_\_\_\_\_ of \_\_\_\_\_, 2017.

Chairman  
David M. Unruh, First District  
County Clerk  
Kelly B. Arnold

Entered on transfer record this \_\_\_\_\_ day of \_\_\_\_\_, 2017.

County Clerk  
Kelly B. Arnold

State of Kansas) SS  
Sedgwick County) This is to certify that this plat has been filed for record in the office of the Register of Deeds, this \_\_\_\_\_ day of \_\_\_\_\_, 2017, at \_\_\_\_\_ o'clock \_\_\_\_\_ M: and is duly recorded.

Register of Deeds  
Tonya Buckingham  
Deputy  
Judy J. Paget

PW-ENGINEERING 1-71  
Arcefi Rosas  
FOR YOUR FILES

# C & M WINTER ADDITION

## Sedgwick County, Kansas

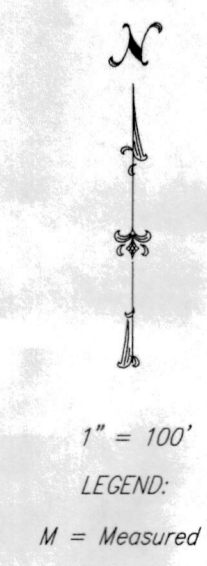

Minimum Pad Elevation for Lowest Opening	
Lot & Blk	Elevation NAVD88
Lot 1, Blk A	1392.5
Lot 2, Blk A	1391.7
Lot 1, Blk B	1389.0
Lot 2, Blk B	1388.0
Lot 3, Blk B	1386.0

- LEGEND:  
M = Measured
- 1/2" REBAR (FOUND)
  - 3/4" IRON PIPE OVER STONE (FOUND)
  - BENCHMARK/STN 1/2" REBAR W/BENCHMARK CAP OVER STONE (FOUND)
  - C&B 1/2" REBAR W/CARLSON-BALDWIN CAP (FOUND)
  - SAV 1/2" REBAR W/SAVOY CAP (SET)
  - STN GLO STONE (FOUND)

BENCHMARK:  
Sedgwick County Reference  
Stations State Plane Coordinate  
System NAD 83, NAVD88