

DRAINAGE PLAN

EDGE WATER 3RD ADDITION

WICHITA, SEDGWICK COUNTY, KANSAS

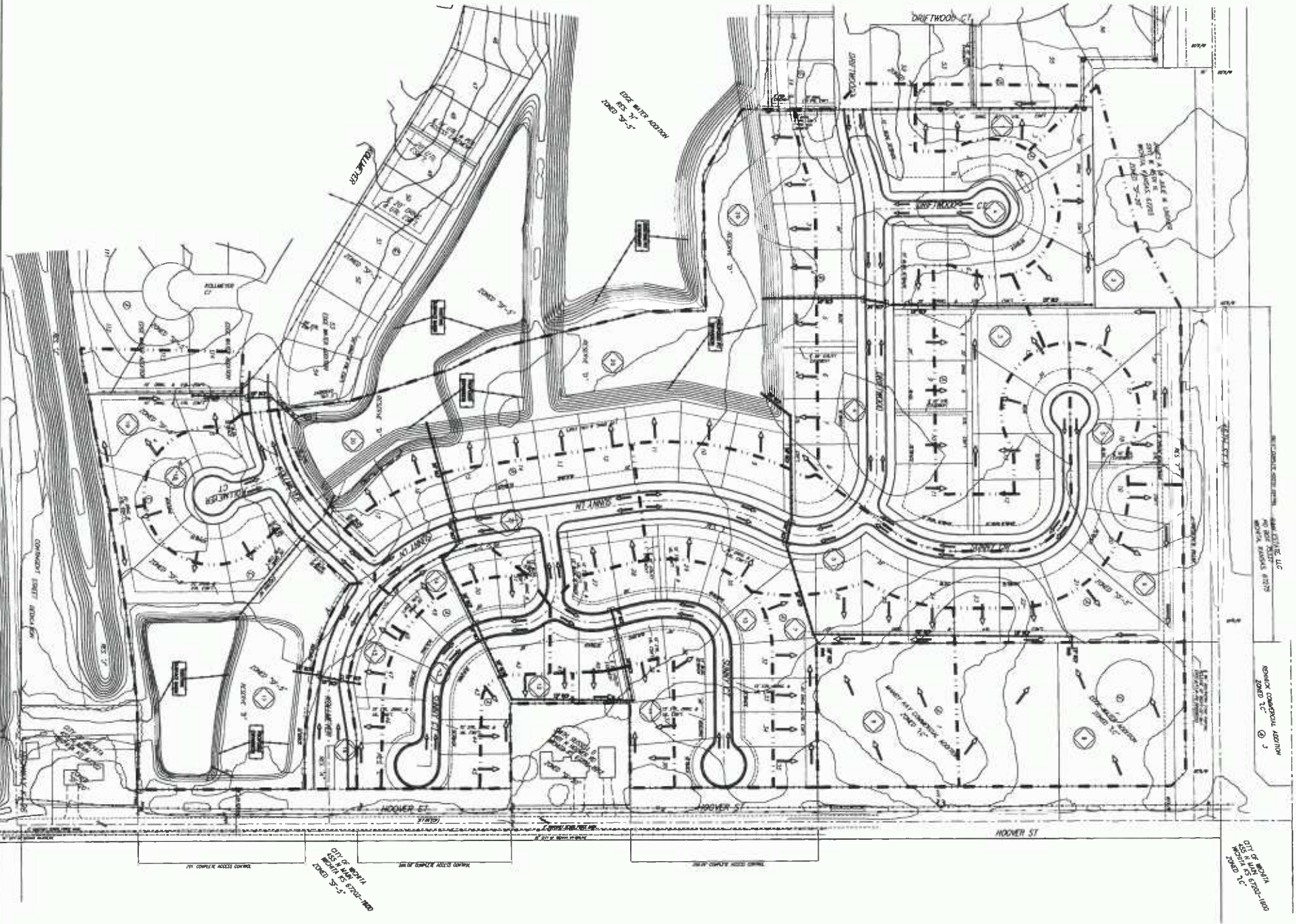

Basin ID	Area (Acres)	2-yr cfs	10-yr cfs	100-yr cfs
1	0.0	1.1	1.9	3.4
2	2.2	4.2	7.1	12.5
3	4.0	7.2	12.1	20.0
4	4.0	7.2	12.1	20.0
5	3.0	5.5	9.5	15.5
6	1.2	2.3	3.9	6.7
7	1.1	2.1	3.6	6.2
8	2.3	4.4	7.4	12.5
9	1.4	2.7	4.5	7.6
10	2.3	4.4	7.4	12.5
11	0.5	1.0	1.6	2.8
12	0.4	0.8	1.3	2.2
13	0.3	0.6	1.0	1.7
14	0.3	0.6	1.0	1.7
15	0.0	1.1	1.9	3.4
16	0.0	1.1	1.9	3.4
17	3.2	6.1	10.5	18.0
18	1.5	2.8	4.9	8.4
19	1.1	2.1	3.6	6.2
20	5.9	11.1	19.1	32.1
21	2.0	3.8	6.5	11.1
TOTAL	20.2	75.0	127.0	220.0

Basin ID	Area (Acres)	2-yr cfs	10-yr cfs	100-yr cfs
1	0.0	1.1	1.9	3.4
2	2.2	4.2	7.1	12.5
3	4.0	7.2	12.1	20.0
4	4.0	7.2	12.1	20.0
5	3.0	5.5	9.5	15.5
6	1.2	2.3	3.9	6.7
7	1.1	2.1	3.6	6.2
8	2.3	4.4	7.4	12.5
9	1.4	2.7	4.5	7.6
10	2.3	4.4	7.4	12.5
11	0.5	1.0	1.6	2.8
12	0.4	0.8	1.3	2.2
13	0.3	0.6	1.0	1.7
14	0.3	0.6	1.0	1.7
15	0.0	1.1	1.9	3.4
16	0.0	1.1	1.9	3.4
17	3.2	6.1	10.5	18.0
18	1.5	2.8	4.9	8.4
19	1.1	2.1	3.6	6.2
20	5.9	11.1	19.1	32.1
21	2.0	3.8	6.5	11.1
TOTAL	20.2	75.0	127.0	220.0

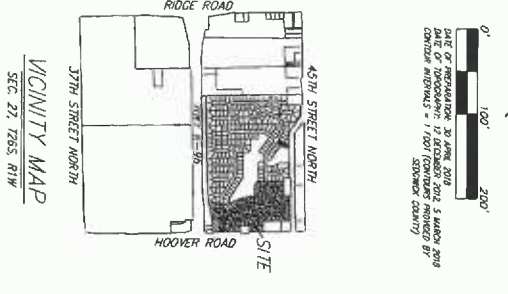

CAUTION: This plan is a PRELIMINARY PLAN. It is not to be used for construction. The engineer's seal and signature are required for the final plan. The engineer's seal and signature are required for the final plan. The engineer's seal and signature are required for the final plan.

NOTES: There is no FEMA 500A located on the property or the site. The site is located in the unshaded area. The site is located in the unshaded area. The site is located in the unshaded area.



Approved
C.O.W.
Joe Hinkle
5-10-18