

KANSAS FOOD BANK WAREHOUSE 2ND ADDITION

A PORTION OF LOT 1, BLOCK 1, KANSAS FOOD BANK WAREHOUSE ADDITION AND
A REPLAT OF LOTS 14-20 EVEN, GRACE (NOW MINNEAPOLIS) AVE., OF BLACK'S ADDITION,
LOTS 13-19 ODD, KIRK (NOW MINNESOTA) AVE., BLACK'S ADDITION,
ALONG WITH THE ABUTTING 20' CITY ALLEY
WICHITA, SEDGWICK COUNTY, KANSAS

FINAL PLAT OF

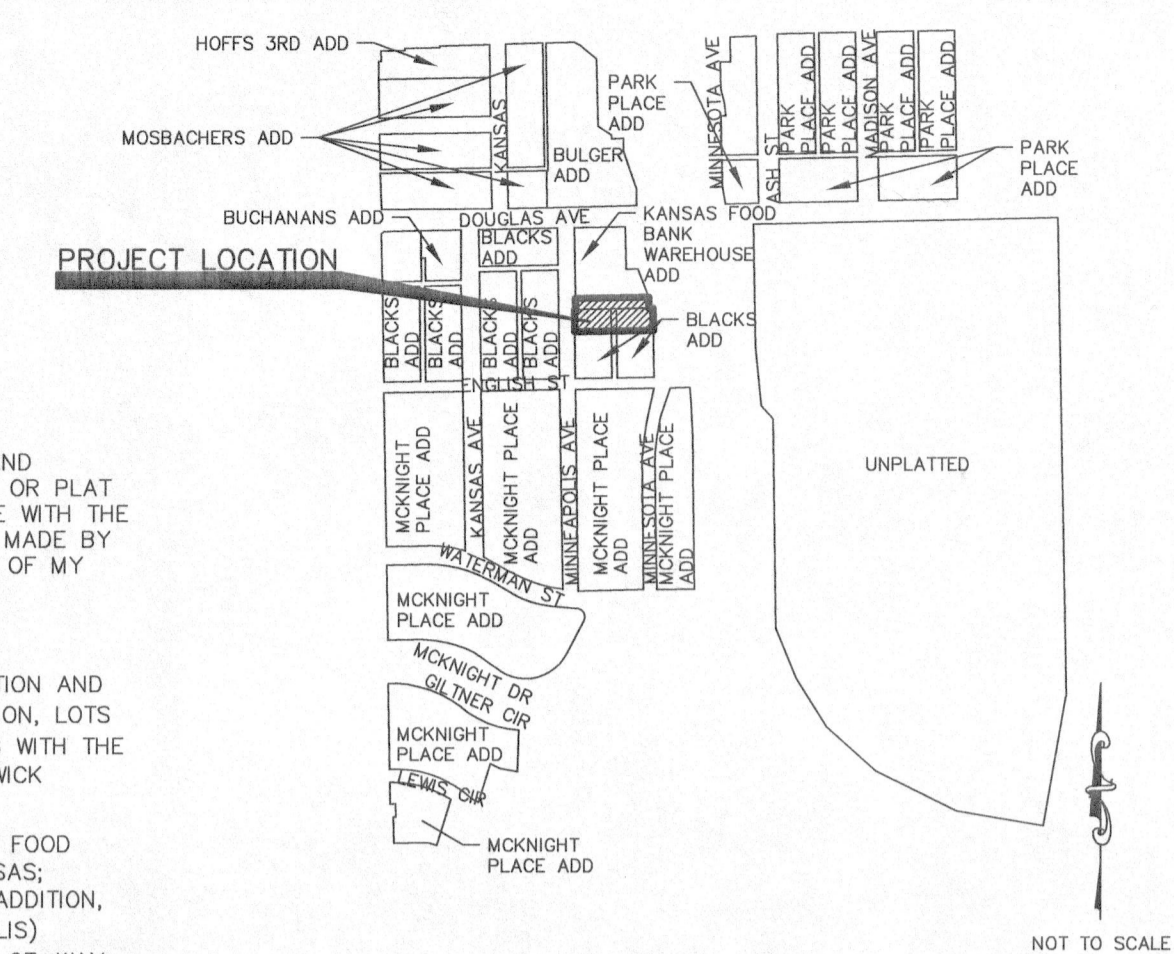

LOCATION MAP
WICHITA, KANSAS

PLANNING COMMISSION CERTIFICATE

STATE OF KANSAS }
COUNTY OF SEDGWICK } SS
THIS PLAT OF "KANSAS FOOD BANK WAREHOUSE 2ND ADDITION", WICHITA, SEDGWICK COUNTY, KANSAS, HAS BEEN SUBMITTED TO AND APPROVED BY THE WICHITA-SEGWICK COUNTY METROPOLITAN AREA PLANNING COMMISSION, WICHITA, SEDGWICK COUNTY, KANSAS. DATED THIS ____ DAY OF ____ 2018.

WICHITA-SEGWICK COUNTY METROPOLITAN AREA PLANNING COMMISSION
_____, CHAIRMAN
JOSEPH A. JOHNSON

ATTEST:
_____, SECRETARY
DALE MILLER

GOVERNING BODY CERTIFICATE

STATE OF KANSAS }
COUNTY OF SEDGWICK } SS
THIS PLAT APPROVED AND ALL DEDICATIONS SHOWN HEREON, ACCEPTED BY THE CITY COUNCIL OF THE CITY OF WICHITA, KANSAS. DATED THIS ____ DAY OF ____ 2018.

_____, MAYOR
JEFF LONGWELL
ATTEST:
_____, CITY CLERK
KAREN SUBLETT

REGISTER OF DEEDS CERTIFICATE

STATE OF KANSAS }
COUNTY OF SEDGWICK } SS
THIS IS TO CERTIFY THAT THIS INSTRUMENT WAS FILED FOR RECORD IN THE REGISTER OF DEEDS OFFICE, AT ____ A.M. ON ____ DAY OF ____ 2018.

_____, REGISTER OF DEEDS
TONYA BUCKINGHAM
_____, DEPUTY
JUDY J. PAGET

DEPUTY COUNTY SURVEYOR CERTIFICATE

THIS PLAT HAS BEEN REVIEWED IN ACCORDANCE WITH K.S.A. 58-2005 ON THIS DAY OF ____ 2018.

TRICIA L. ROBELLO, P.S. #1246
DEPUTY COUNTY SURVEYOR
SEDGWICK COUNTY, KANSAS

TRANSFER RECORD

ENTERED ON TRANSFER RECORD THIS ____ DAY OF ____ 2018.

_____, COUNTY CLERK
KELLY B. ARNOLD

DATUM BENCHMARK:
DATUM IS U.S. SURVEY FEET AND REFER TO NAVD83 DATUM BASED ON THE SEDGWICK COUNTY GNSS NETWORK. ORTHOMETRIC HEIGHT WAS CALCULATED USING THE GEOID28 MODEL.

BENCHMARKS:
BM #1: CHISELED "SQUARE", 8 FEET NORTH OF THE NORTH CURB RETURN, EAST SIDE OF MINNEAPOLIS AVENUE. ELEV=1296.28
BM #2: CHISELED "SQUARE" ON BACK OF CURB, 2 FEET WEST OF ACCESS GATE ON THE SOUTH SIDE OF BUILDING. ELEV=1297.27

SURVEYOR'S CERTIFICATE

STATE OF KANSAS }
COUNTY OF SEDGWICK } SS
I, JASON R. LOADER (LS), BEING A DULY LICENSED AND REGISTERED LAND SURVEYOR IN THE STATE OF KANSAS, HEREBY CERTIFY THAT THIS MAP OR PLAT AND THE SURVEY ON WHICH IT WAS BASED, WAS MADE IN ACCORDANCE WITH THE CURRENT KANSAS MINIMUM STANDARDS FOR BOUNDARY SURVEYS, WAS MADE BY ME OR UNDER MY DIRECT SUPERVISION, AND IS CORRECT TO THE BEST OF MY BELIEF AND ABILITY.

LEGAL DESCRIPTION

A PORTION OF LOT 1, BLOCK 1, KANSAS FOOD BANK WAREHOUSE ADDITION AND LOTS 14-20 EVEN, GRACE (NOW MINNEAPOLIS) AVENUE, BLACK'S ADDITION, LOTS 13-19 ODD, KIRK (NOW MINNESOTA) AVENUE, BLACK'S ADDITION, ALONG WITH THE ABUTTING 20 FEET OF CITY ALLEY, ALL IN THE CITY OF WICHITA, SEDGWICK COUNTY, KANSAS BEING MORE PARTICULARLY DESCRIBED AS FOLLOWS:
COMMENCING AT THE NORTHWEST CORNER OF LOT 1, BLOCK 1, KANSAS FOOD BANK WAREHOUSE ADDITION, CITY OF WICHITA, SEDGWICK COUNTY, KANSAS; THENCE ON THE WEST LINE OF SAID KANSAS FOOD BANK WAREHOUSE ADDITION, ALSO BEING THE EAST RIGHT-OF-WAY LINE OF GRACE (NOW MINNEAPOLIS) AVENUE, S 01°01'21" E, 268.43 FEET TO A POINT ON SAID EAST RIGHT-OF-WAY LINE AND BEING THE POINT OF BEGINNING ALSO SAID POINT BEING 41.72 FEET NORTH OF THE SOUTHWEST CORNER OF SAID LOT 1, BLOCK 1, KANSAS FOOD BANK WAREHOUSE ADDITION; THENCE N 89°39'11" E 278.79 FEET TO A POINT ON THE EAST LINE OF SAID LOT 1, BLOCK 1, KANSAS FOOD BANK WAREHOUSE ADDITION; THENCE CONTINUING ON SAID EAST LINE, S 01°20'43" E 41.69 FEET; THENCE N 88°41'17" E 16.09 FEET TO THE NORTHEAST CORNER OF LOT 13, KIRK (NOW MINNESOTA) AVE, BLACK'S ADDITION, CITY OF WICHITA, SEDGWICK COUNTY, KANSAS; ALSO SAID POINT BEING THE WEST RIGHT-OF-WAY LINE OF KIRK (NOW MINNESOTA) AVENUE; THENCE SOUTH ON SAID WEST RIGHT-OF-WAY LINE, S 01°01'21" E 49.94 FEET; THENCE SOUTH CONTINUING ALONG SAID WEST RIGHT-OF-WAY LINE S 01°01'21" E 50.26 FEET TO THE SOUTHWEST CORNER OF LOT 19, KIRK (NOW MINNESOTA) AVENUE, OF SAID BLACK'S ADDITION; THENCE ALONG THE SOUTH LINE OF SAID LOT 19, KIRK (NOW MINNESOTA) AVENUE, S 88°42'40" W 140.34 FEET TO THE SOUTHWEST CORNER OF LOT 20, GRACE (NOW MINNEAPOLIS) AVENUE, OF SAID BLACK'S ADDITION; THENCE CONTINUING ALONG SAID SOUTH LINE OF SAID LOT 20, GRACE (NOW MINNEAPOLIS) AVENUE, OF SAID BLACK'S ADDITION, S 88°42'40" W 139.70 FEET TO THE SOUTHWEST CORNER OF SAID LOT 20 OF SAID BLACK'S ADDITION, ALSO SAID POINT BEING THE EAST RIGHT-OF-WAY LINE OF GRACE (NOW MINNEAPOLIS) AVENUE; THENCE NORTH ON SAID EAST RIGHT-OF-WAY LINE, N 01°04'48" W 50.03 FEET; THENCE CONTINUING ON SAID EAST RIGHT-OF-WAY, N 01°51'00" W 50.96 FEET TO THE NORTHWEST CORNER OF LOT 14 OF SAID BLACK'S ADDITION; THENCE S 81°07'45" E 5.93 FEET TO THE POINT OF BEGINNING.

SAID TRACT CONTAINING: 41716 SQUARE FEET OR 0.96 ACRES OF LAND, MORE OR LESS.

END OF DESCRIPTION

ALL EASEMENTS ARE HEREBY VACATED BY VIRTUE OF "K.S.A. 12-512(B) AS AMENDED".

DATE OF SURVEY: MARCH 12, 2018

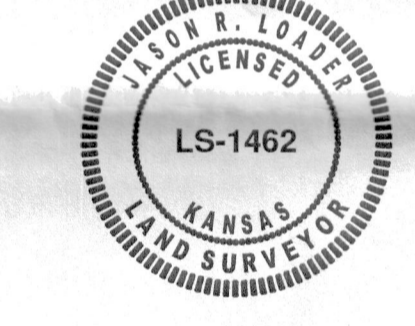

JASON R. LOADER
KANSAS PS NO. 1462
loader.jrkveng.com

OWNER'S CERTIFICATE

STATE OF KANSAS }
COUNTY OF SEDGWICK } SS
KNOW ALL MEN BY THESE PRESENTS THAT WE, THE UNDERSIGNED, HAVE CAUSED THE LAND DESCRIBED IN THE SURVEYOR'S CERTIFICATE TO BE PLATTED INTO LOT 1, BLOCK 1 AND TO BE KNOWN AS "KANSAS FOOD BANK WAREHOUSE 2ND ADDITION", WICHITA, SEDGWICK COUNTY, KANSAS.

NO SIGNS, LIGHT POLES, PRIVATE DRAINAGE SYSTEMS, MASONRY TRASH ENCLOSURES OR OTHER STRUCTURES SHALL BE LOCATED WITHIN PUBLIC UTILITY EASEMENTS UNLESS PERMITTED BY THE PUBLIC WORKS DEPARTMENT OF THE APPROPRIATE GOVERNING BODY.

UTILITY EASEMENTS ARE HEREBY GRANTED AS INDICATED FOR THE CONSTRUCTION AND MAINTENANCE OF ALL PUBLIC UTILITIES. UTILITY EASEMENTS ARE HEREBY GRANTED FOR THE CONSTRUCTION AND MAINTENANCE OF UTILITY AND SANITARY SEWER LINES.

A DRAINAGE PLAN HAS BEEN DEVELOPED FOR THIS PLAT AND ALL RIGHTS-OF-WAY SHALL REMAIN AT ESTABLISHED GRADES, OR AS MODIFIED WITH THE APPROVAL OF THE CITY ENGINEER AND UNOBSTRUCTED TO ALLOW FOR THE CONVEYANCE OF STORMWATER IN ACCORDANCE WITH THE STORMWATER MANUAL.

FEMA FLOODPLAIN AND REGULATORY FLOODWAY BOUNDARIES ARE SUBJECT TO PERIODIC CHANGE AND SUCH CHANGE MAY AFFECT THE INTENDED LAND USE WITHIN THE SUBDIVISION.

DEDICATED STREETS ARE DEDICATED TO THE CITY OF WICHITA FOR THE USE OF THE PUBLIC.

THIS ADDITION IS SUBJECT TO THE CONDITIONS OF KANSAS FOOD BANK WAREHOUSE PLANNED UNIT DEVELOPMENT.

KFBW, LLC. AND KANSAS FOOD BANK WAREHOUSE INC
BRIAN WALKER, MANAGING MEMBER AND PRESIDENT & CEO RESPECTIVELY

NOTARY CERTIFICATE

STATE OF KANSAS }
COUNTY OF SEDGWICK } SS

THE INSTRUMENT WAS ACKNOWLEDGED BEFORE ME, THIS ____ DAY OF ____, 2018, BY BRIAN WALKER, MANAGING MEMBER OF KFBW, LLC, A KANSAS LIMITED LIABILITY COMPANY AND PRESIDENT & CEO, KANSAS FOOD BANK WAREHOUSE INC, ON BEHALF OF THE COMPANY.

_____, NOTARY PUBLIC

MY COMMISSION EXPIRES: _____

- LEGEND
- MONUMENT FOUND
- 1/2" X 24" REBAR W/KVE QLS 20 CAP SET
- (P) PLATTED
- (M) MEASURED
- (S.I.) SEPARATE INSTRUMENT
- LINE NOT DRAWN TO SCALE

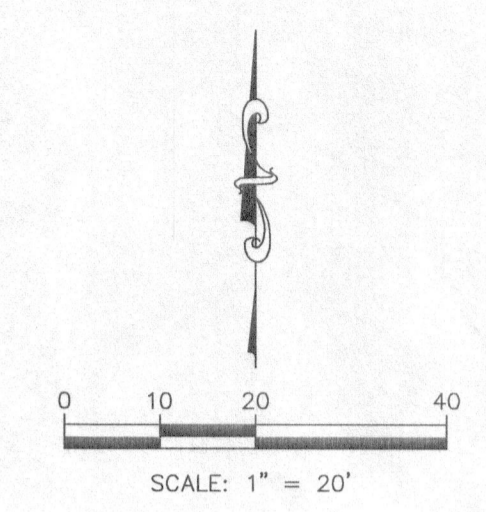

200 N. EMPORIA, SUITE 100
WICHITA, KANSAS 67202
PH. (316) 440-4304 | FAX (316) 440-4309
wh@kveng.com | www.kveng.com