

PRELIMINARY PLAT

# THE HERITAGE AT AUBURN HILLS

## AN ADDITION TO WICHITA, SEDGWICK COUNTY, KANSAS

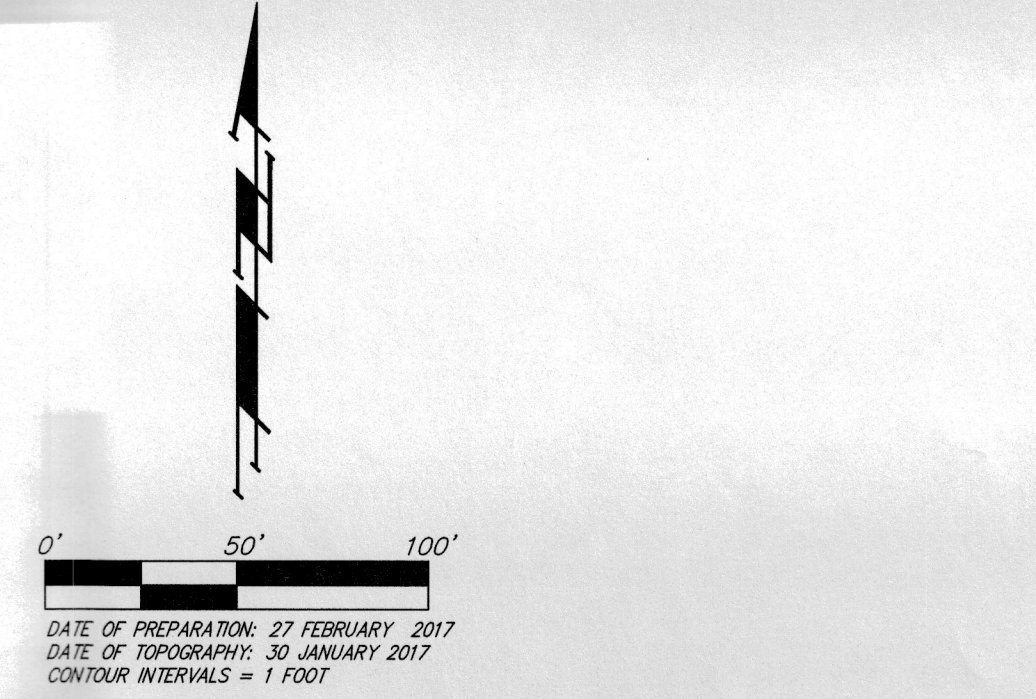

**OWNER/DEVELOPER:**  
 MAPLE 135, LLC  
 150 N. MARKET  
 WICHITA, KS 67202

**LEGAL DESCRIPTION:**  
 LOT 1, BLOCK F, SHADOW WOODS ADDITION,  
 WICHITA, SEDGWICK COUNTY, KANSAS,  
 TOGETHER WITH THE NORTH 70.00 FEET OF  
 LOT 1, EXCEPT THE WEST 47.78 FEET,  
 RIVERSIDE HEALTH SYSTEM ADDITION, WICHITA,  
 SEDGWICK COUNTY, KANSAS.

**BENCHMARK:**  
 CROSS CUT EAST EDGE OF SIDEWALK 60'±  
 NORTH OF THE SE CORNER OF LOT 1, BLOCK A.  
 ELEV. = 1342.07 (NAVD88)

● = #4 Baughman Rebar Set  
 ⊗ = Chiseled "X" Set  
 ○ = #4 Baughman Rebar Found  
 ⊙ = #4 Baughman Rebar Found (Green Cap)  
 ⊕ = #4 "Savoy" Capped Rebar Found (Blue Cap)  
 ⊛ = #4 Rebar Found (Origin Unknown)  
 ⊘ = 1/2" Iron Pipe Found (Monument Box)  
 ⊙ = #4 "Schwab-Eaton" Capped Rebar Found (Thimble)  
 ⊛ = Benchmark

ATT Ped = AT&T Pedestal  
 CW = Cased Well  
 CO = Clean Out  
 DI = Drop Inlet  
 EB = Electric Box  
 FH = Fire Hydrant  
 FOM = Fiber Optics Marker  
 GA = Guy Anchor  
 IVC = Irrigation Control Valve  
 LP = Light Pole  
 PP = Power Pole

Sign = Sign  
 Sign P = Signal Pole  
 SSM = Sanitary sewer Manhole  
 SP = Stand Pipe  
 SWSM = Storm Water Sewer Manhole  
 TMH = Traffic Manhole  
 TPO = Tree  
 TP = Television Pedestal  
 WM = Water Meter  
 WV = Water Valve  
 LP = Light Pole  
 YL = Yard Light

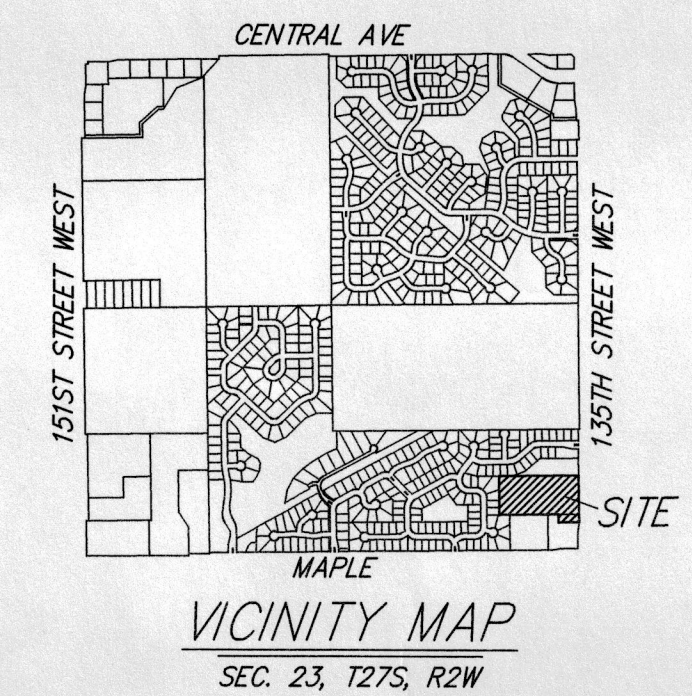
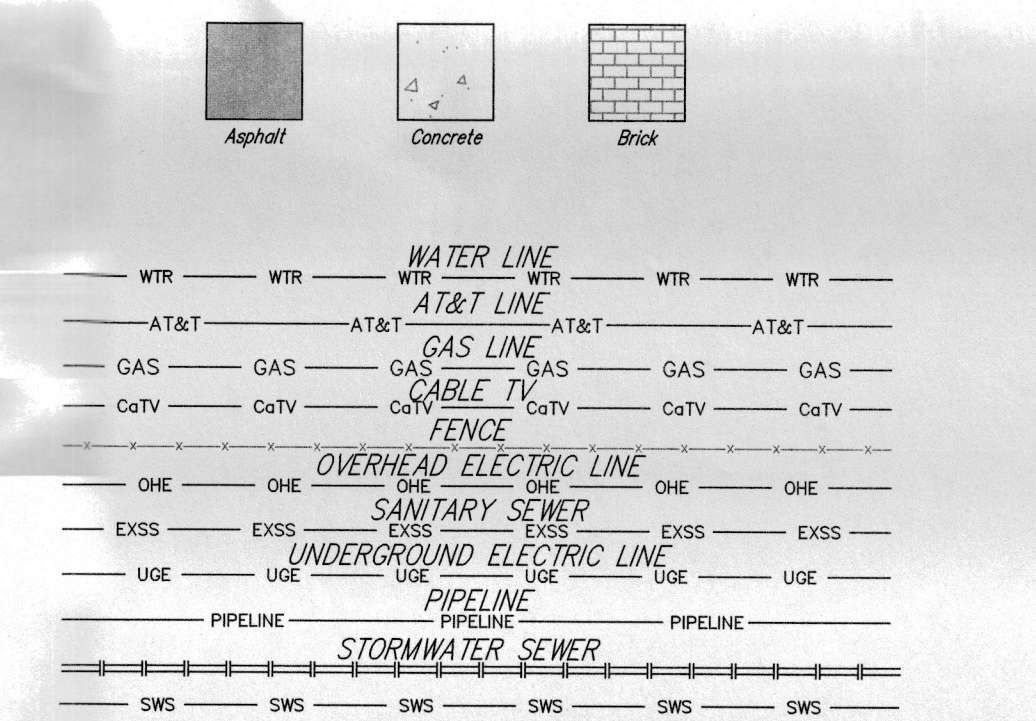

### THE HERITAGE AT AUBURN HILLS

24 February 2017

**Baughman Company, P.A.**  
 315 Ellis St. Wichita, KS 67211 P 316-263-7271 F 316-263-0149  
 ENGINEERING | SURVEYING | PLANNING | LANDSCAPE ARCHITECTURE

A:\Projects\The Heritage at Auburn Hills Addition\Plat\Drawings\Heritage at Auburn Hills\_P.dwg:RR