

FINAL PLAT OF OAK KNOLL INDUSTRIAL PARK 3RD ADDITION

A TRACT IN THE NORTHWEST QUARTER OF SECTION 5, TOWNSHIP 28 SOUTH,
RANGE 2 EAST OF THE 6TH P.M., CITY OF WICHITA, COUNTY OF SEDGWICK, KANSAS

LEGEND	
	SECTION CORNER FOUND
	3/4" PIPE FOUND, ORIGIN UNKNOWN UNLESS OTHERWISE NOTED
(D)	DESCRIBED - PER DOC#/FLM-PG: 29337414
(D2)	DESCRIBED - PER DOC#/FLM-PG: 29382601
(M)	MEASURED - BEARING & DISTANCE
(P)	PLATTED - PER BRAY LINES 2ND ADDITION (S-3 7-34)
	BENCHMARK
	LINE NOT DRAWN TO SCALE

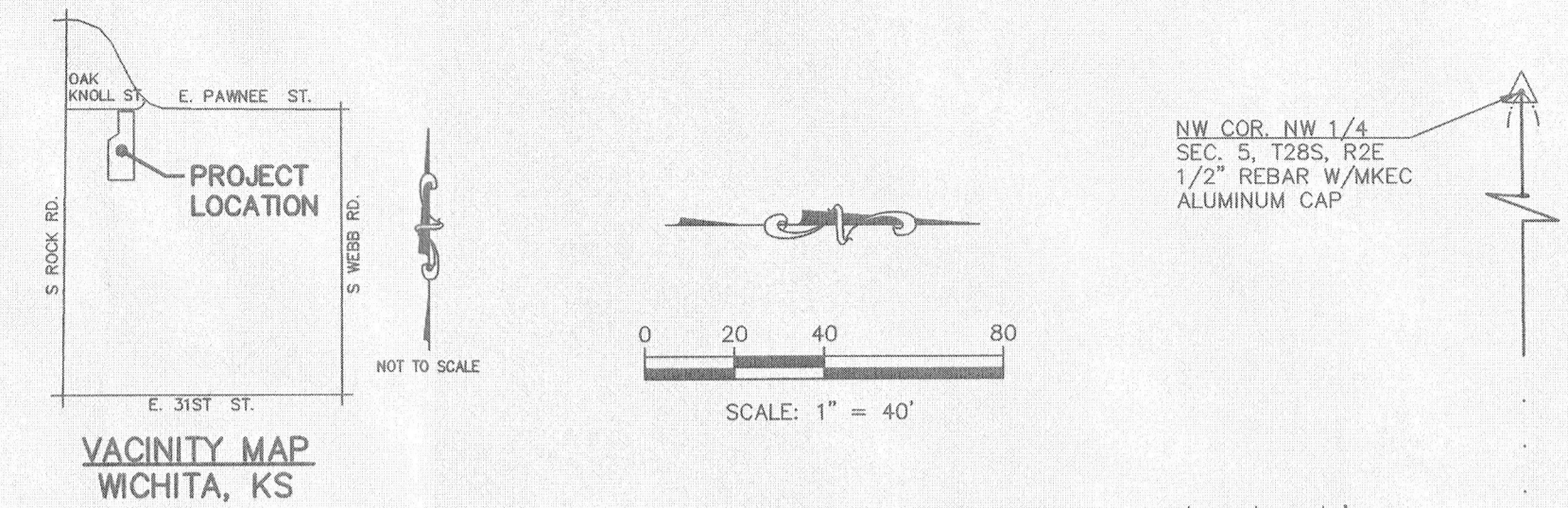

BASIS OF BEARINGS:
THE BASIS OF BEARINGS FOR THIS SURVEY IS AN ASSUMED BEARING OF S89°38'10"W ALONG NORTH LINE OF THE NORTHWEST QUARTER OF SECTION 5.

DATUM BENCHMARK:
DATUM IS U.S. SURVEY FEET AND REFER TO NAVD 88 DATUM DERIVED FROM THE WICHITA RTOM 3.0 GNSS NETWORK ORTHOMETRIC HEIGHT WAS CALCULATED USING THE GEOID 12B MODEL.

BENCHMARK (NAVD 88 DATUM):
BM #60 CHISELED SQUARE CUT AT NORTH END OF CONCRETE FLUME HEADWALL, 150±' NORTHEAST OF FLAG POLE. ELEV.=1388.19
BM #61 CHISELED SQUARE CUT WEST END OF CONCRETE CURB. ELEV.=1389.52

		200 N. EMPORIA, SUITE 100 WICHITA, KANSAS 67202 PH. (316) 440-4304 FAX (316) 440-4309 wh@kveng.com www.kveng.com	PROJECT NO. 0904 DRAWN BY AL CHECKED BY JRL CFN 0904PLAT SHEET 1 OF 2
	PROJECT: FINAL PLAT OF OAK KNOLL INDUSTRIAL PARK 3RD ADDITION	PREPARED FOR: EAB CAPITAL LLC 8401 E. OAK KNOLL WICHITA, KS 67207	KAW VALLEY ENGINEERING, INC. IS AUTHORIZED TO OFFER SURVEYING SERVICES BY KANSAS STATE CERTIFICATE OF AUTHORIZATION NO. LS-20. EXPIRES 12/31/20

FINAL TRACING REC'D 4-10-20

CITY HALL - ENGINEERING
MAIL STOP 1-71
Arceli Rosas
FOR YOUR FILES

THIS DRAWING SHALL NOT BE UTILIZED BY ANY PERSON, FIRM, OR CORPORATION IN WHOLE OR IN PART WITHOUT THE SPECIFIC PERMISSION OF KAW VALLEY ENGINEERING, INC.

