

PRELIMINARY PLAT  
**CURTIS CHATEAU AT HOLLY WOODS**  
 A PORTION OF THE NORTHEAST QUARTER OF SECTION 26  
 TOWNSHIP 27 SOUTH, RANGE 2 WEST OF THE 6TH PRINCIPAL  
 MERIDIAN, WICHITA, SEDGWICK COUNTY, KANSAS

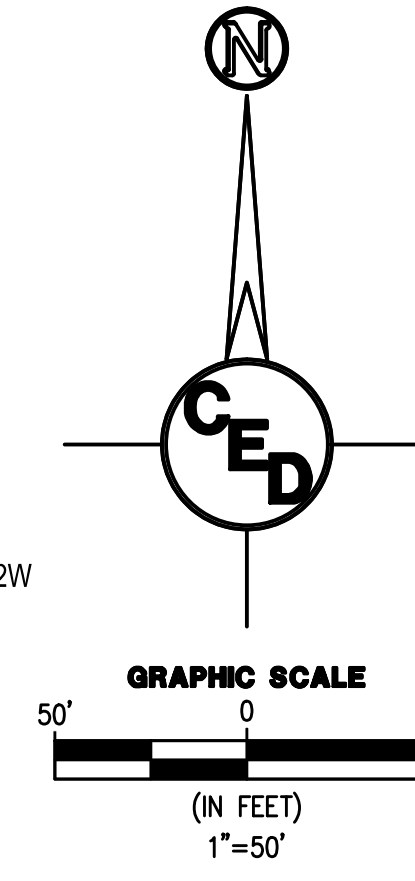

- LEGEND**
- Ⓐ - "ARMSTRONG" capped rebar set
  - Ⓞ - 3/4" iron pipe found
  - Ⓢ - 1/2" iron pipe found
  - Ⓣ - "Savoy" capped rebar found
  - M - measured distance
  - P - plat distance
  - D - deed distance
  - CM - calculated from measured distance

Minimum Building Pad Elevation for Lowest Opening into Structures		
Lot	Block	NAVD88
1 & 2	A	1380

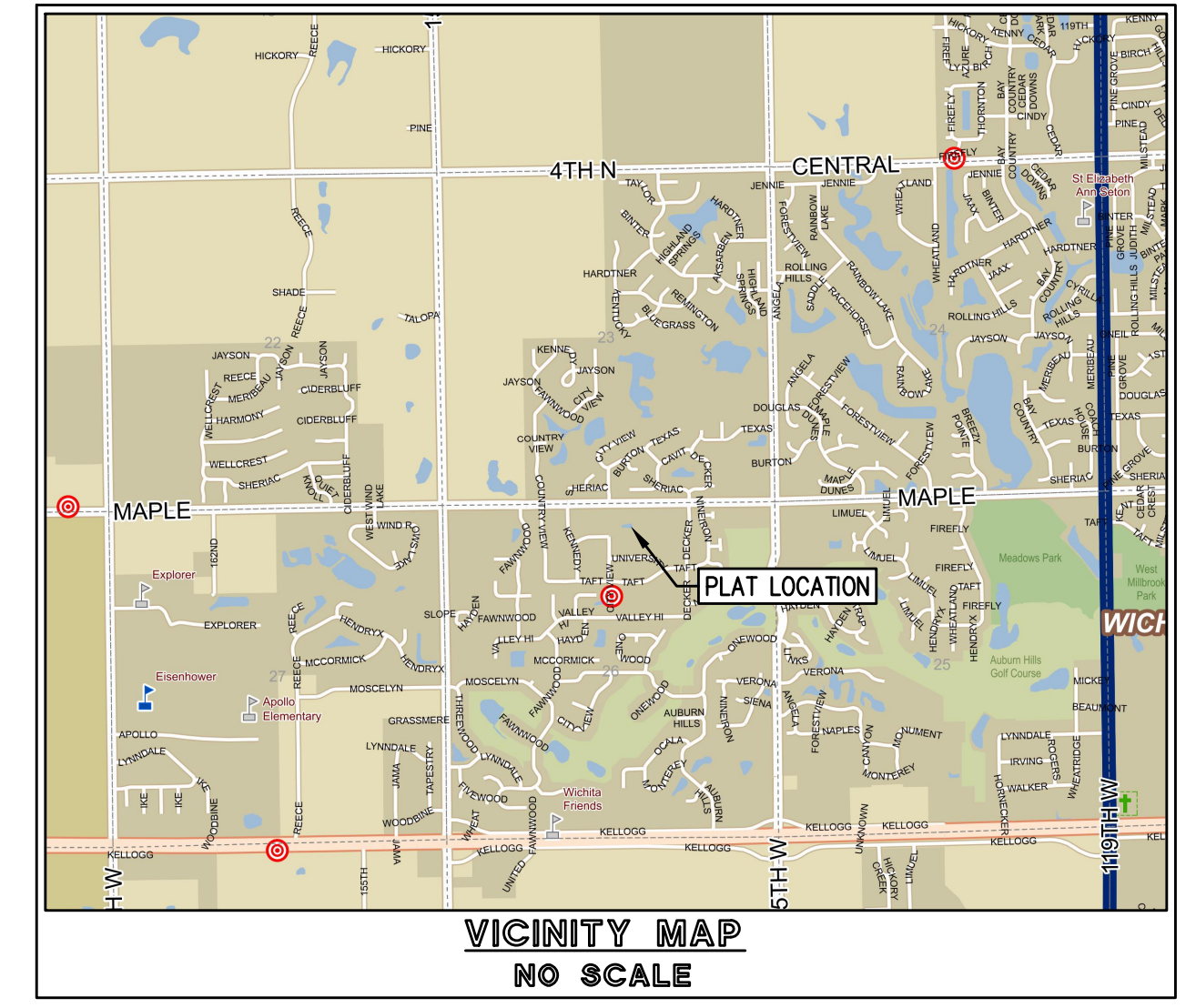

**LEGAL DESCRIPTION:**  
 THE EAST 2/3 OF A TRACT OF LAND DESCRIBED AS: BEGINNING 40 FEET EAST OF THE NORTHWEST CORNER OF THE NORTHEAST QUARTER, THENCE EAST 405 FEET; THENCE SOUTH 674 FEET; THENCE WEST 405 FEET; THENCE NORTH 674 FEET TO THE POINT OF BEGINNING, ALL IN SECTION 26, TOWNSHIP 27, RANGE 2 WEST, SEDGWICK COUNTY, KANSAS.

**SURVEYOR:**  
 DONALD C. ARMSTRONG, LS 780  
 ARMSTRONG LAND SURVEY, P.A.  
 1601 EAST HARRY STREET  
 WICHITA, KS 67211  
 316-263-0082

**OWNERS:**  
 BRIAN & SHONDA CURTIS  
 14213 W. HARDTNER ST.  
 WICHITA, KS 67235  
 (316) 761-1960

**NOTE: BOUNDARY SURVEY COMPLETED BY ARMSTRONG LAND SURVEY, P.A., ON OR ABOUT SEPTEMBER 16, 2022.**

**BENCHMARK:**  
 SQUARE CUT ON THE SOUTH END OF CURB MEDIAN ISLAND ON CITY VIEW STREET NORTH OF MAPLE STREET  
 ELEV. = 1387.36 (NAVD88)

DRAWINGS PREPARED BY:		
<b>CERTIFIED ENGINEERING DESIGN, P.A.</b>		
<b>CED</b>	1935 WEST MAPLE STREET WICHITA, KANSAS 67213 PH: (316) 262-8808 FAX: (316) 262-1669	SHEET 1
		TOTAL 1

FILE LOCATION: C:\Users\ypugh\OneDrive - CED\Projects\2022\20223151\DWG\Shonda Plat 2.dwg TAB NAME: PP USER: ypugh SAVED: 7/27/2023 1:28 PM PLOTTED: 7/27/2023 1:47 PM

