

# Hydraflow Plan View

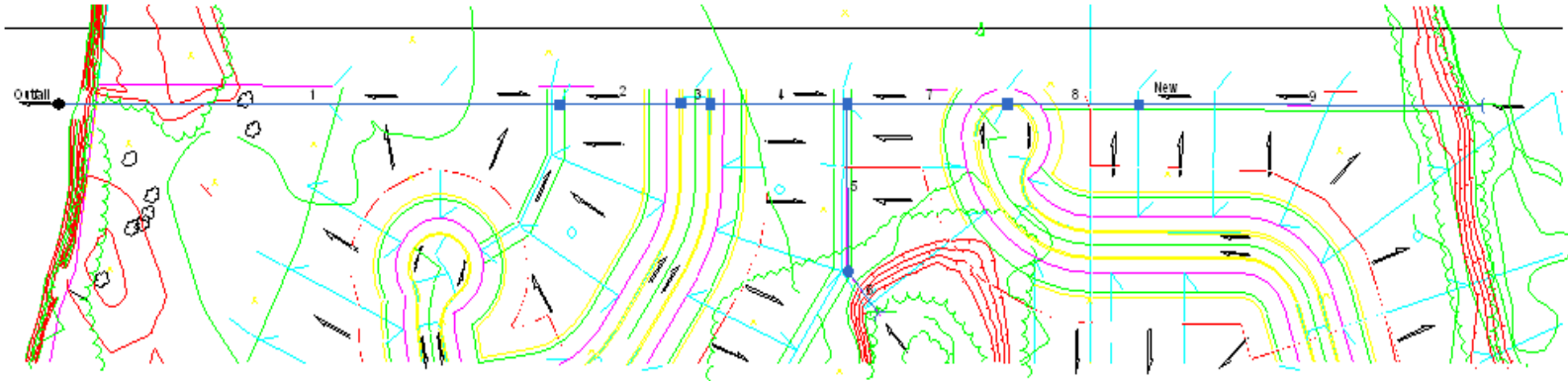

sws3\_RW

No. Lines: 9

04-23-2007

# Storm Sewer Summary Report

Line No.	Line ID	Flow rate (cfs)	Line size (in)	Line length (ft)	Invert EL Dn (ft)	Invert EL Up (ft)	Line slope (%)	HGL down (ft)	HGL up (ft)	Minor loss (ft)	HGL Junct (ft)	Dns line No.
1		15.30	24 c	568.0	1245.00	1246.70	0.299	1247.00*	1249.60*	0.18	1249.78	End
2		13.60	24 c	137.1	1246.70	1247.12	0.306	1249.86*	1250.36*	0.15	1250.50	1
3		12.15	24 c	33.0	1247.12	1247.21	0.272	1250.56*	1250.66*	0.12	1250.77	2
4		10.70	24 c	155.2	1247.21	1247.68	0.303	1250.83*	1251.17*	0.27	1251.44	3
5		2.00	15 c	171.1	1248.43	1248.99	0.327	1251.58*	1251.75*	0.03	1251.77	4
6		2.00	15 c	56.1	1248.99	1249.17	0.321	1251.77*	1251.83*	0.04	1251.87	5
7		7.90	18 c	181.2	1248.18	1248.72	0.298	1251.44*	1252.47*	0.16	1252.63	4
8		3.20	15 c	149.2	1248.97	1249.52	0.369	1252.83*	1253.20*	0.05	1253.25	7
9	(2)	2.00	15 c	388.1	1249.52	1252.00	0.639	1253.31*	1253.69*	0.04	1253.73	8

sws3_RW	Number of lines: 9	Run Date: 04-23-2007
---------	--------------------	----------------------

NOTES: c = cir; e = ellip; b = box; Return period = 10 Yrs. ; \*Surcharged (HGL above crown).

# Inlet Report

Line No	Inlet ID	Q = CIA (cfs)	Q carry (cfs)	Q capt (cfs)	Q byp (cfs)	Junc type	Curb Inlet		Grate Inlet			Gutter						Inlet			Byp line No		
							Ht (in)	L (ft)	area (sqft)	L (ft)	W (ft)	So (ft/ft)	W (ft)	Sw (ft/ft)	Sx (ft/ft)	n	Depth (ft)	Spread (ft)	Depth (ft)	Spread (ft)		Depr (in)	
1	New	1.70*	0.00	1.70	0.00	DrGrt	0.0	0.00	8.00	4.00	2.00	Sag	2.00	0.050	0.050	0.000	0.13	7.22	0.13	7.22	0.00	Off	
2		1.45*	0.00	1.45	0.00	Curb	6.0	10.00	0.00	0.00	0.00	Sag	2.00	0.080	0.030	0.000	0.23	4.26	0.29	4.26	2.00	Off	
3		1.45*	0.00	1.45	0.00	Curb	6.0	10.00	0.00	0.00	0.00	Sag	2.00	0.080	0.030	0.000	0.23	4.26	0.29	4.26	2.00	Off	
4		0.80*	0.00	0.80	0.00	DrGrt	0.0	0.00	8.00	4.00	2.00	Sag	2.00	0.050	0.050	0.000	0.08	5.16	0.08	5.16	0.00	Off	
5		0.00	0.00	0.00	0.00	MH	0.0	0.00	0.00	0.00	0.00	Sag	0.00	0.000	0.000	0.000	0.00	0.00	0.00	0.00	0.00	0.00	Off
6		2.00*	0.00	2.00	0.00	Hdwl	0.0	0.00	0.00	0.00	0.00	Sag	0.00	0.000	0.000	0.000	0.00	0.00	0.00	0.00	0.00	0.00	Off
7		4.70*	0.00	4.70	0.00	Curb	6.0	10.00	0.00	0.00	0.00	Sag	2.00	0.080	0.030	0.000	0.38	9.36	0.45	9.36	2.00	Off	
8		1.20*	0.00	1.20	0.00	Grate	0.0	0.00	8.00	4.00	2.00	Sag	2.00	0.080	0.020	0.000	0.09	1.11	0.14	1.31	2.00	Off	
9		2.00*	0.00	2.00	0.00	Hdwl	0.0	0.00	0.00	0.00	0.00	Sag	0.00	0.000	0.000	0.000	0.00	0.00	0.00	0.00	0.00	0.00	Off
sws3_RW													Number of lines: 9					Run Date: 04-23-2007					
NOTES: Inlet N-Values = 0.016 ; Intensity = 88.24 / (Inlet time + 15.50) ^ 0.83; Return period = 10 Yrs. ; * Indicates Known Q added																							

# Hydraulic Grade Line Computations

Line	Size (in)	Q (cfs)	Downstream								Len (ft)	Upstream								Check		JL coeff (K)	Minor loss (ft)
			Invert elev (ft)	HGL elev (ft)	Depth (ft)	Area (sqft)	Vel (ft/s)	Vel head (ft)	EGL elev (ft)	Sf (%)		Invert elev (ft)	HGL elev (ft)	Depth (ft)	Area (sqft)	Vel (ft/s)	Vel head (ft)	EGL elev (ft)	Sf (%)	Ave Sf (%)	Enrgy loss (ft)		
1	24	15.30	1245.00	1247.00	2.00	3.14	4.87	0.37	1247.37	0.458	568	1246.70	1249.60	2.00	3.14	4.87	0.37	1249.97	0.458	0.458	2.600	0.50	0.18
2	24	13.60	1246.70	1249.86	2.00	3.14	4.33	0.29	1250.15	0.362	137	1247.12	1250.36	2.00	3.14	4.33	0.29	1250.65	0.362	0.362	0.496	0.50	0.15
3	24	12.15	1247.12	1250.56	2.00	3.14	3.87	0.23	1250.79	0.289	33.0	1247.21	1250.66	2.00	3.14	3.87	0.23	1250.89	0.289	0.289	0.095	0.50	0.12
4	24	10.70	1247.21	1250.83	2.00	3.14	3.41	0.18	1251.01	0.224	155	1247.68	1251.17	2.00	3.14	3.41	0.18	1251.35	0.224	0.224	0.347	1.50	0.27
5	15	2.00	1248.43	1251.58	1.25	1.23	1.63	0.04	1251.62	0.096	171	1248.99	1251.75	1.25	1.23	1.63	0.04	1251.79	0.096	0.096	0.164	0.66	0.03
6	15	2.00	1248.99	1251.77	1.25	1.23	1.63	0.04	1251.82	0.096	56.1	1249.17	1251.83	1.25	1.23	1.63	0.04	1251.87	0.096	0.096	0.054	1.00	0.04
7	18	7.90	1248.18	1251.44	1.50	1.77	4.47	0.31	1251.75	0.566	181	1248.72	1252.47	1.50	1.77	4.47	0.31	1252.78	0.566	0.566	1.026	0.50	0.16
8	15	3.20	1248.97	1252.83	1.25	1.23	2.61	0.11	1252.94	0.246	149	1249.52	1253.20	1.25	1.23	2.61	0.11	1253.30	0.246	0.246	0.367	0.50	0.05
9	15	2.00	1249.52	1253.31	1.25	1.23	1.63	0.04	1253.36	0.096	388	1252.00	1253.69	1.25	1.23	1.63	0.04	1253.73	0.096	0.096	0.372	1.00	0.04

sws3\_RW

Number of lines: 9

Run Date: 04-23-2007

# Storm Sewer Profile

Elev. (ft)

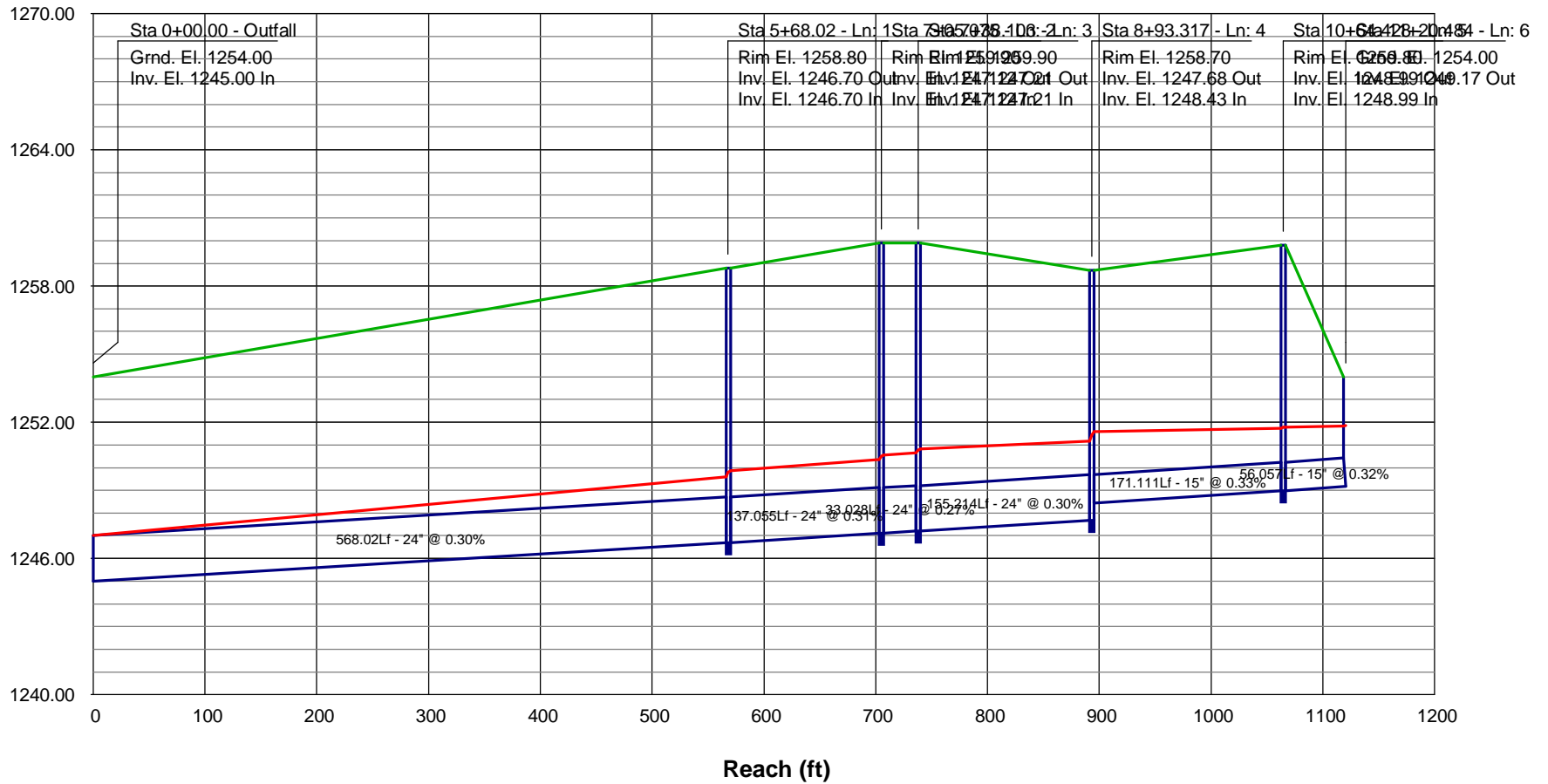

# Storm Sewer Profile

Elev. (ft)

