

# GRADING PLAN EDGE WATER ADDITION WICHITA, SEDGWICK COUNTY, KANSAS

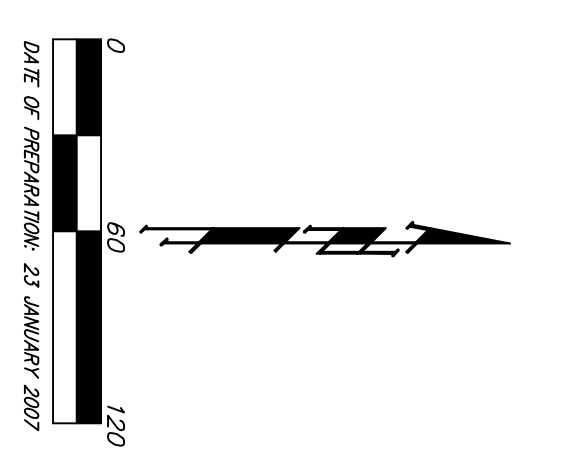

**PROVISIONS:**  
 HOOPER AND 43<sup>RD</sup> ST. NORTH  
 10.25' TO 15.25' OF THE CORNER OF INTERSECTION  
 OF HOOPER AND 43<sup>RD</sup> ST. NORTH  
 26.50' TO 27.50' OF THE CORNER OF INTERSECTION  
 OF HOOPER AND 43<sup>RD</sup> ST. NORTH  
 26.50' TO 27.50' OF THE CORNER OF INTERSECTION  
 OF HOOPER AND 43<sup>RD</sup> ST. NORTH  
 26.50' TO 27.50' OF THE CORNER OF INTERSECTION  
 OF HOOPER AND 43<sup>RD</sup> ST. NORTH

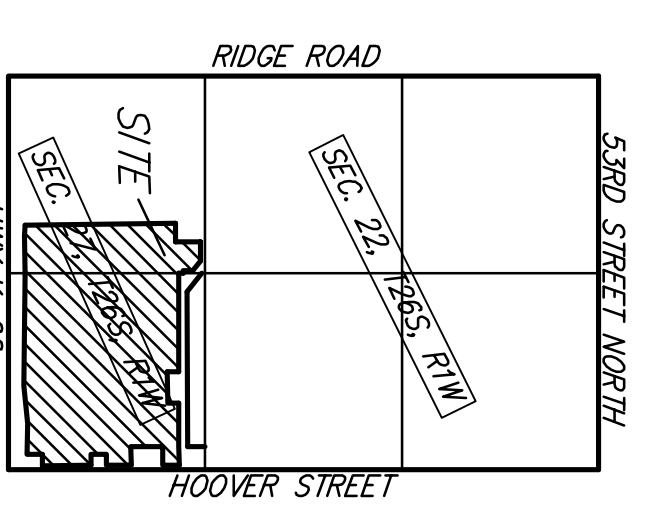
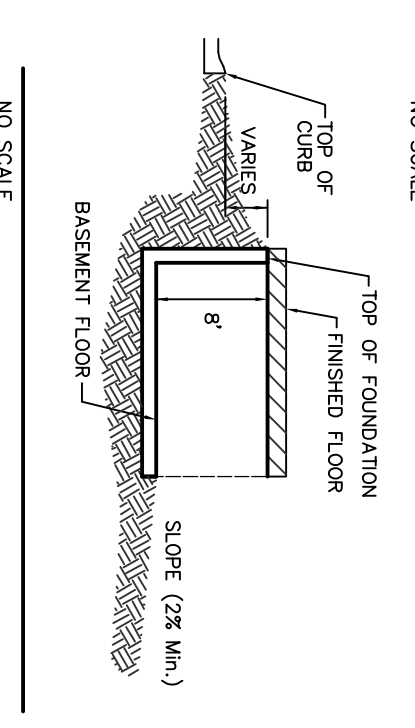
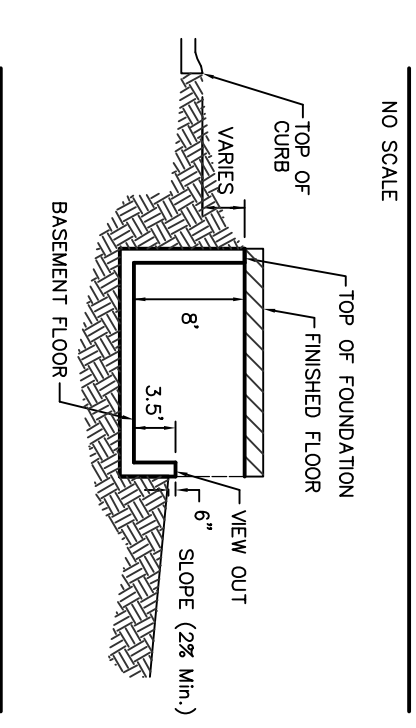
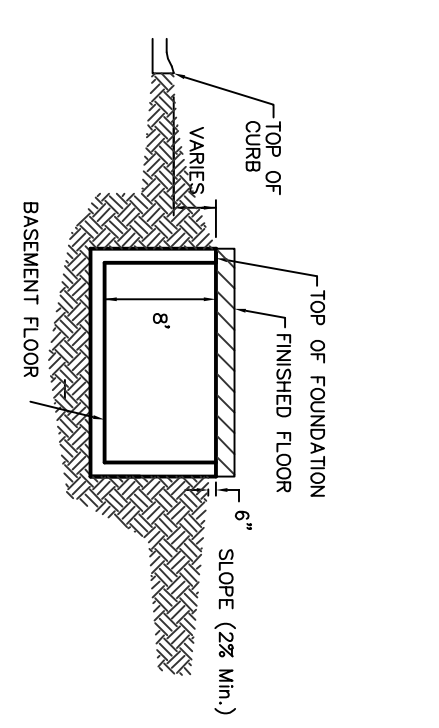

**NOTES:**

1. PROPOSED TOP OF FOUNDATION ELEVATIONS ARE SHOWN ON PLANS. CONTRACTOR TO SET FINISHED FLOOR AND GARAGE FLOOR ELEVATIONS. ALL STREET ELEVATIONS SHOWN ON PLANS ARE FOR TOP OF CURB (FULL-HEIGHT).
2. THIS GRADING PLAN IS DESIGNED WITH MEN-OUTS AND WALK-OUTS. ELEVATIONS SHOWN AS XXX.X V.O. DEPICT VIEW-OUT STRUCTURES. WALK-OUT STRUCTURES.
3. ALL LOTS SHALL MEET MINIMUM PAD REQUIREMENT AS SHOWN ON THE RECORDED PLAT.

LOT	BLOCK	ELEVATION	NO. OF
18-19	A	126.0	NO. OF
1-3-8-25	C	126.0	NO. OF
5-8-26-28	C	126.0	NO. OF
9-27	D	126.0	NO. OF

NOTES: No FEMA Special Flood Hazard Area exists on this property as of January 25, 2007.

Ponds will retain all runoff from the proposed subdivision. The proposed ponds will provide adequate storage for the sites' 100-year rainfall with no outlet.

