

DRAINAGE PLAN E.S. DEVELOPMENT MIDWEST COMMERCIAL ADDITION WICHITA, SEDGWICK COUNTY, KANSAS

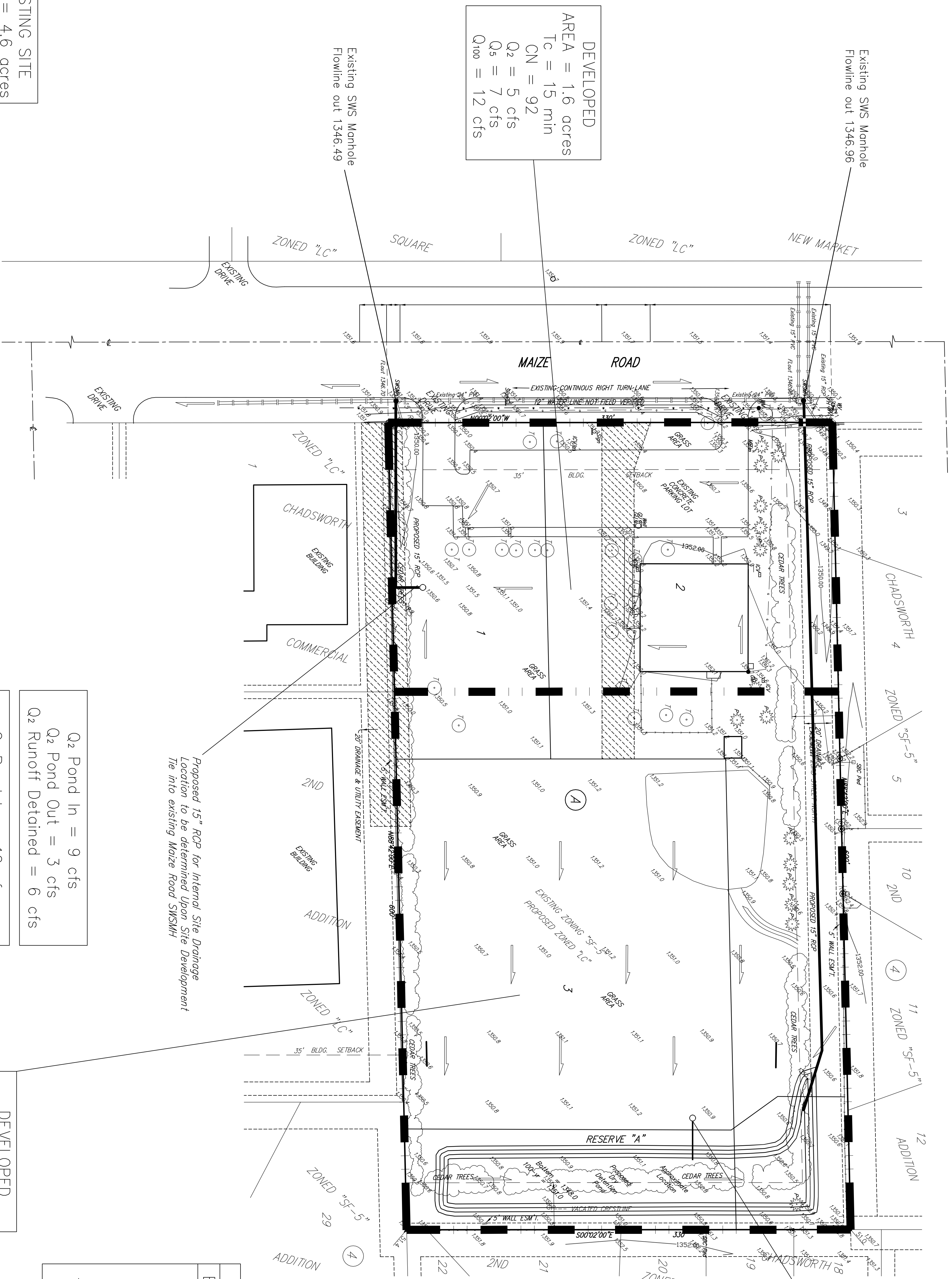

EXISTING SITE
 Area = 4.6 acres
 CN = 69
 Tc = 15 min
 Q₂ = 5 cfs
 Q₅ = 9 cfs
 Q₁₀₀ = 24 cfs

DEVELOPED
 AREA = 1.6 acres
 Tc = 15 min
 CN = 92
 Q₂ = 5 cfs
 Q₅ = 7 cfs
 Q₁₀₀ = 12 cfs

Q₂ Pond In = 9 cfs
 Q₂ Pond Out = 3 cfs
 Q₂ Runoff Detained = 6 cfs

Q₅ Pond In = 12 cfs
 Q₅ Pond Out = 4 cfs
 Q₅ Runoff Detained = 8 cfs

Q₁₀₀ Pond In = 23 cfs
 Q₁₀₀ Pond Out = 5 cfs
 Q₁₀₀ Runoff Detained = 18 cfs

DEVELOPED
 AREA = 3.0 acres
 Tc = 15 min
 CN = 92
 Q₂ = 9 cfs
 Q₅ = 12 cfs
 Q₁₀₀ = 24 cfs

100-yr Pond Summary				
Elevation	Storage	Time	Inflow	Discharge
1348.0	0.0 ac-ft	0.0 hrs	0 cfs	0 cfs
1348.5		11.0	1.4	0.7
1349.0	0.205	11.8	9.0	2.3
1349.5		11.95	20	3.5
1350.0	0.550	12.0	23*	3.8
1350.5		12.1	21	4.3
1350.96*		12.4	5	4.7*
1351.0	0.724			

* Indicates Peak Values

