

Grading Plan

EMERALD BAY ESTATES

Wichita, Sedgwick County, Kansas

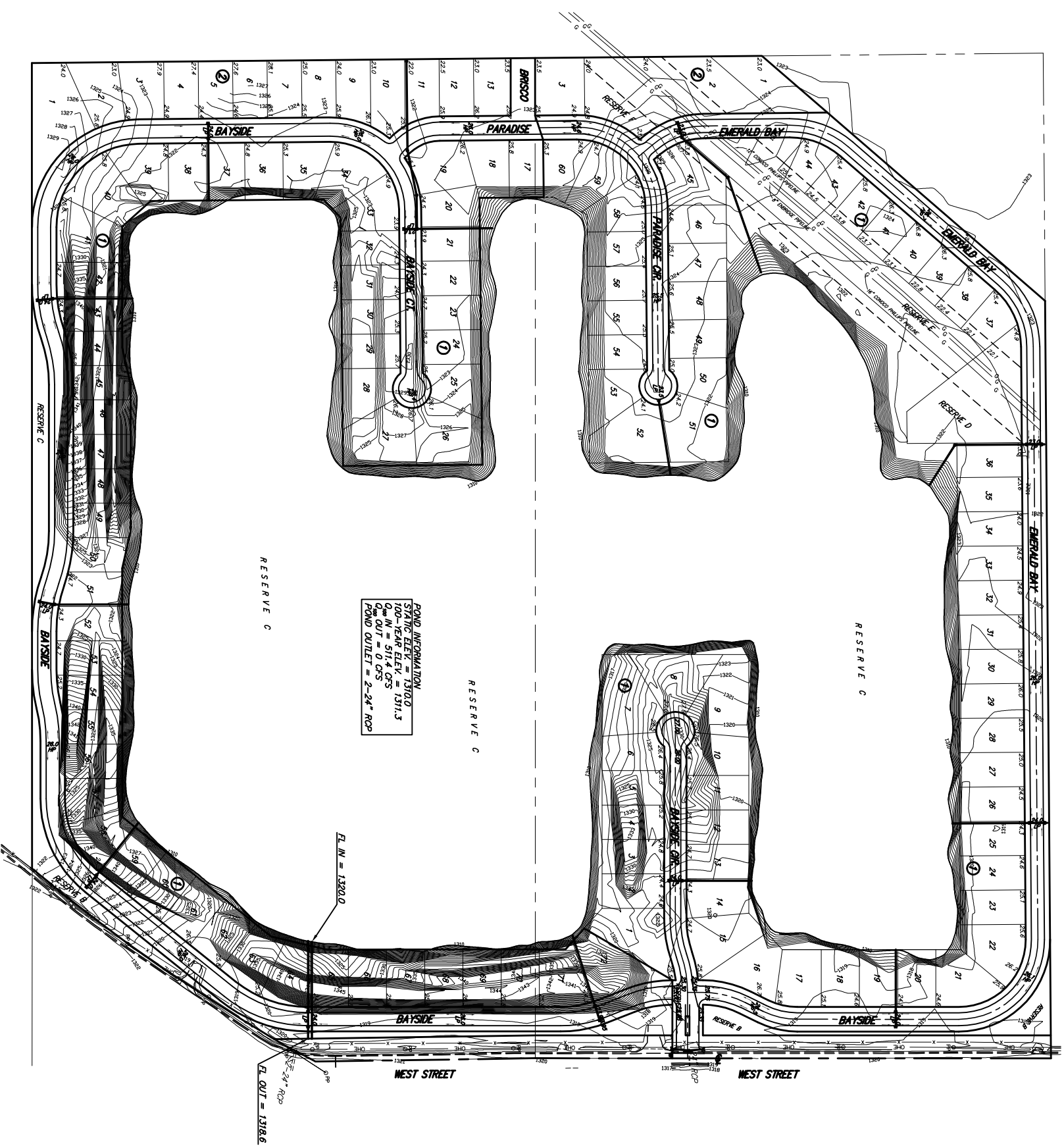

1" = 150'

Lot Cross Sections

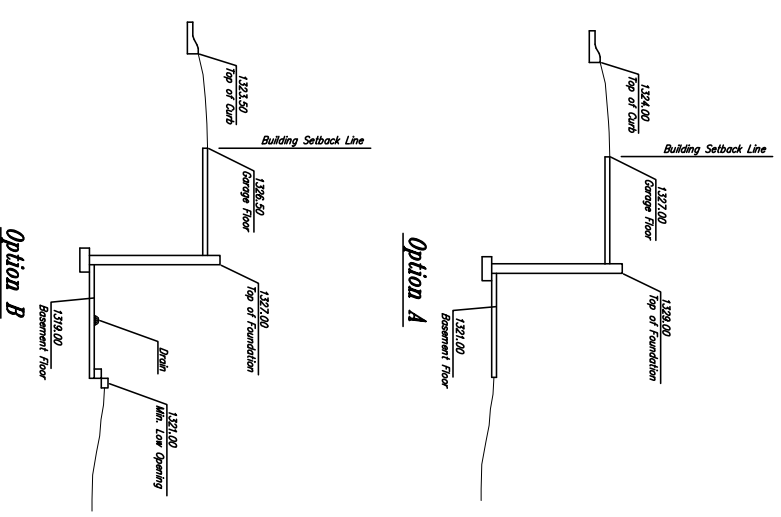

NOTE:
 MINIMUM PAD ELEVATION FOR ALL LOTS WITH BACK
 LOTS LINES BORDERING POND SHALL BE 1321.00

ONE FILE SHEET BASE
 NUMBER 11, 2025



Rugles & Bohm, PA
 Engineering, Surveying, Land Planning
 624 North Main
 Wichita, Kansas 67203
 www.rboh.com
 (316) 264-8008
 (316) 264-4621 fax
 E-mail: info@rboh.com