

Call Before You Dig!
1-800-DIG SAFE
 or 687-2470 In Wichita
 Call Kansas One-Call at Least Two (2)
 Working Days Before Work Begins

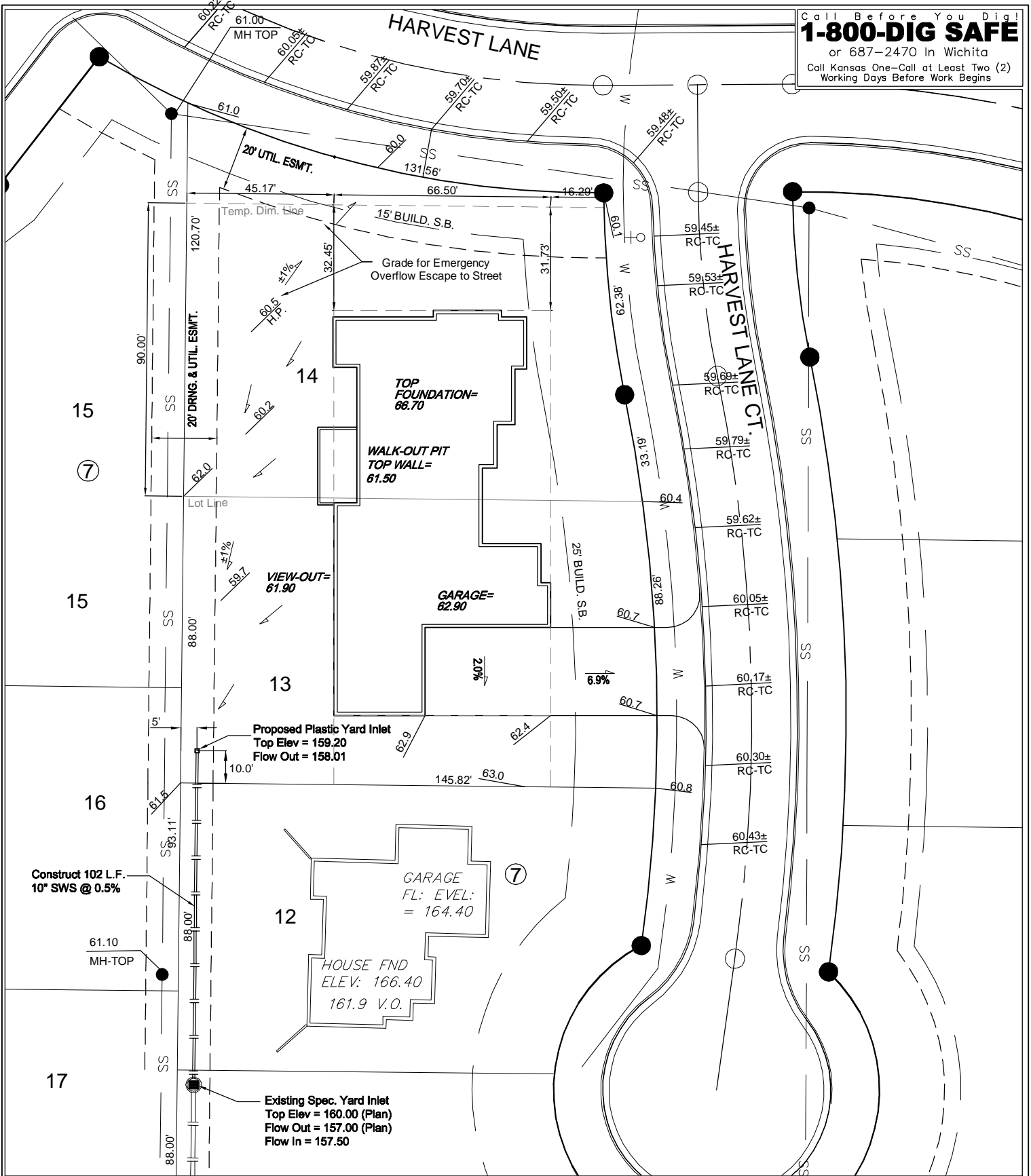

General Notes:

1. This drawing is schematic and is not to be used for construction.
2. No utilities have been located. It shall be the contractor's responsibility to contact Kansas One-Call prior to any excavation.
3. The existing inlet top and flow are based on original construction plans.
4. Contractor shall be required to coordinate access, and to remove/replace existing sod and sprinklers encountered as necessary.
5. Contractor may field adjust pipe location and elevation as necessary to avoid existing utilities.



Private Storm Sewer Improvements

Location:
 Lots 12-13, Block 7
 Hickory Creek Estates

Prepared For:
 Randy Ketzner Construction
 Phone: 721-7945 Fax: 721-8637

File Location:
 F:\Grade\HICKCRK\Lot 13-14 Randy....dwg

Drawn By:
 DSM/AEG

Date Drawn:
 09.08.06

Project Number:

Reviewed By:

Approved By:

Baughman
 ENGINEERING | SURVEYING | PLANNING
 LANDSCAPE ARCHITECTURE

Baughman Company, P.A.
 315 E. 11th | Wichita, KS 67211
 P316-262-7271 F316-262-0149