

# DRAINAGE PLAN MEADOW LAKE BEACH ADDITION WICHITA, SEDGWICK COUNTY, KANSAS



PROPOSED POND (SHEEP POND) (SHEEP POND)

STAGE	INFLOW	OUTFLOW	ELEVATION
2' W	46.26	0.26	126.83
3' W	202.54	0.26	126.83
4' W	425.08	0.26	126.83

DATE OF PREPARATION: 26 OCTOBER 2004  
DATE OF REVISION: 20 NOVEMBER 2004  
DRAWING NUMBER: 17801

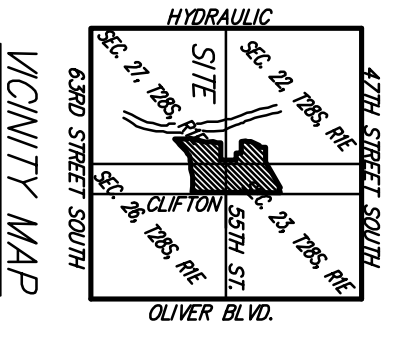

BENCHMARK: WICHITA BENCHMARK DISC, SE CORNER OF CLIFTON AND 55TH ST., SOUTHWEST CORNER OF RES. ON TOP OF HILLOARD AT THE WEST END. ELEV. = 1263.29 (NOV02)

Existing Rational C	2Yr		100Yr		2Yr		100Yr	
	Area	Flow	Area	Flow	Area	Flow		
0.4	0.45	0.51	0.48	0.54	0.54	0.64		

Basin ID	Area	Existing Flows		Developed Flows	
		2Yr	100Yr	2Yr	100Yr
1	0.8	1.8	2.0	2.2	2.4
2	0.9	1.4	1.8	1.7	2.2
3	1.0	1.5	2.1	4.2	1.8
4	0.6	0.9	1.2	2.5	1.1
5	2.0	3.1	4.1	8.4	3.7
6	2.4	3.7	4.9	10.1	4.4
7	0.8	1.2	1.6	1.5	2.0
8	0.5	0.8	1.0	1.2	1.5
9	0.8	1.2	1.6	3.4	1.5
10	0.7	1.1	1.1	3.3	2
11	2.0	3.1	4.1	8.4	3.7
12	0.5	0.8	1.0	1.2	1.5
13	0.4	0.6	0.8	1.7	0.7
14	0.4	0.6	0.8	1.7	0.7
15	3.8	5.8	7.8	16.0	7.0
16	0.4	0.6	0.8	1.7	0.7
17	1.1	1.7	2.3	6.7	2.9
18	1.8	2.5	3.3	8.7	2.9
19	0.8	1.2	1.6	1.5	2.0
20	0.3	0.5	0.6	1.3	0.6
21	0.3	0.5	0.6	1.3	0.6
22	1.3	2.0	2.7	5	2.4
23	0.1	0.2	0.2	0.4	0.2
24	0.5	0.8	1.0	2.1	0.9
25	0.9	1.3	1.7	2.9	1.2
26	0.9	1.3	1.7	2.9	1.2
27	1.1	1.7	2.3	4.6	2.0
28	0.7	1.1	1.4	2.9	1.3
29	1.0	1.5	2.1	4.2	1.8
30	1.1	1.7	2.3	4.6	2.0
31	1.3	2.0	2.7	5.5	2.4
32	0.7	1.1	1.4	2.9	1.3
33	0.7	1.1	1.4	2.9	1.3
34	0.6	0.9	1.2	2.5	1.1
35	1.2	1.8	2.5	5.0	2.2
36	0.5	0.8	1.0	2.1	0.9
37	2.1	3.1	4.1	8.4	3.7
38	1.8	2.8	3.7	7.8	3.3
39	0.7	1.1	1.4	2.9	1.3
40	1.5	2.3	3.1	6.3	2.8
41	0.6	0.9	1.2	2.5	1.1
42	0.9	1.4	1.8	3.8	1.7
43	1.8	2.8	3.7	7.8	3.3
44	0.6	0.9	1.2	2.5	1.1
45	0.6	0.9	1.2	2.5	1.1
46	0.7	1.1	1.4	2.9	1.3
47	1.8	2.8	3.7	7.8	3.3
48	0.4	0.6	0.8	1.7	0.7
49	0.4	0.6	0.8	1.7	0.7
50	0.3	0.5	0.6	1.3	0.6
51	0.3	0.5	0.6	1.3	0.6
52	0.5	0.8	1.0	2.1	0.9
53	0.6	0.9	1.2	2.5	1.1
54	0.3	0.5	0.6	1.3	0.6
55	0.4	0.6	0.8	1.7	0.7
56	0.4	0.6	0.8	1.7	0.7
57	0.4	0.6	0.8	1.7	0.7
58	0.4	0.6	0.8	1.7	0.7
TOTAL	68.8	92	123	232	110

NOTE: All lots lie within the FEMA 100-Yr Floodplain Boundary. Base Flood Elevations are as shown. Boundary and BEF are per Preliminary Sedgwick County FEMA Flood Zones 500 & 510 of 2003.