

DRAINAGE PLAN

NEWMAN UNIVERSITY 3RD ADDITION WICHITA, SEDGWICK COUNTY, KANSAS

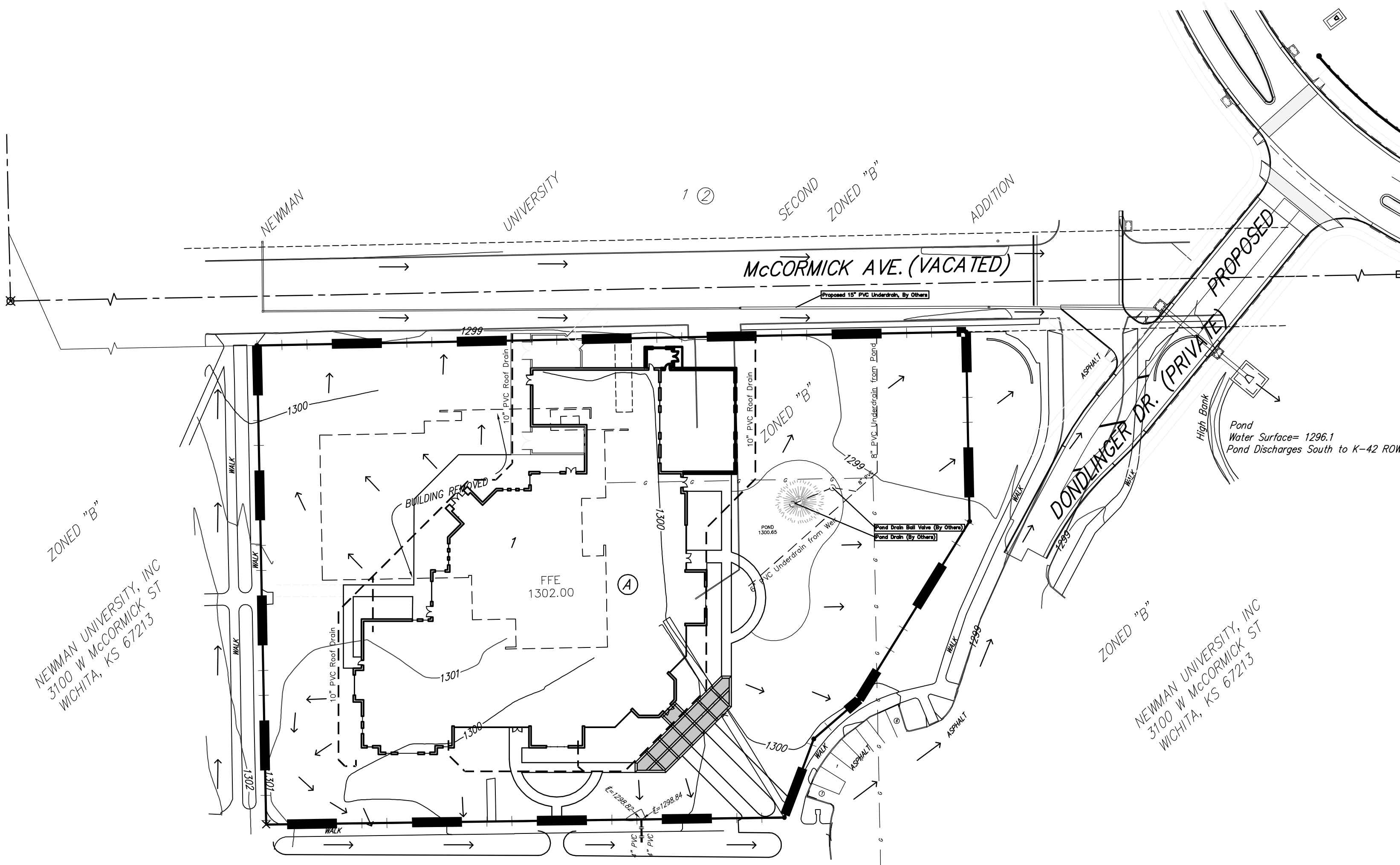

Existing = Developed
 DA = 2.7 acres
 Tc = 15 min
 'C' = 0.85
 Q₂ = 9.0 cfs
 Q₅ = 10 cfs
 Q₁₀₀ = 17 cfs

NOTE: Proposed building to include roof drains to drain into proposed 15" PVC SWS. Proposed SWS to drain into existing pond to the east.

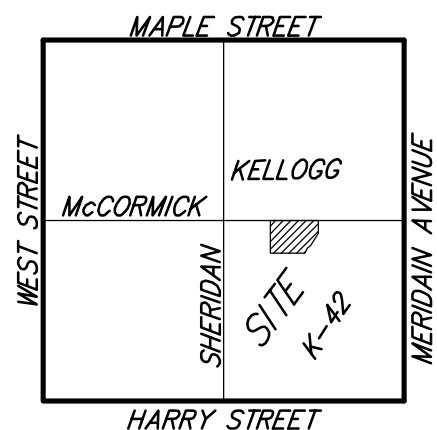

VICINITY MAP
 SEC. 25, T27S, R1W

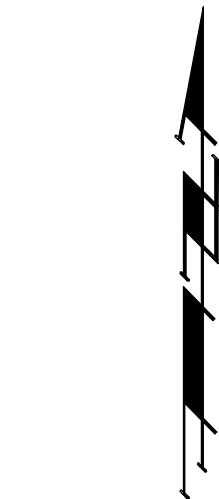

0 50 100
 DATE OF PREPARATION: 12 APRIL 2006
 DATE OF TOPOGRAPHY: 11 NOVEMBER 2006
 CONTOUR INTERVALS = 1 FOOT

BENCHMARK:
 COW BENCHMARK-SE COR. OF INTERSECTION OF SHERIDAN &
 McCORMICK LYING 24' E. OF CENTERLINE & 46.3' S. OF
 CENTERLINE.
 ELEV. = 1299.76 NGVD29