

MH TOP=1363.2  
 FL OUT=1358.44  
 FL IN=1358.54

MH TOP=1363.5  
 FL OUT=1352.08(S)AB  
 FL IN=1352.18(W)

MH TOP=1361.2  
 FL OUT=1358.18  
 FL IN=1358.28

MH TOP=1363.9  
 FL OUT=1358.53  
 FL IN=1358.63

TF=1370.0  
 BF=1362.3  
 9'-0" BSMT.

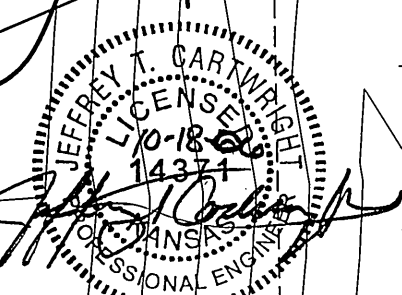

**LACKING OVERALL  
 GENERAL NOTES**

- Builder shall provide retaining walls along property line for grade transitions when required to maintain proper slopes between houses.
- This drawing is provided for grading purposes only.
  - drawing does not represent a boundary or mortgage title inspection. Easement and Building Setback information shown is from the recorded plat unless otherwise indicated.
  - Utilities shown are for information only, and builder shall verify depths and locations prior to construction. Builder will be required to provide a minimum advance notice of forty-eight (48) hours to utility companies prior to starting any excavation as follows: Kansas One Call 1-800-344-7233 or 687-2470 (local Wichita).

**BUILDER: ROBL CONSTRUCTION**

**LEGEND**

BENCHMARK:		DISTANCE FROM HOUSE TO PROPERTY LINE	
1. N/A		FRONT	30.55'
		REAR	75.35'
		LEFT	6.51'
		RIGHT	6.34'
T.W.	Top of Wall		
F.G.	Finished Ground		
B.F.	Basement Floor		
188.0	Proposed Elevations		
x 00.0	Existing Elevations		
0.0%	Flow Arrow & Percent Slope		
PAD	Elevation @ Garage Door Opening		
T.F.	Top of Foundation		
T.C.	Top of Curb	T.F.	1370.0
FL	Flow Line	Sanitary Sewer FL	1352.2
Add 1 Step	Step from Garage Floor to Finish Floor	T.F. - Sanitary Sewer	17.8
-----	Drop Siding or Brick Ledge	Minimum Pad	X
GRD.	Ground	BFE (PENDING FEMA)	X

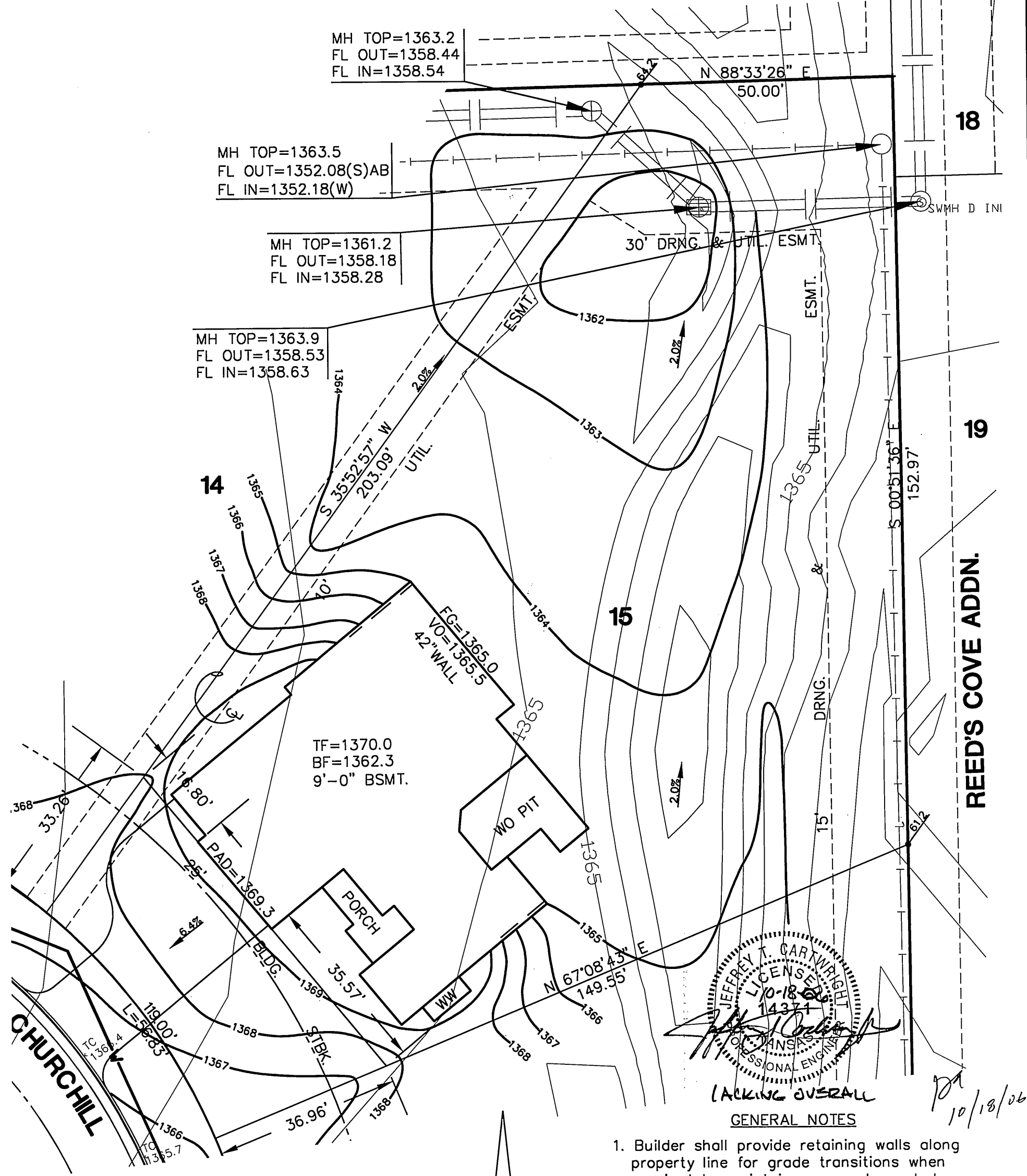
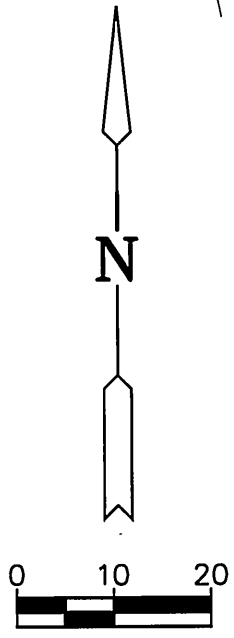

*10/18/06*