

**VICINITY MAP**

**BENCHMARK**

- BM#1 60' IN SOUTH LEG OF "H" POLE HIGH LINE STRUCTURE, 75' NORTH & 80' EAST OF C 127TH STREET & CENTERLINE BURLINGTON NORTHERN RAILROAD. ELEV. = 1365.37'
- BM#2 Top of iron at SW. Cor., SW. 1/4, Sec. 2, T27S, R2E, (127th St. E. & 21st St. N.). ELEV. = 198.01 (CITY DATUM) 1385.41 NGVD

**LEGEND**

- ⊙ - CONIFEROUS TREE & DIAMETER
- ⊙ - DECIDUOUS TREE & DIAMETER
- ⊙ - SIGN
- ⊙ - BUSH
- - EDGE OF TREES
- - FENCE
- ⊙ - SANITARY SEWER MANHOLE
- ⊙ - GAS METER
- ⊙ - POLE
- ⊙ - POLE - HIGH LINE POLE
- ⊙ - GATE
- - WALL
- ⊙ - LIGHT POLE
- ⊙ - FIRE HYDRANT
- ⊙ - WATER VALVE
- ⊙ - WATER METER
- ⊙ - POWER POLE AND GUY ANCHOR
- ⊙ - TELEPHONE RISER
- ⊙ - INLET
- - STORM SEWER PIPE
- - WATER LINE
- - SANITARY SEWER LINE
- - GAS LINE
- - TELEPHONE LINE
- - UNDERGROUND ELECTRIC LINE
- - OVERHEAD TELEPHONE
- - OVERHEAD ELECTRIC
- - UNDERGROUND FIBER OPTIC CABLE
- ⊙ - SECTION CORNER
- ⊙ - PROPERTY CORNER FOUND
- ⊙ - BENCHMARK
- ⊙ - VIEWOUT
- ⊙ - TERRACED VIEWOUT
- ⊙ - WALKOUT WHICH MAY REQUIRE THICKER FOOTING AND/OR ENGINEERED FILL UNDER FOOTINGS
- ⊙ - SPOT ELEVATIONS
- ⊙ - PROP. HOUSE ELEV.
- ⊙ - EXIST. PLOT PLAN HOUSE ELEV.

**REED'S COVE ADDITION**

MINIMUM PAD ELEVATIONS (LOWEST OPENINGS)			
LOT	BLOCK	ELEVATION (CITY DATUM)	ELEVATION (USGS)
1	1	165.60	1353.00
2	1	165.60	1353.00
3	1	165.60	1353.00
4	1	165.60	1353.00
5	1	165.60	1353.00
9	1	169.60	1357.00
10	1	169.10	1356.50
11	1	168.10	1355.50
12	1	168.10	1355.50
13	1	166.60	1354.00
14	1	166.60	1354.00
15	1	168.10	1355.50
16	1	168.10	1355.50
17	1	169.10	1356.50
18	1	169.60	1357.00
1	2	165.60	1353.00
2	2	165.60	1353.00
3	2	165.60	1353.00
4	2	165.60	1353.00
5	2	165.60	1353.00
6	2	165.60	1353.00
7	2	165.60	1353.00
8	2	163.60	1351.00
9	2	161.60	1349.00
10	2	161.60	1349.00

**REED'S COVE 2ND ADDITION**

MINIMUM PAD ELEVATIONS (LOWEST OPENINGS)			
LOT	BLOCK	ELEVATION (CITY DATUM)	ELEVATION (USGS)
1	1	166.10	1353.00
1	4	165.10	1353.00

\* WITH CORRECTION TO PLAT

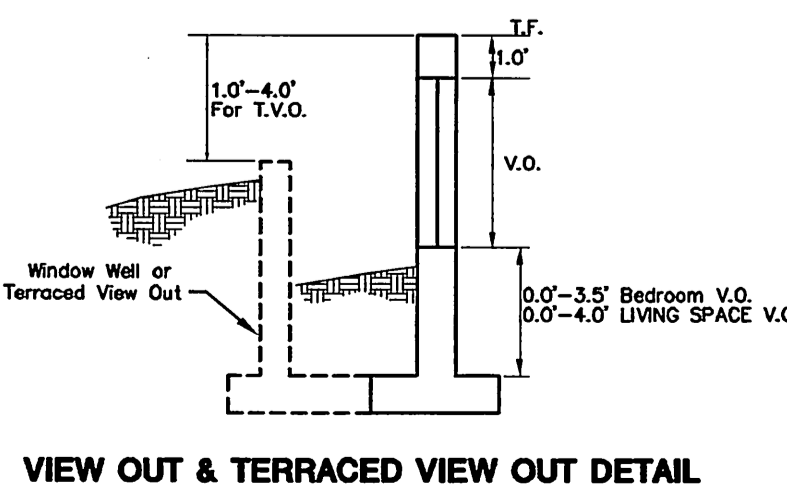

**VIEW OUT & TERRACED VIEW OUT DETAIL**

DATES	NOTES
11/24/03	INITIAL PHASE
12/11/03	ADD REED'S COVE 2ND
8/24/04	ADDITIONAL PHASES
3/15/05	ADDITIONAL PHASE
2/13/06	ADDITIONAL PHASES
12/28/06	ADD REED'S COVE 4TH

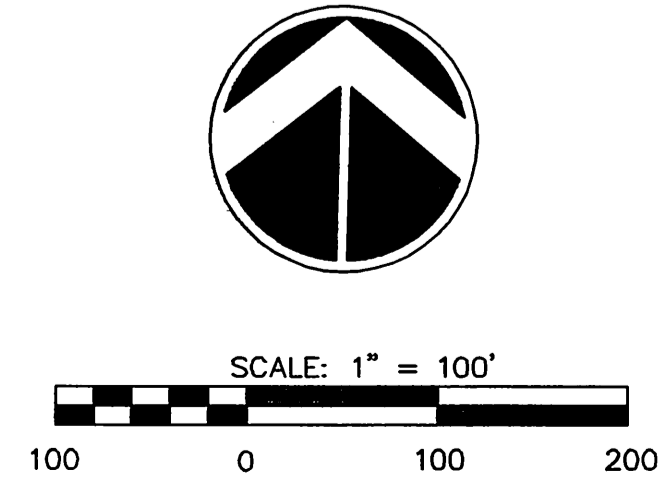

**UPDATED: DECEMBER 2006**  
**UPDATED: FEBRUARY 2006**  
**UPDATED: SEPTEMBER 2005**

**MKEC**  
 ENGINEERING CONSULTANTS, INC.  
 PROJECT NAME: **REED'S COVE ADDITIONS**  
 SHEET TITLE: **VIEWOUT AND WALKOUT PLAN**

411 N. WEBB ROAD  
 WICHITA, K.S. 67206  
 316-684-9600

DESIGN BY: **JFL**  
 DATE: **JULY 2004**

DRAWN BY: **GJA**  
 JOB NO.: **02121**

CHECKED BY: **JFL**  
 SHEET OF: **1 / 1**