

Drainage Plan SPANGLES ADDITION

WICHITA, SEDGWICK COUNTY, KANSAS

Legal Description:

The north 100 feet of the south 275 feet of the west 160 feet of Lot 17, except the west 10 feet there, dedicated for street, Block 4, Lynncrest Heights an Addition to Wichita, Sedgwick County, Kansas.

OFFSITE DEVELOPED DRAINAGE DATA:
Area = 0.16 acre
SCS Soil Type D
Urban Land-Irwin Complex,
1% to 3% Slopes
C 5 = 0.87
C 100 = 0.89
Tc = 15 Min
i 5 = 4.62"/hr.
i 100 = 7.40"/hr.
Q 5 = 0.64 cfs
Q 100 = 1.05 cfs

ONSITE DEVELOPED DRAINAGE DATA:
Area = 0.07 acre
SCS Soil Type D
Urban Land-Irwin Complex,
1% to 3% Slopes
C 5 = 0.87
C 100 = 0.89
Tc = 15 Min
i 5 = 4.62"/hr.
i 100 = 7.40"/hr.
Q 5 = 0.28 cfs
Q 100 = 0.46 cfs

ONSITE DEVELOPED DRAINAGE DATA:
Area = 0.97 acre
SCS Soil Type D
Urban Land-Irwin Complex,
1% to 3% Slopes
C 5 = 0.87
C 100 = 0.89
Tc = 15 Min
i 5 = 4.62"/hr.
i 100 = 7.40"/hr.
Q 5 = 3.90 cfs
Q 100 = 6.39 cfs

ONSITE & OFFSITE DEVELOPED DRAINAGE DATA:
Area = 1.13 acre
SCS Soil Type D
Urban Land-Irwin Complex,
1% to 3% Slopes
C 5 = 0.87
C 100 = 0.89
Tc = 15 Min
i 5 = 4.62"/hr.
i 100 = 7.40"/hr.
Q 5 = 4.54 cfs
Q 100 = 7.44 cfs

ONSITE UNDEVELOPED DRAINAGE DATA:
Area = 1.0 acre
SCS Soil Type D
Urban Land-Irwin Complex,
1% to 3% Slopes
C 5 = 0.35
C 100 = 0.65
Tc = 34 Min.
i 5 = 3.09"/hr.
i 100 = 5.18"/hr.
Q 5 = 1.08 cfs
Q 100 = 3.37 cfs

ONSITE DEVELOPED DRAINAGE DATA:
Area = 0.12 acre
SCS Soil Type D
Urban Land-Irwin Complex,
1% to 3% Slopes
C 5 = 0.87
C 100 = 0.89
Tc = 15 Min
i 5 = 4.62"/hr.
i 100 = 7.40"/hr.
Q 5 = 0.48 cfs
Q 100 = 0.79 cfs



GRAPHIC SCALE
(IN FEET)
1 inch = 30 ft.

C.A.C. = Complete Access Control

LEGEND:

P = Plotted
M = Measured

- 1/2" IP 1/2" IRON PIPE (FOUND)
- BPN 1/2" REBAR W/BAUGHMAN CAP (FOUND)
- SAV 1/2" REBAR W/SAVOY CAP (SET)
- MAG/SAV WSH MAG NAIL W/SAVOY WASHER (SET)
- CROSS CHISELED CROSS (FOUND)
- IW CHISELED V-NOTCH (SET)

LEGEND

- G = GAS MAIN
- W = WATER MAIN
- SS = SANITARY SEWER
- SWS = STORM WATER SEWER
- UGT = UNDER GROUND TELEPHONE
- TELE. PED TELEPHONE PEDESTAL
- E.M. ELECTRIC METER
- E.O. ELECTRIC OUTLET
- ← GUY ANCHOR
- G.M. GAS METER
- G.P. GUARD POST
- HIGH LINE POLE
- M.W. MONITOR WELL
- △ TELEPHONE
- POWER POLE
- SIGN
- W.M. WATER METER
- XTMR ELECTRIC TRANSFORMER
- SS M.H. SANITARY SEWER MANHOLE

↻ = EXISTING FLOW DIRECTION

----- = RIDGELINE(EXISTING)

----- = FEMA FLOODPLAIN BOUNDARY(SCALED)

----- = FEMA FLOODPLAIN BOUNDARY(ELEVATION 1327)

QUADRANGLE MAP

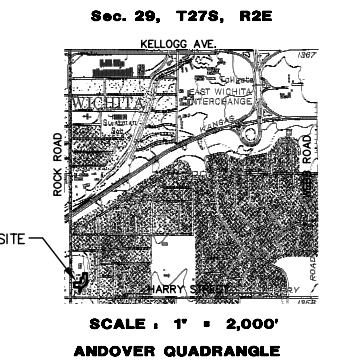

FLOOD ZONE MAP

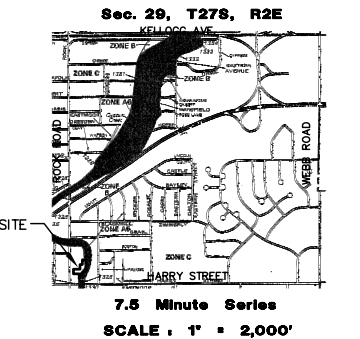

FLOOD ZONE:
Subject property is in Zones A6 & B, as shown of Federal Emergency Management Agency (FEMA) Flood Insurance Rate Map (FIRM) for Wichita, Sedgwick County, Kansas, Panel Number 200328 0030 A, effective May 15, 1986.



OWNER:
Spangles, Inc.
437 N Hillside
Wichita, Kansas 67214
Ph 685-8817

MINIMUM LOT SIZE
14999.71 Sq. Ft.
0.34 Acres±

ZONING
LC - Limited Commercial

GROSS SIZE
14999.71 Sq. Ft.
0.34 Acres±

CONTROL NUMBER
17727

NET SIZE
14999.71 Sq. Ft.
0.34 Acres±

DRAINAGE PLAN PREPARED BY:
CERTIFIED ENGINEERING DESIGN, P.A.

CED 810 WEST DOUGLAS, SUITE C WICHITA, KANSAS 67203
PH: (316) 262-8808
FAX: (316) 262-1669

SHEET 1
TOTAL 1