

DRAINAGE PLAN TURKEY CREEK 3RD ADDITION WICHITA, SEDGWICK COUNTY, KANSAS

BOARD OF COUNTY COMMISSIONERS
OF SEDGWICK COUNTY, KANSAS
(BOARD FILE NO. 200521)

BOARD OF COUNTY COMMISSIONERS
OF SEDGWICK COUNTY, KANSAS
(BOARD FILE NO. 200521)

U.S. HIGHWAY 54

U.S. HIGHWAY 54

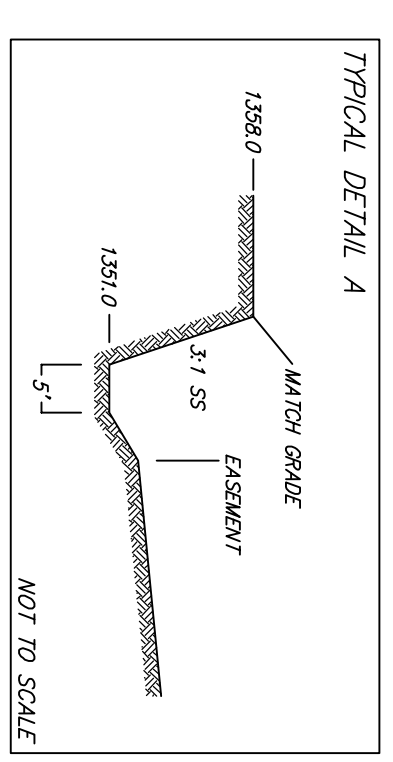
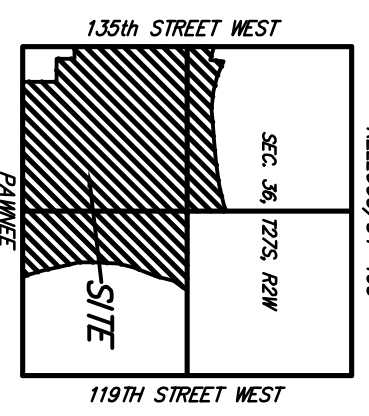

DATE OF REVISION: 20 JUNE 2005
DATE OF THROUGH: 05 JAN 2004
COMPAR MEASUREMENTS = 1 FOOT

Basin ID	Area acres	Existing Flowrates		Developed Flowrates	
		2-yr cfs	5-yr cfs	2-yr cfs	5-yr cfs
1	0.5	0.9	1.1	2.1	1.0
2	1.3	2.2	3.0	5.6	2.6
3	1.3	6.0	8.9	16.0	7.5
4	2.0	3.4	4.8	8.5	4.0
5	5.5	9.5	13.4	24.1	11.4
6	0.8	1.0	1.4	2.6	1.2
7	1.2	2.1	2.7	5.1	2.4
8	1.2	2.1	2.7	5.1	2.4
9	0.8	1.0	1.4	2.6	1.2
10	1.2	2.1	2.7	5.1	2.4
11	1.2	2.1	2.7	5.1	2.4
12	2.6	4.5	5.9	11.1	5.2
13	4.8	8.3	11.1	21.1	9.6
14	2.8	4.8	6.4	12.2	5.6
15	5.6	9.7	13.2	24.4	11.4
16	1.4	2.4	3.2	6.0	2.8
17	1.2	2.1	2.7	5.1	2.4
18	2.2	4.2	5.5	10.2	4.8
19	1.1	1.9	2.6	4.8	2.3
20	1.2	2.1	2.7	5.1	2.4
21	1.2	2.1	2.7	5.1	2.4
22	1.5	2.6	3.4	6.4	3.0
23	5.3	9.1	12.2	23.1	11.3
24	5.3	9.5	13.2	24.4	11.4
25	4.5	8.3	11.1	21.1	9.6
26	4.5	8.3	11.1	21.1	9.6
27	2.2	3.8	5.0	9.4	4.4
28	1.2	2.1	2.7	5.1	2.4
29	1.4	2.4	3.2	6.0	2.8
30	1.8	3.1	4.1	7.7	3.6
31	0.8	1.0	1.4	2.6	1.2
32	2.3	4.0	5.2	9.8	4.6
33	4.5	7.9	10.6	20.6	9.7
34	4.5	7.9	10.6	20.6	9.7
35	1.3	2.2	3.0	5.6	2.6
36	4.0	6.9	9.1	17.7	8.0
37	1.4	2.4	3.2	6.0	2.8
38	1.2	2.1	2.7	5.1	2.4
39	0.4	0.7	0.9	1.7	0.8
40	1.5	2.6	3.4	6.4	3.0
41	1.5	2.6	3.4	6.4	3.0
42	1.8	3.1	4.1	7.7	3.6
43	1.5	2.6	3.4	6.4	3.0
44	2.1	3.6	4.8	9.0	4.2
45	1.1	1.9	2.5	4.7	2.2
46	1.5	2.6	3.4	6.4	3.0
47	0.8	1.0	1.4	2.6	1.2
48	2.0	3.4	4.5	8.5	4.0
49	2.3	4.0	5.2	9.8	4.6
50	0.8	1.0	1.4	2.6	1.2
51	3.0	5.2	6.8	13.3	6.0
52	7.7	13.3	18.0	35.3	15.9
53	2.0	3.4	4.5	8.5	4.0
TOTAL	202	349	481	885	403

NOTE: FEMA Floodplain scaled per location per FEMA FIRM 200321 02004, Effective Date June 3, 1996.

Base Flood Elevations and Cross Sections determined per HEC-2 modeling previously submitted with Turkey Creek 2nd Addition. A Floodplain Fill Permit will be obtained from the Kansas Department of Water Resources prior to development on lots in the Floodplain, as established by the HEC-2 model.

20 JUNE 2005

B Baughman Company, P.A.
1515 S.W. 15th St., Wichita, KS 67211 | 781.626.2111 | F3136260149

Baughman
KANSAS ENGINEERING | SURVEYING | PLANNING | DESIGN | CONSTRUCTION