

Existing Site and Offsite Runoff								
Block #	Acres	Tc	C5	I5	C100	I100	Q5	Q100
Area 1	0.24	15.0 min	0.22	4.56	0.41	7.37	0.24cfs	0.73cfs
Area 2	3.97	15.0 min	0.22	4.56	0.41	7.37	3.98cfs	12.00cfs
Area 3	1.01	15.0 min	0.22	4.56	0.41	7.37	1.01cfs	3.05cfs
Keith drain Area	11.63	47.3 min	0.46	2.55	0.65	4.35	13.08cfs	31.54cfs
Westfield Drain Area	13.54	45.2 min	0.46	2.55	0.65	4.35	13.54cfs	38.12cfs
Total Runoff=							31.85cfs	85.44cfs

Proposed Site and Offsite Runoff								
Block #	Acres	Tc	C5	I5	C100	I100	Q5	Q100
Lot 1	1.41	15.0 min	0.69	4.56	0.80	7.37	4.44cfs	8.31cfs
Lot 2	1.85	15.0 min	0.69	4.56	0.80	7.37	5.82cfs	10.91cfs
Lot 3	1.96	15.0 min	0.69	4.56	0.80	7.37	6.16cfs	11.56cfs
Keith drain Area	11.63	47.3 min	0.46	2.55	0.65	4.35	13.08cfs	31.54cfs
Westfield Drain Area	13.54	45.2 min	0.46	2.55	0.65	4.35	13.54cfs	38.12cfs
Total Runoff=							43.04cfs	100.44cfs

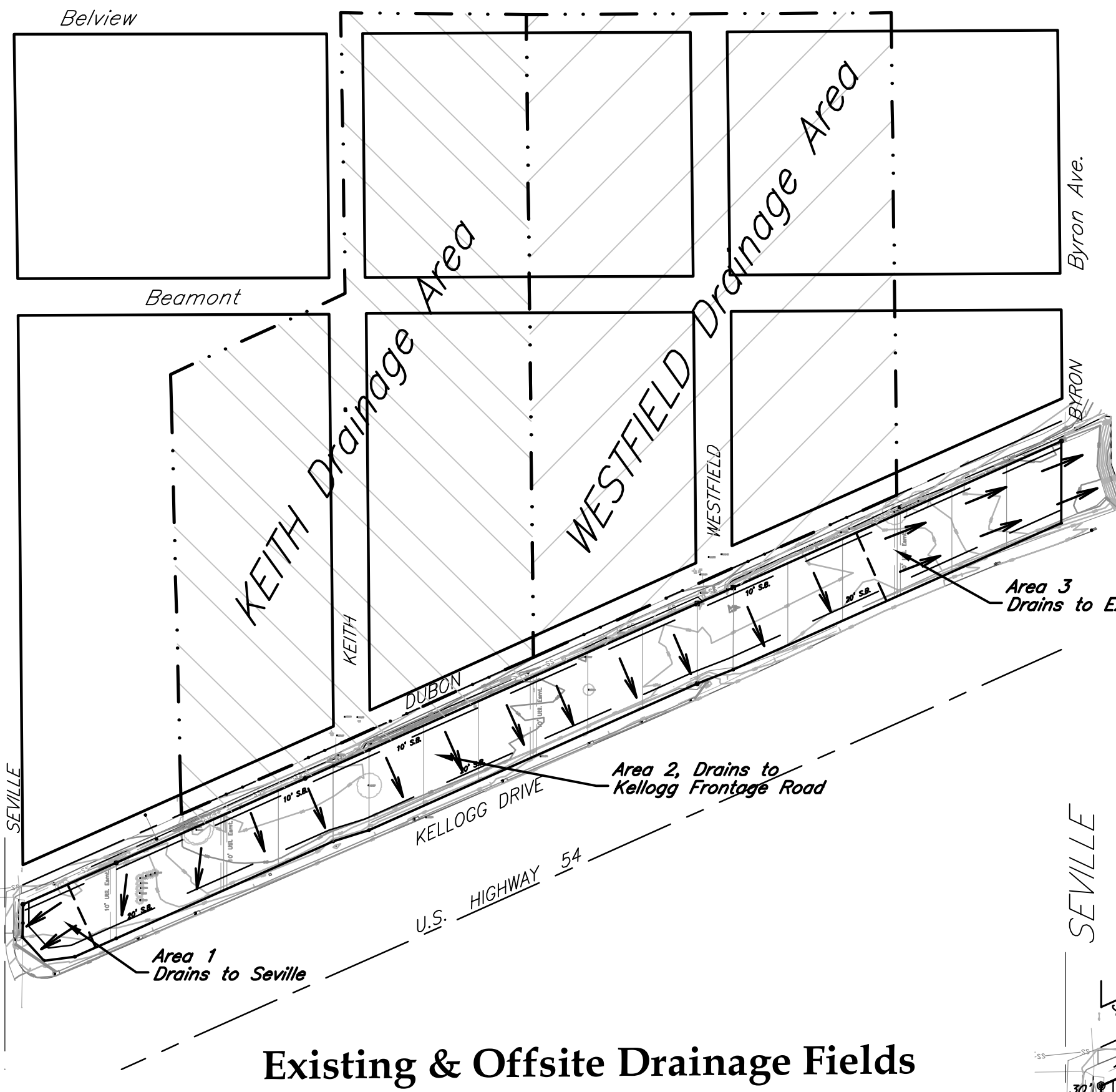

Existing & Offsite Drainage Fields

OWNER: John E. and Marilyn Dugan and John E. Dugan Family Partnership, L.P.

AREA: 5.22 acres (On Site)

Upstream Area:  
2 Drainage areas drain across site  
Keith & Westfield Areas drain across site  
from North to South. Picked up by ex.  
area inlets. Flow values listed below.

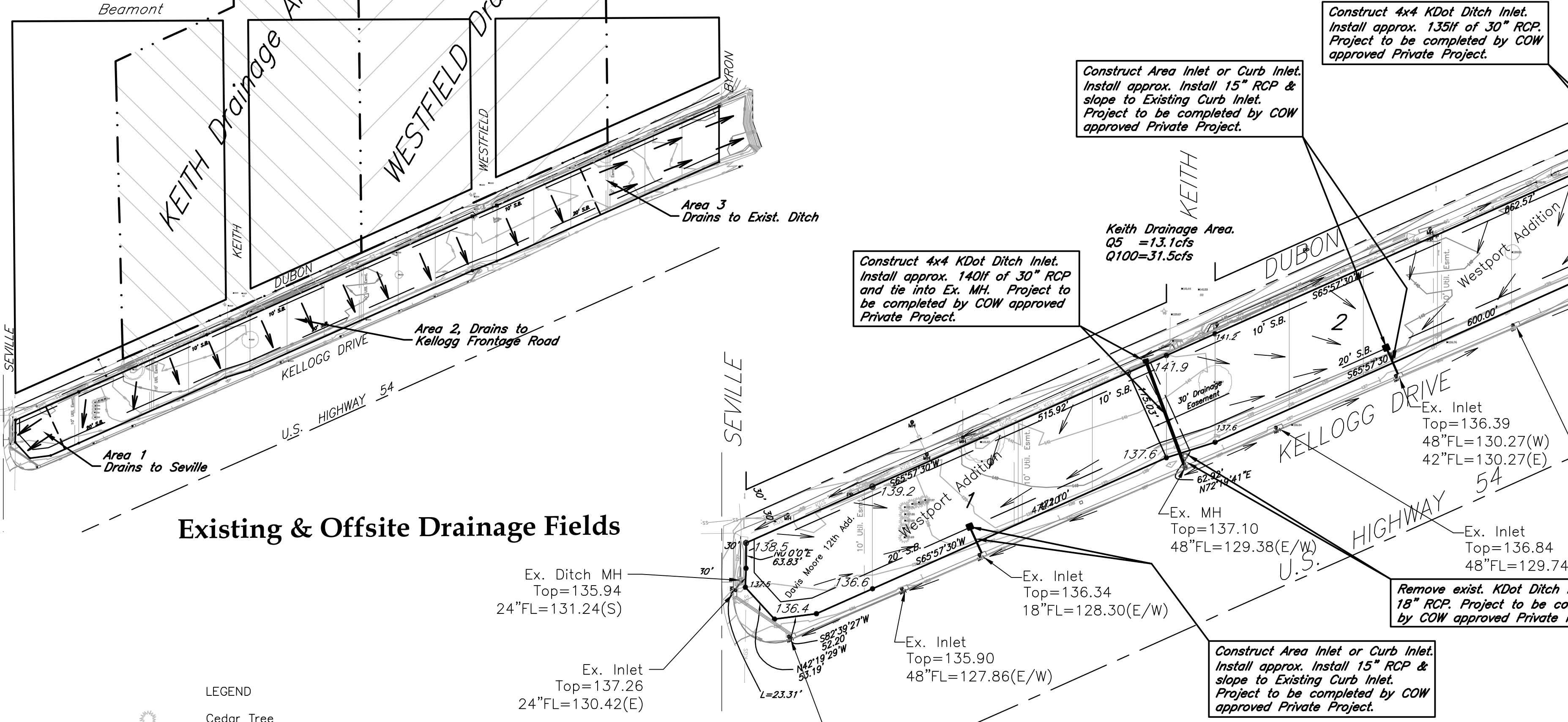

Proposed Drain

**LEGEND**

- Cedar Tree
- Fire Hydrant
- Light Pole
- Manhole
- Power Pole
- Sign
- Tree
- Water Valve
- Kansas Gas Service Line
- Sanitary Sewer
- Fence
- 1/2" Rebar (found) PEC LS #65
- 1/2" Rebar (found)
- 5/8" Rebar (found)
- 3/4" Iron Pipe (found)
- 3/4" Pinched Iron Pipe (found)

( IN FEET )  
1 inch = 100 ft.

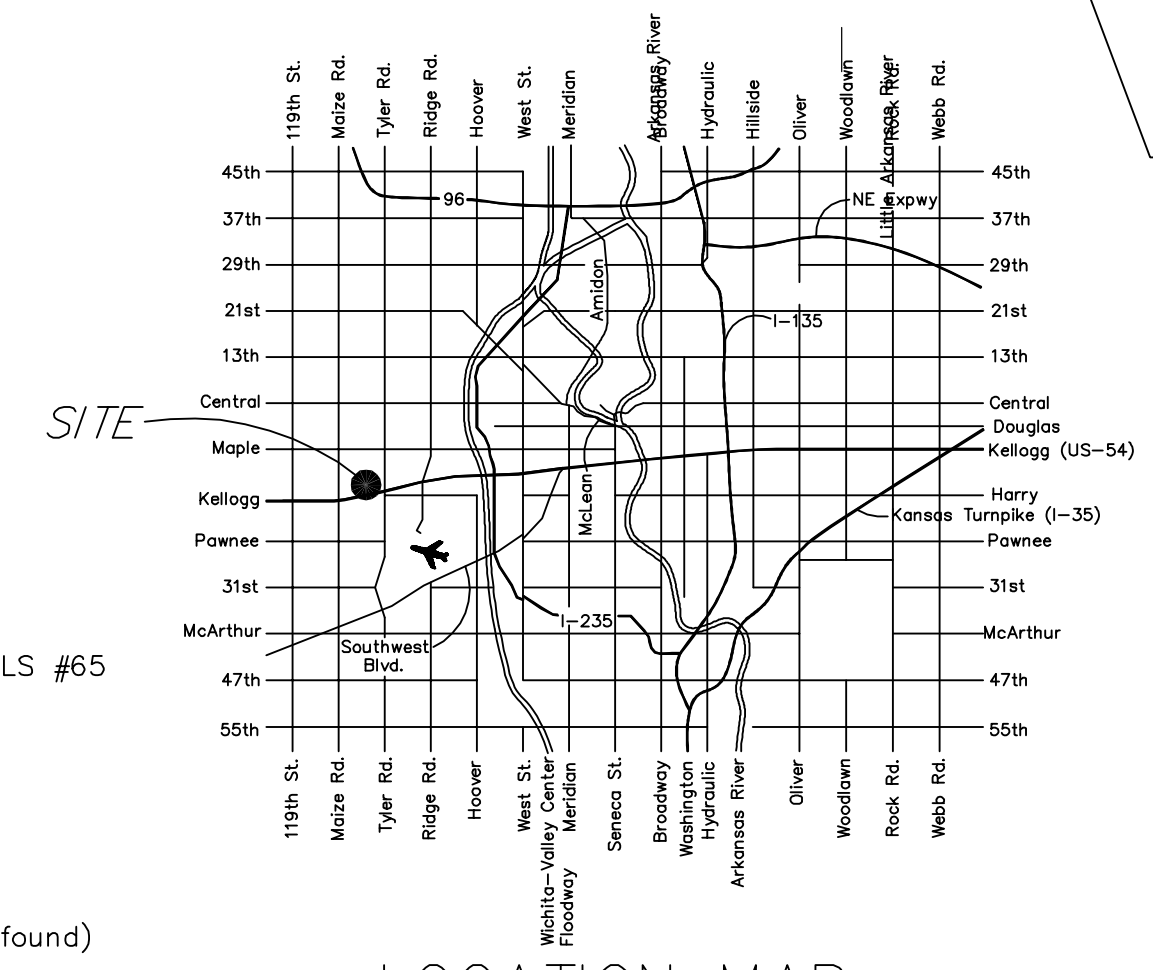

LOCATION MAP