

NOTES:

- BENCH MARK:
SQ. CUT ON N.E. CORNER OF R.O.B. 900' N. OF E. 1/4
COR. SECTION 30 T269 R2E ELEV. 185.30.
- RESERVE "A" IS FOR GOLF COURSE, LANDSCAPING, DRNG., ENTRY MONUMENTS,
FOUNTAINS, OPEN SPACE, SIDEWALKS, AND UTILITIES (IN DEFINED ESM'T.).
- RESERVE "B" IS FOR THE SAME USES IN RESERVE "A" PLUS PARKING BUT NOT
INCLUDING FOUNTAINS, ENTRY MONUMENTS, AND GOLF COURSE.
- RESERVE "C" IS FOR LANDSCAPING, ENTRY MONUMENTS, AND GUARD HOUSE.
- RESERVE "D" IS FOR LANDSCAPING, UTILITIES, DRNG., WALLS, ENTRY
MONUMENTS, PARKING, AND GUARD HOUSE.
- A DRAINAGE CONCEPT HAS BEEN PREPARED BY MID-KANSAS ENGINEERING
CONSULTANTS.

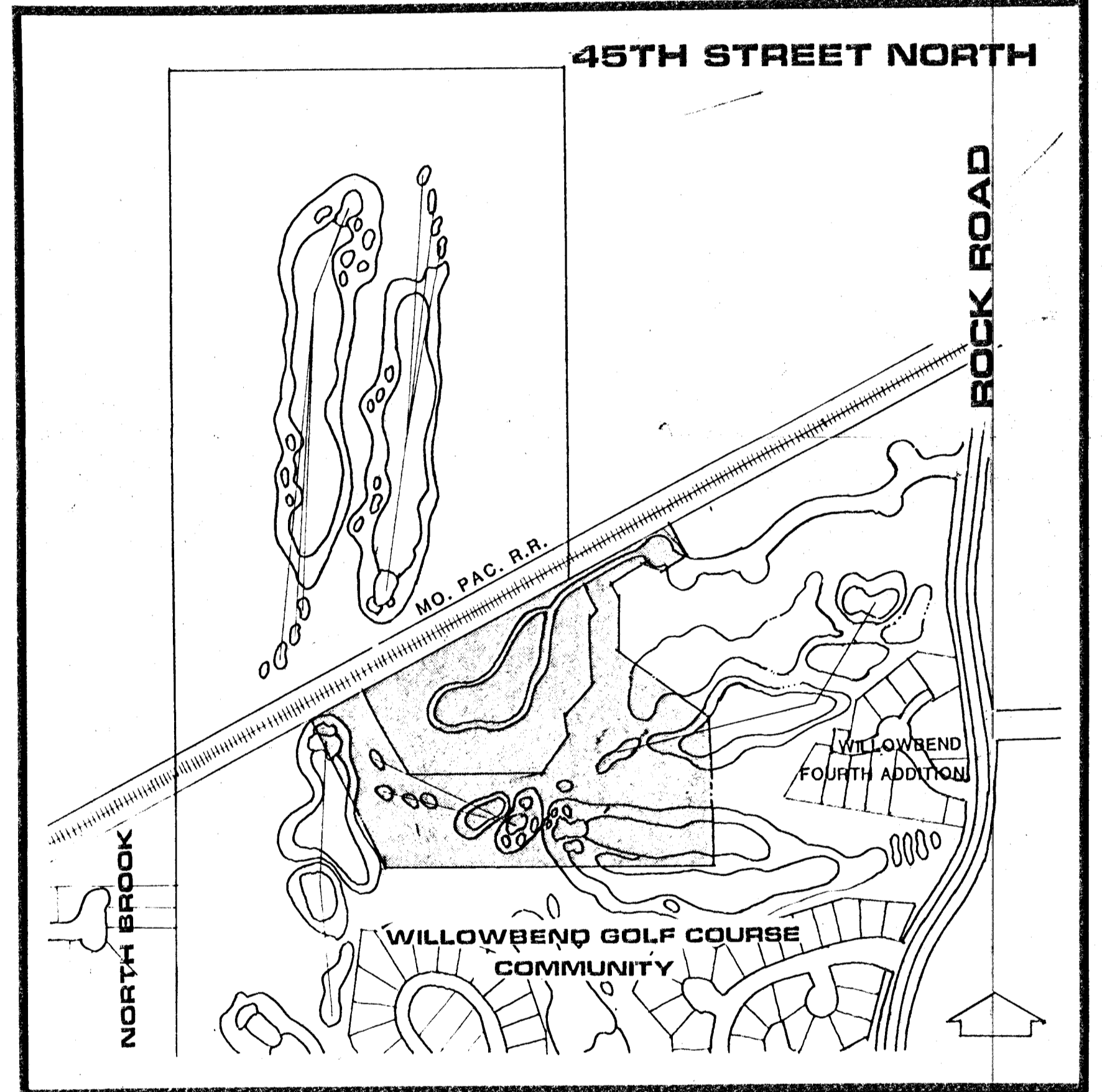

LOCATION MAP

SCALE: 1" = 400'

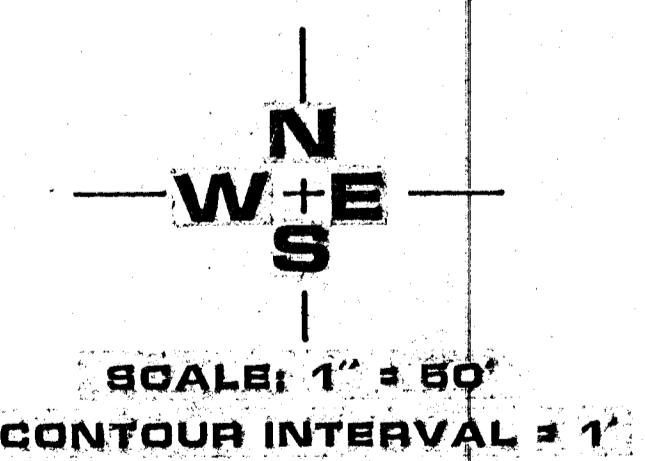

PRELIMINARY PLAT

WILLOWBEND HEIGHTS

OWNER: GOLF COURSES OF AMERICA 4110 N. TARA CIRCLE WICHITA, KS, 67228

DATE: JULY 31, 1987

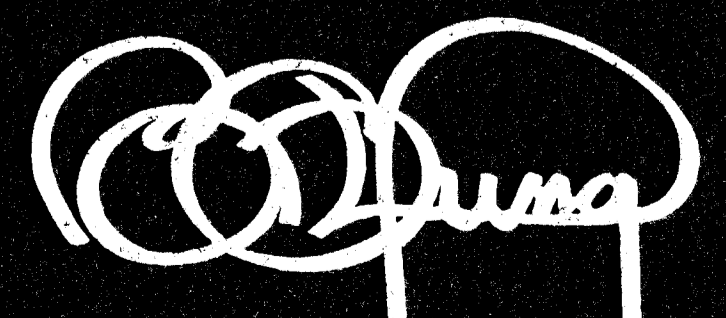

BILL G. YUNG DESIGN
4912 E. 29TH STREET NORTH WICHITA, KS 67220 318-683-5567