

# PRELIMINARY PLAT

WILLIAMSBURG ADDITION  
Wichita, Sedgwick County, Kansas.

OWNER: KANSAS GENERAL PROPERTIES  
90 William E. Morin  
555 N. Woodlawn, Bldg. 1,  
Wichita, Kansas 67208  
Teleph. (316) 621-2171

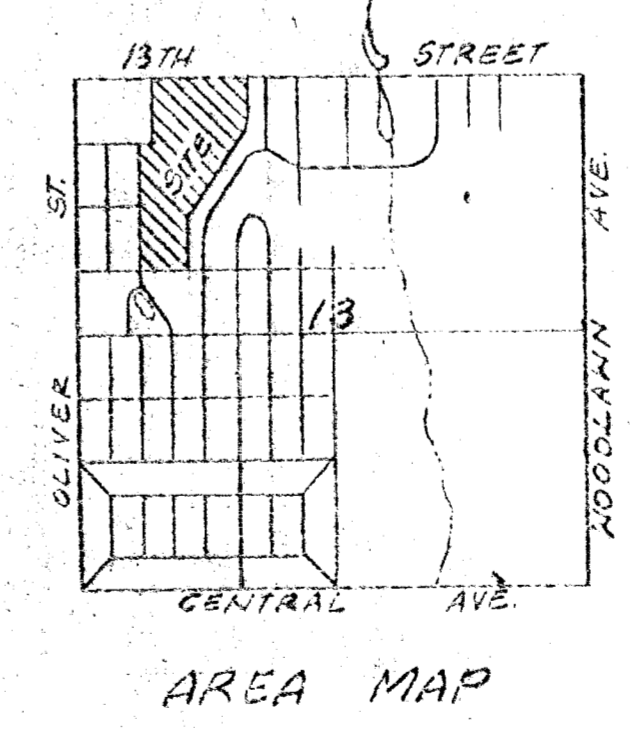

ASSUMED BE PLAT  
SURVEYING MAP OF LANDS LOCATED AT  
N.W. 1/4 SECTION 13, 27S./1E.,  
SEDGWICK COUNTY, KANSAS  
SURVEYING & ENGINEERING  
P. E. C. ALLIED LABORATORIES

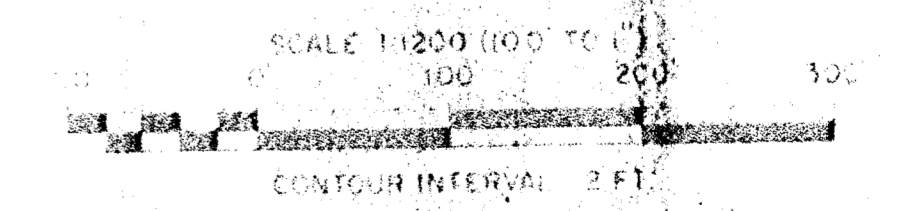

PHOTO SURVEY BY  
S. A. P. HISTO SURVEY  
AND ASSOCIATES  
1115 N. W. 10th St.  
WICHITA, KANSAS 67202

AERIAL PHOTOGRAPHY  
THREE VERTICAL AIR PHOTOGRAPHS  
DATE OBTAINED 4-22-68

Moore  
5012 E 9th  
Water Sealing