

SCALE: 1" = 100'

CITY B.M. DISC. 44'W & 42'N OF
 E'S HYDRAULIC ST & 43RD ST SO.
 ELEVATION 82.111
 CITY DATUM
 DATE OF TOPO: JULY 14, 1980
 Note:
 For street grades see
 Drainage Concept Plan.

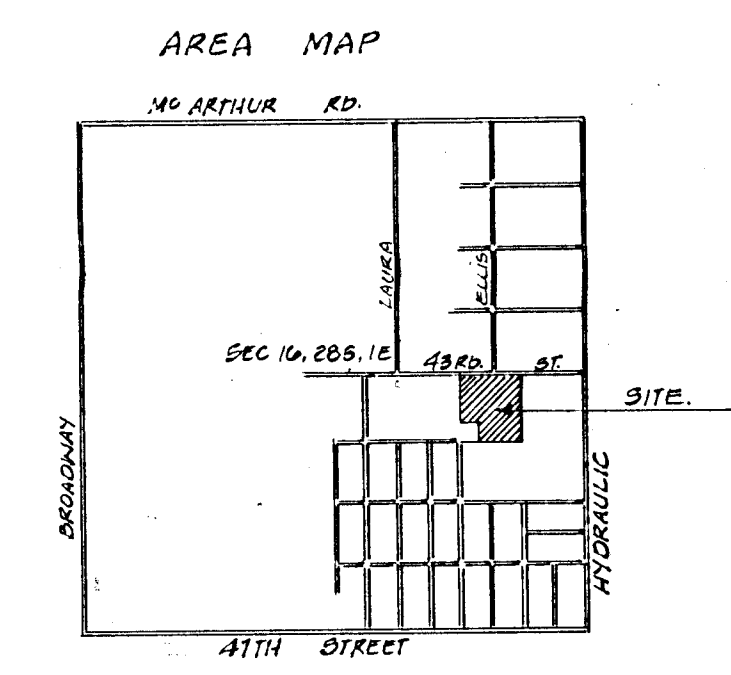

OWNER: Dale E. Wood
 906 N. Arapaho
 Wichita Ks.
 SUBDIVIDER: William B. Livingston and Thomas R. Gossen
 420 S. Emporia
 Wichita Ks.
 ENGINEER: Professional Engineering Consultants
 1440 E. English
 Wichita Ks.

CAROL JEAN 2ND ADDITION

PRELIMINARY PLAT

Utilities:
 Power: 7.2 K.V., 34, 2 wire on South Line of
 43rd St So. (K.G. & E.)
 Gas: 4" L.L.P. Gas Main to South of N. E. of 43rd (Gas Service)
 Water: 8" A.C. Water Main to South of N. E. of 43rd (City of Wichita)
 TELEPH: Overhead Service on South side of 43rd
 Street (Southwestern Bell)
 SEWER: As shown (City of Wichita)