

93RD ST. NO.

135TH ST WEST

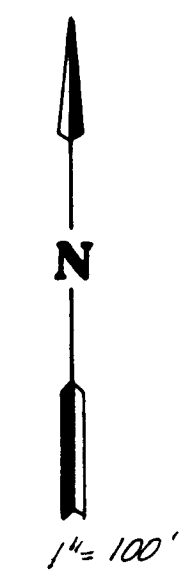

Bench mark:
Top of iron in thimble at the
south 1/4 corner of Sec. 23
Elevation = 1379.91 M.S.L.

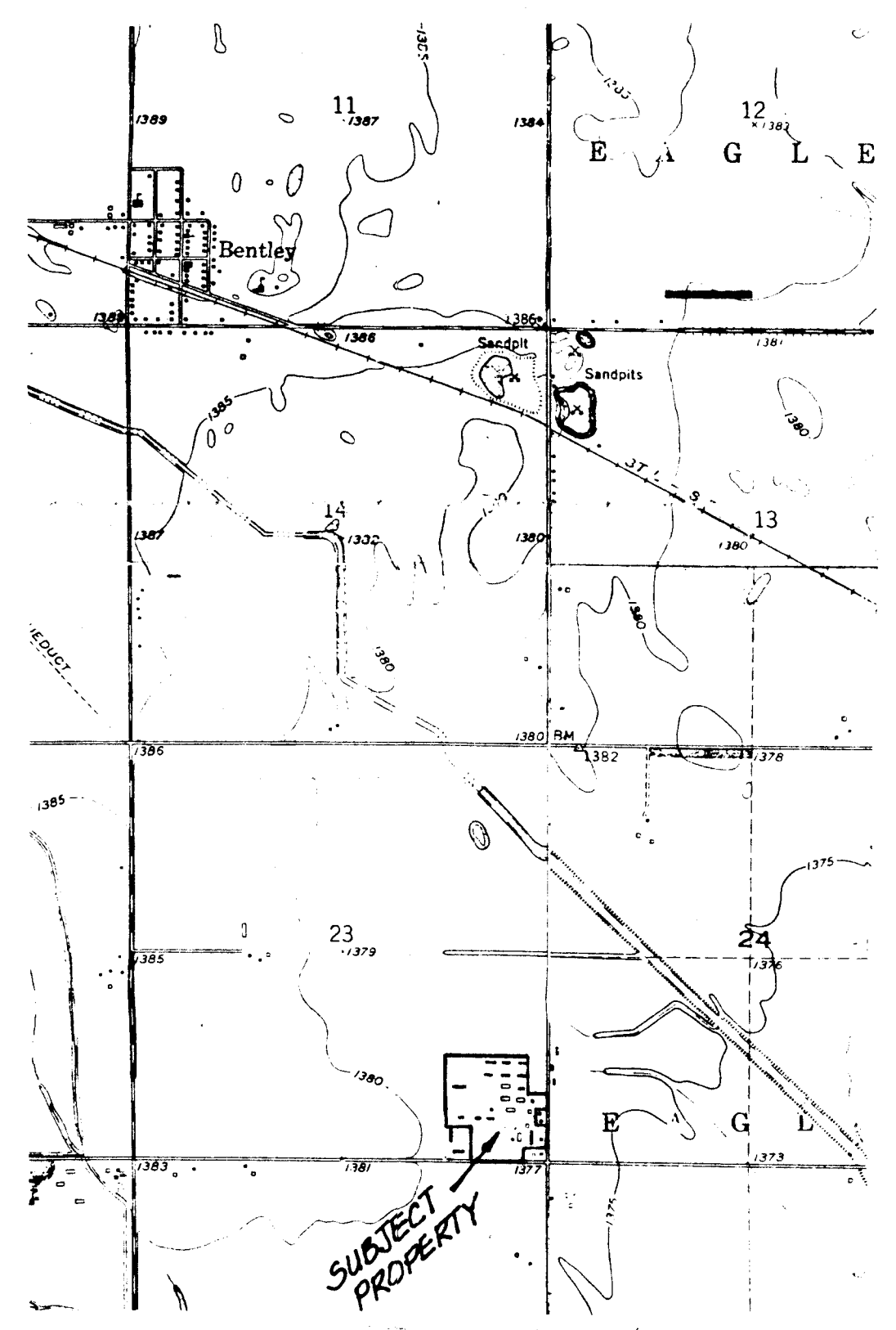

Vicinity Plat
1" = 200'

PRELIMINARY PLAT
COOMBS FARM ADDITION

Part of the S.E.1/4 of the S.E.1/4
of Sec. 23, Twp. 25-S, R-2-W

Owner:
Kansas Investment Corp.