

PRELIMINARY PLAT
CALDWELL EQUIPMENT ADDITION
 SEDGWICK COUNTY, KANSAS

OWNER:
 Sig Caldwell
 Caldwell Equipment Co.
 1210 S. West Street
 Wichita, KS 67213
 Ph. - 316-942-2215

LEGAL DESCRIPTION:

A tract of land in the NE 1/4 of Section 9, Twp. 28S., R.1 W. of the Sixth P.M. described as commencing at the SE corner of said NE 1/4; thence N01°22'06"W (assumed bearing) along the east line of said NE 1/4, 1196 feet for a Point of Beginning; thence at right angles to the east line of said NE 1/4 on a bearing of S88°37'54"W, 600 feet; thence N01°22'06"W parallel to and 600 feet distant from the east line of said NE 1/4, 806.56 feet to a point on the south line of the Atchison, Topeka, & Santa Fe (A.T. & S.F.) Railroad right-of-way; thence N73°09'44"E along the south line of said A.T. & S.F. Railroad tract, 191.43 feet to the NW corner of the A.T. & S.F. Railroad tract as set forth in Deed Book 217, Page 251; thence at right angles to said A.T. & S.F. right-of-way on a bearing of S16°30'15"E along the westerly line of said A.T. & S.F. Railroad tract, 50 feet to the SW corner thereof; thence N73°09'44"E parallel to and 50 feet distant from said A.T. & S.F. Railroad right-of-way along the southerly line of said A.T. & S.F. Railroad tract extended, 417.29 feet to a point on the east line of said NE 1/4; thence S01°22'06"E along the east line of said NE 1/4, 920.73 feet to the Point of Beginning. Said tract contains 512,542.28 sq. ft. or 11,768 Acres, more or less, subject to road right-of-ways and easements of record.

BENCHMARK:
 Ridge Road & K-42 Highway, City of Wichita Disc, 60.5' NNW of centerline K-42 asphalt and concrete pavement, 48' ENE of centerline of Ridge Road extended, 2.5' NE of P.P., 0.5' below ground level.
 Elevation = 124.416 City Datum

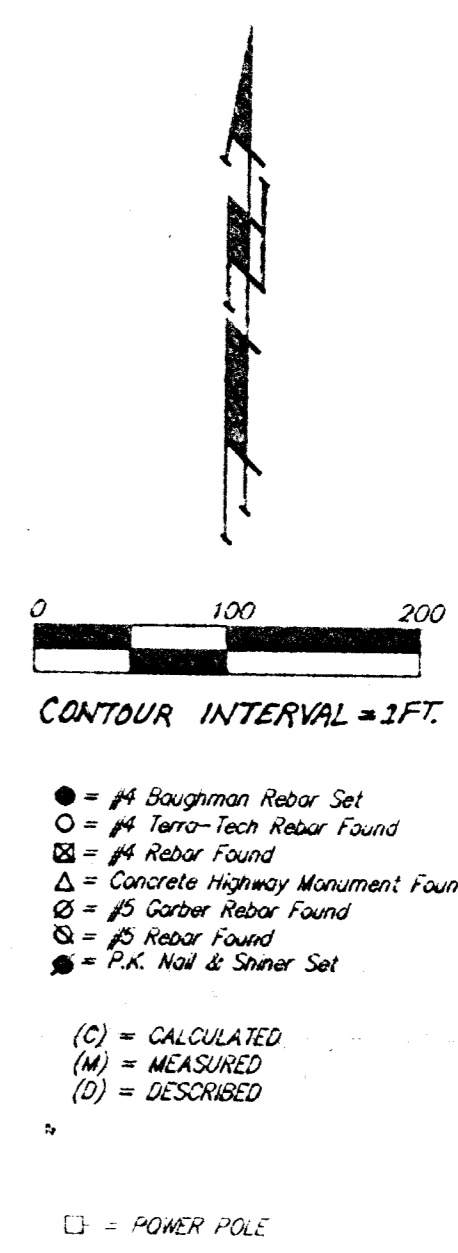

- = #4 Baughman Iron Set
 - = #4 Iron-iron Stake Found
 - ⊙ = #4 Iron Found
 - ⊠ = Concrete Highway Monument Found
 - ⊞ = #5 Corner Stake Found
 - ⊚ = #5 Iron Found
 - ⊛ = P.C. Nail & Stake Set
- (C) = CALCULATED
 (M) = MEASURED
 (D) = DESCRIBED
- ☐ = POWER POLE

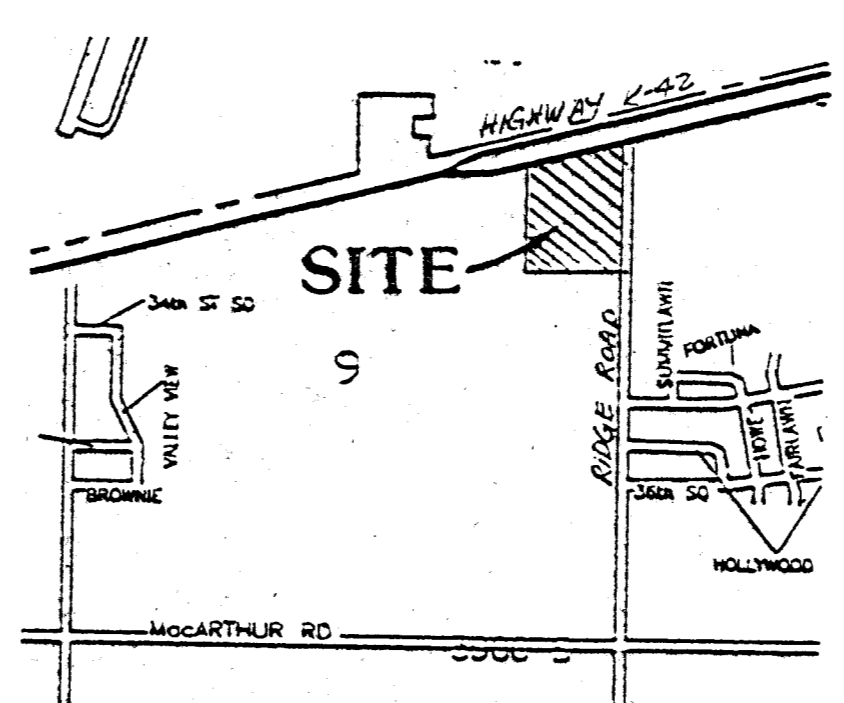

VICINITY MAP

