

E 284
L34 MA SWI

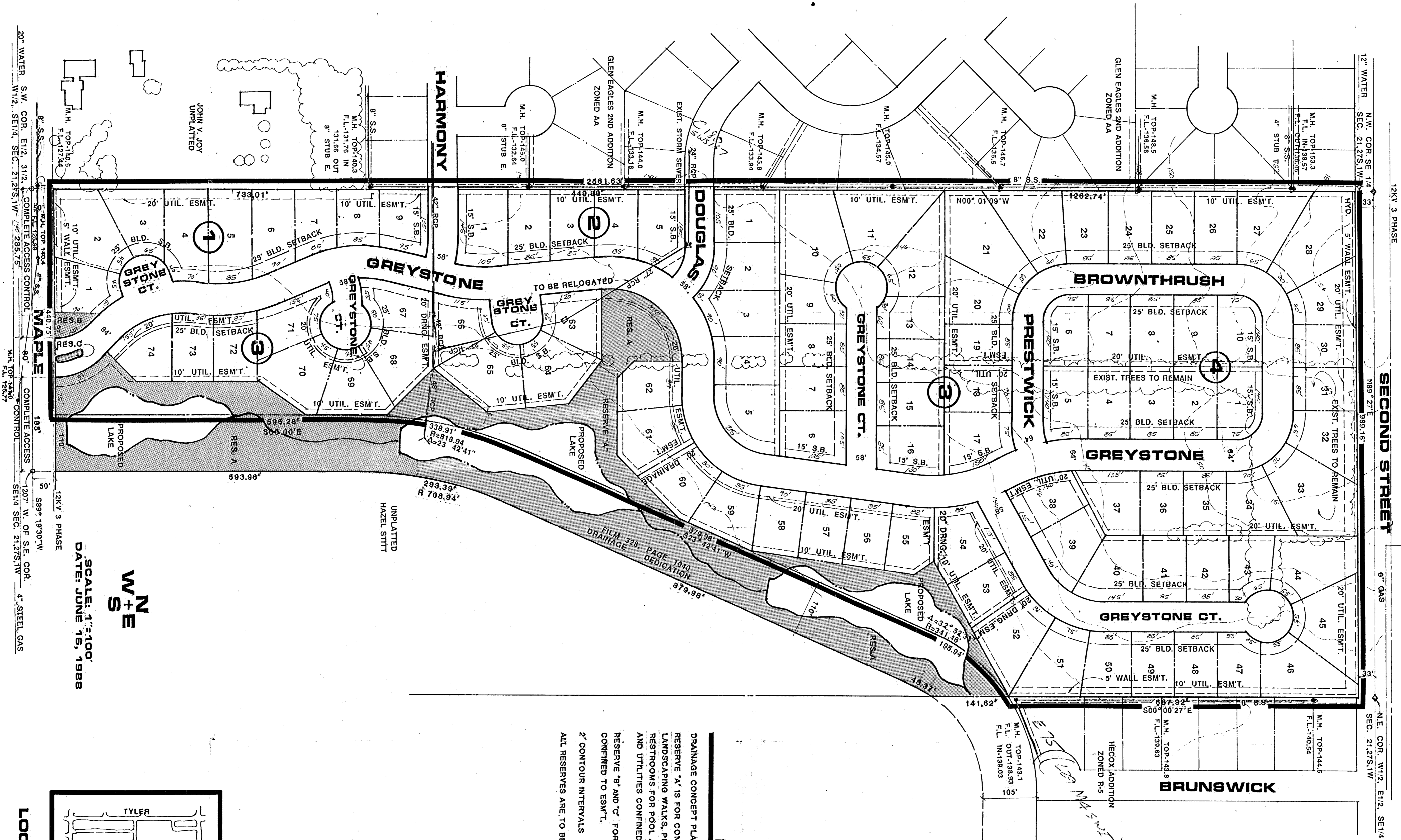

12" WATER N.W. COR. SE 1/4 SEC. 21.27S.1W
 12" WATER SEC. 21.27S.1W
 12KV 3 PHASE
 189' 27" 999.16'
 8" GAS
 N.E. COR. W1/2. E1/2. SE1/4 SEC. 21.27S.1W
 12KV 3 PHASE
 189' 27" 999.16'
 12KV 3 PHASE
 189' 27" 999.16'
 12KV 3 PHASE
 189' 27" 999.16'
 12KV 3 PHASE
 189' 27" 999.16'
 12KV 3 PHASE
 189' 27" 999.16'

SCALE: 1"=100'
 DATE: JUNE 16, 1988
 N
 W+
 S
 E

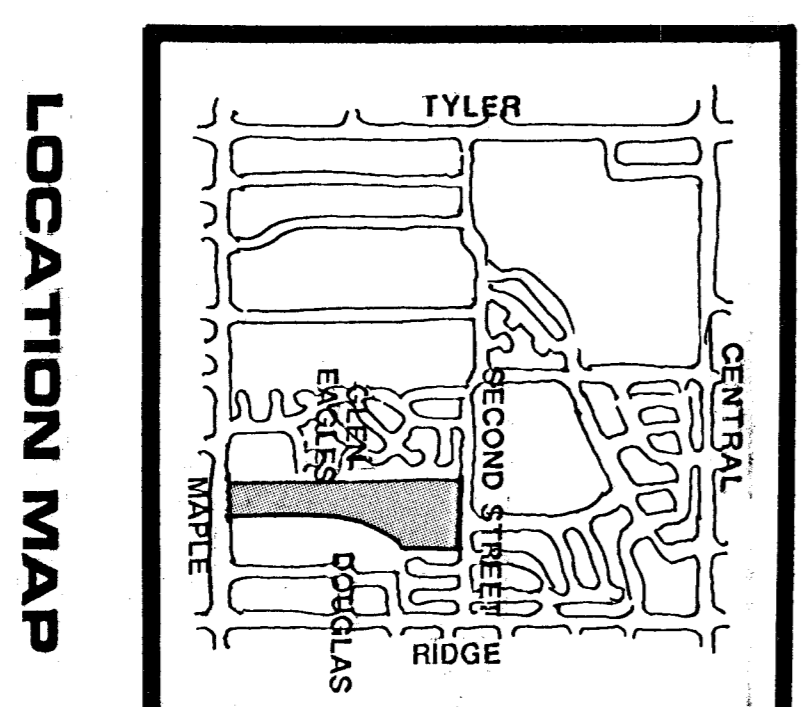

NOTES

DRAINAGE CONCEPT PLAN TO BE PREPARED BY P.E.C.
 RESERVE 'A' IS FOR CONSTRUCTION OF LAKES AND RELATED STRUCTURES
 LANDSCAPING WALKS, PRIVATE POOL WITH OFF STREET PARKING GAZEBOS,
 RESTROOMS FOR POOL AREA, RECREATION EQUIPMENT, TENNIS
 AND UTILITIES CONFINED TO ESM'TS.
 RESERVE 'B' AND 'C' FOR LANDSCAPING ENTRY MONUMENTS AND UTILITIES
 CONFINED TO ESM'T.
 2' CONTOUR INTERVALS
 ALL RESERVES ARE TO BE OWNED AND MAINTAINED BY A HOMEOWNERS ASSOCIATION

MSB
 (MA)

PRELIMINARY PLAT
GREYSTONE ADD.

OWNER: J. W. RUSSELL 443 N. MAIZE ROAD, WICHITA, KS. 67212 PH. 722-2417