

BROCK THIRD ADDITION:

Area = 1.21 Acres
Zoning = LC

BROCK FOURTH ADDITION:

Area = 2.43 Acres
Zoning = LC

OWNER:

Patice Properties, LLC
243 Portlock Road
Honolulu, HI 96825

SURVEYOR/ENGINEER:

Babar M. Khan
Municipal Engineers, P.A.
254-Laura, Suite 201
Wichita, Kansas 67211

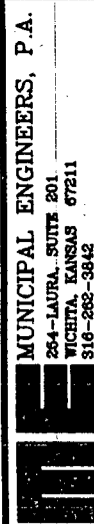
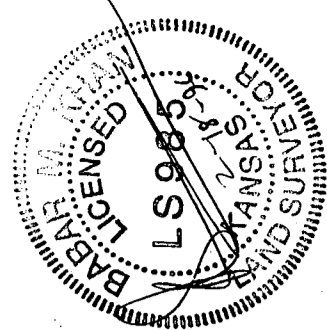

VICINITY MAP BROCK THIRD & FOURTH ADDITION TO WICHITA SEDGWICK COUNTY, KANSAS

