

MISSOURI PACIFIC RAILROAD Co.

6400 MARTIN AVENUE

KANSAS CITY, MISSOURI 64120

TEL. AREA CODE 816 245-2300

E. C. MAY
GENERAL MANAGER
P. L. TUCKER
ASSISTANT GENERAL MANAGER

M. F. KELLY
GENERAL SUPERINTENDENT
T. L. GIBSON
DISTRICT ENGINEER
B. W. WIGGANS
MECHANICAL SUPERINTENDENT

J. A. ANTHONY
DISTRICT MANAGER
CONTRACTS, LAND AND LEASES
H. M. DICKSON
MANAGER
ADMINISTRATIVE SERVICES

January 20, 1984

File: G 104-W-4

Mr. Michael E. Lindebak
City Engineer
City of Wichita, Kansas
455 North Main Street
Wichita, KS 67202

Dear Mr. Lindebak:

Reference is made to your letter of December 6, 1983, regarding the Century II Utility Relocation, PEC Project No. 34-83105-042. You indicated that the City desired to remove our tracks in Waterman Street between Wichita Street and Water Street to install two pipe lines by the open cut method.

This will acknowledge receipt of your letter. We are presently reviewing the proposal and will furnish additional comments at a later date.

Yours truly,

James A. Anthony

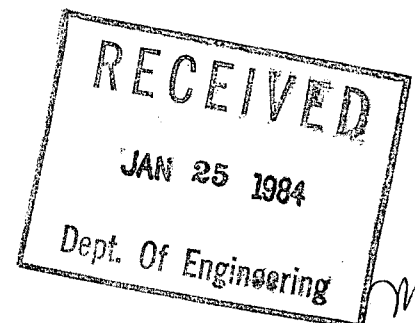

WICHITA—SEDGWICK COUNTY

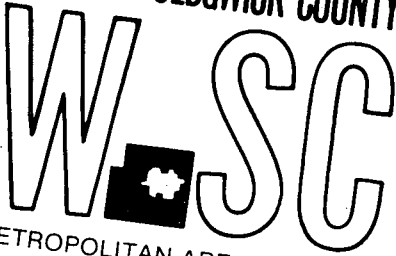

METROPOLITAN AREA PLANNING
DEPARTMENT

CITY HALL — TENTH FLOOR
455 NORTH MAIN STREET
WICHITA, KANSAS 67202
(316) 268-4561

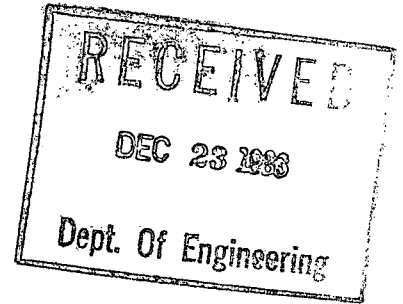

December 23, 1983

Professional Engineering Consultants, P.A.
Attention: Gary Wiley
1440 E. English
Wichita, Ks. 67211

Re: S/D 83-83 - Final plat of Civic Center South 2nd Addition

Dear Mr. Wiley:

At the regular meeting of the Subdivision Committee of the Metropolitan Area Planning Commission, December 22, 1983, the above-captioned plat was considered. The action of the Committee was to recommend that this plat be approved subject to:

- A. Satisfactory arrangements shall be made to abandon or relocate all utilities which are not to be retained within utility easements. These utilities include storm water sewer, sanitary sewer, water, gas, and electric.
- B. Closure computations shall be submitted with the final plat tracing.
- C. Recording of the plat within 30 days after approval by the Board of City Commissioners.

The enclosed "marked" copy of the final plat is for your information and files.

This matter will be forwarded to the Planning Commission for its consideration on January 12, 1984, at 1:30 p.m. If you have any questions concerning this matter, please call.

Sincerely,

Louise Olivarez
Senior Planner
LO:bh

cc: James F. Clancy, Director of Community Facilities
+ Mike Lindebak, City Engineer

Final plat
SUBDIVISION REPORT

SUBDIVISION COMMITTEE
METROPOLITAN AREA
PLANNING COMMISSION

S/D No. 83-83 Name Civic Center South 2nd Addition
Date Application Rec'd. 9-29-83 Preliminary Approval 10-13-83
Scheduled S/D Meeting 12-22-83

DESCRIPTION

General Location Between English and Waterman, east of Wichita Street

Owner City of Wichita (James F. Clancy, Director of Community Facilities)
Surveyor/Engineer Professional Engineering Consultants (Gary Wiley)
Address 1440 E. English, Wichita, Ks Zip Code 67211 Phone 262-2691

- | | |
|---|--|
| 1. Gross Acreage of Plat <u>3.50 ac+</u> | 7. Lineal Feet of New Street |
| 2. Number of Lots : | a. <u> </u> R/W <u> </u> ft. |
| Residential <u> </u> | b. <u> </u> R/W <u> </u> ft. |
| Commercial <u> </u> | c. <u> </u> R/W <u> </u> ft. |
| Industrial <u> </u> | d. <u> </u> R/W <u> </u> ft. |
| Other <u>1="D"</u> (Central Business District) | e. <u> </u> R/W <u> </u> ft. |
| Total Number of Lots <u>1</u> | TOTAL <u>-0-</u> New <u> </u> ft. |
| 3. Minimum Lot Frontage <u>300 ft. ±</u> | 8. Sidewalk adjacent to all |
| 4. Minimum Lot Area <u>3.47 ac ± (151,209'±)</u> | streets <u>X</u> yes <u> </u> no |
| 5. Existing Zoning <u>"D"</u> | |
| 6. Proposed Zoning <u>"D"</u> | |
| 9. Is public water available <u>X</u> Yes <u> </u> No, Name <u>City of Wichita</u> | |
| 10. Is sanitary sewer available <u>X</u> Yes <u> </u> No, Name <u>City of Wichita</u> | |
| 11. Has Health Dept. approval been obtained (where applicable) <u> </u> Yes <u> </u> No | |
| 12. City of Wichita <u>X</u> 3-Mile Area <u> </u> Outside of 3-Mile Area <u> </u> | |

STAFF COMMENTS:

- A. Satisfactory arrangements shall be made to abandon or relocate all utilities which are not to be retained within utility easements. These utilities include storm water sewer, sanitary sewer, water, gas, and electric.
- B. Closure computations shall be submitted with the final plat tracing.
- C. Recording of the plat within 30 days after approval by the Board of City Commissioners.

WICHITA - SEDGWICK COUNTY

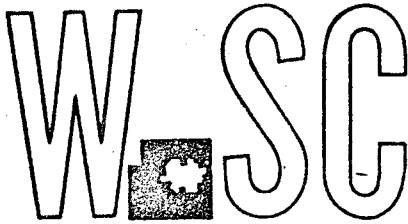

METROPOLITAN AREA PLANNING
COMMISSION

CITY HALL - TENTH FLOOR
455 NORTH MAIN STREET
WICHITA, KANSAS 67202
(316) 268-4561

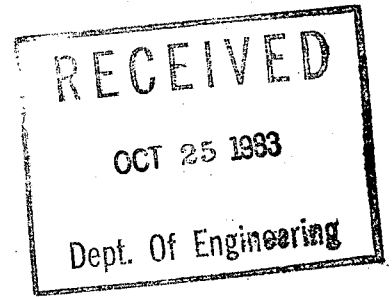

October 14, 1983

Professional Engineering Consultants, P.A.
Attention; Gary Wiley
1440 E. English
Wichita, Kansas 67211

Re: S/D 83-83 - Preliminary plat of Civic Center South
2nd Addition.

Dear Mr. Wiley:

At the regular meeting of the Subdivision Committee of the Metropolitan Area Planning Commission, October 13, 1983, the above-captioned plat was considered. The action of the Committee was to approve the preliminary and authorize preparation of the final plat, subject to the following:

- A. Satisfactory arrangements shall be made to abandon or relocate all utilities which are not to be retained within utility easements.
- B. It is proposed that the dedicated public portion of English Street terminate at the east line of this plat. Vehicular circulation will, however, be provided from that point north to the existing drive east of Century II. This dedicated portion of Wichita Street will terminate at the northwest corner of the plat but vehicular access can continue into the existing parking lot west of Century II. Some slight revisions may be necessary in the preliminary building layout plans to assure no building or loading dock encroachment into the Wichita Street right-of-way.
- C. The final plat shall indicate the necessary easements to cover the relocation of storm and sanitary sewers.
- D. The applicant shall install or guarantee installation of all utilities and facilities which are applicable and described in Article 8 of the Subdivision Regulations.
- E. Requirements for a final plat (see pages 20-25, Part 4, Article 5 of the MAPC Subdivision Regulations).

P.E.C., Attention: Gary Wiley
10-14-83 - Page 2

Enclosed herewith is the "marked" copy of the preliminary plat for your information and files.

If you should have any questions concerning this matter, please call.

Sincerely,

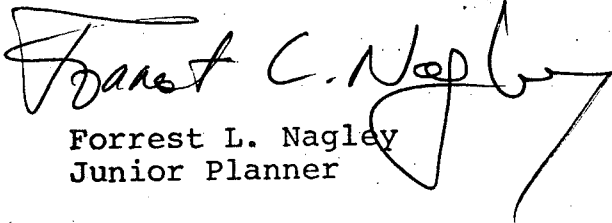

Forrest L. Nagley
Junior Planner

FLN:bh

cc: James Clancy, Director of Community Facilities
X Mike Lindebak, City Engineer
Ron Gott, First National Bank Bldg., 105 N. Main, 67202

P.E.C. Wants

Meeting with
Waterman

MOAAC & Santa Fe

1st

Wayne Isaac - 4867

Mo-Pac

Bill Summerville

816-245-2517

who was there 1st

Santa Fe

Jack Kelly

913-235-0041 Ext. 4473

JIM ANTHONY, DISTRICT MANAGER CONTRACTS

Missouri Pacific Railroad Co.

6400 Martin Ave

Kansas City, MO 64120

(816) 245-2517

ARKANSAS RIVER

\$10,000 ±

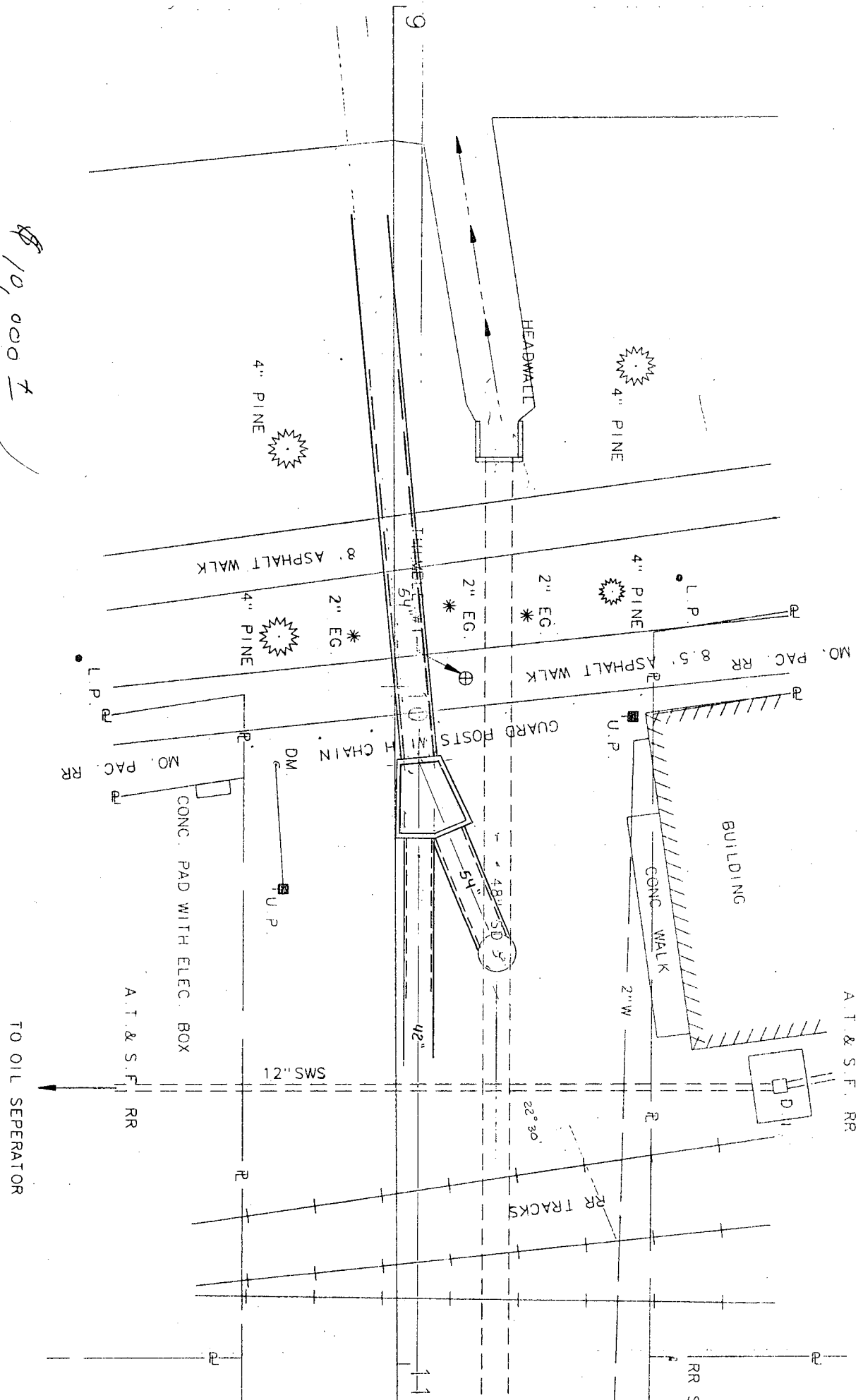

Preliminary plat
SUBDIVISION REPORT

of
SUBDIVISION COMMITTEE
METROPOLITAN AREA
PLANNING COMMISSION

S/D No. 83-83 Name Civic Center South 2nd Addition
Date Application Rec'd. 9-29-83 Preliminary Approval _____
Scheduled S/D Meeting 10-13-83

DESCRIPTION

General Location Between English and Waterman, east of Wichita Street

Owner City of Wichita (James F. Clancy, Director of Community Facilities)
Surveyor/Engineer Professional Engineering Consultants (Gary Wiley)
Address 1440 E. English, Wichita, Ks. Zip Code 67211 Phone 262-2691

- | | |
|--|--------------------------------|
| 1. Gross Acreage of Plat <u>3.50 ac +</u> | 7. Lineal Feet of New Street |
| 2. Number of Lots : | a. _____ R/W _____ ft. |
| Residential _____ | b. _____ R/W _____ ft. |
| Commercial _____ | c. _____ R/W _____ ft. |
| Industrial _____ | d. _____ R/W _____ ft. |
| Other <u>1-"D" (Central Business District)</u> | e. _____ R/W _____ ft. |
| Total Number of Lots <u>1</u> | TOTAL <u>-0-</u> New _____ ft. |
| 3. Minimum Lot Frontage <u>300 feet +</u> | 8. Sidewalk adjacent to all |
| 4. Minimum Lot Area <u>3.47 ac + (151,209'+)</u> | streets <u>X</u> yes _____ no |
| 5. Existing Zoning <u>"D"</u> | |
| 6. Proposed Zoning <u>"D"</u> | |
| 9. Is public water available <u>X</u> Yes _____ No, Name <u>City of Wichita</u> | |
| 10. Is sanitary sewer available <u>X</u> Yes _____ No, Name <u>City of Wichita</u> | |
| 11. Has Health Dept. approval been obtained (where applicable) _____ Yes _____ No | |
| 12. City of Wichita <u>X</u> 3-Mile Area _____ Outside of 3-Mile Area _____ | |

STAFF COMMENTS:

- A. Satisfactory arrangements shall be made to abandon or relocate all utilities which are not to be retained within utility easements.
- B. It is proposed that the dedicated public portion of English Street terminate at the east line of this plat. Vehicular circulation will, however, be provided from that point north to the existing drive east of Century II. This dedicated portion of Wichita Street will terminate at the northwest corner of the plat but vehicular access can continue into the existing parking lot west of Century II. Some slight revisions may be necessary in the preliminary building layout plans to assure no building or loading dock encroachment into the Wichita Street right-of-way.
- C. The applicant shall install or guarantee installation of all utilities and facilities which are applicable and described in Article 8 of the Subdivision Regulations.
- D. Requirements for a final plat (see pages 20-25, Part 4, Article 5 of the MAPC Subdivision Regulations).