

Bench mark:
North rim of M.H.
Elev. = 130.61 City Datum
Elev. = 1318.01 M.S.L.

West line of NE 1/4 15-27-1W

Scale 1" = 100'
North Declination
Reference: U.S.G.S.
T.S. Quad 109
Revised 1970 & 1975

SKETCH PLAT
CLUPNY ADDITION
A TRACT IN THE N.E. 1/4 OF 15-27-1W
OWNER: ALOYSIUS CLUPNY

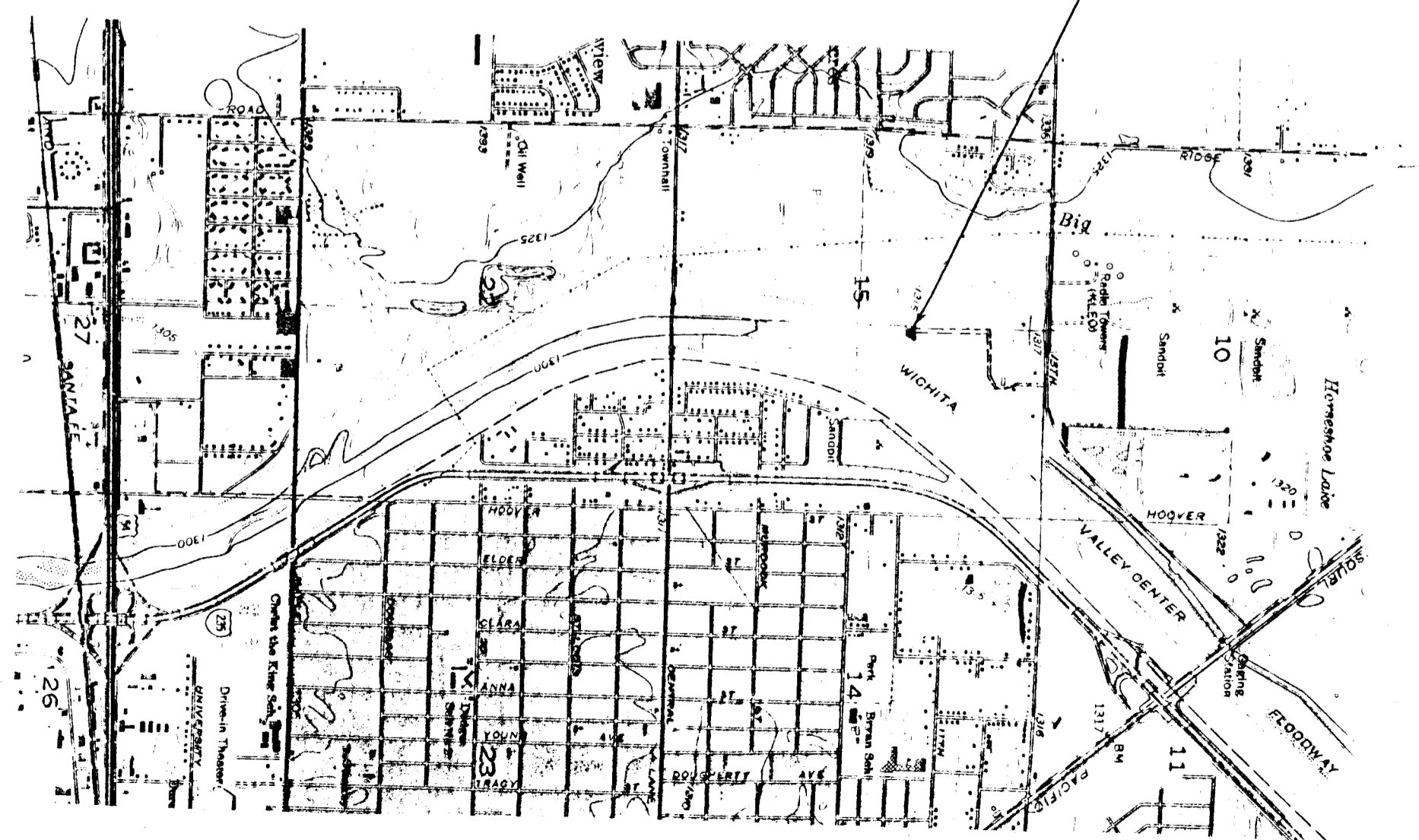

Kansas Gas & Electric Co.
120 E. 1st St.
Wichita, Kansas
12 KV transmission line
3 phase 4 wire

Arkansas-Louisiana Gas Co.
2030 S. Main
Wichita, Kansas
Note: Gas line along
south side of
13th St. No.

13TH ST.
North line of NE 1/4 15-27-1W NO.

Note: 12" City of Wichita water line
17' 13th St. RW

Architect	Consultant	
Project ADVANCED MOBILE PHONE SERVICE		Sheet
Drawing		Scale
Approved by	AMPS Location Number	Date
AMPS - Director of Operations	AMPS Job Number	Drawing Number
AMPS - General Manager - Construction		