

I-295 HIGHWAY R/W  
 CASE A-77126

RAY ALLEN ADD.

PART OF LOT 14  
 R.A. MORRIS TRACTS

TRACTS

PROPOSED  
 DONNA'S 1ST ADD

SW Cor NW1/4  
 Sec. 14-275-1W

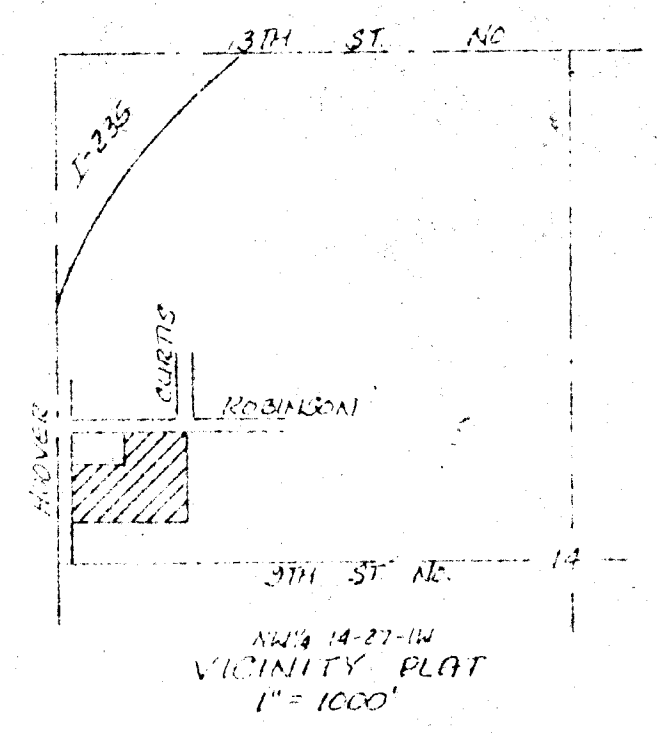

1" = 50'  
 Elev. = City Datum

BENCH MARK:  
 City Standard Disc. 34" E. & 42" S.  
 at the E. of Hoover & 37th St.  
 Elev. = 126.223 City Datum

PRELIMINARY PLAT  
**COMFORT WEST ADDITION**

PART OF LOTS 13, AND 14, R.A. MORRIS TRACTS

RICHARD NIEDENS

140.8  
 137.9  
 9

**DRAINAGE PLAN** 10/31

**BAUGHMAN COMPANY, P.A.**  
 SURVEYING & ENGINEERING  
 316/262-7271 • 330 LAURA • WICHITA, KANSAS 67211

14 Sept  
 18, 2008