

**NOTES:**

- 1.) BENCHMARK: CITY DISC 64' E. AND 99' S. OF CENTERLINE OF MAIZE AND 21ST STREET NORTH. ELEV.- 164.3 CITY DATUM. 1351.7 MSL.
- 2.) DRAINAGE CONCEPT PLAN TO BE PREPARED BY BAUGHMAN CO. AND SUBMITTED TO CITY ENGINEER.
- 3.) SEE CHADSWORTH COMMERCIAL C.U.P. DP-204 FOR ADDITIONAL REQUIREMENTS.
- 4.) MAJOR STREET IMPROVEMENTS FOR MAIZE ROAD AND 21ST STREET NORTH SHALL BE IN CONFORMANCE WITH THE CHADSWORTH COMMERCIAL C.U.P. PRELIMINARY TRAFFIC STUDY DRAWING UNLESS OTHERWISE DETERMINED NECESSARY BY THE CITY ENGINEER.

**TOTAL AREA- 18.0 AC.**

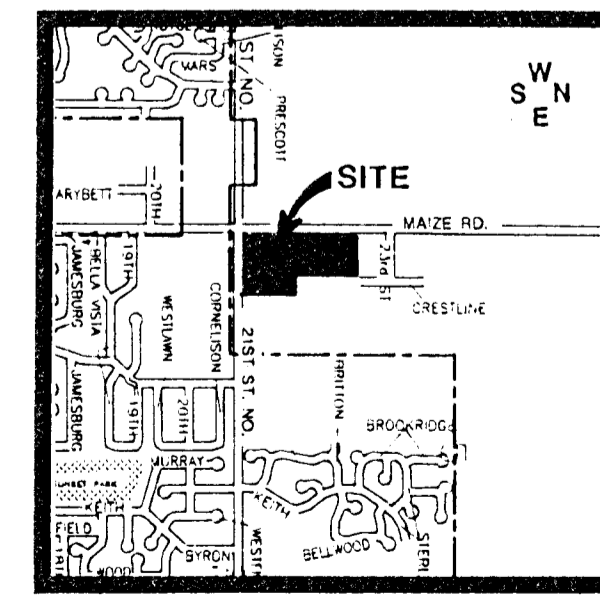
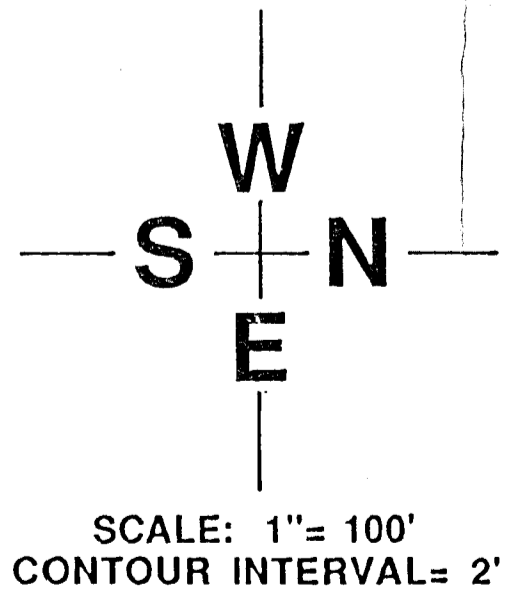

NO SCALE  
**LOCATION MAP**

PRELIMINARY PLAT

**CHADSWORTH COMMERCIAL**

BRUCE A. & ESTHER L. PEARSON 10218 W. 21ST ST. N. WICHITA, KANSAS 67212

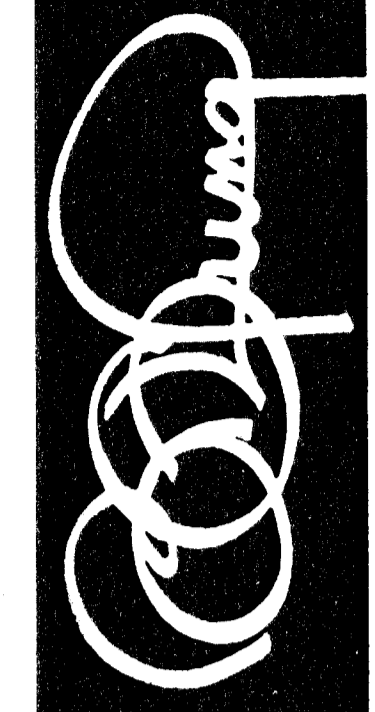

**BILL G. YUNG DESIGN**  
WICHITA, KS. 67220  
4912 E. 20TH STREET NORTH  
316-683-6567

DATE FEB. 12, 1992  
REV.

SHEET TITLE  
PRELIMINARY PLAT

PROJECT  
CHADSWORTH COMMERCIAL

SHEET  
OF