

GENERAL NOTES:

- The Contractor shall comply with all applicable safety regulations. All construction shall be completed following current City Standard Specifications and Special Provisions.
- Contractor will be required to provide notice to utility companies a minimum of seventy-two (72) hours prior to any excavation, as follows:
Kansas One-Call 687-2470
The Contractor must notify the following in case of an emergency:
Black Hills Energy 1-800-246-8464
City of Wichita Stormwater 1-316-268-4200
City of Wichita Traffic 1-316-268-4034
City of Wichita Public Works 1-316-268-4034
Kansas Gas Service 1-800-482-4500
Energy 1-800-544-4487
- Utility service lines, poles, etc. one to be adjusted as necessary by others prior to construction unless the Contractor or unless the plans specifically identify a utility to be adjusted by its owner during construction. Plans, represent the best information obtainable for existing utilities within the project area. Any conflict with proposed construction.
- Excavation shall be completed in a timely manner and excess excavation which is to be wasted shall be removed and shall be the responsibility of the Contractor. The Contractor shall be responsible for the safety, suitability, appearance and site location. Locations, in appearance will not be approved. All disposal sites must be approved by the Kansas Department of Health and Environment. All disposal sites must be approved by the Kansas State Board of Engineers and geologists. Any material buried or additional archaeological investigations unless buried in a previously approved borrow location.
- Trees and shrubs in public right-of-way which are in direct conflict with proposed new construction shall be removed. Trees and shrubs which are not in direct conflict with proposed new construction shall be saved and protected from damage.
- The Contractor shall give all property owners and/or adjacent property owners a minimum of ten (10) days notice prior to start of construction.
- The Contractor shall be responsible for providing property lines. The Contractor will be required to provide property lines to the City of Wichita. Property lines shall be re-established by a licensed land surveyor in accordance with state law.
- The Engineering Division shall field locate water valves one (1) mile from the project location. The Contractor shall be responsible for the Contractor's field locations during the construction process. Water valves shall be re-established by a licensed land surveyor in accordance with state law.
- The Contractor shall notify the inspecting engineer and Wichita with the anticipated construction start date and notify them of project completion. Staking and inspection for this project will be the responsibility of the Contractor.
- Construction shall be completed before traffic control construction can begin. The Contractor shall be responsible for all construction zone markings and signage shall conform to Kansas Standard Specifications for Highway Construction (MUTCD) as published by the US Dept. of Transportation, Federal Highway Administration. All costs for construction zone markings and signage shall be the Contractor's responsibility.
- All elevations shown are MVD 85.
- All areas disturbed during construction that will not be restored to original conditions.

Iva Fultz Gardens Addition

SANITARY SEWER TO SERVE

3193 Seneca St

CITY OF WICHITA, KANSAS
Paul Gunzelman, P.E. City Engineer
Project Number
2024-016689 PPS (53030982)

AS BUILTS
5344B
SS22-01

Contractor:
McCullough
Excavation
5/02/2025

Project Inspector:
Larry Gann
KEMILLER
ENGINEERING PA

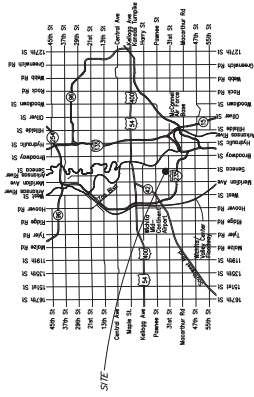

Vicinity Map

Sheet Index

- Cover Sheet
- Precast SS MH Detail
- MH Frame and Cover Detail
- Plan and Profile Sheet
- Erosion Control Plan
- 4.1-4.5 Erosion Control BMP Details
- Plan

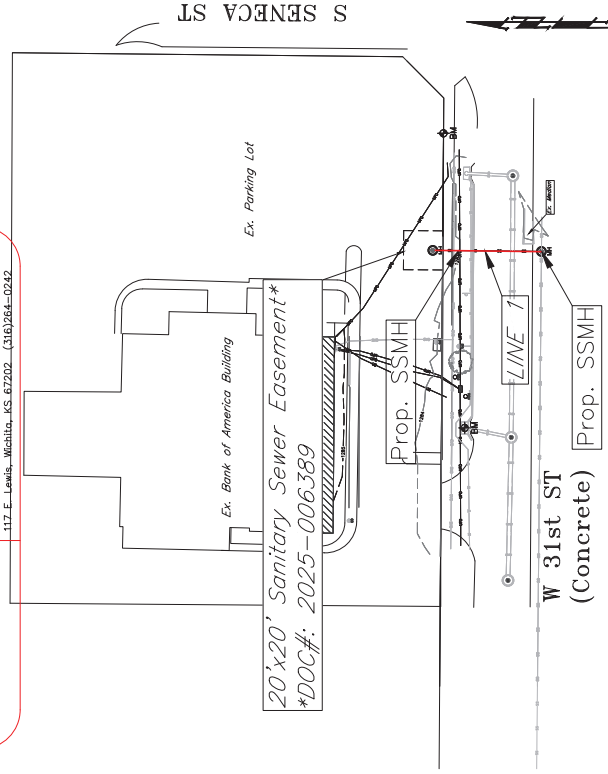

Benchmarks

Property Corner
1567 Feet South of the Southeast
Corner of Seneca St. and
Seneca St. (M1058)
Elev. = 1023.45 (M1058)



APPROVED AS NOTED
BY WICHITA PUBLIC WORKS
ENGINEERING DIVISION

Reviewed by: Sharon Matis, on this day
the 14th of March, 2025

Reviewed by: Scott Moser, on this day
the 14th of March, 2025

NOTE TO CONTRACTORS

Inspection and testing for this project is to be provided by a Licensed Consulting Engineering Firm under contract with the City of Wichita. The Contractor shall be responsible for providing the City of Wichita with a Licensed Professional Engineer in the state of Kansas to inspect and test the construction. The Contractor shall be responsible for providing the City of Wichita with a Licensed Professional Engineer in the state of Kansas to inspect and test the construction. The Contractor shall be responsible for providing the City of Wichita with a Licensed Professional Engineer in the state of Kansas to inspect and test the construction. The Contractor shall be responsible for providing the City of Wichita with a Licensed Professional Engineer in the state of Kansas to inspect and test the construction.

An approved copy of these plans signed by City staff are required on-site.

MARCH 2025



