

BM 111.11 "4" cut on back of walk at NW corner of building east of alley between Main & Market on the S.L. of English.

Note: Concrete, asphalt, and brick building will be removed by others except where otherwise noted.

NOTE: CONTRACTOR FOR THIS PROJECT SHALL COORDINATE HIS WORK WITH THE CONTRACTOR FOR CONSTRUCTION OF HERITAGE SQUARE PARK.

Plan Scale 1" = 10'
 Profile Scale 1" = 10' Horiz.
 1" = 5' Vert.

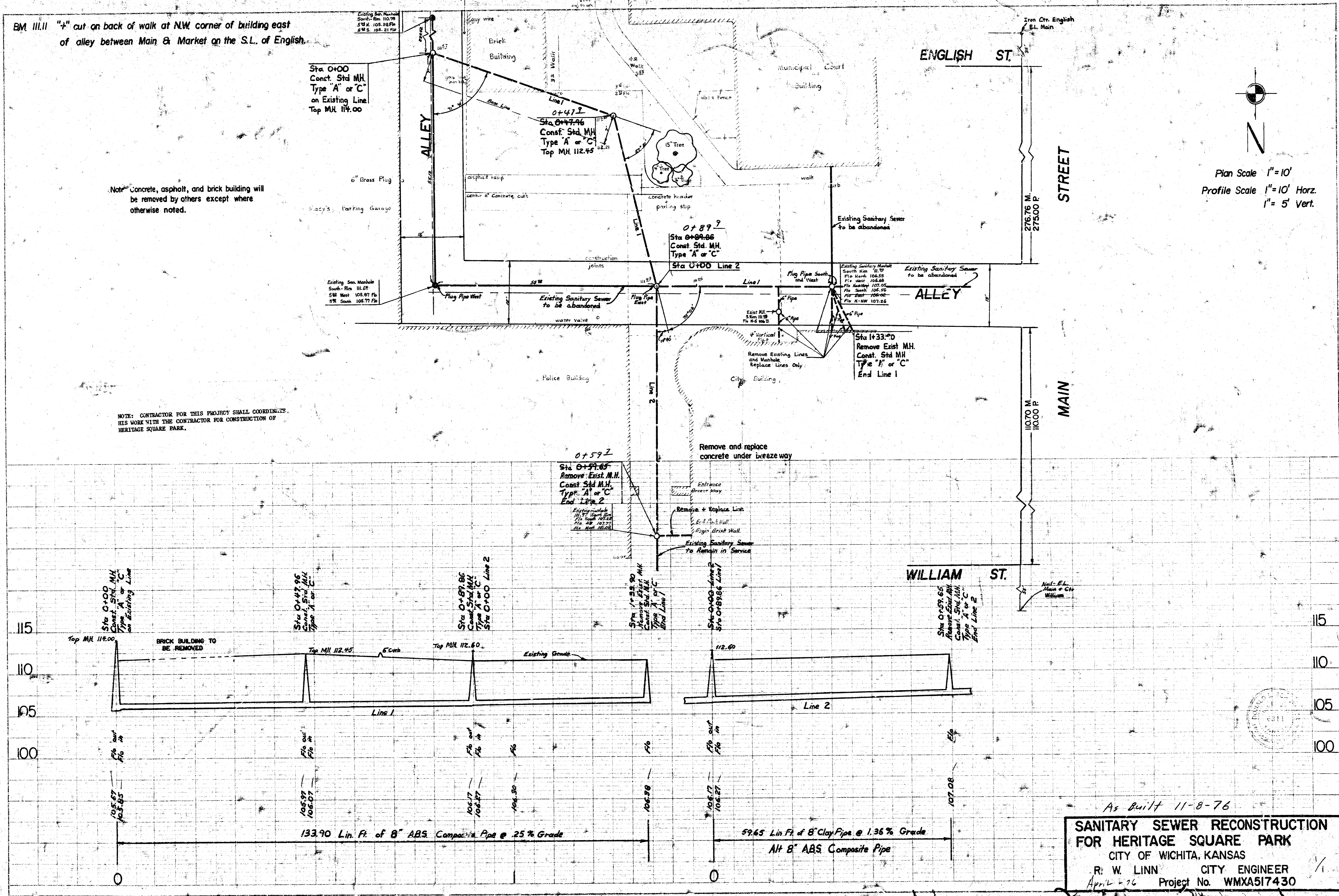

As Built 11-8-76

SANITARY SEWER RECONSTRUCTION FOR HERITAGE SQUARE PARK
 CITY OF WICHITA, KANSAS
 R. W. LINN CITY ENGINEER
 April 1976 Project No. WMXA517430