

SCALE: 1"=20'

| | |
|-------------|--|
| BM 112.90 | Washington & 9th, brass rod in conc. post, 23' S. & 37' E. of E. both. |
| B.M. 113.17 | R.R. Spk. 5-ft Light Pole, NW Cor. 8th & Indiana. |
| B.M. 113.94 | R.R. Spk. 5-ft Light Pole, W5 Indiana, 23' S. of S.L. 8th St. |
| B.M. 113.04 | R.R. Spk. 5-ft Light Pole, E5 Ohio, 27' S. of S.L. 8th St. |

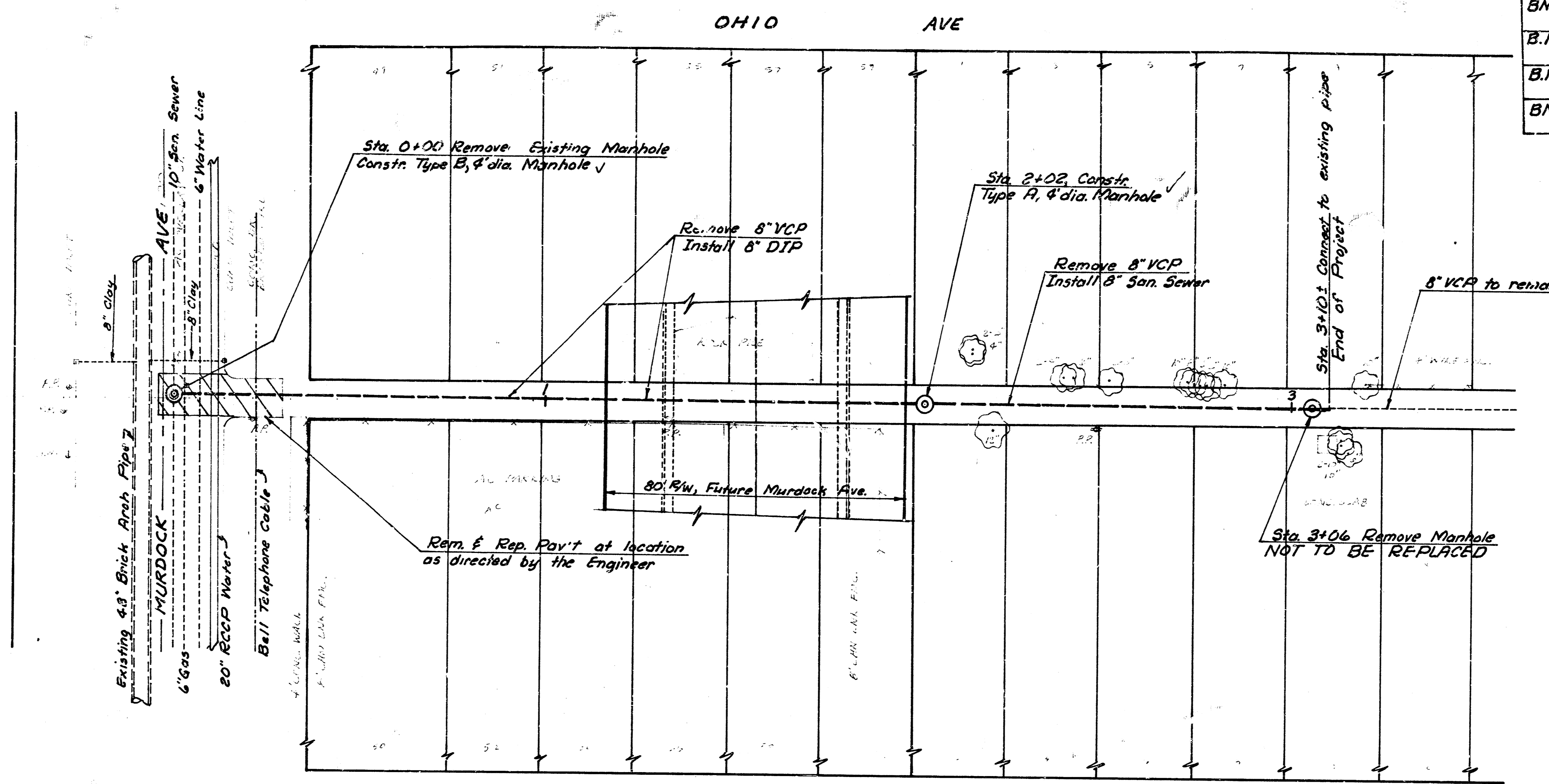

THE CONTRACTOR SHALL BE RESPONSIBLE FOR PRESERVING PROPERTY RIGHTS. THE CONTRACTOR SHALL BE REQUIRED TO RE-ESTABLISH ANY PROPERTY LINES WHICH ARE DAMAGED OR DESTROYED BY HIS CONSTRUCTION OPERATIONS. SUCH RIGHTS SHALL BE RE-ESTABLISHED BY A LICENSED LAND SURVEYOR OR A LICENSED PROFESSIONAL ENGINEER IN ACCORDANCE WITH STATE LAWS.

As Built
J.L.L.
2-84

- NOTES:
- 1) Saw Joint shall be incidental to project
 - 2) The contractor shall remove the existing clay pipe up to the nearest joint in the vicinity of station 3+10 Sheet 1 and station 3+05, Sheet 2. The installation of the new pipe shall be started at the joint. Contractor shall ensure watertight connection at no additional cost.

NOTE: For Manholes, See City Std. Drawings for Type A Manhole & for Type B Manhole

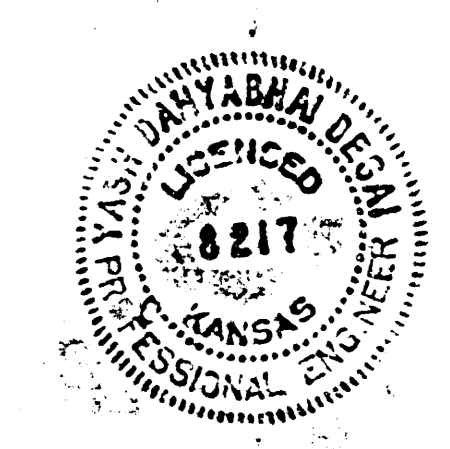
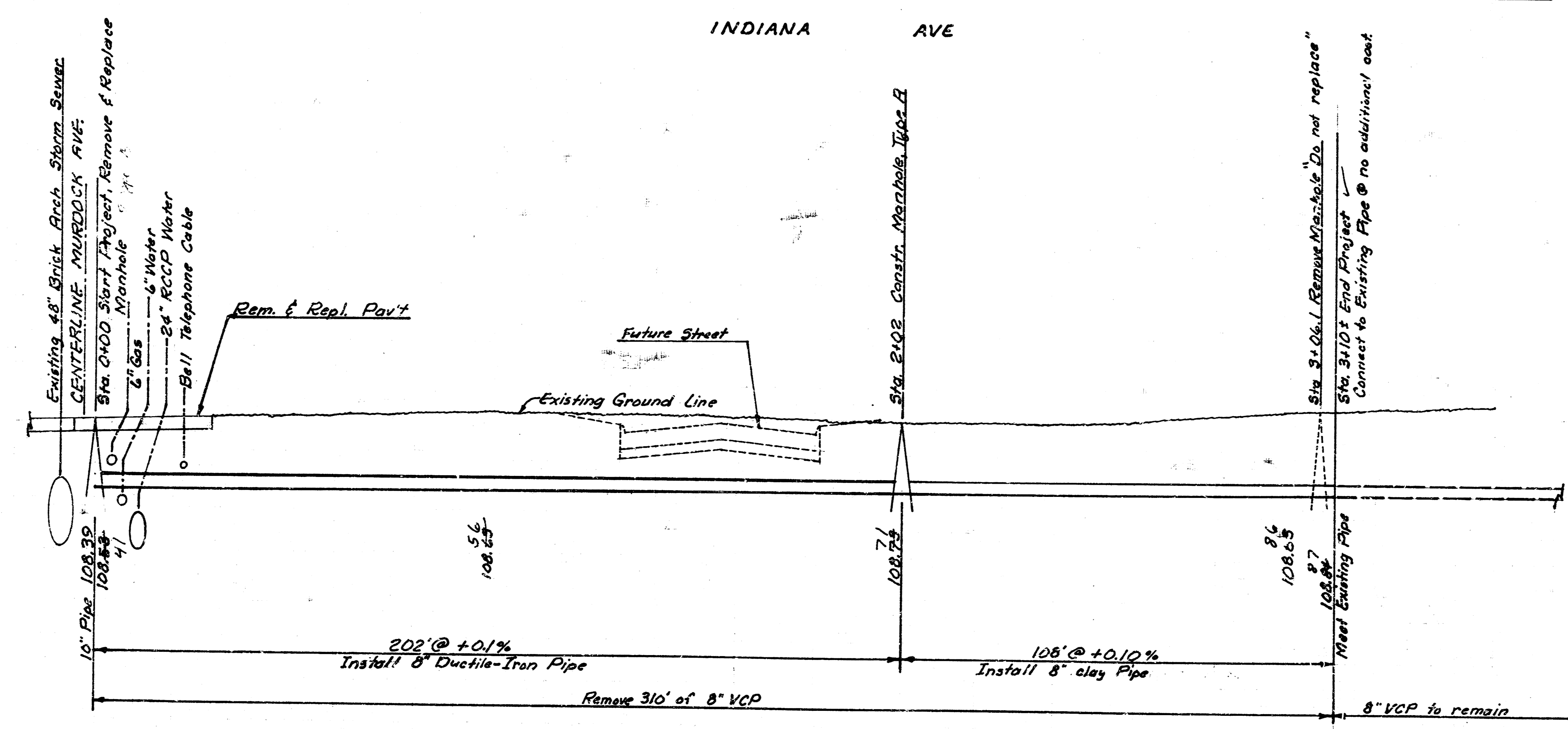

| | | |
|---|-------------|--------------|
| PROJECT DESCRIPTION | | |
| RECONSTR. A PORTION OF S.S. NO. 14 & DIST. V, S.S. NO. 20 IN THE ALLEYS BETWEEN OHIO & CLE. LAND, FROM MURDOCK TO 8th STREET. | | |
| PROJECT NUMBER | | |
| 468-76-245-81248-000-000-001 | | |
| BOOK NO. 125-22 | APPROVED BY | DATE 6-83 |
| DRAWN BY WSK | | REVISED |
| CITY OF WICHITA | | 1/2 |
| DEPARTMENT OF ENGINEERING | | |
| DIRECTOR OF ENG./CITY ENGINEER | | |
| R. W. BRUCE-EMAN | | Sheet 1 of 2 |

FOR B.M.'s See Sheet 1

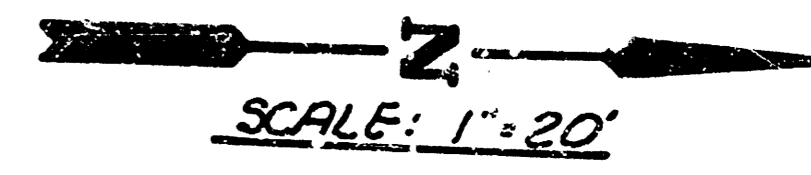

THE CONTRACTOR SHALL BE RESPONSIBLE FOR PRESERVING PROPERTY IRONS. THE CONTRACTOR SHALL BE REQUIRED TO RE-ESTABLISH ANY PROPERTY IRONS WHICH ARE DAMAGED OR DESTROYED BY HIS CONSTRUCTION OPERATIONS. SUCH IRONS SHALL BE RE-ESTABLISHED BY A LICENSED LAND SURVEYOR OR A LICENSED PROFESSIONAL ENGINEER IN ACCORDANCE WITH STATE LAWS.

As Built
JKL
2-84

NOTE: For Manholes, See City Std. Drawings for Type A Manhole & for Type B Manhole

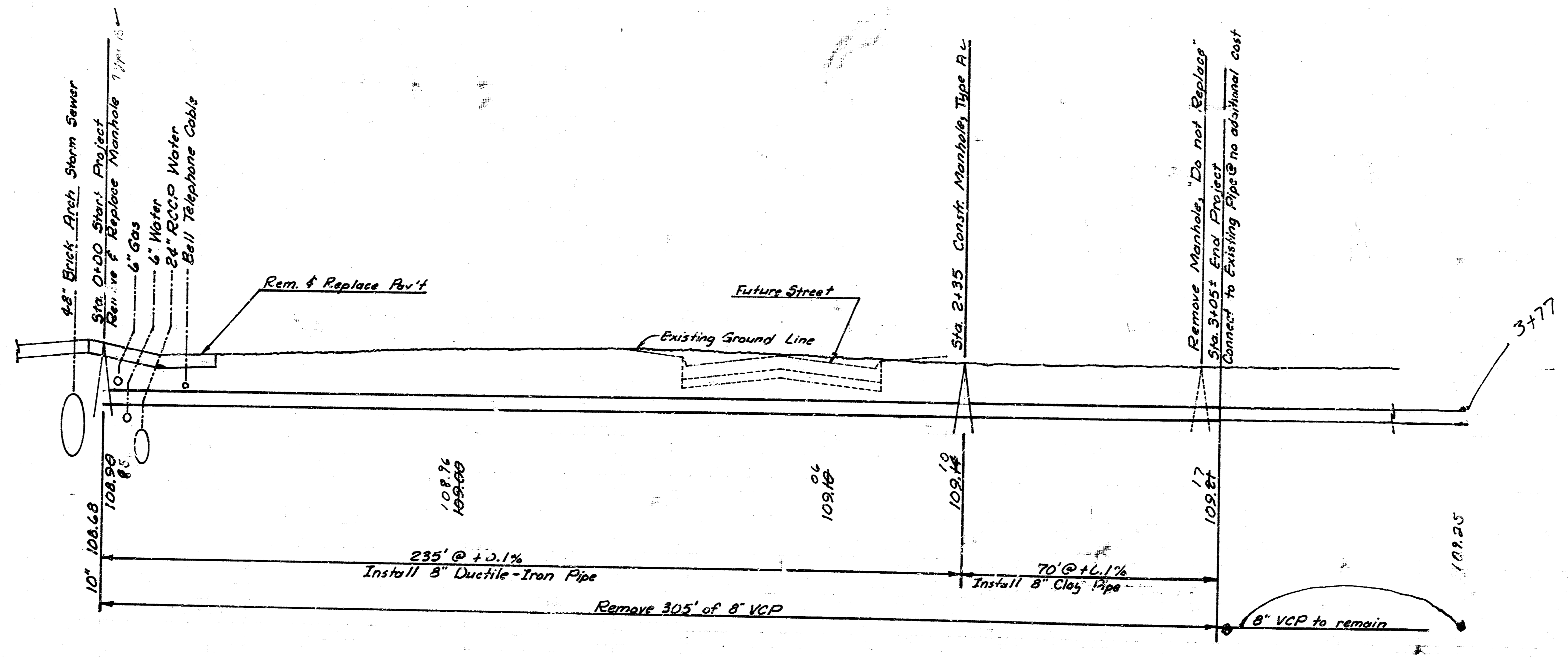
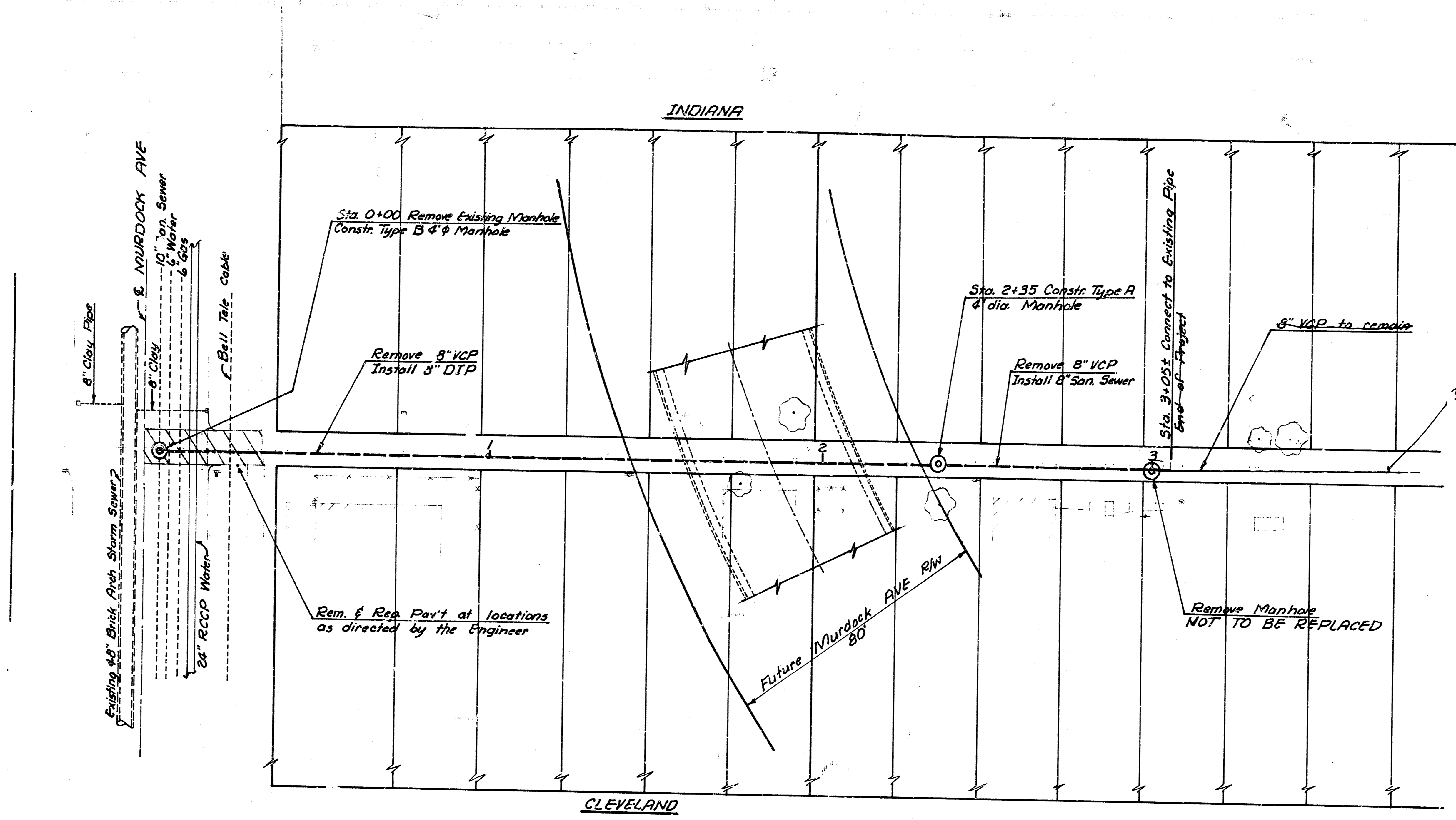

PROJECT DESCRIPTION
RECONSTR. A PORTION OF S.S. NO. 14 &
DIST. Y. S.R. NO. 20 IN THE ALLEYS
BETWEEN OHIO & CLEVELAND, FROM
MURDOCK TO 8th STREET. 2/2
PROJECT NUMBER
648-76-245-81248-000-000-001
Sheet 2 of 2

6.5.22
NOR

115
110
105

115
110
105

10 3 5 10 Sheet 2 of 2