

# SANITARY SEWERS 1 & 20 REHABILITATION

## BETWEEN DOUGLAS AND HARRY FROM THE BIG ARKANSAS RIVER TO WASHINGTON

### INDEX TO DRAWINGS

SHEET NO.	DESCRIPTION
1	TITLE, LEGEND AND GENERAL NOTES
2	KEY MAP
3 - 5	PLAN & PROFILE

### PROJECT NUMBER

## 468-76-245-81642-000-000-001

**CITY OF WICHITA, KANSAS**  
**MICHAEL E. LINDEBAK, CITY ENGINEER**  
**FEBRUARY, 1987**

### GENERAL NOTES

9. Only active building sewer lines which connect actual buildings to the sewer system are to be reconnected to the new sewer construction. Building sewer lines and/or connections which have been abandoned are not to be reconnected to the new sewer construction. It will be the sole responsibility of the Contractor to ascertain which such building sewer lines and/or connections are active and which such sewers and/or connections have been abandoned. All work involved with building sewer line construction and/or building sewer connections shall conform to the applicable section of the Standard Specifications.
10. The Contractor shall be responsible for maintaining continuous flow of sewage through construction. Contractor's proposed method for maintaining sewage flow shall be approved by the Engineer. Cost of maintaining flow of sewage through construction will not be paid for directly and this cost shall be considered as subsidiary to the other pay items of work.
11. The Contractor shall be responsible for preserving property irons. The Contractor will be required to re-establish any property irons which are damaged or destroyed by his construction operations. Such irons shall be re-established by a licensed land surveyor or a licensed professional engineer in accordance with state laws.
12. Pavement removal and/or replacement will be measured and paid for on the lineal foot basis as measured along the centerline of the sewer regardless of width or thickness. Minimum limits of such pavement removal and replacement shall be one foot beyond the limits of the excavation made for the sewer or the structure, except when the limits of removal are within three (3) feet of an existing joint the limits of removal shall be extended to the existing joint. Removal and replacement of existing pavement shall conform to the applicable sections of the City of Wichita Standard Specifications.
13. The spot repairs denoted as Sites 10 and 11, as shown in the City of Wichita T.V. log, shall include a minimum of 10 L.F. of new pipe and related fittings and other required work and materials. This work shall be paid for as a lump sum item for each spot repair. The location and extent of this rehabilitation shall be confirmed by the Engineer.

### LEGEND

EXISTING	DESCRIPTION
---	BACK OF CURB, EDGE OF PAVEMENT
---	FENCE
● FH	CURB OR AREA STORM SEWER INLET
● FH	FIRE HYDRANT
---	ARKLA GAS SERVICE
---	KPL GAS SERVICE
● GM	GAS METER
● GV	GAS VALVE
---	GRAVEL ROAD OR TRAVELED WAY
● LP	LIGHT POLE
● MH	MANHOLE - STORM SEWER, SANITARY SEWER AND ELECTRICAL
○	POWER POLE
● GLA	GAS LINE ANODE
— 8" SWS	SANITARY SEWER
— 8" SWS	STORM SEWER
---	STRUCTURES
+	TELEPHONE POLE
+	THIMBLE
+	TREE
+	SCRUB HEDGE
+	COMBINED TELEPHONE AND POWER POLE
---	WATER LINE
● WM	WATER METER
● V	VALVE
● LP	COMBINED LIGHT AND TELEPHONE POLE
● GP	GUY POLE
● CC	CLEANOUT
○	TRAFFIC POLE
---	UNDERGROUND TELEPHONE LINE
---	RAILROAD
○ RD	ROOF DRAIN
○	4" STEEL POST
---	PERMANENT EASEMENT
---	PROPERTY LINE
● OH	OBSERVATION HOLE

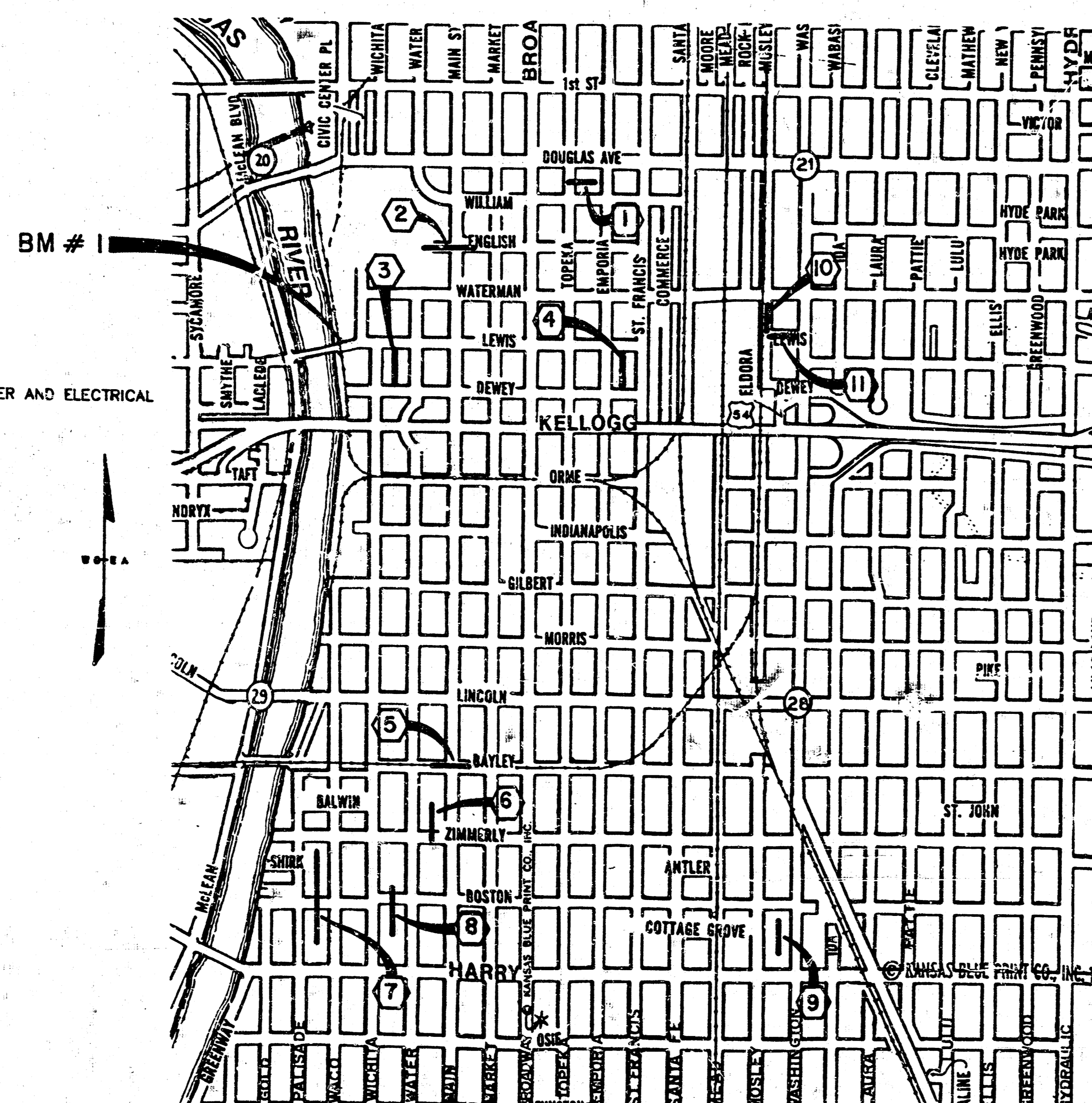

LOCATION MAP

### GENERAL NOTES

1. Interurban traffic generated outside the project area and local business or apartment traffic generated within the project area are to be carried through construction, as further promulgated in the Special Provisions.
2. Underground utility service lines and overhead utility pole lines are to be adjusted as necessary by others prior to construction unless the plans specifically call for their adjustment by the Contractor or unless the plans specifically show utility adjustment during construction by the utility company. Existing utilities and their location, as shown on the plans, represent the best information obtainable for design. The Contractor will be required to work around existing utilities within the right-of-way which do not conflict with proposed construction.
3. A saw cut of at least one-half the depth of existing surface courses or one-fourth the depth of the existing total pavement thickness shall be provided at locations where proposed construction abuts an existing surface course or pavement for which partial removal of that surface or pavement is required. Saved joint to facilitate removal within 3 feet (3') of existing joints will not be permitted and for such instances the limits of removal shall extend to the existing joint. Such saw cuts will not be paid for directly and this cost shall be considered as subsidiary to the removal of the surface or pavement.
4. Rubble from the removal of miscellaneous structures and excess excavation which is to be wasted shall be disposed of on sites to be provided by the Contractor. These sites shall be approved by the Engineer as to suitability, appearance and site location. Locations that, in the opinion of the Engineer, will leave an unsightly appearance will not be approved.
5. The Engineer shall take field ties to all quarter section corners. The Contractor shall set a City survey monument in the required location where such quarter section corners exist within the limits of pavement construction. Survey monuments will be furnished by the City. The Engineer will accurately locate and install the iron at the quarter section corner. This work will not be paid for directly, but shall be considered subsidiary to the other pay items of work in the contract.
6. Properties within the project limits may have underground sprinkler systems in public right-of-way which conflict with new construction. Contractor will be required to remove such improvements should they not be removed by their owner at the time of construction of the project. The Contractor will be required to salvage all sprinkler heads and/or valves and give such material to their owner. Portions of underground sprinkler systems not in conflict with new construction shall be protected from damage and shall remain in place. All work in connection with underground sprinkler systems shall be considered as subsidiary to the contract pay items of work.
7. Trees and shrubs in public right-of-way which are in direct conflict with proposed new construction shall be removed by the Contractor with the Engineer's approval. Trees and shrubs which are not in direct conflict with proposed new construction shall be saved and protected from damage.
8. The Contractor shall give all property owners and/or tenants of developed property abutting the construction of this project a minimum of ten (10) days advance notice prior to start of construction.

### PROJECT BENCH MARK

BM #1 CITY OF WICHITA BENCH MARK DISK IN  
 SIDEWALK AT NORTHEAST CORNER OF  
 BRIDGE AT THE ARKANSAS RIVER & LEWIS  
 ELEV. 112.68

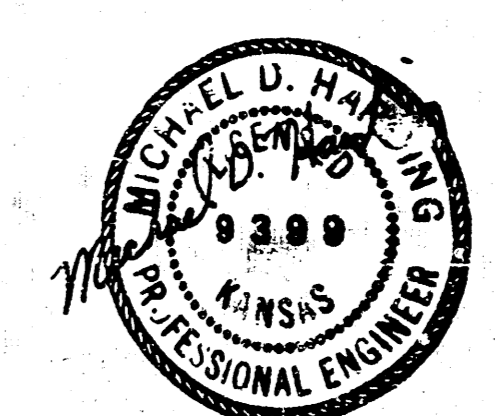

**WILSON**  
 COMPANY  
 ENGINEERS  
 ARCHITECTS

WICHITA KANSAS  
 CITY OF WICHITA PROJECT NUMBER  
 468-76-245-81642-000-000-001

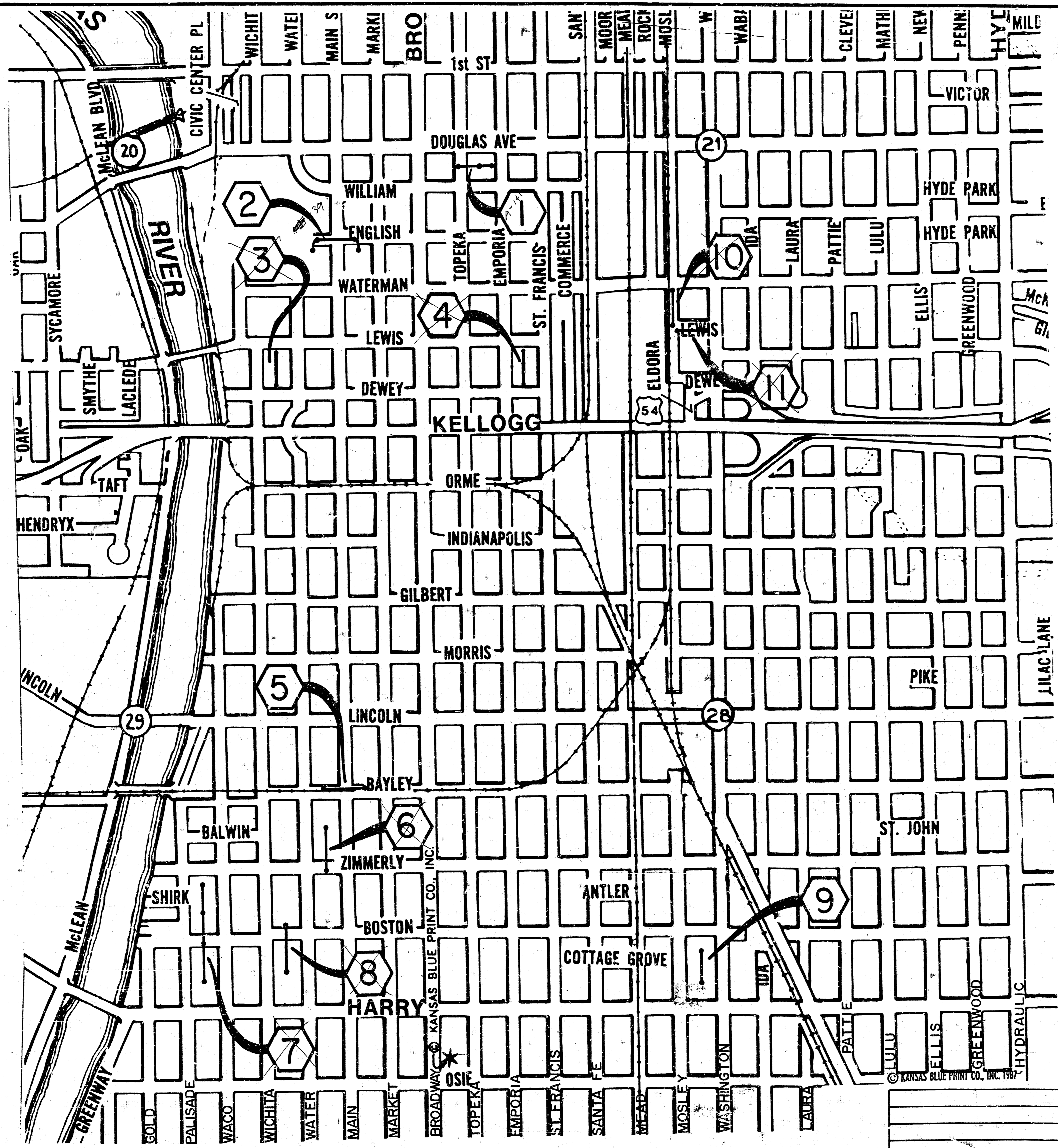

- Site No. 1. In the alley south of Douglas from the first manhole west of Emporia (MH7+46.6) to the manhole on the west side of Topeka (MH3+69.4).
- Site No. 2. In English Street from the manhole on the south side of English, west of Market (MH4+20), to the manhole on the south side of English, west of Main (MH0+00).
- Site No. 3. In the alley east of Wichita from the first manhole north of Dewey (MH8+15) to the first manhole south of Lewis (MH4+30.0).
- Site No. 4. In the alley west of St. Francis from the first manhole south of Lewis (MH11+40.5) to the first manhole north of Dewey (MH7+60.5). Also a spot repair 57 ft. south of MH 7+60.5.
- Site No. 5. In Bayley from the first manhole east of Main Street (MH3+69) to the first manhole west of Main Street (MH0+32).
- Site No. 6. In the alley west of Main Street from the first manhole north of Zimmerly (MH16+24) to the manhole in the south parking of Zimmerly (MH13+27).
- Site No. 7. In alley west of Waco from the first manhole south of Zimmerly (MH12+01.5) to the second manhole south of Boston (MH3+00).
- Site No. 8. In the alley east of Wichita from the first manhole north of Boston (MH10+63) to the first manhole south of Boston (MH7+49).
- Site No. 9. In the easement west of Washington from the first manhole south of Boston (MH4+40.5) to the second manhole south of Boston (MH2+19).
- Site No. 10. Spot repairs on the line in Mosley 175 ft. south of the manhole in the south parking of Waterman (MH7+13), and 268 ft. south of said manhole.
- Site No. 11. Spot repairs on the line in Lewis Street 77 ft. east of the manhole in Mosley (MH5+28) and 179 ft. east of said manhole.

CITY OF WICHITA PROJECT NO. 468-76-245-81642-000-000-001  
 WICHITA, KANSAS  
 SANITARY SEWERS 18 20 REHABILITATION  
 KEY MAP

DESIGN	MEK	DATE:	MARCH 1987
DRAWN	MEK	FILE NO.	87-307
		SHEET NO.	2
		OF	5
WILSON & COMPANY	WICHITA - KANSAS		
ENGINEERS & ARCHITECTS			

REVISION	DATE	BY

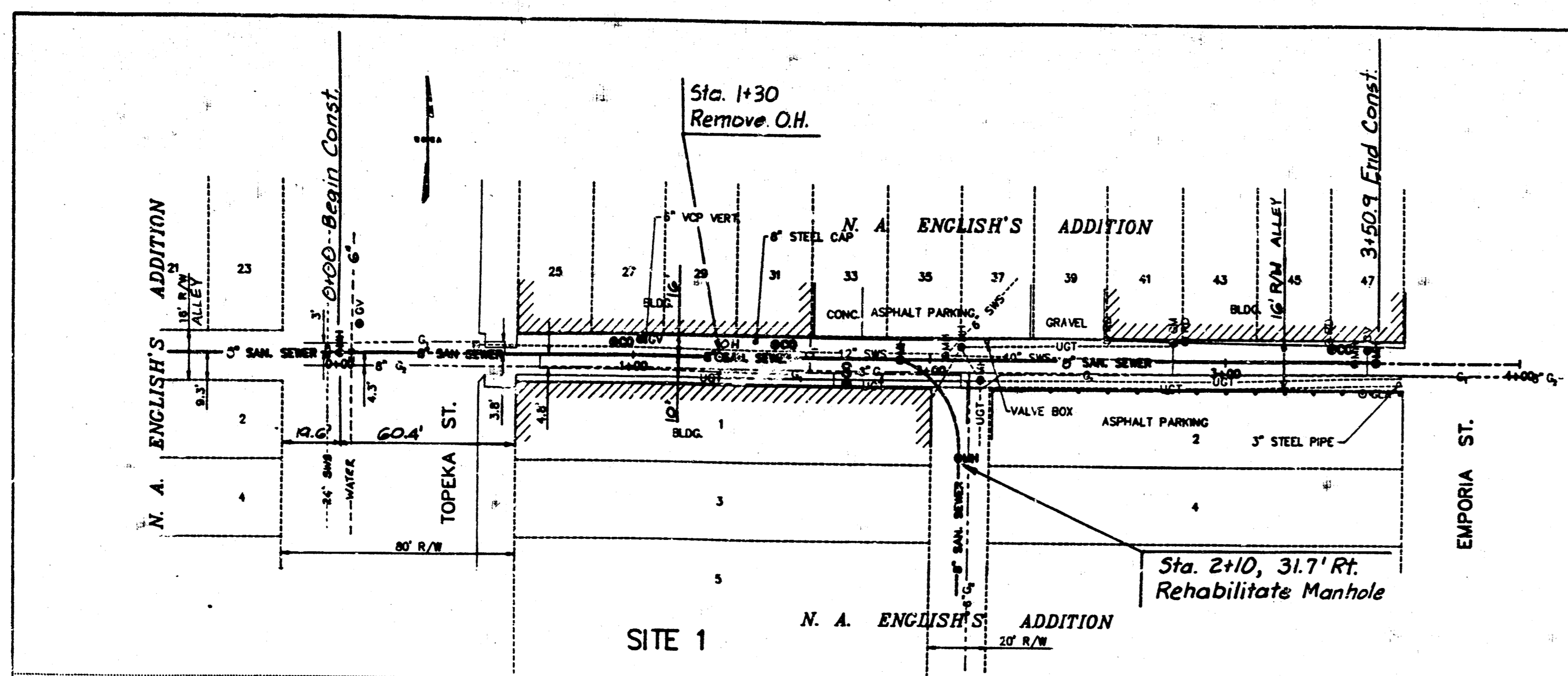

Site No.	Wye Sta.
1	0+32.9
1	0+67.3
1	0+89.7
1	1+14.1
1	1+42.8
1	1+64.3
1	1+83.3
1	1+91.2
1	2+16.5
1	2+42.6
1	2+63.9
1	2+86.0
1	3+07.6
1	3+31.8
1	3+48.0

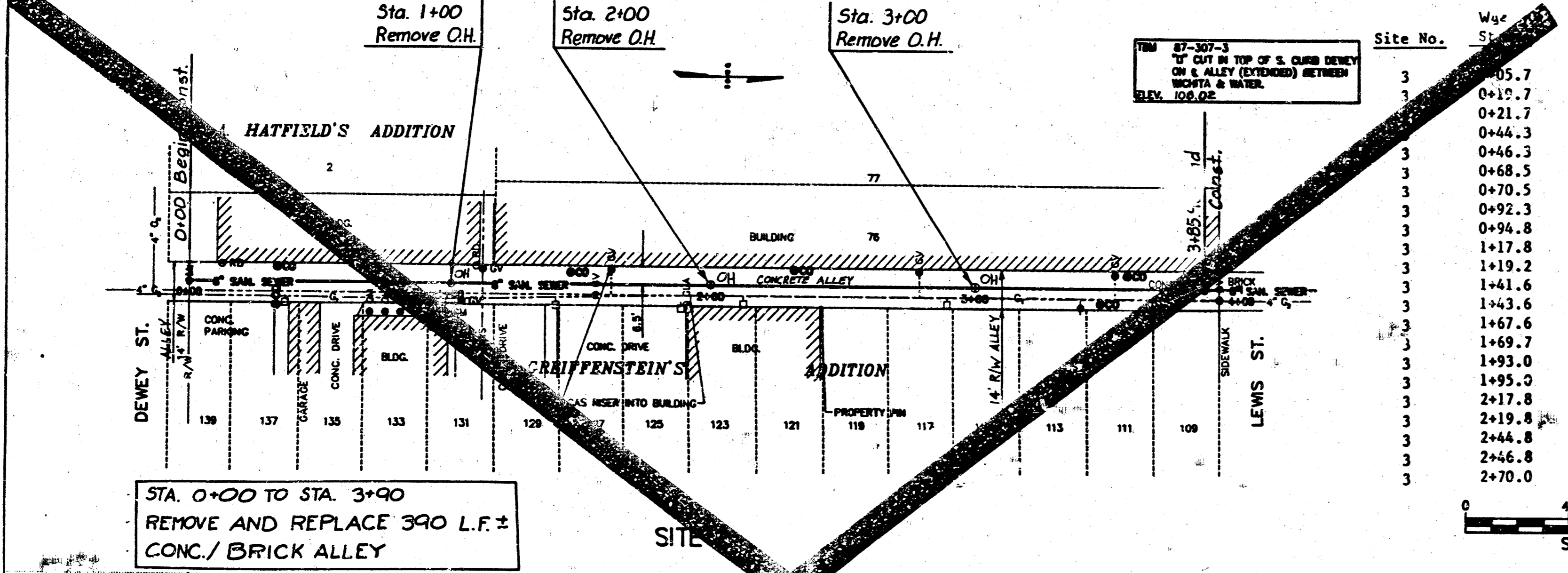
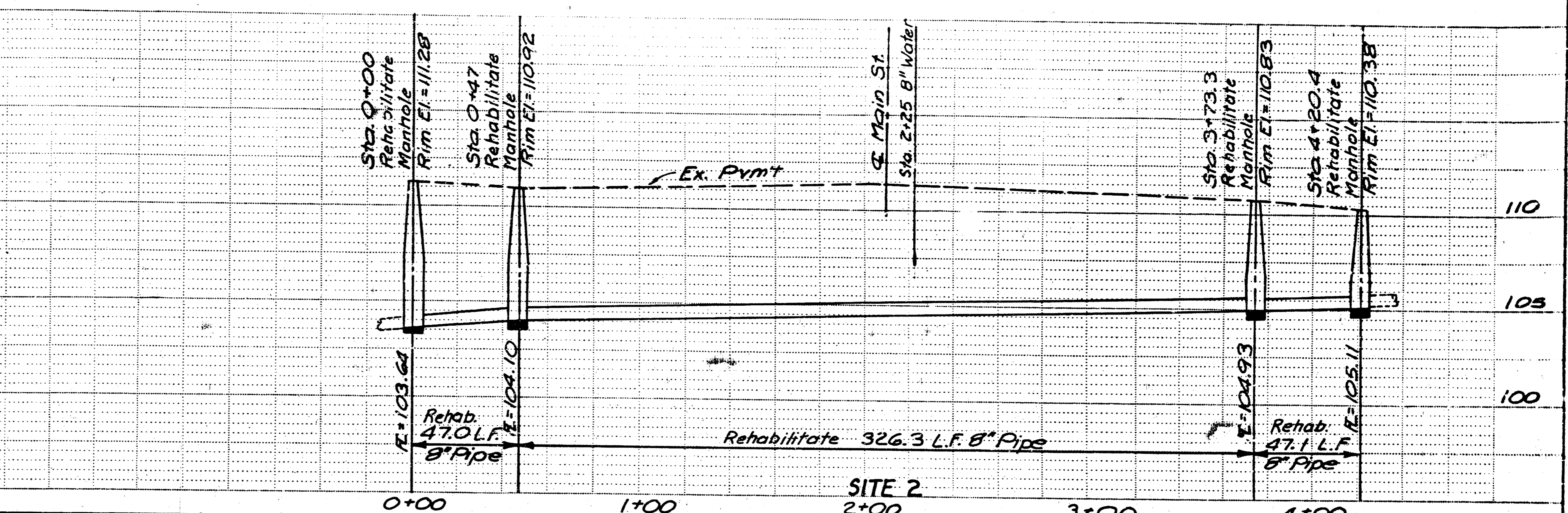
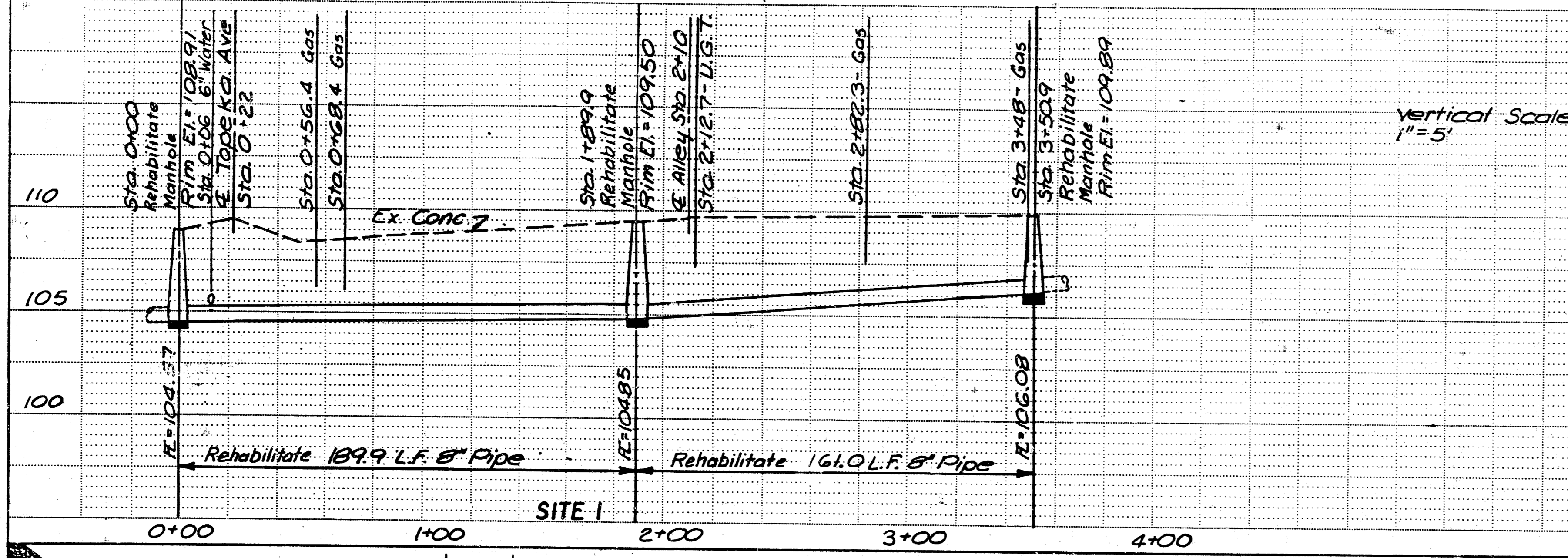
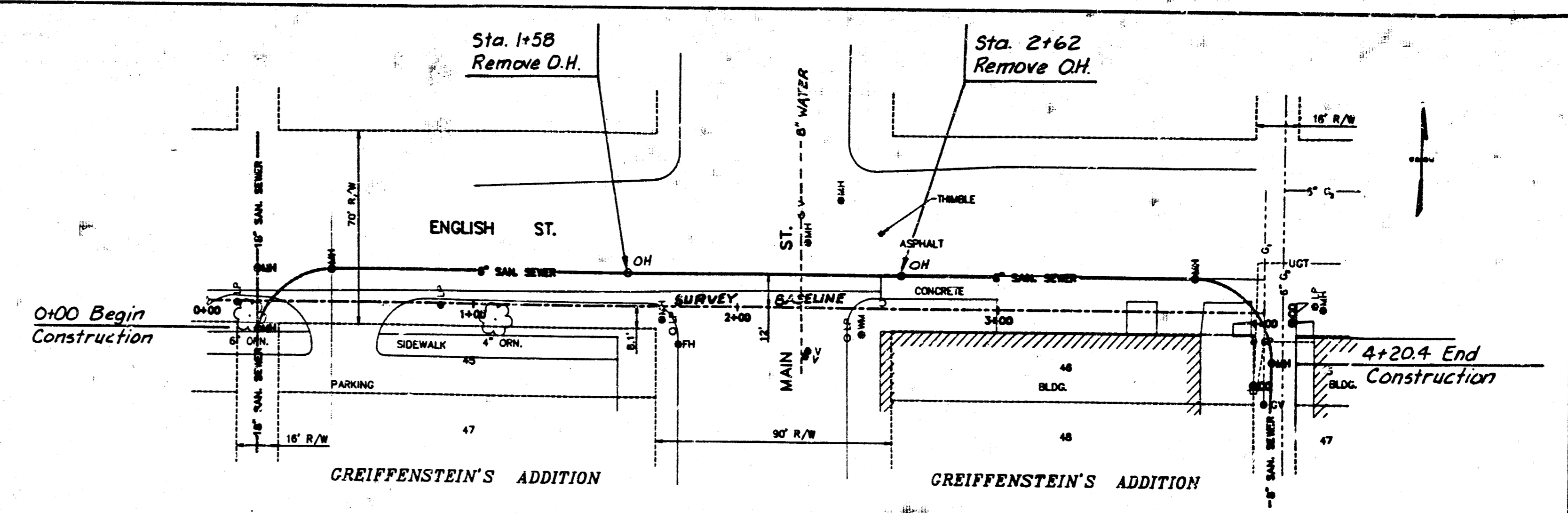
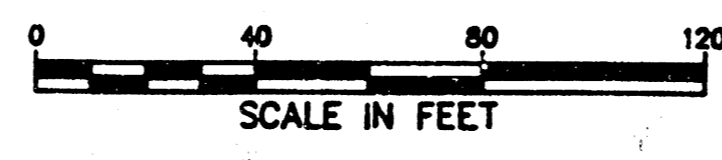

Site No.	Wye Sta.
3	0+05.7
3	0+15.7
3	0+21.7
3	0+46.3
3	0+68.5
3	0+70.5
3	0+92.3
3	0+94.8
3	1+17.8
3	1+19.2
3	1+41.6
3	1+43.6
3	1+67.6
3	1+69.7
3	1+93.0
3	1+95.0
3	2+17.8
3	2+19.8
3	2+44.8
3	2+46.8
3	2+70.0

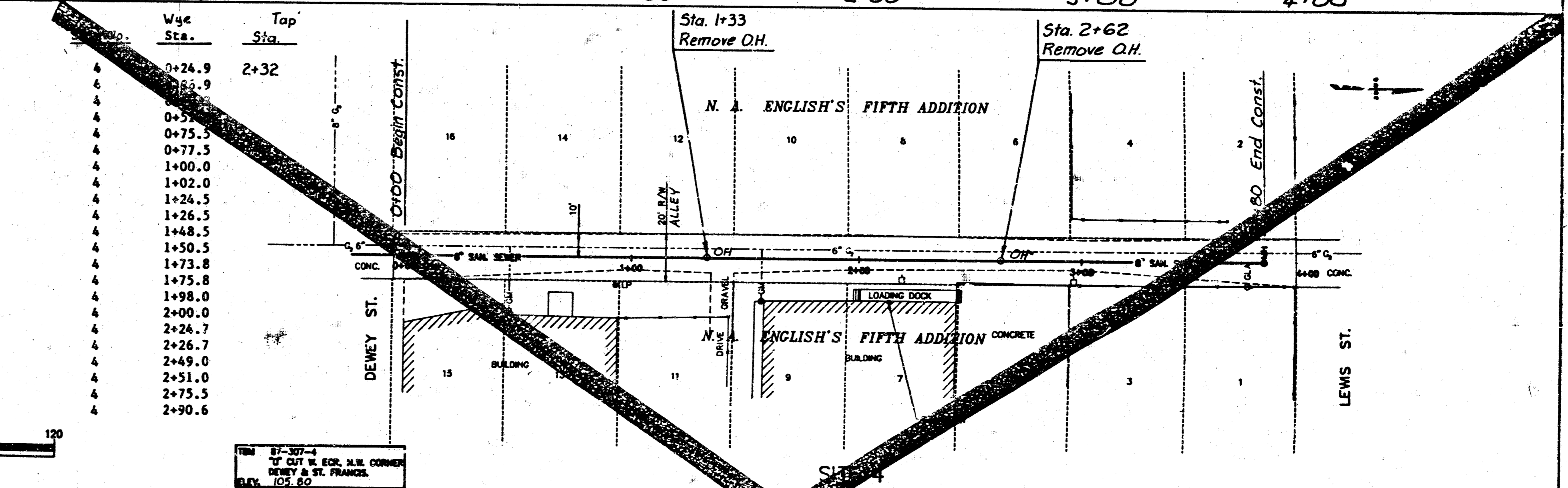
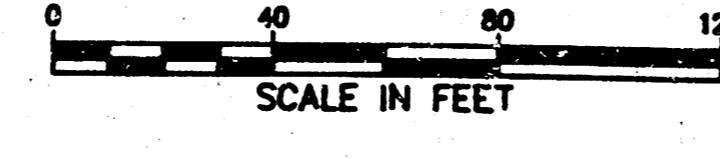

Site No.	Wye Sta.
4	0+24.9
4	0+15.7
4	0+21.7
4	0+35.9
4	0+75.5
4	0+77.5
4	1+00.0
4	1+02.0
4	1+24.5
4	1+26.5
4	1+48.5
4	1+50.5
4	1+73.8
4	1+75.8
4	1+98.0
4	2+00.0
4	2+26.7
4	2+26.7
4	2+49.0
4	2+51.0
4	2+75.5
4	2+90.6

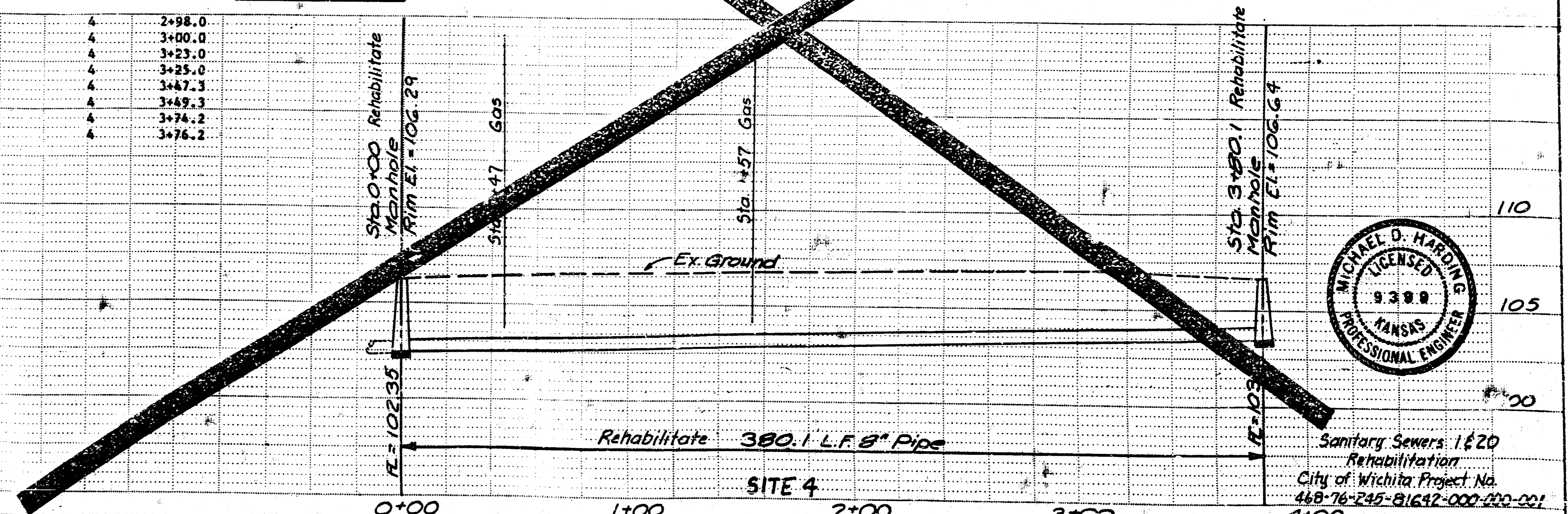
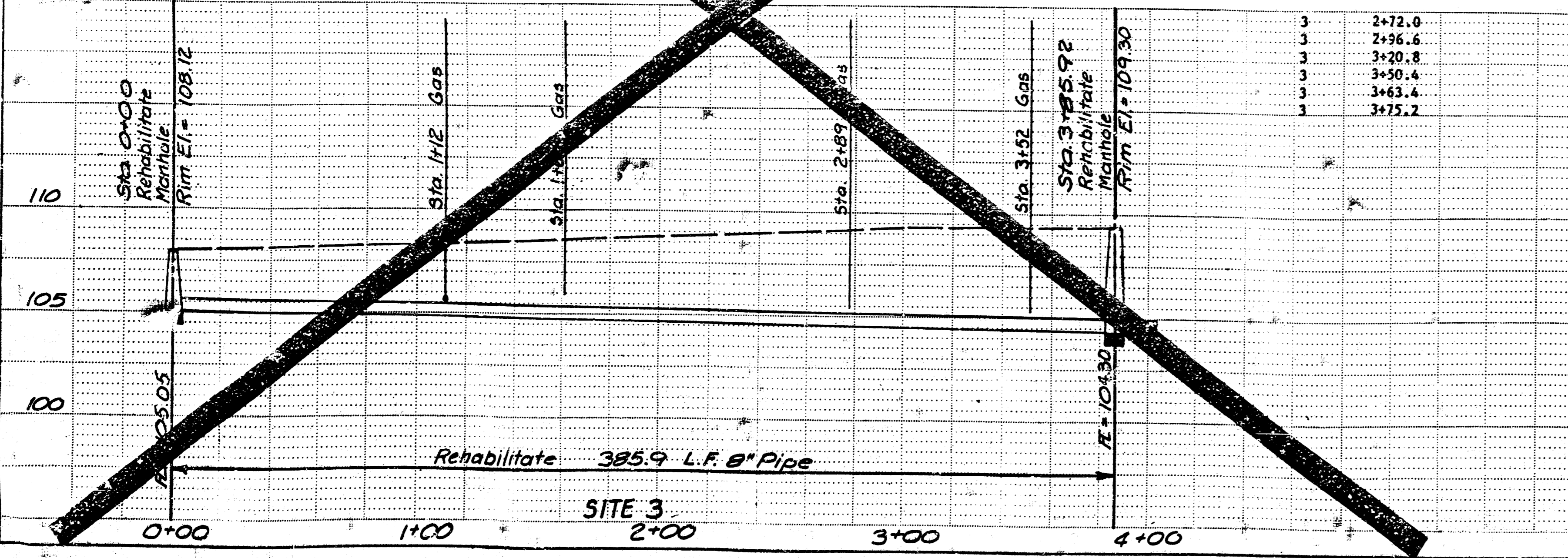

Sanitary Sewers 1620 Rehabilitation  
City of Wichita Project No. 468-76-245-91642-000-200-001  
4+00

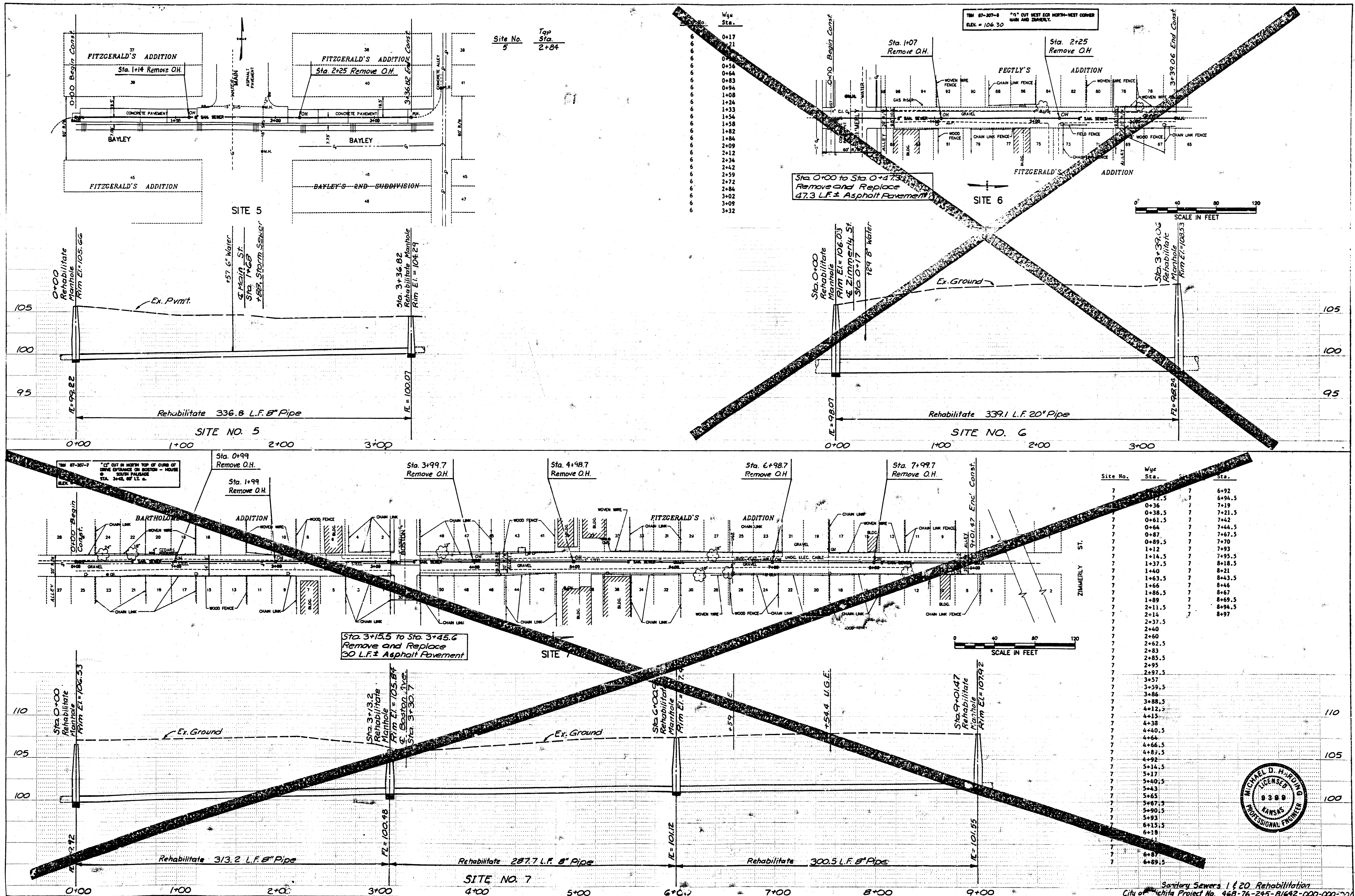

Site No. 5  
Tap Sta. 2+84

Sta. 0+00 to Sta. 0+47.3  
Remove and Replace  
47.3 L.F. ± Asphalt Pavement

Sta. 3+15.5 to Sta. 3+45.6  
Remove and Replace  
30 L.F. ± Asphalt Pavement

Wye Sta.	Elev.
0+17	106.21
0+21	106.66
0+25	107.00
0+29	107.34
0+33	107.68
0+37	108.02
0+41	108.36
0+45	108.70
0+49	109.04
0+53	109.38
0+57	109.72
0+61	110.06
0+65	110.40
0+69	110.74
0+73	111.08
0+77	111.42
0+81	111.76
0+85	112.10
0+89	112.44
0+93	112.78
0+97	113.12
1+01	113.46
1+05	113.80
1+09	114.14
1+13	114.48
1+17	114.82
1+21	115.16
1+25	115.50
1+29	115.84
1+33	116.18
1+37	116.52
1+41	116.86
1+45	117.20
1+49	117.54
1+53	117.88
1+57	118.22
1+61	118.56
1+65	118.90
1+69	119.24
1+73	119.58
1+77	119.92
1+81	120.26
1+85	120.60
1+89	120.94
1+93	121.28
1+97	121.62
2+01	121.96
2+05	122.30
2+09	122.64
2+13	122.98
2+17	123.32
2+21	123.66
2+25	124.00
2+29	124.34
2+33	124.68
2+37	125.02
2+41	125.36
2+45	125.70
2+49	126.04
2+53	126.38
2+57	126.72
2+61	127.06
2+65	127.40
2+69	127.74
2+73	128.08
2+77	128.42
2+81	128.76
2+85	129.10
2+89	129.44
2+93	129.78
2+97	130.12
3+01	130.46
3+05	130.80
3+09	131.14
3+13	131.48
3+17	131.82
3+21	132.16
3+25	132.50
3+29	132.84
3+33	133.18
3+37	133.52
3+41	133.86
3+45	134.20
3+49	134.54
3+53	134.88
3+57	135.22
3+61	135.56
3+65	135.90
3+69	136.24
3+73	136.58
3+77	136.92
3+81	137.26
3+85	137.60
3+89	137.94
3+93	138.28
3+97	138.62
4+01	138.96
4+05	139.30
4+09	139.64
4+13	140.00
4+17	140.36
4+21	140.72
4+25	141.08
4+29	141.44
4+33	141.80
4+37	142.16
4+41	142.52
4+45	142.88
4+49	143.24
4+53	143.60
4+57	143.96
4+61	144.32
4+65	144.68
4+69	145.04
4+73	145.40
4+77	145.76
4+81	146.12
4+85	146.48
4+89	146.84
4+93	147.20
4+97	147.56
5+01	147.92
5+05	148.28
5+09	148.64
5+13	149.00
5+17	149.36
5+21	149.72
5+25	150.08
5+29	150.44
5+33	150.80
5+37	151.16
5+41	151.52
5+45	151.88
5+49	152.24
5+53	152.60
5+57	152.96
5+61	153.32
5+65	153.68
5+69	154.04
5+73	154.40
5+77	154.76
5+81	155.12
5+85	155.48
5+89	155.84
5+93	156.20
5+97	156.56
6+01	156.92
6+05	157.28
6+09	157.64
6+13	158.00
6+17	158.36
6+21	158.72
6+25	159.08
6+29	159.44
6+33	159.80
6+37	160.16
6+41	160.52
6+45	160.88
6+49	161.24
6+53	161.60
6+57	161.96
6+61	162.32
6+65	162.68
6+69	163.04
6+73	163.40
6+77	163.76
6+81	164.12
6+85	164.48
6+89	164.84
6+93	165.20
6+97	165.56
7+01	165.92
7+05	166.28
7+09	166.64
7+13	167.00
7+17	167.36
7+21	167.72
7+25	168.08
7+29	168.44
7+33	168.80
7+37	169.16
7+41	169.52
7+45	169.88
7+49	170.24
7+53	170.60
7+57	170.96
7+61	171.32
7+65	171.68
7+69	172.04
7+73	172.40
7+77	172.76
7+81	173.12
7+85	173.48
7+89	173.84
7+93	174.20
7+97	174.56
8+01	174.92
8+05	175.28
8+09	175.64
8+13	176.00
8+17	176.36
8+21	176.72
8+25	177.08
8+29	177.44
8+33	177.80
8+37	178.16
8+41	178.52
8+45	178.88
8+49	179.24
8+53	179.60
8+57	180.00
8+61	180.40
8+65	180.80
8+69	181.20
8+73	181.60
8+77	182.00
8+81	182.40
8+85	182.80
8+89	183.20
8+93	183.60
8+97	184.00
9+01	184.40
9+05	184.80
9+09	185.20
9+13	185.60
9+17	186.00
9+21	186.40
9+25	186.80
9+29	187.20
9+33	187.60
9+37	188.00
9+41	188.40
9+45	188.80
9+49	189.20
9+53	189.60
9+57	190.00
9+61	190.40
9+65	190.80
9+69	191.20
9+73	191.60
9+77	192.00
9+81	192.40
9+85	192.80
9+89	193.20
9+93	193.60
9+97	194.00
10+01	194.40
10+05	194.80
10+09	195.20
10+13	195.60
10+17	196.00
10+21	196.40
10+25	196.80
10+29	197.20
10+33	197.60
10+37	198.00
10+41	198.40
10+45	198.80
10+49	199.20
10+53	199.60
10+57	200.00
10+61	200.40
10+65	200.80
10+69	201.20
10+73	201.60
10+77	202.00
10+81	202.40
10+85	202.80
10+89	203.20
10+93	203.60
10+97	204.00
11+01	204.40
11+05	204.80
11+09	205.20
11+13	205.60
11+17	206.00
11+21	206.40
11+25	206.80
11+29	207.20
11+33	207.60
11+37	208.00
11+41	208.40
11+45	208.80
11+49	209.20
11+53	209.60
11+57	210.00
11+61	210.40
11+65	210.80
11+69	211.20
11+73	211.60
11+77	212.00
11+81	212.40
11+85	212.80
11+89	213.20
11+93	213.60
11+97	214.00
12+01	214.40
12+05	214.80
12+09	215.20
12+13	215.60
12+17	216.00
12+21	216.40
12+25	216.80
12+29	217.20
12+33	217.60
12+37	218.00
12+41	218.40
12+45	218.80
12+49	219.20
12+53	219.60
12+57	220.00
12+61	220.40
12+65	220.80
12+69	221.20
12+73	221.60
12+77	222.00
12+81	222.40
12+85	222.80
12+89	223.20
12+93	223.60
12+97	224.00
13+01	224.40
13+05	224.80
13+09	225.20
13+13	225.60
13+17	226.00
13+21	226.40
13+25	226.80
13+29	227.20
13+33	227.60
13+37	228.00
13+41	228.40
13+45	228.80
13+49	229.20
13+53	229.60
13+57	230.00
13+61	230.40
13+65	230.80
13+69	231.20
13+73	231.60
13+77	232.00
13+81	232.40
13+85	232.80
13+89	233.20
13+93	233.60
13+97	234.00
14+01	234.40
14+05	234.80
14+09	235.20
14+13	235.60
14+17	236.00
14+21	236.40
14+25	236.80
14+29	237.20
14+33	237.60
14+37	238.00
14+41	238.40
14+45	238.80
14+49	239.20
14+53	239.60
14+57	240.00
14+61	240.40
14+65	240.80
14+69	241.20
14+73	241.60
14+77	242.00
14+81	242.40
14+85	242.80
14+89	243.20
14+93	243.60
14+97	244.00
15+01	244.40
15+05	244.80
15+09	245.20
15+13	245.60
15+17	246.00
15+21	246.40
15+25	246.80
15+29	247.20
15+33	247.60
15+37	248.00
15+41	248.40
15+45	248.80
15+49	249.20
15+53	249.60
15+57	250.00
15+61	250.40
15+65	250.80
15+69	251.20
15+73	251.60
15+77	252.00
15+81	252.40
15+85	252.80
15+89	253.20
15+93	253.60
15+97	254.00
16+01	254.40
16+05	254.80
16+09	255.20
16+13	255.60
16+17	256.00
16+21	256.40
16+25	256.80
16+29	257.20
16+33	257.60
16+37	258.00
16+41	258.40
16+45	258.80
16+49	259.20
16+53	259.60
16+57	260.00
16+61	260.40
16+65	260.80
16+69	261.20
16+73	261.60
16+77	262.00
16+81	262.40
16+85	262.80
16+89	263.20
16+93	263.60
16+97	264.00
17+01	264.40
17+05	264.80
17+09	265.20
17+13	265.60
17+17	266.00
17+21	266.40
17+25	266.80
17+29	267.20
17+33	267.60
17+37	268.00
17+41	268.40
17+45	268.80
17+49	269.20
17+53	269.60
17+57	270.00
17+61	270.40
17+65	270.80
17+69	271.20
17+73	271.60
17+77	272.00
17+81	272.40
17+85	272.80
17+89	273.20
17+93	273.60
17+97	274.00
18+01	274.40
18+05	274.80
18+09	275.20
18+13	275.60
18+17	276.00
18+21	276.40
18+25	276.80
18+29	277.20
18+33	277.60
18+37	278.00
18+41	278.40
18+45	278.80
18+49	279.20
18+53	279.60
18+57	280.00
18+61	280.40
18+65	280.80
18+69	281.20
18+73	281.60
18+77	282.00
18+81	282.40
18+85	282.80
18+89	283.20
18+93	283.60
18+97	284.00
19+01	28

Site No.	Sta.
8	0+03
8	0+05
8	0+28
8	0+30
8	0+53
8	0+55
8	0+78
8	0+80
8	1+03
8	1+05
8	1+28
8	1+30
8	1+53
8	1+55
8	1+78
8	1+80
8	2+03
8	2+05
8	2+28
8	2+30
8	2+53
8	2+55
8	2+78
8	2+80
8	3+03
8	3+05

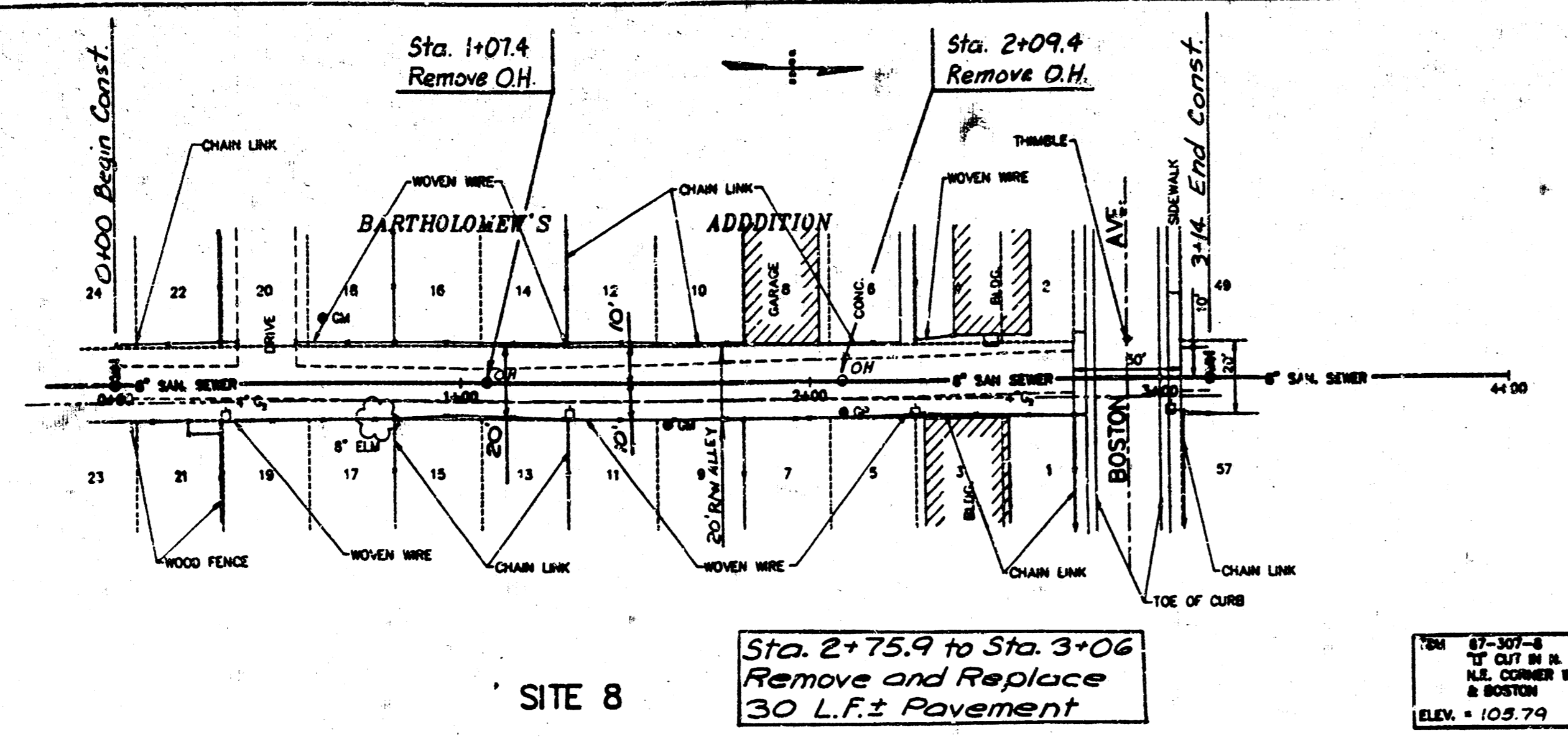

SITE 8  
Sta. 2+75.9 to Sta. 3+06  
Remove and Replace  
30 L.F. Pavement

SEE 87-307-10  
CUT IN S.E. COR.  
N.E. CORNER MOSELY  
& BOSTON  
ELEV. = 109.74

Site No.	Wgt. Sta.
9	0+7.5
9	0+25
9	0+31
9	0+33.5
9	0+58
9	0+60.5
9	0+83
9	0+85.5
9	1+07.5
9	1+10
9	1+34.5
9	1+37
9	1+58
9	1+60.5
9	1+84.3
9	1+86.8
9	2+08.5
9	2+11

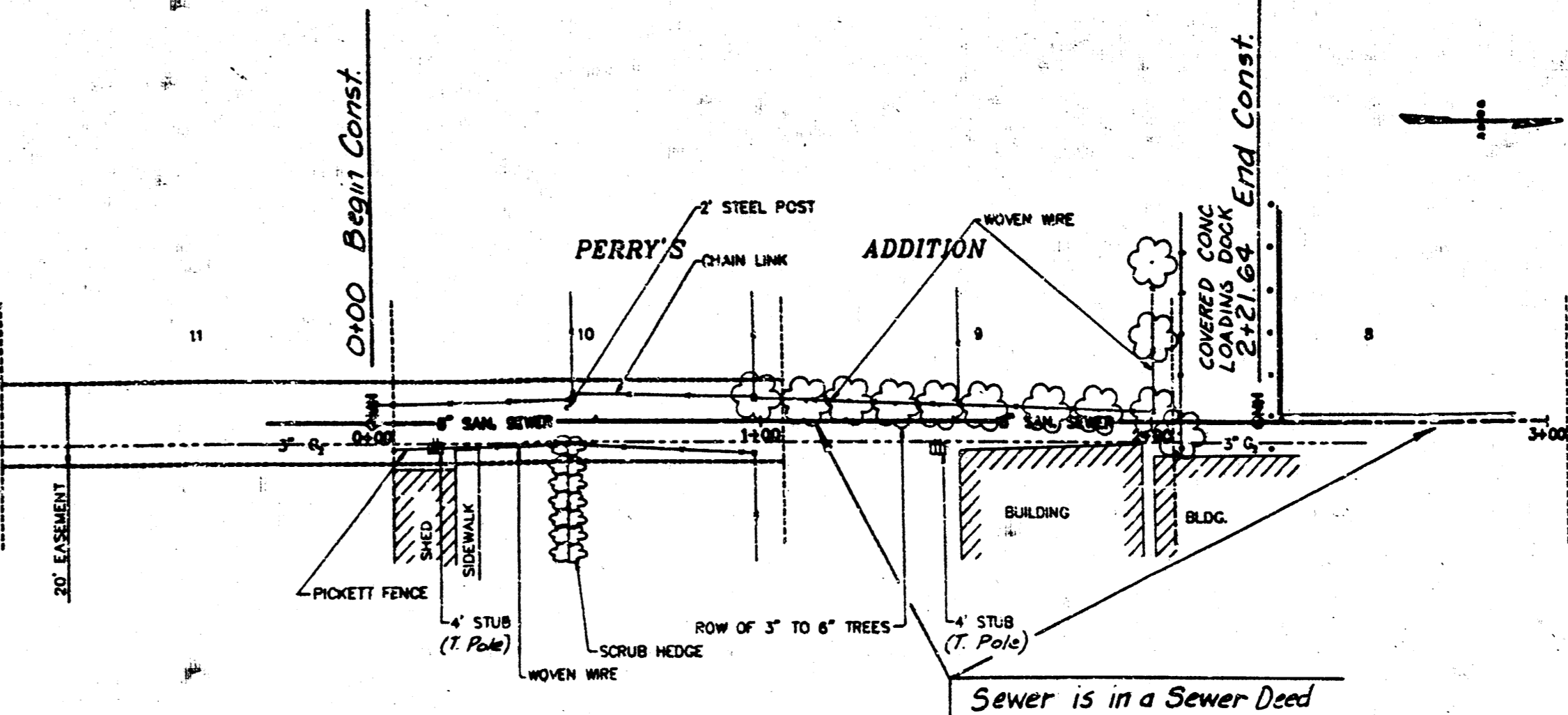

SITE 9  
Sewer is in a Sewer Dead  
Recorded in Dead Book 118  
Pages 258, 336 and 397

SCALE IN FEET

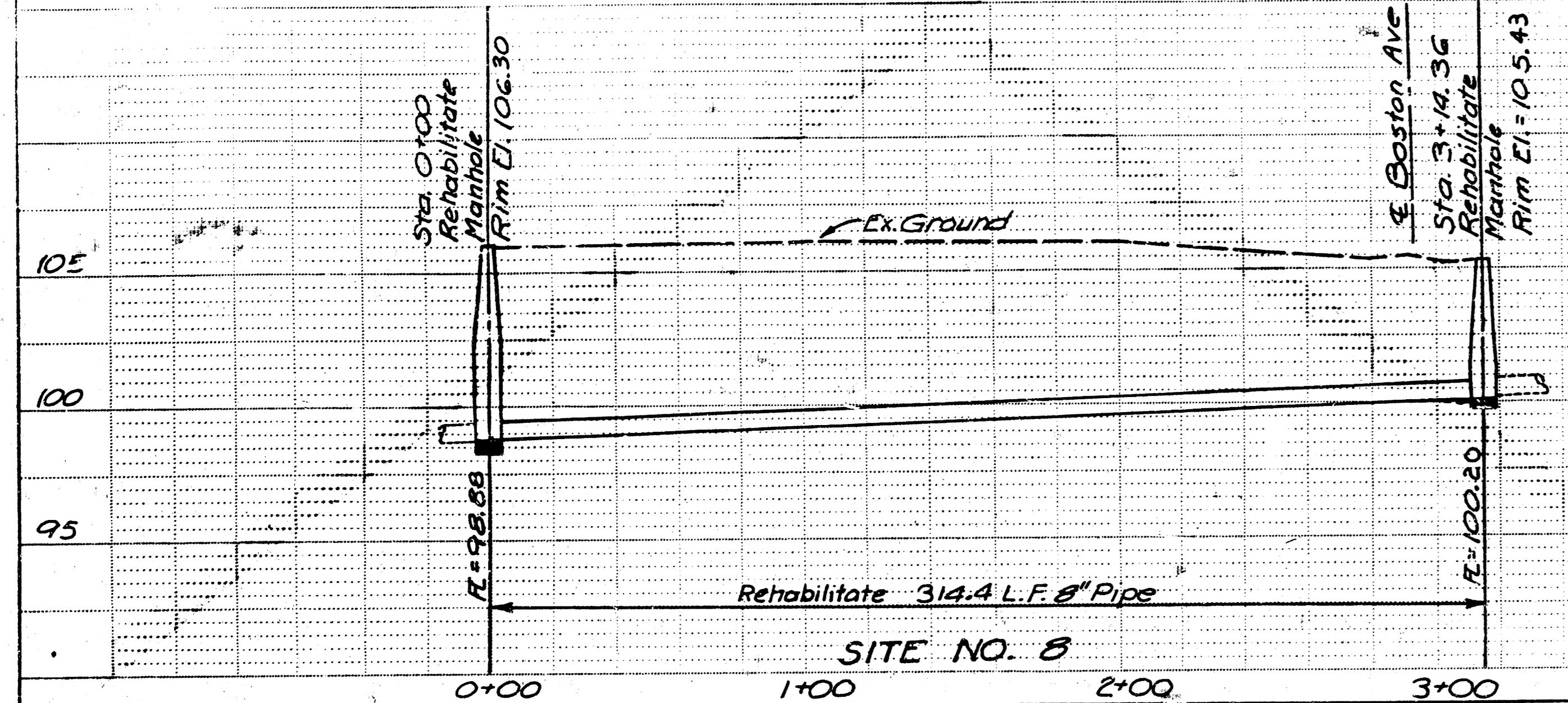

SITE NO. 8

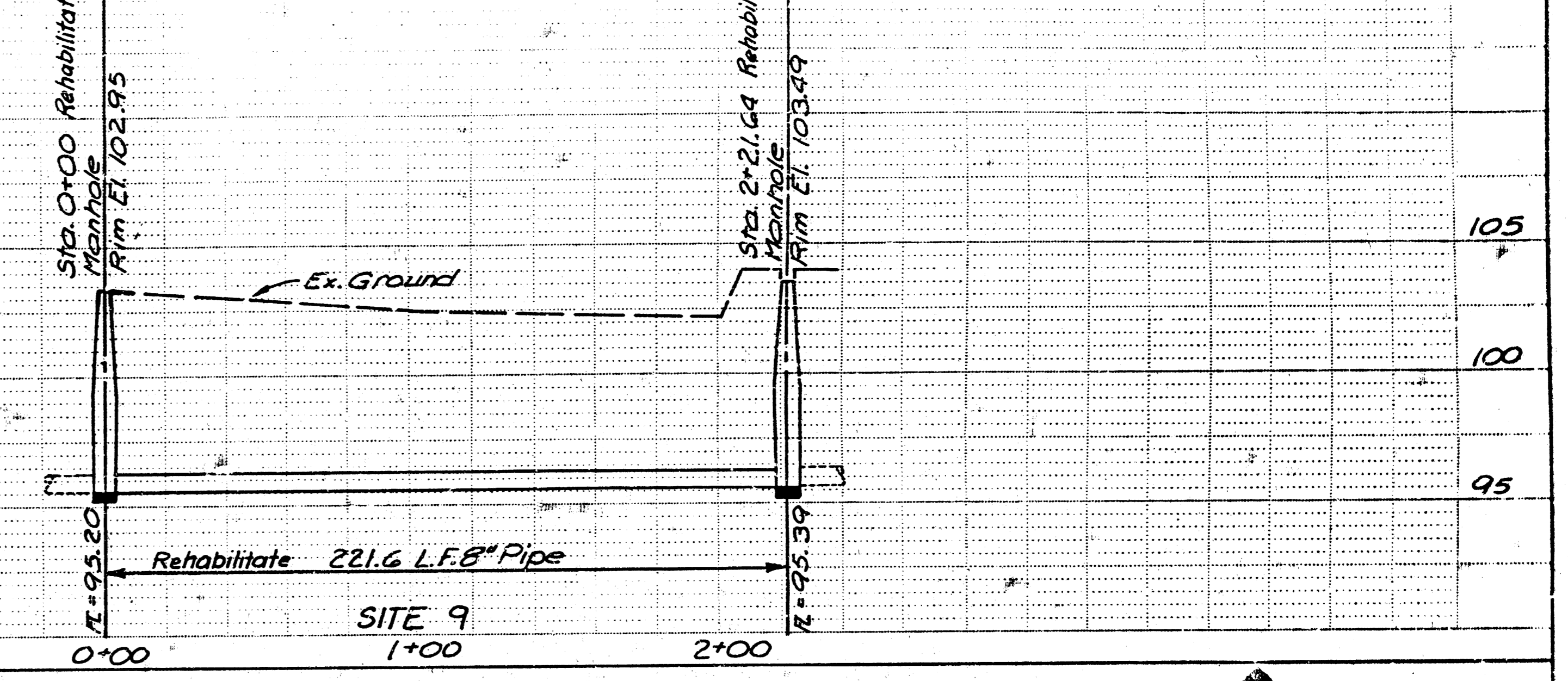

SITE 9

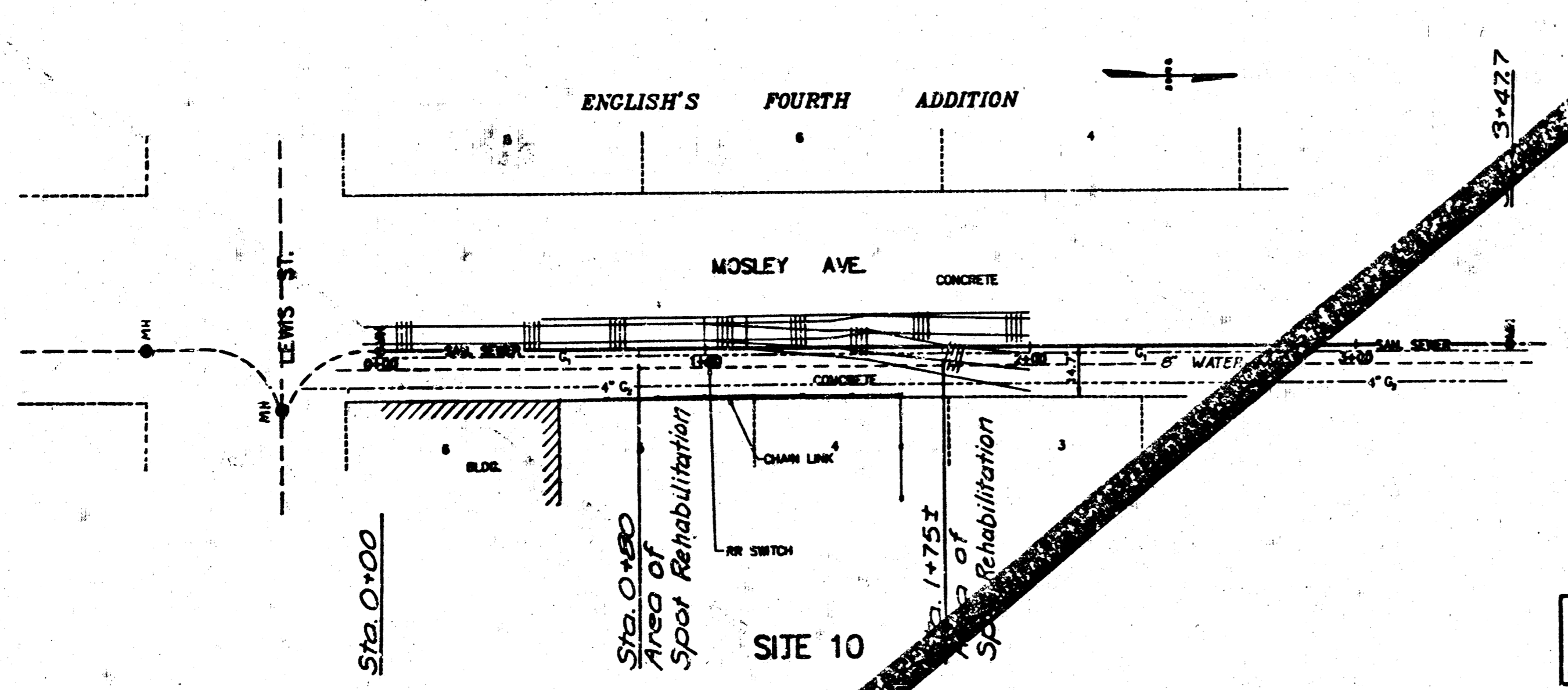

SITE 10

SEE 87-307-10  
CUT IN S.E. CORNER  
(CORNER) LINES @  
MOSELY  
ELEV. = 109.82

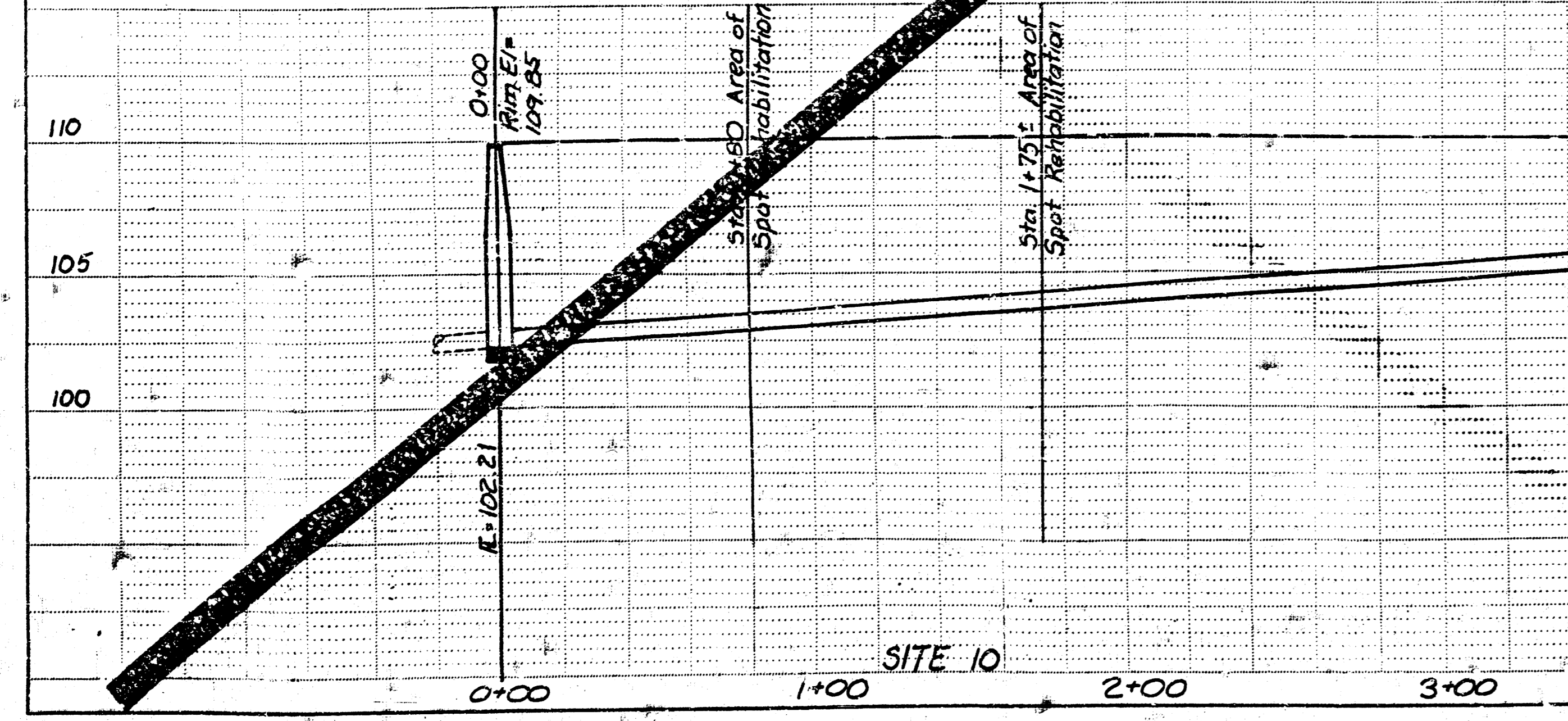

SITE 10

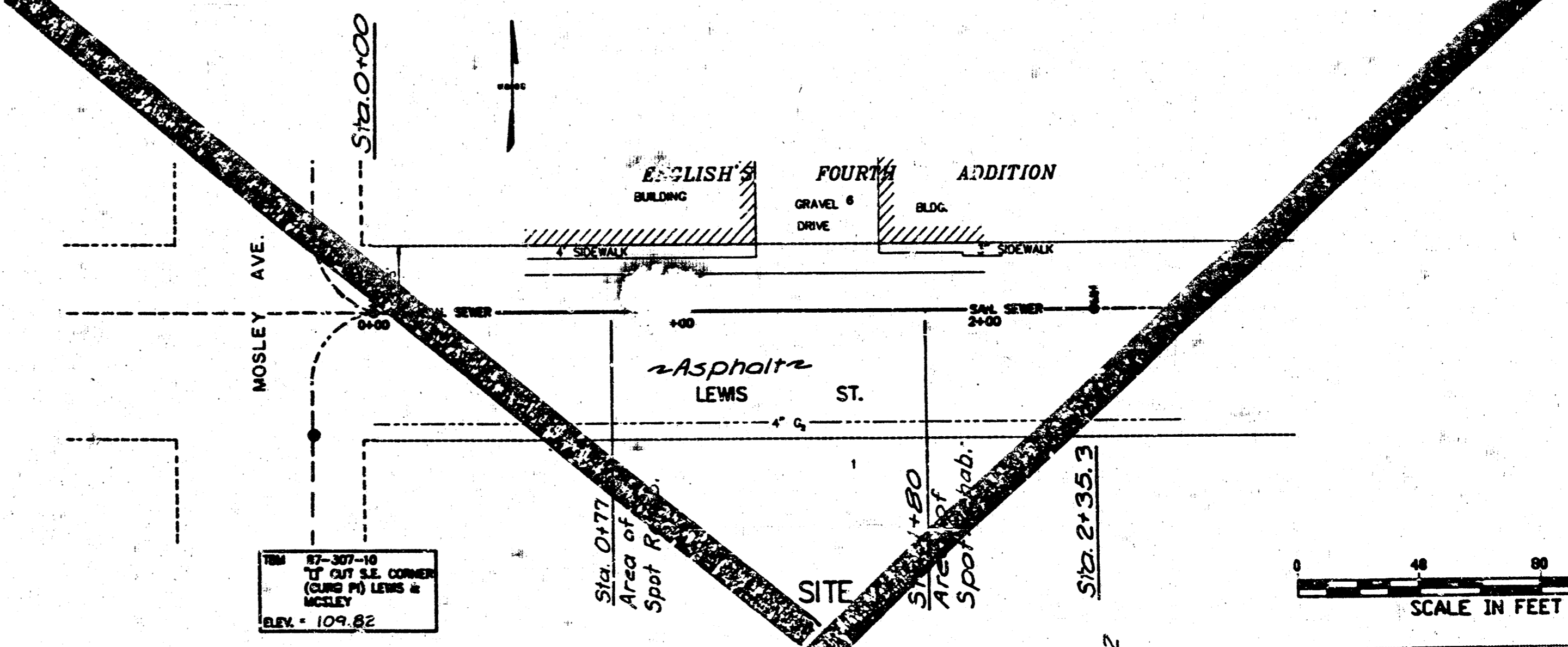

SITE 11

SEE 87-307-10  
CUT IN S.E. CORNER  
(CORNER) LINES @  
MOSELY  
ELEV. = 109.82

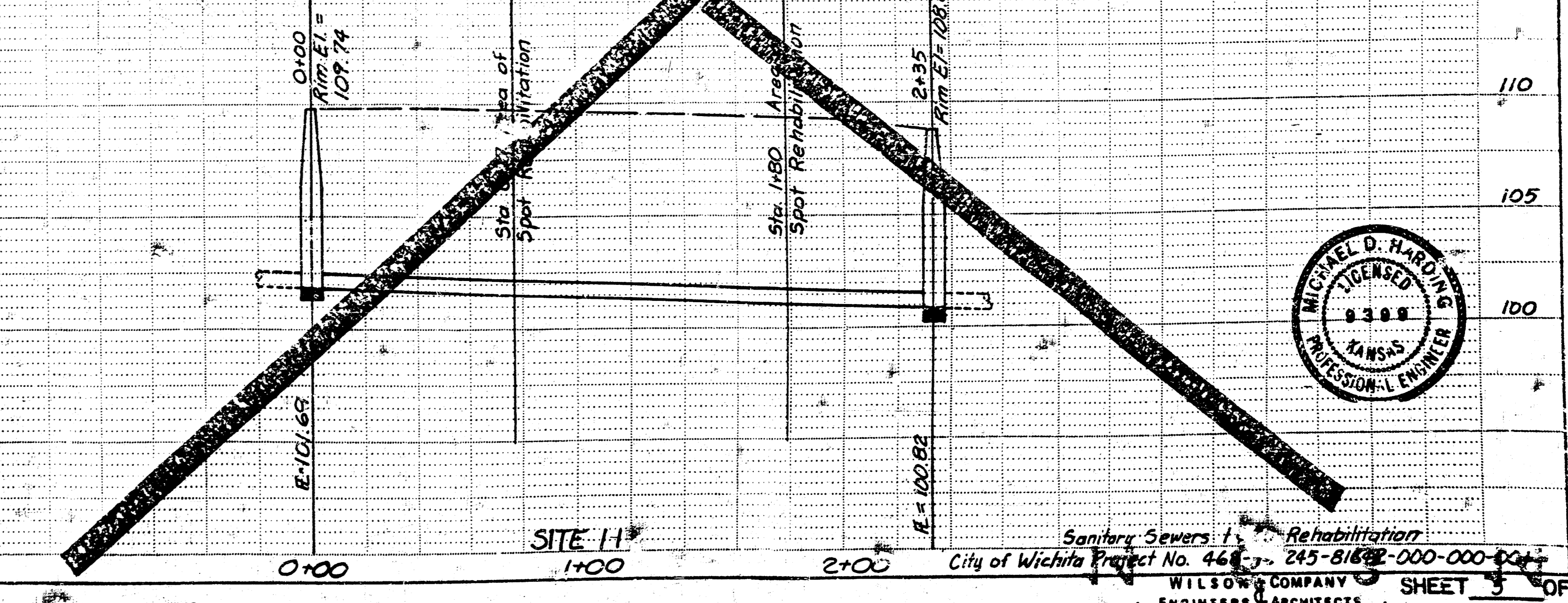

SITE 11



SCALE IN FEET