

B.M. 103,725 R.R. Spike on S. side P. Pole NE Cor Pawnee & Sheridan.
 B.M. 104,155 R.R. Spike on S. side P. Pole on N. side Pawnee Sta. 6115.

Survey No. J.E.G. 008
 Plan by J.E.G.
 Dated 12/1/64

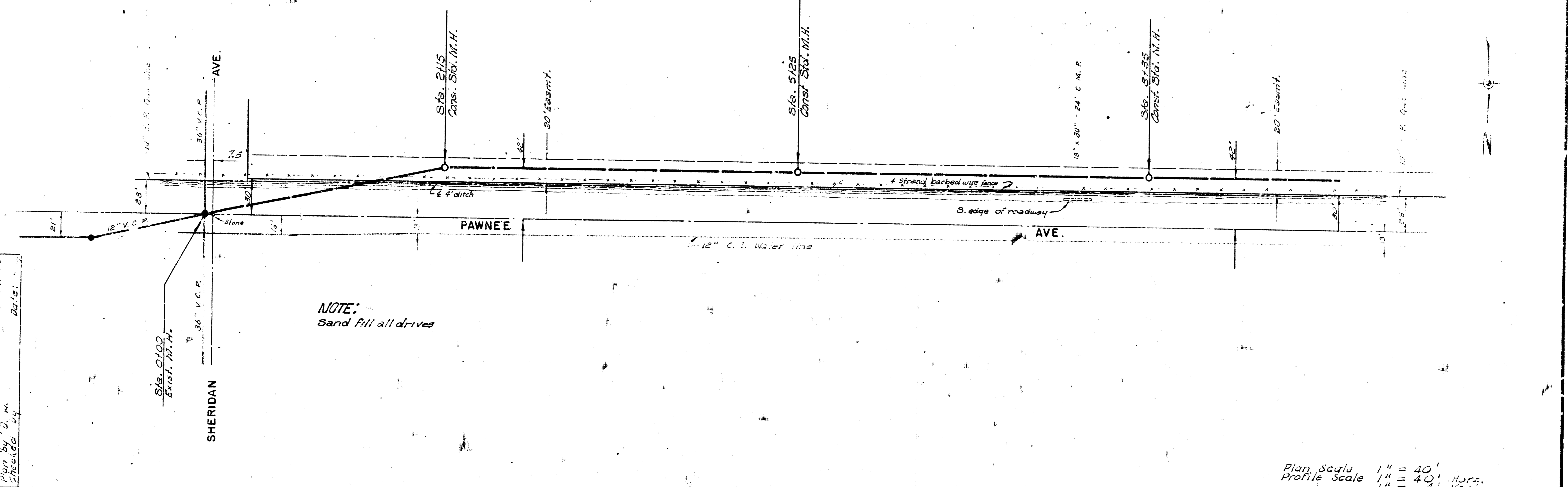

NOTE:
 Sand fill all drives

Plan Scale 1" = 40'
 Profile Scale 1" = 40' Horiz.
 1" = 4' Vert.

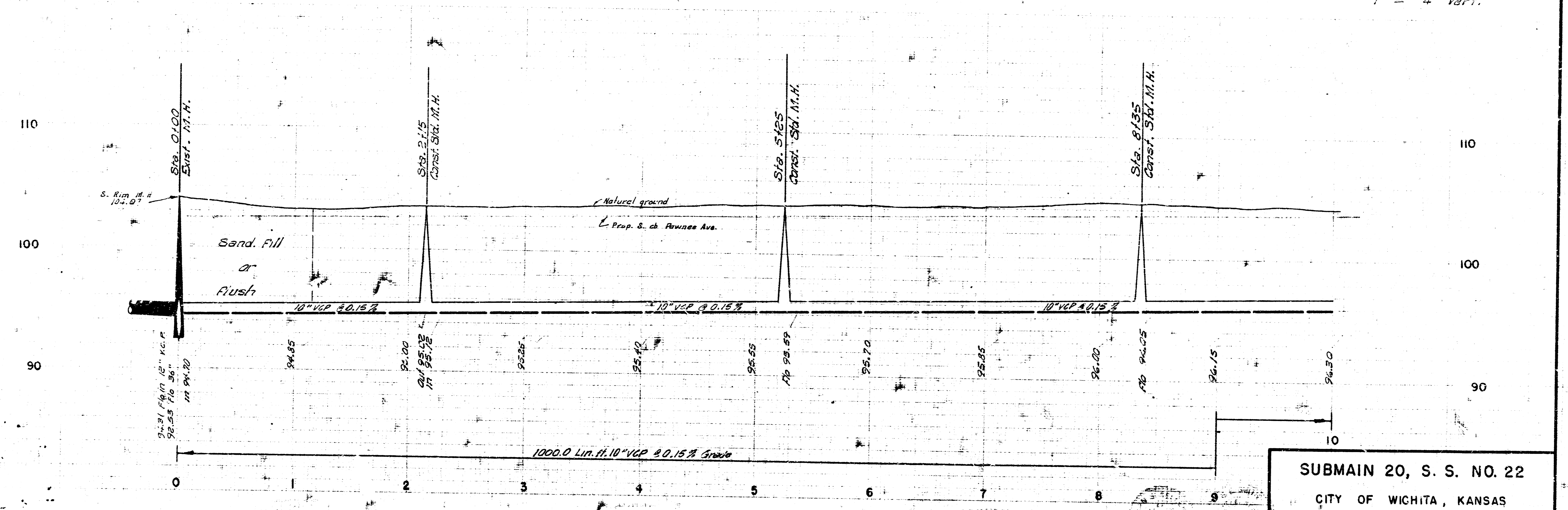

SUBMAIN 20, S. S. NO. 22
 CITY OF WICHITA, KANSAS
 B. E. SMITH CITY ENGINEER
 AUG. 1964 PROJECT NO C24-8

B. M. 104.455 R. R. Spike on S. side P. pole on N. Side Pawnee Sta. 12+35.
 B. M. 105.32 R. R. Spike on S. side P. Pole on N. side Pawnee Sta. 19+70.

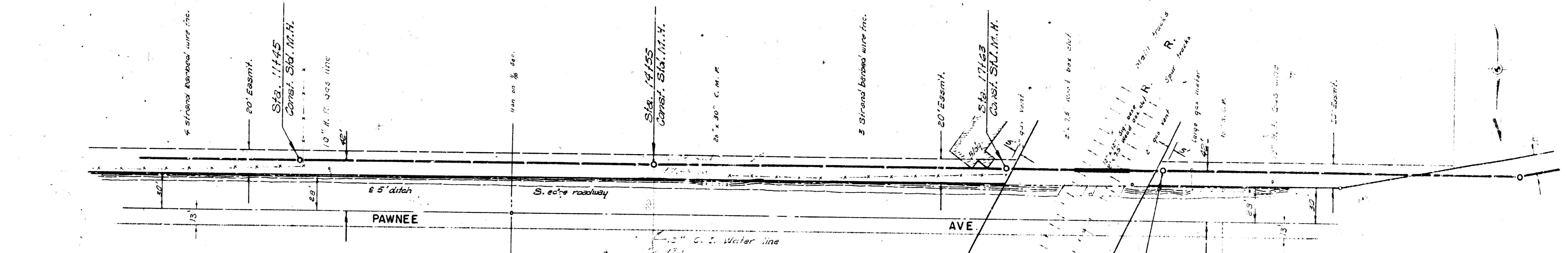

NOTE:
 10" C. I. P. to be placed under R. R. by augering and jacking pipe into place. Augered hole to be cased with 21" diameter steel pipe. Good (in the judgement of the field Eng'r.) used steel pipe will be acceptable for casing. 4 sack conc. to be used to fill space between C. I. P. and the casing. The bid of 10" C. I. P. shall include augering, casing, and 4 sack conc.

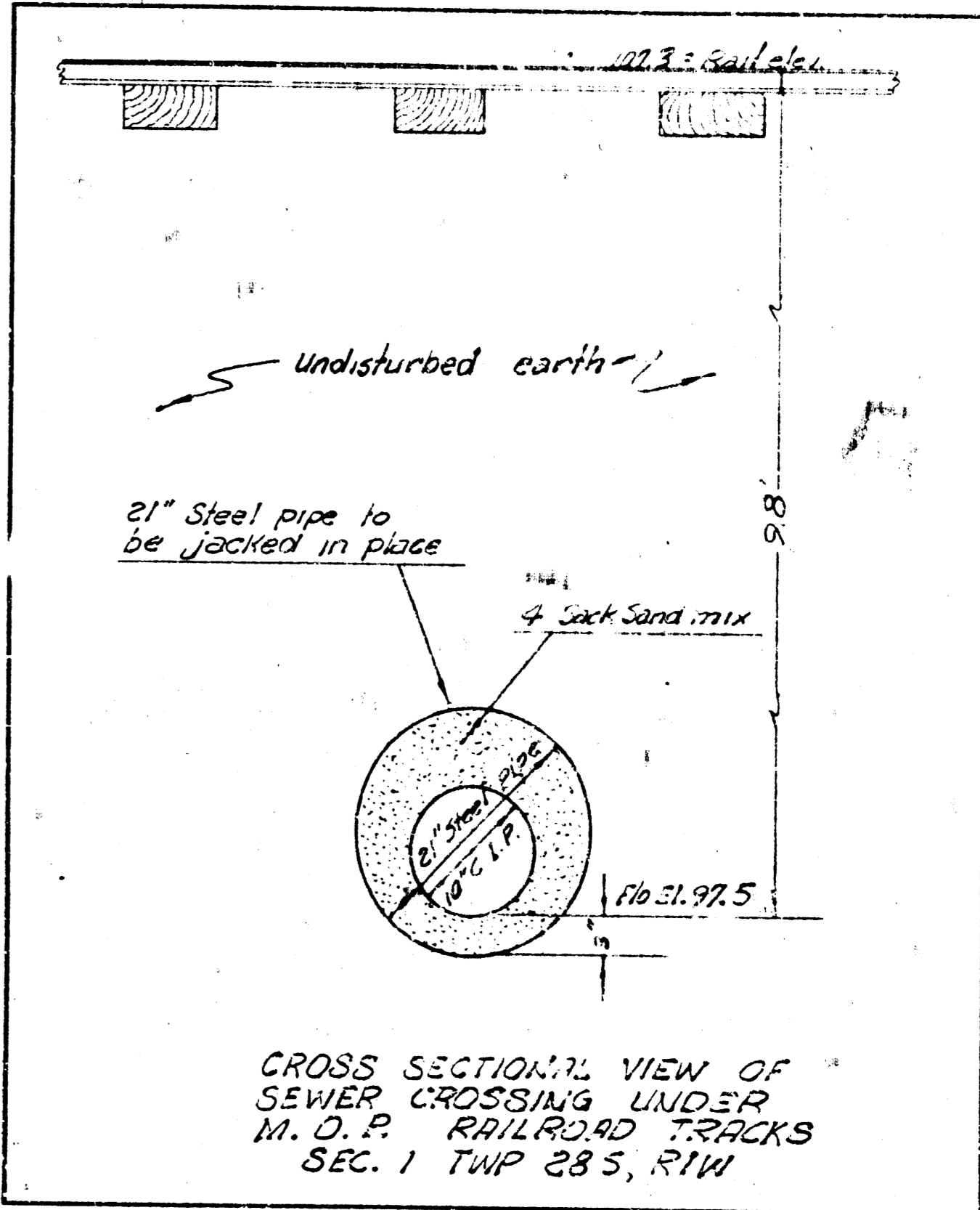
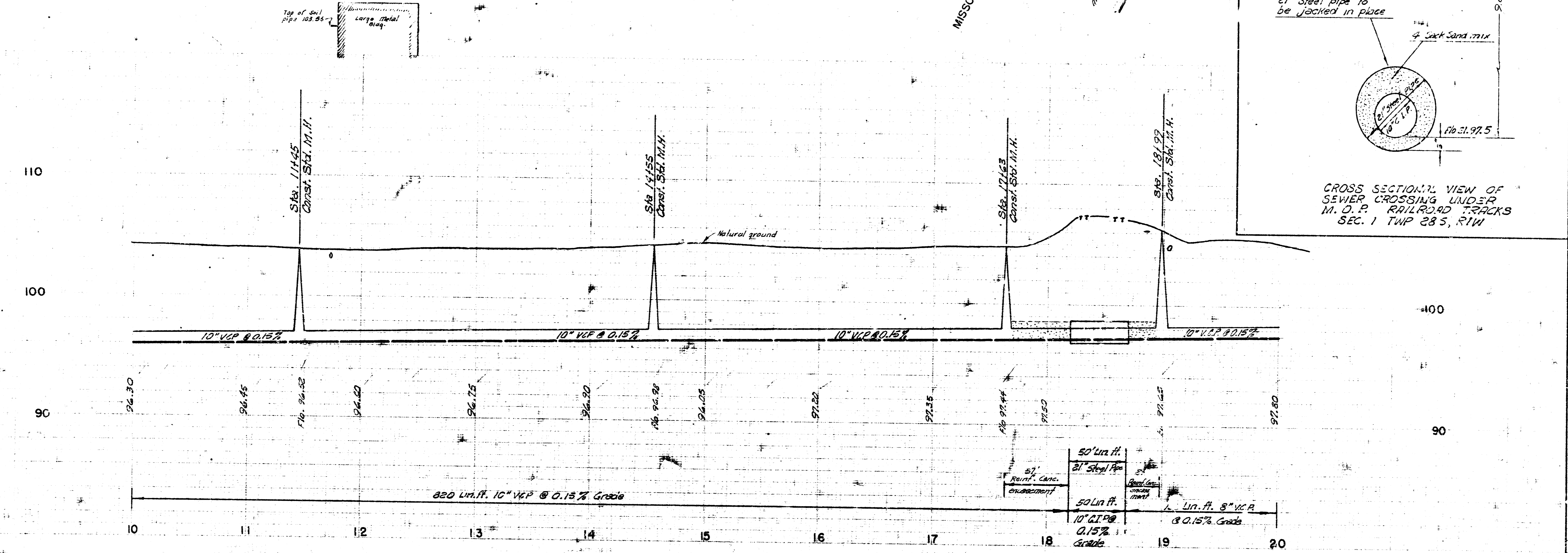

B. M. 109.495 chisled "a" on E conc. pvt. C slab of K-42 at WL West St.
 B. M. 109.43 City Sid. B. M. in ctr. Island on E West St. 495' N. 6" iron on E Pawnee east.

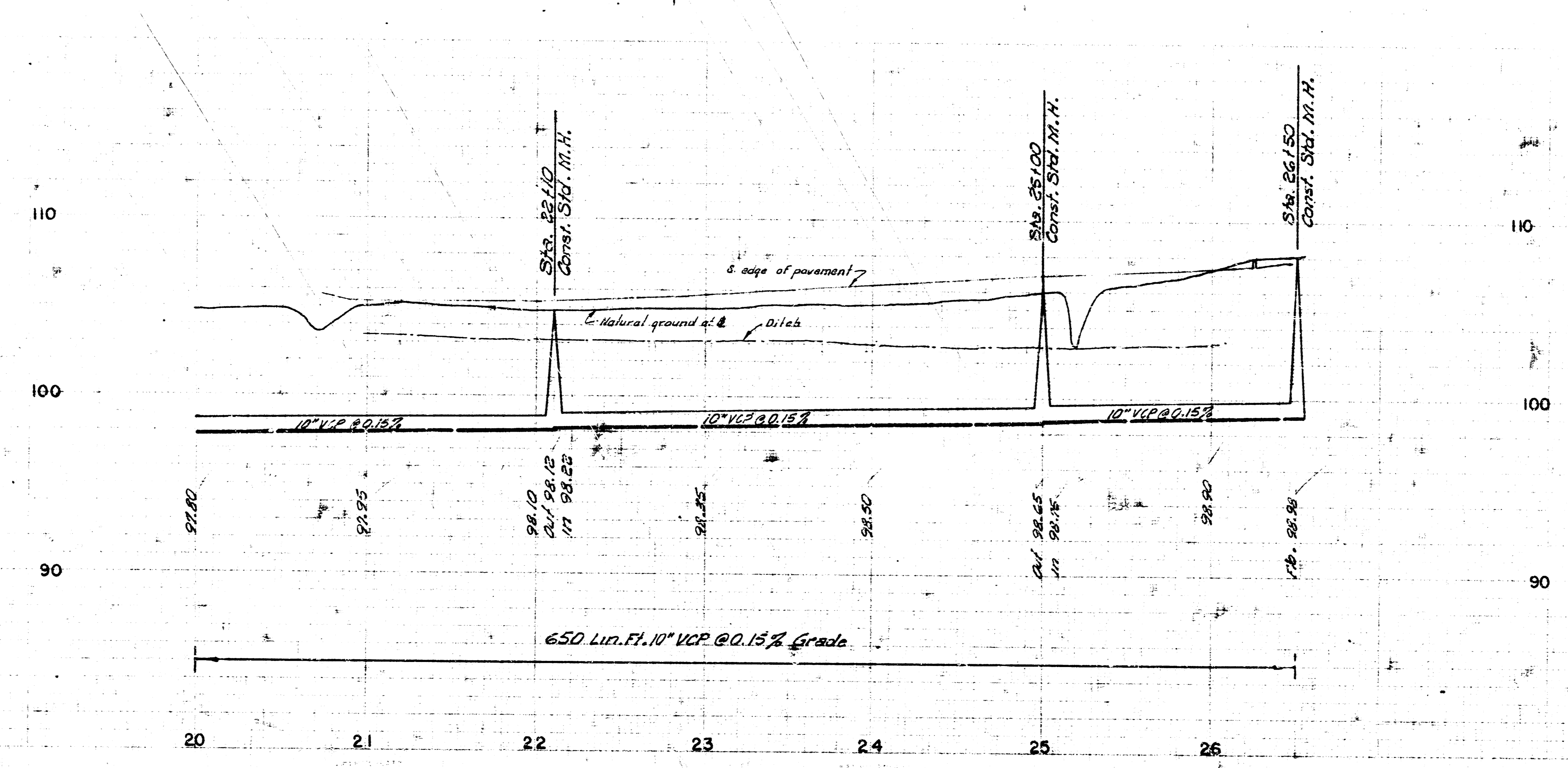
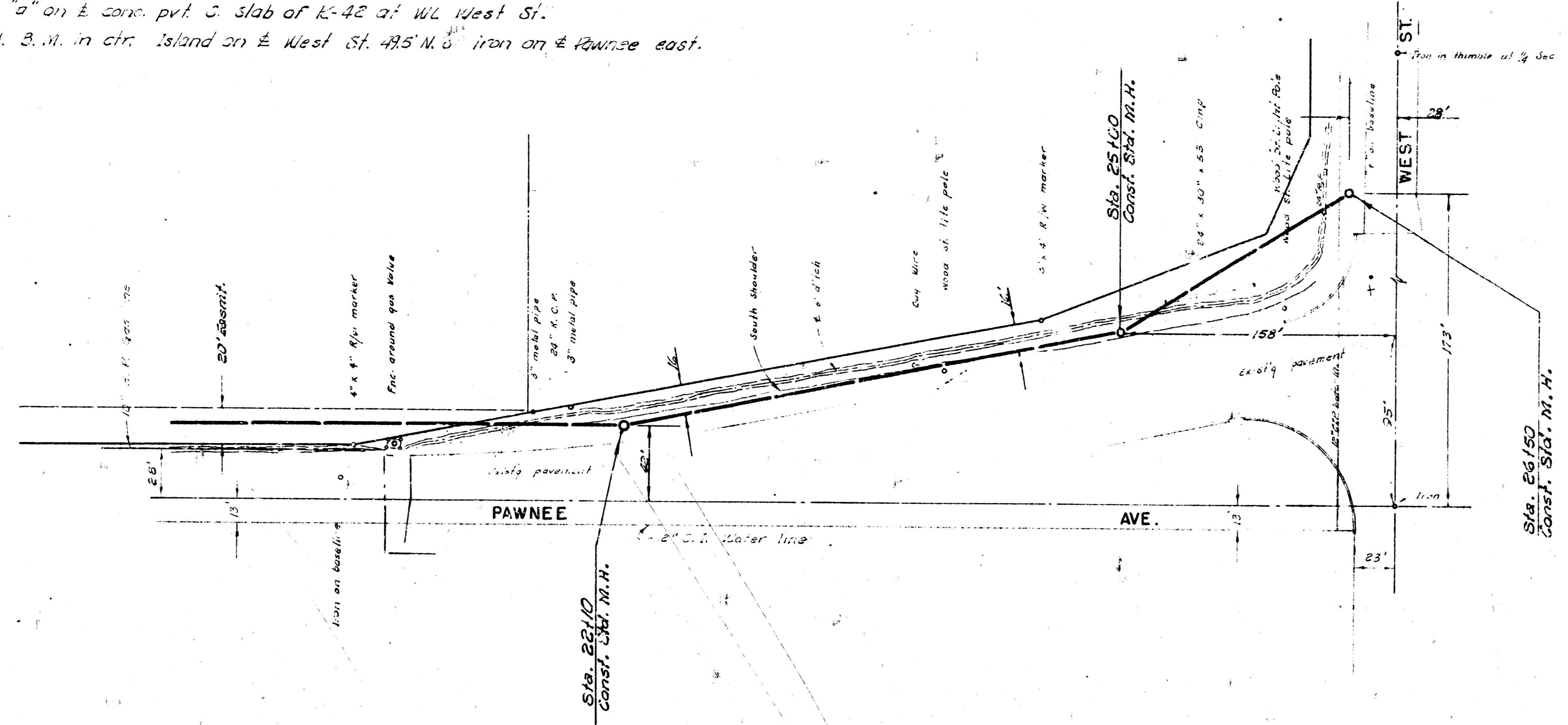

3/3

SUBMAIN 20, S. S. NO. 22
 PROJECT NO. C24-8

9 10 3