

MAIN A - HARRY TO ZIMMERLY
S.S. #1 - 1889

Plot 9-58

TRAP AREA

RECONSTRUCT SANITARY SEWER
1420, PHASE III
PROJ. NO. 468-81996 (#630541)
BUILT BY W. B. CARTER CONST. CO.
BOOKED 5-3-95 FROM AS BUILTS

RECONNECTIONS

STA.	ADDRESS	DIRECTION
6+91	No Address	West
6+44	No Address	East
6+41	No Address	West
5+94	No Address	East
5+91	No Address	West
5+56	No Address	West
5+43	No Address	West
5+41	No Address	East
4+97	No Address	East
4+47	No Address	East
4+22	No Address	West
4+08	No Address	East
3+96	No Address	West
3+94	No Address	East
3+64	No Address	West
3+38	No Address	East
1+20	No Address	East

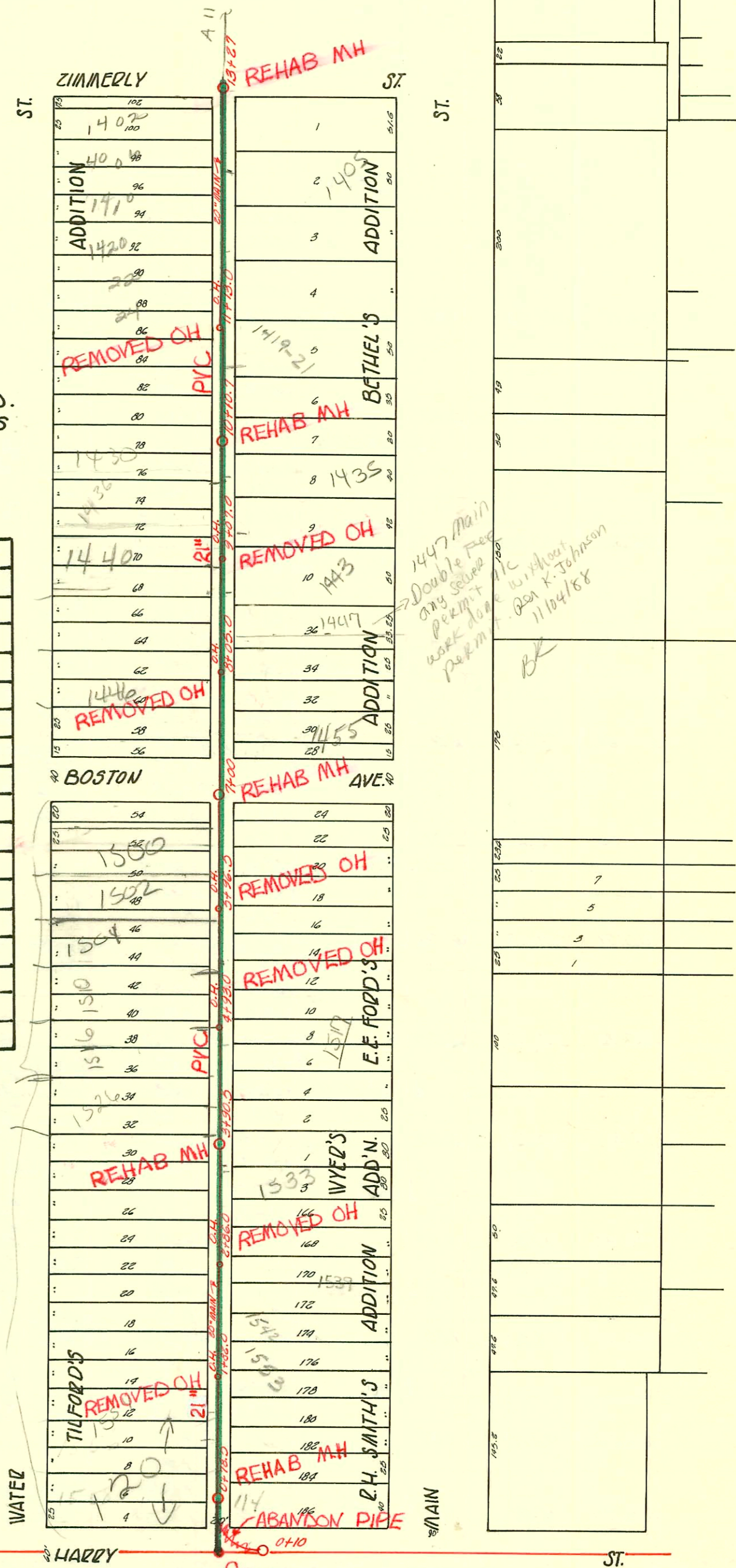

1999-00488-8/24/99-120 W Harry - David Lies- 4" sch 40, Tied to bldg swr - ITWIN co, 1V45, 1 COMB
99-4386-7 - 3/15/99- 1533 S Main - AE Henning 4" sch 40 - Repl Lower 10' of line to point 6' from main

99-13227-7 - 6/25/99- 1401 S Main - Coah No Leaks - 4" sch 40 - Repl all but upper 35' of line, 4" trap installed

2002-00693 - 3/13/02 - 1446 S. Water - Bamms Plog 4" Pvc 40 Replaced all but lower 8' - Shallow - ITWIN Co @ House, 3H45, trap installed - no msmt

2002-01751- 6/24/02 - Coah No Leaks - 4" pvc 40 Replaced all but lower 10', ITWIN co @ house, 2H45, 8' sof NPL

97-943-7 9/2/97 A E Henning - Repl 20' section to point 2' from Main & Repl 4' section at house incl. 4" trap - 4" sch 40 PVC

CONSTRUCTION RECORD						SERVICE RECORD						
STATION	ELEVATION		Depth	MANHOLE	4-INCH "Y" BRANCHES		No. of Permit		House Number		DATE OF PERMITS	
	Ground	Grade			North West	South East	North West	South East	North West	South East	North West	South East
				+27								
13	107.65	97.94	9.71		+20.8	+22.8	# 239		140 S. WATER		6-12-16	
					+02	+04	# 314		115 W. WATER		6-23-24	
					12+77	12+79		# 99-13227-7	140 S. WATER	140 S. MAIN	See next pg	6-25-99
					12+58	12+54	# 1221	# 7516125	140 S. WATER	140 S. MAIN		5-25-11
12	107.37	97.84	9.53		+40.2	+40.4	# 394	# 250	142 S. WATER	142 S. MAIN	12-8-21	12-10-06
					+77	+79	# 163		142 S. WATER		4-6-09	5-18-20
					+52	+54						
				+13 O.H.	+27	+29	# 261		117 S. MAIN			4-7-21
11	107.20	97.74	9.46		+10.2	+10.4	# 1375	# 18188	142 S. WATER	142 S. MAIN	9-26-29	4-23-27
					+77	+79	# 268	# 358	142 S. WATER		5-7-17	1-25-09
					+52	+54		# 933				8-2-22
					+27	+29	# 137	# 1792437	143 S. WATER	143 S. MAIN	3-16-10	6-9-97
10	107.26	97.64	9.62	+10.7	+10.2	+10.4	# 250	# 174	143 S. WATER		10-31-08	3-16-21
					+77	+79		# 129				3-8-22
					+52	+54	# 124	# 1856	144 S. WATER	144 S. MAIN	11-20-97	3-8-22
9	107.27	97.54	9.63	+07 O.H.	+02	+04	# 401	# 90	144 S. WATER		6-3-05	
					+77	+79	# 124				7-10-05	
					+52	+54	# 441	# 1071 1/2	144 S. WATER	144 S. MAIN	7-20-14	10-27-19
					+26	+28	# 584	# 1089	144 S. WATER	144 S. MAIN	3-14-09	7-21-19
8	106.77	97.44	9.33	+40.5 O.H.	+03	+07	# 188	# 1284	144 S. WATER	144 S. MAIN	3-14-09	1-27-09
					+76.5	+78.5		# 368			3-10-20	
					+51.5	+53.5						
					+26.5	+28.5						
7	106.36	97.34	9.02	+40.0	+04.5	+06.5	# 1415		150 S. WATER		12-17-19	
					+77	+79	# 855		150 S. WATER		11-21-17	
					+50	+52		# 122		150 S. MAIN		6-8-08
					+25	+27						
6	105.38	97.24	8.14		+40.0	+40.2	# 1180	# 229	150 S. WATER	150 S. MAIN	9-12-22	4-16-10
					+96.5 O.H.	+75	# 1038	# 89	150 S. WATER		7-16-23	2-9-22
					+50	+52		# 91				3-2-10
					+25	+27						
5	105.11	97.14	7.97		+40.0	+40.2		# 23072		151 S. MAIN		5-4-21
					+93 O.H.	+75	# 644	# 447	No Record		7-18-11	7-19-09
					+50	+52						
					+25	+27						
4	104.40	97.04	7.36		+40.0	+40.2	# 160		1530 S. WATER		7-21-08	
					+85.5	+85.5	# 399		153 S. MAIN		7-5-18	
					+75	+75	# 118	# 598	1530 S. WATER	1533 S. MAIN	3-8-10	3-15-99
					+50	+50	# 1256		1536 S. WATER		12-15-21	11-9-10
					+25	+25						
3	104.21	96.94	7.27		+40.0	+41.4	# 2783		1537 S. MAIN		10-18-40	
					+86 O.H.	+75	# 487	# 140	154 S. WATER	1539 S. MAIN	5-31-11	2-8-28
					+50	+55		# 351			6-6-10	
					+25	+30		# 1824		1549 S. MAIN		9-28-49
2	104.62	96.84	7.78		+40.0	+40.5	# 192		1550 S. WATER		8-25-08	
					+82 O.H.	+90.0	# 419		1543 S. MAIN		6-20-17	
					seal off	+75	# 279	# 18	1554 S. WATER		4-15-20	
					+50.5	+65	# 217	# 23645	1556 S. WATER	see next pg	4-23-09	
					+25.5	+40.5	# 23645	# 236	120 W. HARRY	1537 S. MAIN	8-24-21	5-18-15
1	104.73	96.74	7.99		+40.5	+45.5						
					+90.5	+90.5	# 27		1555 S. WATER		1-11-22	
0	104.10	96.64	7.46	+78.5	+83.5	+81.5	# 389		1555 S. MAIN		3-20-23	

1663 - Top - 112-114 W. Harry - 6-19-39 - A.L. Lansdowne

1697 - Used old connection - 120 W. Harry - 3-2-48 - P.C. Fish

15959 seal off 1556 S. water - Bowers Pllg 7-30-62

B544 - Seal off - 1558 S. Water - Bowers Pllg - 12-9-63

C46081 - 1420 S. water - 8-2-74 - Exp. - Kime Pllg.

- # 21935 - 11/15/88 - 1447 S. Main - Herndon

97183567 10-20-97 1440 S. Water (Cov. sewer main Div)