

Plat 9-49

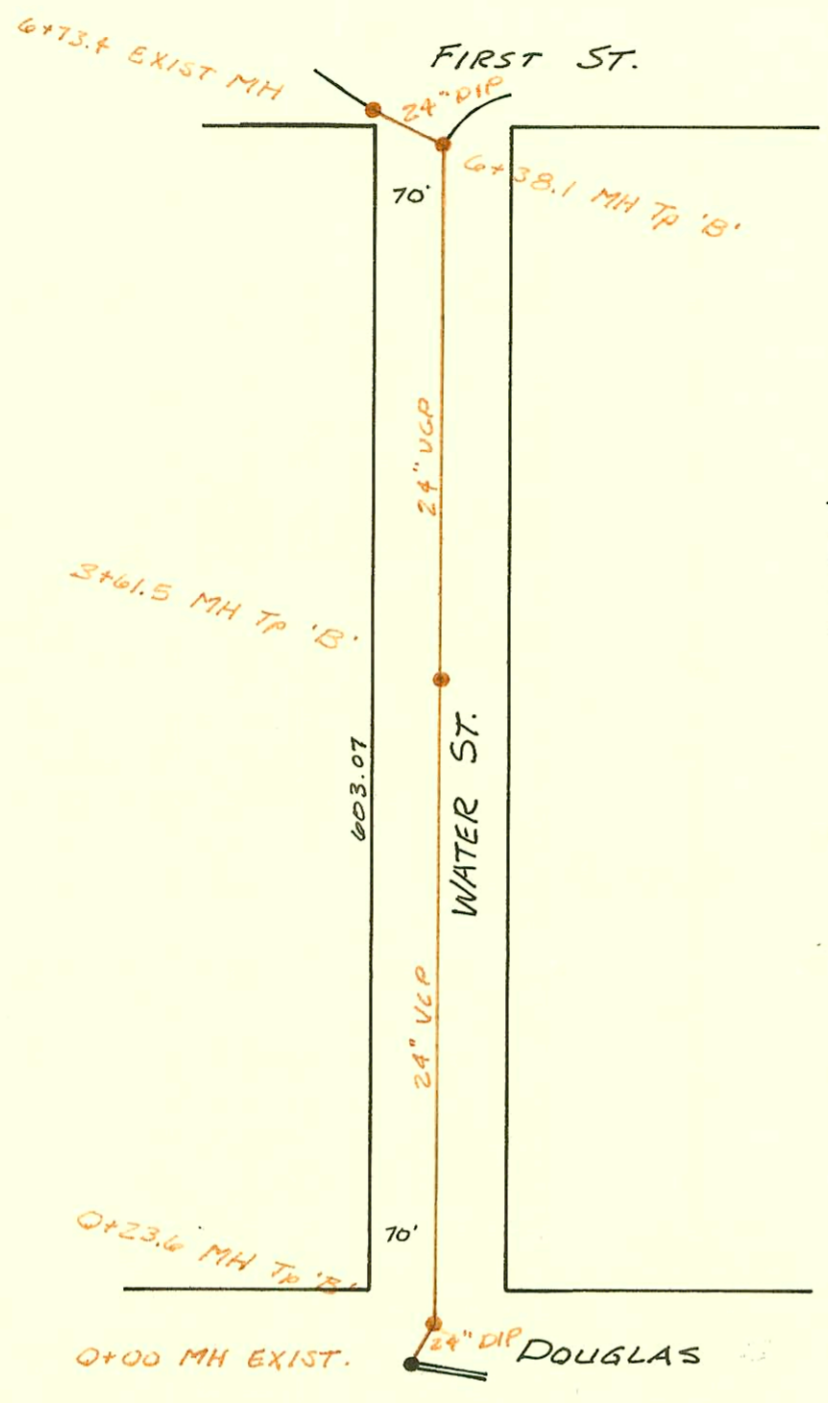

Sewer Rehab & Mosley Relief Sewer
 Dist. 1 & 20, North of Douglas
 468-80-990-80271-000-000-001
 Built By Stannard Const.
 Booked 8-13-85 - From BR-117

CONSTRUCTION RECORD						SERVICE RECORD						
STATION	ELEVATION		Depth	MANHOLE	4-INCH "Y" BRANCHES		No. of Permit		House Number		DATE OF PERMITS	
	Ground	Grade			North West	South East	North West	South East	North West	South East	North West	South East
Sewer Rehab. Dist 1 & 20												
Sewer in Water from Douglas to First												
0+00	112.03	104.18	7.9	0+00 EXIST								
	111.85	104.55	7.3	0+23.6								
1+00	112.03	104.62	7.4									
					1+46 6" SERV. W						11-20-84	
2+00	112.21	104.71	7.5									
					2+58 6" SERV. W						11-20-84	
3+00	112.39	104.80	7.6									
	112.5	104.85	7.7	3+61.5	10" VCP W						11-20-84	
4+00	112.6	105.0	7.6									
5+00	112.85	105.0	7.9									
6+00	113.10	105.0	8.1									
	113.20	105.00	8.2	6+38.1								
	113.15	105.10	8.1	6+73.4								