

WEST SUB MAIN "A" ON TWELFTH ST. & LAT. N. & S. S.S. #1-1889

TRAP AREA

Plat 9-43

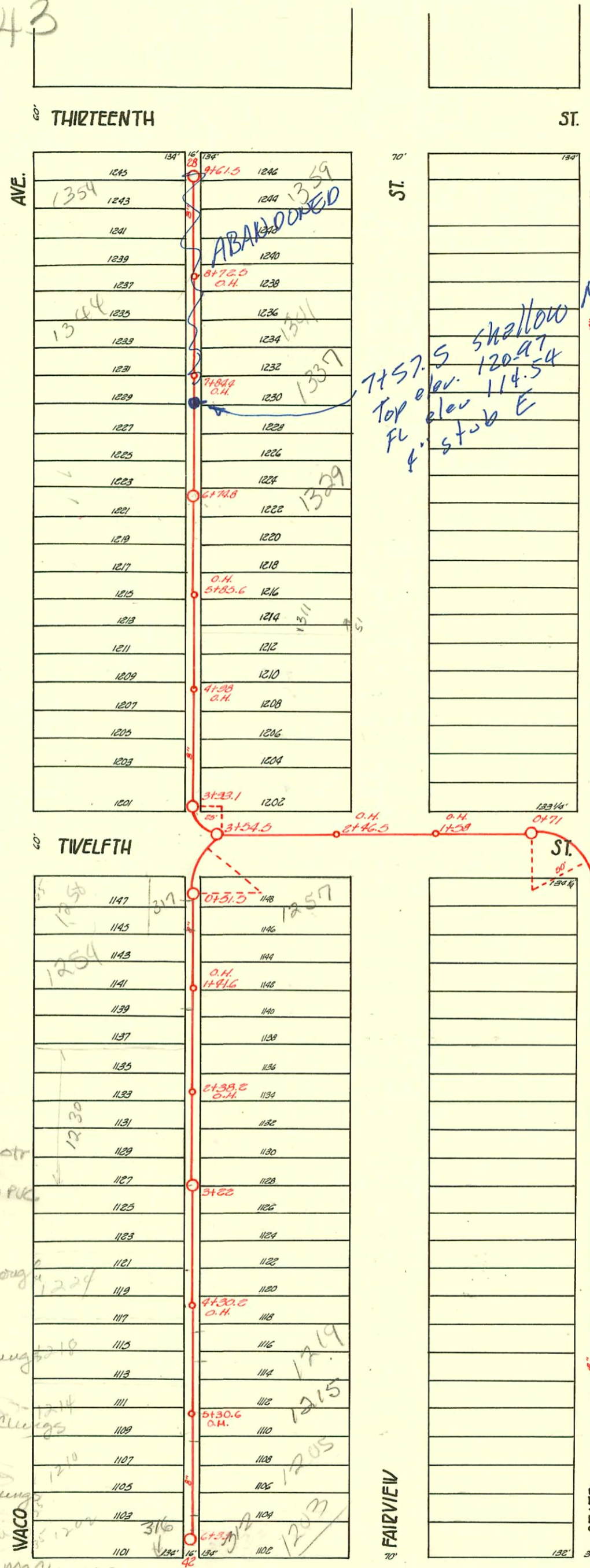

S.S. to serve lot 1 Bencor 2nd Addn Proj. No. 997 PPS Built By McCulloog Exc. Booked 3-23-01 per AsBuilt

MH Tap 'P'

7157. Top elev. 120.54 Fl. elev. 114.5 stop E

2006-00280-1241 Fairview-Barnes 6" stub NE, CID box + Fernco Repair

2002-02602-1254 N Waco- Redd Root 2 Kickouts, 3 Fernco, 17 Twinco, 2 H45, 2-6" Dir Clo, 1-6x4 wye, 6" SCH 40 PVC

1358 N Waco abandoned w/ line per Jess McCulloog 121100 #997 PPS

2000-01464 6-20-2000 1344 N Waco s/d 105' S of MH 9+61.5 (8156.5) McCulloog

2000-01467 6-20-2000 1331 N Fairview s/d 250' S of MH 9+61.5 (7+11.5) McCulloog

2000-01466 6-20-2000 1337 N Fairview s/d 188' S of MH 9+61.5 (7+73.5) McCulloog

2000-01465 6-20-2000 1359 N Fairview s/d 30' N of OH MH 8+27.5 (9+02.0) McCulloog

99-4894-7 - 3/23/99- 1257 N Fairview- Ark Valley- Tap 4' S of MH 6" Predco - don't know where 6" line went to 1-6" 45, 1-6" 22, 2-6" PVC saddle - SWR hit by Ark Valley sewer Maint has put saddle on main + Ark Valley repaired bldg SWR # 24216 11-2-89 1203 N Fairview City Tap 30.5' W of MH (old line tied into other house to west (312 w 11th) 41' N of MH - disconnected by DL Nothing tied into wye 19' S of MH 6259)

2000-01156 5-9-00 1219 N Fairview - Ark Hearings - 4" PVC - Tied to wye w/ donut 6+39 DE MH Dirt Alley Cut 3+43.6

