

TRAP AREA

Interception and Main B from Harry St. to Zimmerly St.

S.S. #1-1889

Plat 9-59

EASEMENT #34 - SOUTH 1/2 OF WEST 1/2 LOT 1  
JUN 9TH 1889  
BK 118 Page 41

Relocated  
see 959

Immanuel Baptist Ch. Adl  
20" clay became private main serving church prop. until it leaves church prop. City Line Relocated Refer to L-297

EASEMENT #10 - E/W THRU LOT 4 WHERE ALLEY WOULD NATURALLY CORNER. NO GIVEN WIDTH.

EASEMENT #103 - THRU TRACT IN LOT 5 DEF AS FOLLOWS: BEG. N. 0° E. OF N.W. COR. THENCE 3' N. 1/2° E. 20' N. 1/2° W. 50' TO BEG. EASEMENT # 68; N.W. 15' OF LOT 5.

EASEMENT #97 - ON EAST LINE OF 3 1/2 OF N. 1/2 OF LOT 1.

RECONSTRUCT SANITARY SEWER NO. 1 AND 20 (SOUTH OF DOUGLAS)  
PROD. NO. 468-81996 (630541)  
BUILT BY INSITUFORM PLAINS, INC.  
BOOKED 12-4-92 FROM AS BUILTS

RECONNECTIONS

STA.	ADDRESS	DIRECTION
1+40.1	320, 24, 76, 78, 30, 32 E. HARRY	EAST
1+44.1	1546, 48, 50, 52 S. BROADWAY	EAST
2+59.1	1541 S. Topeka	EAST 94, 528, 74
3+08.9	1539 S. Topeka	EAST
3+58.4	1537 1/2 S. Topeka	EAST
3+80.6	1536 S. Broadway	WEST
4+24.9	1525 S. Topeka	EAST
4+49.3	1528 S. Broadway	WEST
4+83.3 5/8	1522 S. Broadway	WEST 107, 102
4+86.3	1521 S. Topeka	EAST
5+59.6	1511 + 1515 S. Topeka	EAST
5+81.7 3/8	1516 S. Broadway	WEST 310 107, 102
6+08	1506 S. Broadway	WEST
6+10.3	1509 S. Topeka	EAST
6+28.5	1505 S. Topeka	EAST
6+59.2	1503 S. Topeka	EAST
7+68	322 E. Boston	EAST
7+77.5	1458 S. Broadway	WEST
7+77.5	1443 S. Topeka	EAST (see below)
7+81.7	1458 S. Broadway	WEST
8+33	1441 S. Topeka	EAST

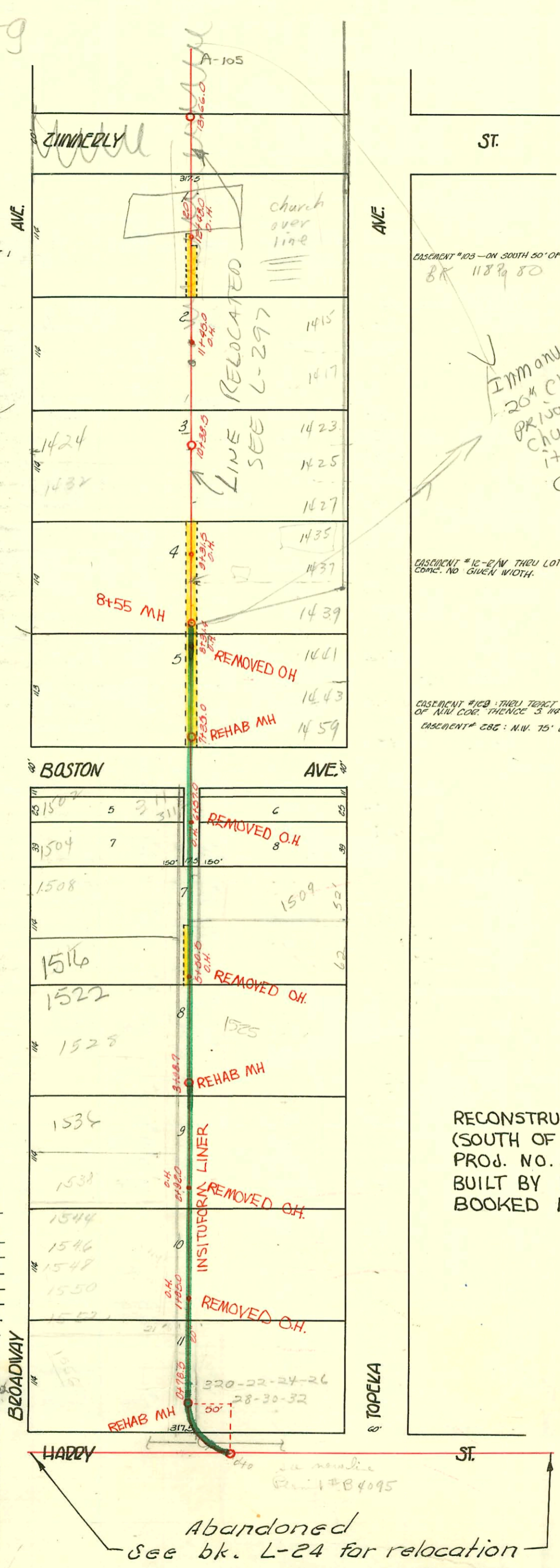

Abandoned  
see bk. L-24 for relocation

# 25557- 6-15-90 1440 S. Broadway (Line was connected to sewer of house south that had already been sealed)

# 177A- 1-3-92 1512 S. Broadway Tim Lubbers - (S/O in 30ft from house at wife on 6" 4/2)

96-18409.7 11-1-96 1443 S. Topeka - McClung's

CONSTRUCTION RECORD

SERVICE RECORD

STATION	ELEVATION		Depth	MANHOLE	4-INCH "Y" BRANCHES		No. of Permit		House Number		DATE OF PERMITS	
	Ground	Grade			North West	South East	North West	South East	North West	South East	North West	South East
13	105.41	96.97	8.44	+66.0	+78.0	+80.0	#271		1407 S. Broadway SW Cor			11-18-08
				+48.0 O.H.	+53.0	+55.0	#157		Primarily Topoka			7-23-06
					+88.0	+30.0						
12	106.02	96.87	9.15		+03.0	+05.0		#516	1409 S. Topoka			8-17-09
					+78.5	+80.0	#84		1408 S. Broadway			8-21-17
				+45.0 O.H.	+53.0	+55.0	#691		1421 S. Topoka			11-4-09
					+88.0	+30.0	#36		1410 S. Broadway			1-26-10
11	105.76	96.77	8.99		+03.0	+05.0		#53	1417 S. Topoka			8-25-09
					+78.0	+80.0	#2476		1423 S. Topoka			11-30-03/4-3-89
				+38.5	+53.0	+55.0	#810	#534	Edwin St			3-21-90
					+88.0	+30.0			1425 S. Topoka			1-21-10
10	105.43	96.67	8.76		+03.0	+05.0		22930	1435 S. Topoka			4-3-89
					+78.0	+80.0	#25938	#187	1427 S. Topoka			8-13-90
				+31.5 O.H.	+53.0	+55.0			1435 S. Topoka			4-1-70
					+88.0	+30.0			1435 S. Topoka			3-21-90
9	104.48	96.57	7.91		+03.0	+05.0	#2388	#25979	1438 S. Topoka			11-14-69
					+78.0	+80.0	#160	#15604	Edwin St			8-20-90
				+31.4 O.H.	+53.0	+55.0	#303	#185	1440 S. Topoka			8-29-69
					+88.0	+30.0	#280	#175	1440 S. Topoka			16-15-08
8	104.29	96.47	7.82		+03.0	+05.0	#678	#175	1440 S. Topoka			6-17-46
					+78.0	+80.0	#160	#105	1441 S. Topoka			8-14-08
				+35.0	+53.0	+55.0	#565	#105	1456 S. Biway			5-7-23
					+88.0	+30.0			1456 S. Biway			8-3-08
7	101.96	96.37	5.59		+03.0	+05.0		#909	1502 S. Broadway			1-24-58
				+57.0 O.H.	+78.0	+80.0	#106	#13451	1502 S. Broadway			6-30-26
					+53.0	+55.0			1502 S. Broadway			3-26-08
					+88.0	+30.0			1502 S. Broadway			1-24-68
6	100.45	96.27	4.18		+03.0	+05.0	#13451	#407	1506 S. Broadway			6-18-23
					+78.0	+80.0			1506 S. Broadway			3-19-09
				+50.5 O.H.	+53.0	+55.0			1506 S. Broadway			5-3-72
					+88.0	+30.0			1506 S. Broadway			8-23-89
5	101.53	96.17	5.36		+03.0	+05.0		#405	1522 S. Broadway			7-1-89
					+78.0	+80.0		#465	1519 S. Topoka			8-16-15
					+58.0	+54.0			1519 S. Topoka			7-28-09
					+88.0	+30.0			1519 S. Topoka			5-11-70
4	101.11	96.07	5.04		+04.0	+06.0	#10194	#594	1528 S. Broadway			3-26-09
				+3+98.7	+06.0	+08.0	#60935	#594	1528 S. Broadway			4-29-77
					+79.0	+81.0	#631	#830	1536 S. Broadway			9-17-09
					+54.0	+56.0	#673	#577	1537 S. Topoka			10-6-09
					+89.0	+31.0	#577	#439	1538 S. Broadway			11-16-17
					+23.7	+06.0	#632	#439	1508 S. Broadway			7-11-83
3	100.54	95.97	4.57		+04.0	+06.0		#792	1542 S. Broadway			10-28-09
				+96.0 O.H.	+79.0	+81.0		#688	1542 S. Broadway			9-28-14
					+54.0	+56.0		#674	1542 S. Broadway			10-6-09
					+89.0	+31.0		#674	1542 S. Broadway			7-17-14
2	101.13	95.97	5.26		+04.5	+06.5		#674	1541 S. Topoka			1-12-10
				+85.0 O.H.	+81.5	+83.5	#666	#474	1541 S. Topoka			9-17-17
					+31.5	+33.5		#474	1543 S. Topoka			10-28-09
					+04.0	+06.0		#39009	1545 S. Topoka			10-5-09
1	102.45	95.77	6.68		+04.0	+06.0		#169	1545 S. Topoka			6-7-20
0	103.32	95.75	7.57	+78.5	+81.3	+83.3	#166	#1063	320-32 E. Harry			10-2-71
							#361	#1063	320-32 E. Harry			6-7-20
									1557 S. Broadway			5-15-73
									1560 S. Broadway			3-10-19
									1560 S. Broadway			9-15-17
									1560 S. Broadway			4-20-22

6994 - 1525 S. Topoka - 11-15-82 - Hurston Powers  
 7025 - 1525 S. Topoka - 11-18-82 -  
 02005 - 1423 S. Topoka (Cawens) - 10-18-85 (16-5 N of M.K.)  
 #C13453 - dead off 1508 S. Broadway - Lower Blg. - 4-8-69 (5778.9)

3+98.7 N (30' N of MH)  
 3+98.7 N (7.5' N of MH) (4+16.2)  
 256 26 - 1434 S. Broadway - 6-27-90 - sewer apparently conn to  
 25912 - 81740 - 1432 S. Broadway - 11-11-89 - (50' S of Center of  
 Alley and 47' S.R. Line  
 71' into Hoagland's Line)

#1006 - Tap - 1408 S. Biway - Hamilton School - 7-22-31 - Connor & Ripstra  
 #2280 - Private Line - 1536 S. Biway - 9-13-45 - Magruder Pkg.  
 #2566 - Used old connection - 322 E. Harry - 1-8-46 - C.B. Brennan  
 #416 - Tap - 1443 S. Topoka - 3-24-53 - Joe McDonald  
 #1917 - Tap - 1414 S. Biway - 7-19-52 - Kendall Pkg.  
 #4380 - Tap - 1415 S. Topoka - 4-17-51 - C. Lee Fide  
 #1140 - Tap - 1402 S. Biway - Immanuel Baptist Church - 11-18-47 - Moore - Debarlson  
 #1554 - Used Old Connection - 330 E. Harry - 9-9-49 - Bradie Pkg.  
 #886 - Tap - 322 E. Boston - 5-8-50 - E. La Foy  
 #4624 - 1542 S. Broadway - dead off - 11-23-65 - Al Henning  
 #5232 - 1549 S. Topoka - Seal off - Al Henning - 10/11/67 (1+47.5)  
 #11994 - 1542 S. Broadway - Seal off - Al Henning - 12-17-68 (1+57.9) - 076495 - 2/19/80 - 1546 S. Biway - Repair - Kendall  
 #11994 - 1542 S. Broadway - Seal off - Al Henning - 12-17-68 (1+59.9)