

TRAP AREA

WEST SUB MAIN "B" ON INDIANAPOLIS ST. & LAT. N. & S.  
LAT. SOUTH FROM WEST SUB MAIN "B" ON ORME ST.

S.S. #1-1889

Plot 9-55

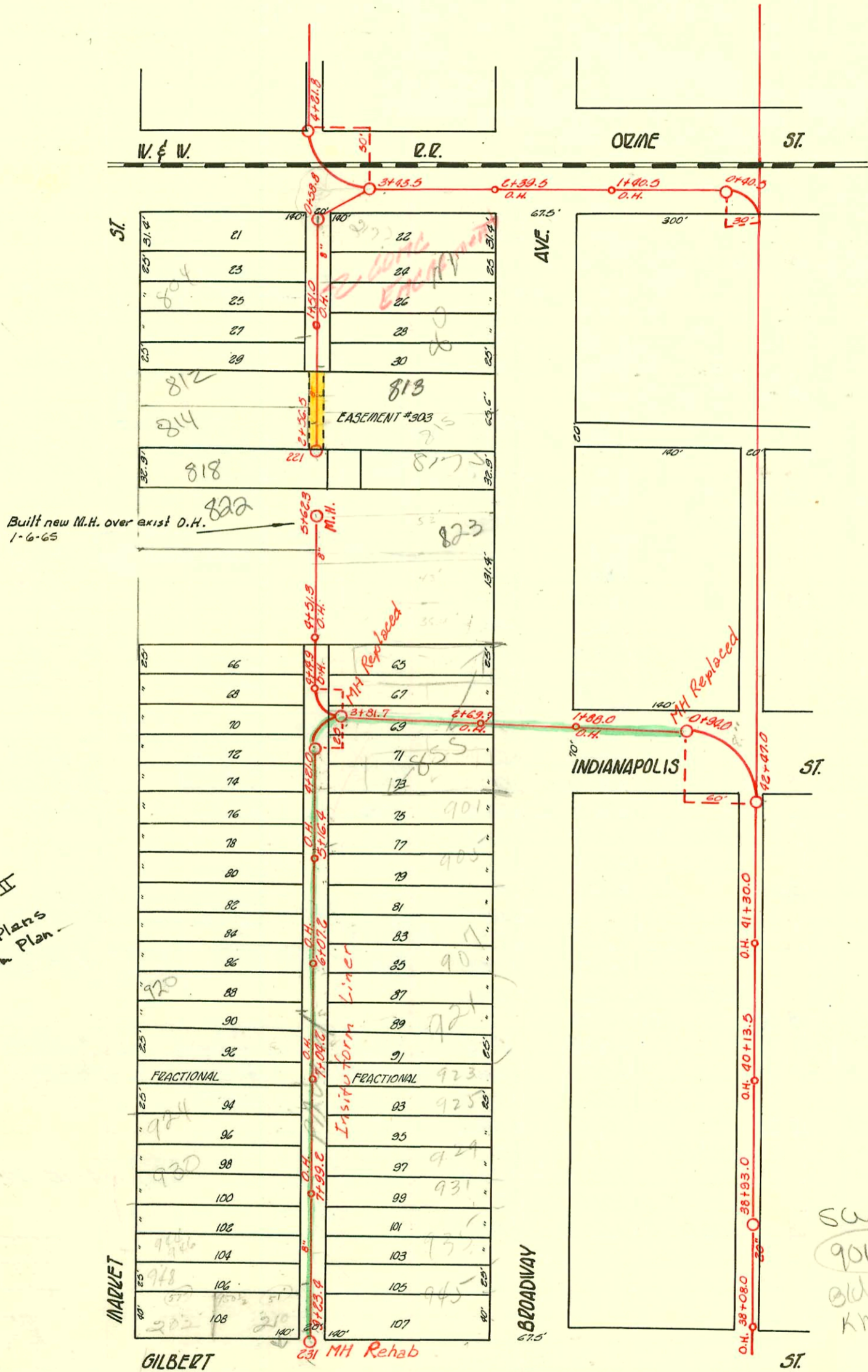

1989 S.S. Reconst. Phs II  
#28-82011 (725002)  
Built B4 Insituform Plans  
Booked 16-16-90 from Plan.

SUR 2053-02135 8114/13  
901 S. Broadway (Commercial  
Bldg on same lot as have  
known as 905) A & Henning

Rep-2000-02512-1117100-McClung-4"SCH40-exist tap-4"trap installed-No alley

- # 23334-6/8/89-803 S. Broadway - New Conn. McHutton-
- # 25868-7-27-90-813 S Broadway - Henning-(2120)
- # 25982-8/20/90-813 S Broadway - Henning-(5' wof structure, sewer to be used for new structure)
- 91-26/187 7/15/91-815 S. Broadway - Henning (slo 6" cby 2' off Main)
- 93-3283-7 12-693-804 S MARKET - Foto Kwik - 6" ABS 40 - Replaced lower 5ft of line to point 7ft from main - 1/4 pf shallow - no alley

CONSTRUCTION RECORD

SERVICE RECORD

STATION	ELEVATION		Depth	MANHOLE	4-INCH "Y" BRANCHES		No. of Permit		House Number		DATE OF PERMITS	
	Ground	Grade			North West	South East	North West	South East	North West	South East	North West	South East
	103.90	102.48	1.42	+56.5 FT.								
2	103.70	102.36	1.34	2 +52.0 +34.0 +10.0 +83.5 +51.0 O.H. +33.5 +09.4 +87.3	2 +54.0 +136.0 +12.0 +85.5 +59.6 +35.5 +11.4 +89.3	#119 #310 #306	#347 #555 #375 #87	818 S. R. Market 814 S. R. Market 812 S. R. Market	700 Market 827 S. Broadway 811 S. Broadway	4-13-01 6-28-01 6-1-10 4-9-10	5-26-02 12-12-06 3-13-41 5-7-06	
1	103.98	102.12	1.86	1 +57.6 +33.5 +09.4 +87.3	1 +59.6 +35.5 +11.4 +89.3	#68 #251 #138	#163 #757 13720 connected	820 S. Market 800 S. Market 802 S. Market	815 S. Broadway 805 S. Broadway 803 S. Broadway	5-2-07 5-4-09 3-29-09	12-16-03 6-22-70 12-5-09 5-7-95 12-12-84	
0	103.98	102.02	1.96	+58.8	+64.6							
4	103.93	102.26	1.67	+61.8								
3	104.35	101.98	2.37	+43.5								
6	108.87	101.46	7.41	+39.5 O.H.								
1	105.63	101.10	4.53	+40.5 O.H.								
0				+40.5								
	104.07	101.64	2.43	+51.3 O.H.	+56.3							
4	104.83	101.42	3.41	+12.9 +63.4 FT.	+17.7 +19.7	#1209		830 S. Market			9-3-29	
9	105.33	102.76	2.57	+19.2 +98.8 +72.3 +98.0	+21.2 +100.8 +74.3 +50.0	#378 #108 #58 #233		840 S. Market 948 S. Market 944 S. Market	N.W. Cor. Street + Lane 5-01-06 3-9-08 5-1-13	12-5-04		
8	104.68	102.48	2.20	+99.2 O.H. +95.5 +71.4 +46.8 +104.2 O.H.	+83.8 +97.5 +73.4 +48.8 +82.9	#112 #85 #178	#498 #29297	936 S. Market 940 S. Market 900 S. Market	931 S. Broadway 935 S. Broadway	6-3-08 5-1-08 5-9-46	3-3-77 3-9-13 12/4/71	
7	105.89	102.20	3.69	+98.5 +72.8 +48.0 +81.5 +97.5 +73.7 +49.6 +16.4 O.H.	+100.5 +44.4 +74.8 +50.0 +99.5 +75.7 +51.6 +87.4	#808 #600 #596	#4627 #1250	922 S. Market 950 S. Market 946 S. Market 907 S. Market	921 S. Broadway 11-12-17 11-26-98 5-10-43	1-19-94	8-28-67	
6	106.44	101.98	4.56	+07.2 O.H. +97.5 +73.7 +49.6 +16.4 O.H. +50.5 +76.9 +450.5	+81.5 +83.5 +99.5 +75.7 +51.6 +87.4 +52.5	#808 #600 #596	(4627) #1250	922 S. Market 950 S. Market 946 S. Market 907 S. Market	921 S. Broadway 11-12-17 11-26-98 5-10-43	8-28-67		
5	106.34	101.64	4.70	+01.0 +76.9 +450.5	+03.0 +78.9 +52.5	#695 #182	#113 #563	904 S. Market 900 S. Market	710 Broadway 849 S. Broadway	5-10-43 3-15-22	6-7-93 11-29-12	
4	105.61	101.42	3.79	+21.0 mit +88.3	+30.3							
3	105.52	101.31	4.21	+81.7 +86.8 Top 2 +96.1	+37.06 +53.5 +98.0							
2	108.50	100.80	7.70	+69.7 O.H.								
1	108.41	100.52	7.89	+88.0 O.H.								
0	108.44	100.50	7.94	+94.0								
4				+51.3 O.H.	+56.3	#805	#?	710 Broadway			10-10-11	Previously
5					+05.3 +35.3 +57.3	#?					Previously	
				+66.3 NEW M.H.	+60.3	#542	#60	800 N. Market	829 S. Broadway		6-22-21	1-14-12

76 # 13552 (817 S. Broadway) Sealed 4-24-85 (3+6) (8)  
 # C29285 - 157-59 New York - Seal off - at Henning - 12/6/71  
 # C29286 - 153-55 New York - Seal off - at Henning - 12/6/71  
 # C29287 - 141 New York - Seal off - at Henning - 12/6/71  
 # C25085 - 923 S Broadway - Seal off - at Henning 6-23-71  
 # 31-907 S. Broadway - 8-23-32 - M.M. Pray - Used Old Connection  
 # 614-945 S. Broadway - 11-29-37 - Dermody - Used Old Connection  
 # 701-803 S. Broadway - 3-7-58 - Kansas Pipe Co. - Top  
 # 1263-822 S. Market - 1-13-47 - J. Douglas Landowne - ASAP 71/63 4" PE - COO house  
 11224 Broadway - 945 S Broadway - Enger - Budie - 9-9-59 9+42.4  
 Seal off C1084 (6+50.1) 921 S. Broadway - 7-25-67  
 Seal off C1597-924 S. Market - at Henning 1-25-68  
 Seal off C47431-803 S. Broadway - 11-19-74 - at Henning (Dish in with house on corner Sealed 66' E of Man 41' S. of N. H.L.)

Seal off C25615 - 831 S. Broadway - 7-15-71 - at Henning (4+19.9)  
 # C70280 - (929 S. Broadway) - 2-15-79 - Henning (7+6 6.1)  
 14964 - 407 S. Broadway - 11-4-85 - Henning (1+12.5) 81.02