

TRAP AREA

Plot 9-53

EAST SUB MAIN "B" ON VELLOGG ST. & LAT. N. & S.
S.S. #1-1889

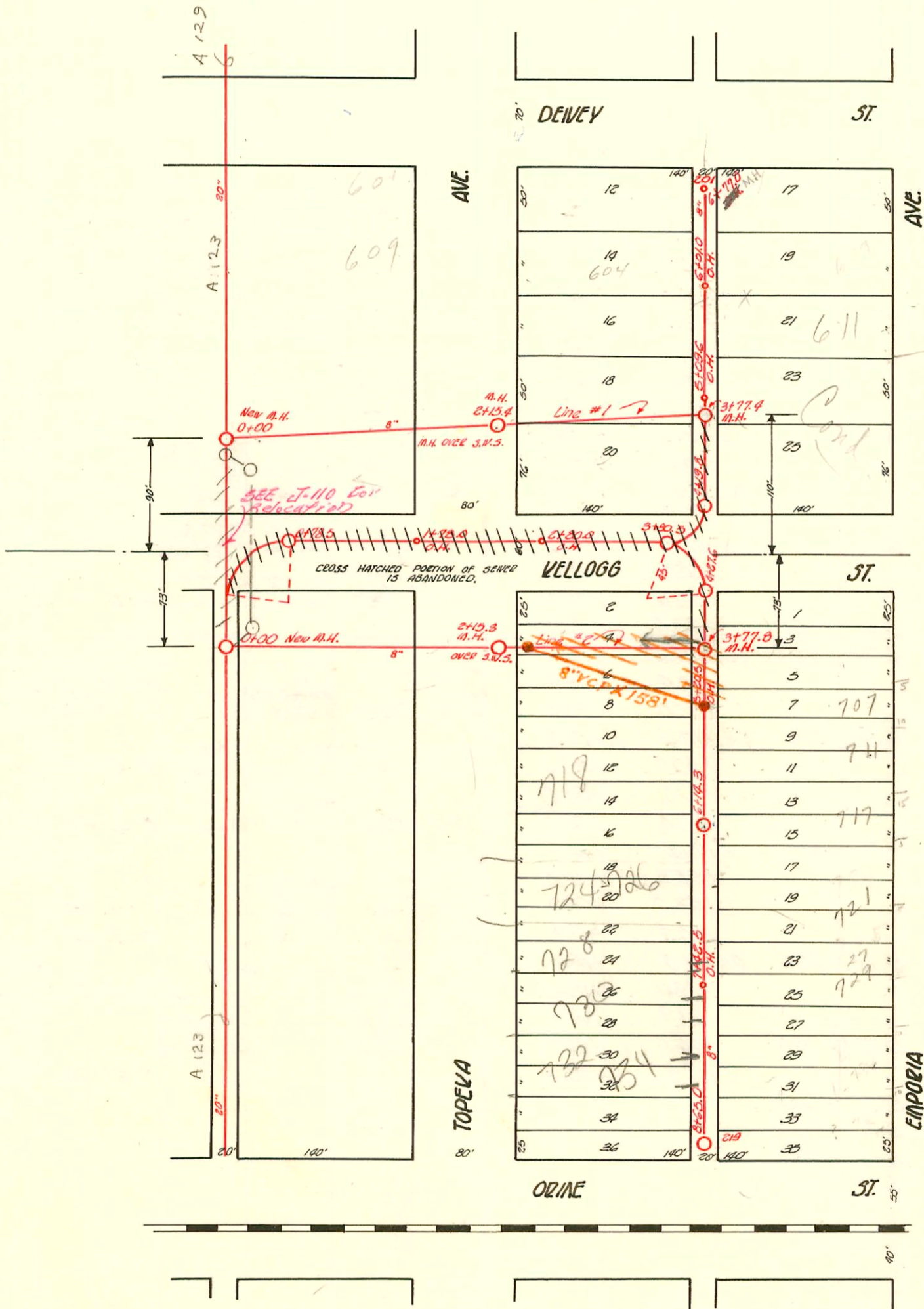

CHANGES MADE BY
STATE HIGHWAY DEPT 1978

CONSTRUCTION RECORD

SERVICE RECORD

STATION	ELEVATION		Depth	MANHOLE	4-INCH "Y" BRANCHES		No. of Permit		House Number		DATE OF PERMITS	
	Ground	Grade			North West	South East	North West	South East	North West	South East	North West	South East
#1 0	107.3	101.62	5.7	+100								
1	106.8	101.72	5.1			+25.5						
2	106.3	101.82	4.5									
3	106.4	101.84	4.6	+15.4	North							
	106.8	101.92	4.9		+33.7							
	106.7	102.00	4.7	+77.4								
#2 0	106.7	101.43	5.3	+100								
1	105.7	101.53	4.2									
2	105.4	101.63	3.8									
3	105.7	101.65	4.1	+15.8								
	105.9	101.73	4.2									
	105.7	101.81	3.9	+77.8								
	108.30	103.72	4.58	+650 O.H.								
8	108.16	103.42	4.74		+50.7	+24.8		#65	735 S. Emporia			5-20-03
					+82.8	+100.5		#1320	74 S. Emporia			9-19-29
7	107.97	103.02	4.95		+98.5							
					+73.0	+75.0	#118	#169	736 S. Emporia	7-5-05	18-26-03	
					+42.5	O.H. +49.0						
					+23.0	+25.0	#1059	#1484	739 S. Emporia	7-6-00	7-17-56	
6	103.65	102.62	1.03		+97.5	+99.5		#1827	745 S. Emporia	7-10-19	7-9-52	
					+73.0	+75.0						
					+47.0	+49.0						
					+47.0	+49.0						
5	104.14	102.22	1.92		+47.0	+49.0						
					+47.0	+49.0						
4	104.66	101.83	2.69		+47.0	+49.0						
					+27.6	+31.6						
	107.86	102.99	4.87	+77.0 O.H.								
6	106.83	102.62	4.21		+72.5	+70.5		#616	605 S. Emporia			11-21-78
					+46.7	+44.7	#697	#137	604 S. Emporia	5-8-23	6-26-20	
5	106.66	102.22	4.44		+19.4	+21.2		C43527	604 S. Emporia	2-19-74	7-18-19	
					+97.5	+95.5	#916	#92	605 S. Emporia	10-25-27	6-7-05	
					+71.7	+69.7		#4916	611 S. Emporia	5-11-99	9-19-67	
					+47.8	+45.8						
4	105.80	101.90	3.90		+47.8	+45.8						
					+22.0	+20.0	#119	#579	612 S. Emporia	3-25-15	9-23-18	
3	105.11	101.74	3.37		+96.5	+94.5						
					+72.8	+70.8	#262	#92	620 S. Emporia	5-7-09	5-29-07	
2	105.28	101.52	3.76	+80.0 O.H.								
1	105.26	101.40	3.86	+78.0 O.H.								
0	105.52	101.37	4.15	+78.5								

RELOCATION OF PORTION OF S.S. #1 BOOKED SEPT. 19, 1932 BK. # J. 67

5/0 2000-20017 - 1/5/00 - 7385 Topeka - Boardman - 5/0 OK

- 61841-721 S. Emporia - James Francis - 700 (7+38.3)
- 59700-720 S. Topeka - 2-1-77 - R. M. Lundy (6+04.3)
- 59474-706 S. Topeka - 1-14-77 - Al Henning (4+17)
- 716 S. Topeka - Al Henning - 1-14-77 - (4+44)
- 18026-604 S. Topeka - 2-17-70 - Al Henning - (6+05.6)

- #935-1st & 4th - 626 S. Topeka - 11-2-26
- #893-1st - 745 S. Emporia - 10-9-47 - Moore - Kabetson
- #4365-1st - 609 S. Emporia - 8-13-51 - E.B. Brannon
- #4513-4 - 49514 - Private Line - 609 S. Emporia - 5-2-51 - E.B. Brannon
- #4958 - Old Connection - 332 E. Kellogg - 4-25-53 - Creechmore

50 C 34805-417 E Dewey 9-12-72 Al Henning (sealed at top at least edge of alley)
 4627 (608 S. Topeka) 11-9-81 Delaney 3+77.4 N (63.10, 0.8 mH) (5.4+40.4)
 72-8257 6592 E 9th Pl 11-9-81 Delaney 3+77.4 N (m.v) (n/c 21728)-84.6 w/0831774