

TRAP AREA

MAIN "B" FROM MORRIS ST. (N.) TO WATERMAN ST.
S.S. #1-1889

Plat 9-53

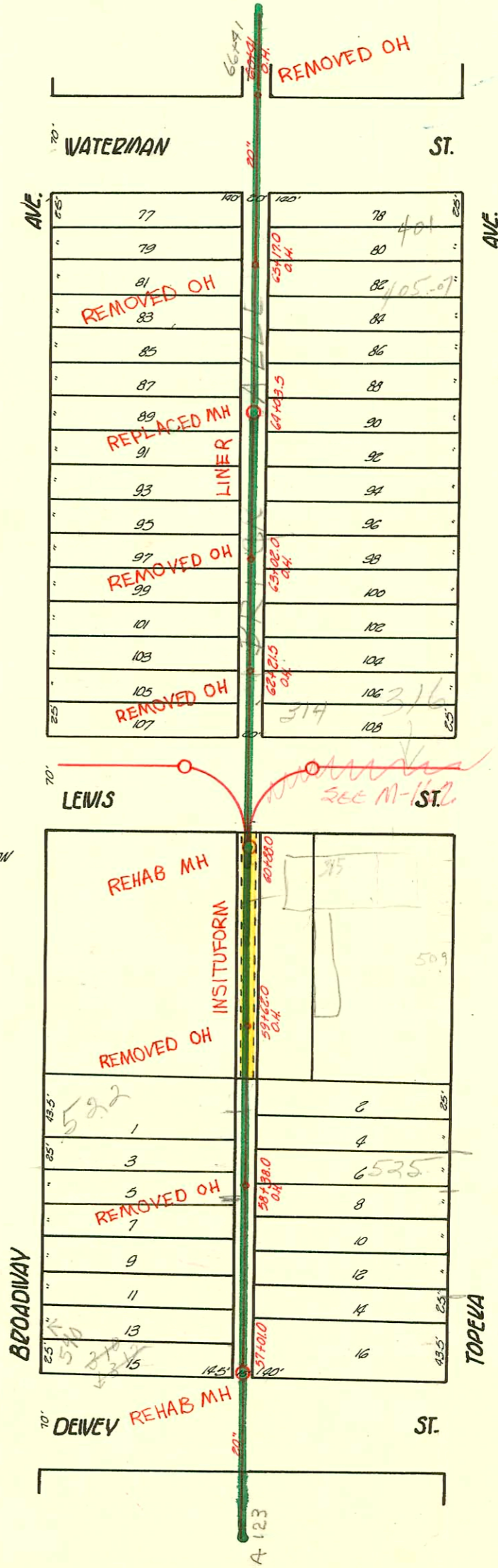

CASEMENT #153: BEG. 145' E. OF S.E. COR. BROADWAY AND LEWIS 315. THENCE 185.5' TO AN ALLEY. E. 10', N. 183.5', W. 10' TO BEG.

RECONSTRUCT SANITARY SEWER 1 AND 20
(SOUTH OF DOUGLAS)
PROJ. NO. 468-81996 (630541)
BUILT BY INSITUFORM PLAINS, INC.
BOOKED 12-4-92 FROM AS BUILTS

RECONNECTIONS

STATION	ADDRESS	DIRECTION
57+79.6	535 S. Topeka	East
58+30.5	522 S. Broadway	West
58+75.6	535 S. Topeka	East
59+78.7	535 S. Topeka	East
60+01	500 S. Broadway (West Bldg.)	West
60+47.4	535 S. Topeka	East
60+49.4	500 S. Broadway (East Bldg.)	West
61+93	428 S. Broadway	West
63+40	428 S. Broadway	West
64+69.4	411 S. Topeka	East
65+23.4	400 S. Broadway	West

CONSTRUCTION RECORD

SERVICE RECORD

STATION	ELEVATION		Depth	MANHOLE	4-INCH "Y" BRANCHES		No. of Permit		House Number		DATE OF PERMITS	
	Ground	Grade			North West	South East	North West	South East	North West	South East	North West	South East
66	109.65	108.54	7.11	+410 O.H.	+39.0	+37.0						
65	110.07	108.44	7.63	+170 O.H.	+38.0	+36.0	#580	#1000	401 S. Topoka	405 S. Topoka	8-30-00	11-27-07
64	109.61	108.34	7.27	+03.5	+150	+13.0	#145	13624	406 S. Topoka	411 S. Topoka	9-18-58	1-22-01
63	109.41	108.84	7.17	+08.0 O.H.	+89.5	+87.5	#51		700 Broad		11-9-85	12-31-96
62	109.41	108.14	7.27	+01.5 O.H.	+62.0	+60.0	#319				11-11-91	12-14-69
61	108.98	108.04	6.94	+08.0	+39.0	+37.0	#320					6-30-00
60	108.94	101.94	7.00	+08.0	+88.0	+86.0	#58					8-20-98
59	108.94	101.84	7.10	+08.0	+63.0	+61.0	#318					6-10-13
58	108.98	101.74	7.24	+08.0	+38.0	+36.0	#113					12-31-06
57	108.57	101.64	6.93	+01.0	+11.0	+15.6	#113					10-28-09
56					+88.0	+85.0	#320					10-28-09
55					+62.0	+60.5	#58					8-28-01
54					+80.5	+78.5	#320					6-10-13
53					+96.0	+94.0	#58					8-28-01
52					+68.5	+66.5	#58					6-10-13
51					+42.5	+40.5	#58					8-28-01
50					+80.0	+78.0	#58					6-10-13
49					+94.5	+92.5	#58					8-28-01
48					+70.5	+68.5	#58					6-10-13
47					+44.5	+42.5	#58					8-28-01
46					+61.5	+59.5	#58					6-10-13
45					+94.0	+92.0	#58					8-28-01
44					+71.5	+69.5	#58					6-10-13
43					+43.5	+41.5	#58					8-28-01
42					+19.0	+17.0	#58					6-10-13

12937 500-2-4 S Broadway (Front) 1-16-85

12478 508 S Broadway 5/10 11-7-84 (88' S of 60188.0) (at 100.0)

72411 512-512 1/2 S Broadway (Hemming) 10-30-84 (137.5' S of 60188.0 - 59+50.5)

7923 - (433 3/4 Topoka - 426-83 - 64103.5 S.

#C1703K-505-07 Seal off at Hemming - 11-21-69

C14760-509-11 Seal off at Hemming 7-3-69 } no sewer found

C14761-515 Seal off at Hemming 7-3-69 } when excavation

C14762-519 Seal off at Hemming 7-3-69 } made

(58+80)

#8094 - Tap - 550 S Broadway - 5-17-88 - Howard F. Cowan

#961 - 305 C. Waterman - 9-13-88 - Max Hinshaw - Used old connection

#6881 - Tap - 661 N. Mission Rd. - Carroll P. Bly - 11-10-85

#6902 & #6903 - Private Line - Trailer - 529 S. Topoka - 12-21-81 - Howard F. Cowan

#12705 - Seal off 525 S. Topoka - 4-27-60

#B6069 - Seal off - 429 S. Topoka - 7-27-66

#C10512 Seal off - 548 S. Broadway - at Hemming 9-16-68 (59+44.5)

94 5967 1-14-94 335 W. Lewis (bathhouse) - Rel