

WEST SUB-MAIN "B" on SEVENTEENTH ST. and LAT. A
S.S. No. 1 - 1889

Plat 9-37

TRAP AREA

1995 SANITARY SEWER REHABILITATION PROGRAM - PHASE II
PROJ. NO. N/A (621060)
BUILT BY W. B. CARTER CONST. CO.
BOOKED 2-20-96 FROM AS BUILTS

RECONNECTIONS

STA.	ADDRESS	DIRECTION
4+10	106 E. 17TH St.	West
4+51	106 E. 17TH St. ^{R see below}	West ^{1/24/03}
4+18	1801 N. Market	East
4+58.5	1807 N. Market	East
4+79	1809 N. Market	East
5+53	1811 N. Market	East
5+58	1818 N. Park Place	West
6+04	1815 N. Market	East
6+06.5	1824 N. Park Place	West
6+10	1829 N. Market	East
6+48	1826 N. Park Place ^{see below}	West ¹²⁻²³⁻⁹⁹
7+06	1833 N. Market	East
7+07.5	1832 N. Park Place	West
7+57	1841 N. Market	East
7+59.5	1838 N. Park Place	West
8+17	1840 N. Park Place	West
8+18	1845 N. Market	East
8+50	1847 N. Market	East
8+55	1848 N. Park Place	West
9+05	1853 N. Market	East
9+12	1854 N. Park Place	West
9+27	1855 N. Market	East
9+30	115 E. 18TH St.	West
10+46	114 E. 18TH St.	West
10+90.5	1901 N. Market	East
11+89	1915 N. Market	East
12+17	1914 N. Park Place	West
12+41	1919 N. Market	East
12+65	1922 N. Park Place	West
12+87	1921 N. Market	East
13+12	1925 N. Market	East
13+15	1928 N. Park Place	West
13+65	1927 N. Market	East
13+66	1934 N. Park Place	West
13+90	1931 N. Market	East
14+22	1936 N. Park Place	West
14+42	1940 N. Park Place	West
14+65	1943 N. Market	East
15+36	1947 N. Market	East
15+38	1944 N. Park Place	West
15+54	1948 N. Park Place	West
15+86	1952 N. Park Place	West
16+07.5	1955 N. Market	East
16+09.5	105 E. 19TH St. ³⁻²⁰⁻⁰²	West

2001-00332

2002-00844 - 510 w/ concrete 46.6' S of mth 1, 315

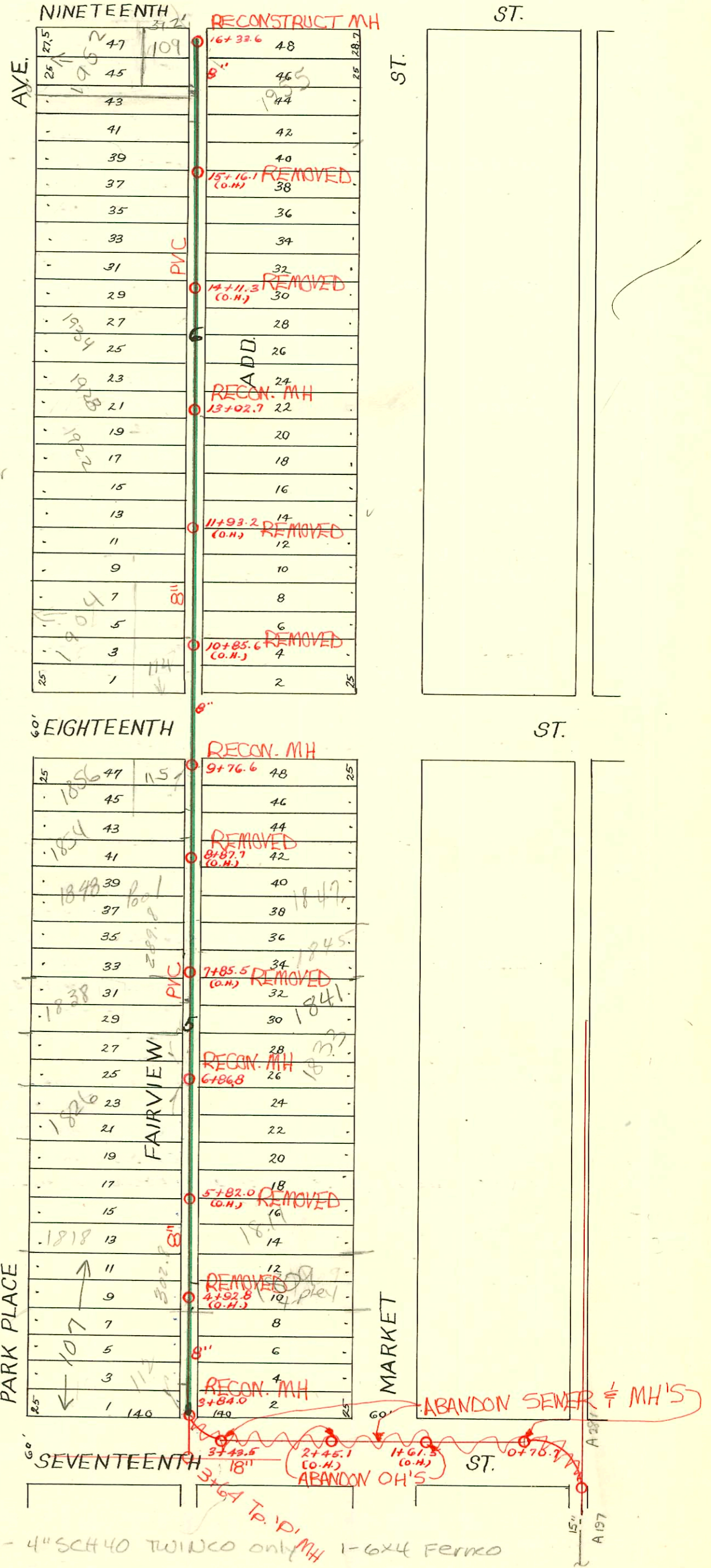

- 2001-00343-211601-1856 N PARK PL - Reddi - 4" SCH 40 TWINCO only MH 1-6x4 Ferro
- 2001-00332-211501-1826 N PARK PL - Kings Solar - 4" SCH 40, Trap installed, tied 6' from main, 1 TWINCO, 1-6x4 Ferro Alley Cut
- 2003-00227-1/24/03-106 E 17th - Bowers Plbg - 4" SCH 40 8x4 PVC saddle 103' N of mth 3+84(4+51) 2H22, 1 Running trap (4 V45)

CONSTRUCTION RECORD						SERVICE RECORD						
STATION	ELEVATION		Depth	MANHOLE	4-INCH "Y" BRANCHES		No. of Permit		House Number		DATE OF PERMITS	
	Ground	Grade			North West	South East	North West	South East	North West	South East	North West	South East
				16 + 33.6								
16	126.01	121.64	4.37		16 + 29.0	16 + 27.0	#251		1955 N. Market		4-10-00	
					16 + 09.3	16 + 07.3	#1564	?	109 E. 1970		7-23-54	11-7-99
					15 + 85.2	15 + 83.2	#48		1948 B. 10-11th		4-13-92	
					15 + 67.5	15 + 59.5	#1398		18th Place		5-27-52	
15	125.87	121.24	4.63		15 + 38.0	15 + 36.0	#184	#519	1944 Park Place		3-31-10	8-17-09
					15 + 14.2	15 + 12.2						
					14 + 90.5	14 + 88.5						
					14 + 67.3	14 + 65.3						10-27-08
					14 + 43.8	14 + 41.8						
14	125.76	120.84	4.92		14 + 15.7	14 + 13.7	#69		1936 N. Main		4-26-06	
					13 + 91.5	13 + 89.5	#257	#68	1937 N. Market		12-13-06	4-24-06
					13 + 65.0	13 + 63.0	#765	#541	1927 N. Market		7-1-22	12-15-83
					13 + 41.4	13 + 39.4						10-1-10
13	125.74	120.44	5.30	13 + 02.7	13 + 16.5	13 + 14.5	#990	#991	1932 Park Place	1923 N. Market	8-25-81	12-15-83
					12 + 90.3	12 + 88.3	#187	#201	18th Place		3-10-25	5-6-12
					12 + 66.0	12 + 64.0	#765	#691	1922 Park Place		5-21-23	8-8-11
					12 + 42.7	12 + 40.7		#53	1917 N. Market		4-26-07	
12	125.45	120.04	5.41		12 + 18.5	12 + 16.5	#211				4-22-09	
					11 + 90.0	11 + 88.0		#278				6-13-12
					11 + 65.5	11 + 63.5	#617				4-26-23	
					11 + 42.2	11 + 40.2						
11	125.50	119.64	5.96		11 + 18.3	11 + 16.3						
					10 + 92.0	10 + 90.0	#152				7-17-93	3-4-02
					10 + 68.0	10 + 66.0						
10	125.17	119.24	5.93		10 + 43.2	10 + 41.2	#233		114 B. 18th		4-19-10	
				9 + 76.6								
					9 + 54.8	9 + 52.8						
					9 + 30.0	9 + 28.0	#9		1858 7th Main		2-19-06	
9	124.79	118.84	5.95		9 + 08.8	9 + 06.8	#1097	#122	1840 Park Place		10-5-25	3-6-14
					8 + 80.8	8 + 78.0						
					8 + 53.3	8 + 51.3	#923	#104	1847 N. Market		4-23-24	12-26-69
					8 + 30.5	8 + 28.5			1847 N. Market		3-13-85	
8	124.71	118.44	6.27		8 + 06.4	8 + 04.4	#1057				7-10-19	
					7 + 82.2	7 + 80.2	#796		1836 Park Place		9-20-27	
					7 + 57.8	7 + 55.8	#138	#239	1832 Park Place	1743 N. Market	11-15-91	12-4-07
					7 + 33.4	7 + 31.4	#81		1831 N. Market		4-28-08	
7	124.48	118.04	6.44		7 + 08.0	7 + 06.0	#208		1832 Park Place		3-19-30	
				6 + 86.8								
					6 + 82.2	6 + 80.2						
					6 + 55.3	6 + 53.3						
6	124.26	117.64	6.62		6 + 06.0	6 + 04.0	#290	#980	1826 Park Pl		12-8-08	6-5-19
					5 + 81.5	5 + 79.5						
					5 + 56.2	5 + 54.2	#3746	#94	1818 Park Place		6-27-41	2-27-17
					5 + 32.0	5 + 30.0						
5	123.41	117.24	6.17		5 + 08.0	5 + 06.0						6-9-87
					4 + 83.6	4 + 81.6	#417		1804 N. Market		7-1-64	7-15-10
					4 + 59.4	4 + 57.4	#117.7	#57	1805 N. Market		8-22-19	2-25-09
					4 + 35.1	4 + 33.1	#757		1801 N. Market		8-22-21	
4	123.61	116.78	6.83	3 + 84.0	3 + 82.0	3 + 80.0	#12		1804 N. Market		2-22-93	
					3 + 89.6	3 + 87.6						
3	123.66	116.62	7.04	3 + 43.5	445.1.0		#3075.7		106 E. 17th		2-17-93	
2	124.53	116.04	8.49									
1	123.28	115.64	7.64									
0	123.10	115.52	7.58	0 + 70.7								

#01283R 125 E. 17th - 9/17/50 - Dean Jaffer
 #44 - C43212 - 1809 N. Market - Al Jennings - 3-5-74
 #2310 - Private line - 1955 N. Market (Rear) J.E. Lansdowne - 5-13-40
 #3287 - old connection - 1901 N. Market - Kendall Plbg. - 1-28-55
 #4946 - Con 8 wye - 1815 Park Place - 5-26-55 - Ferrell Plbg.
 #3375 - B 1600 - 106 E. 17th - Keith Willard Jones - 7-7-64 - lwp (4+51)