

WEST SUB-MAIN "C" on LEWIS ST. and LAT. N.
WEST SUB-MAIN "C" on WATERMAN ST. and LAT. N.
S.S. No. 1 - 1889

TRAP AREA

Plat 9-53

City lateral for this block
to be abandoned - SLO at
DS MH
100 Building
SLO Building
Per Reg Id
System Planning
7/12/67
SR

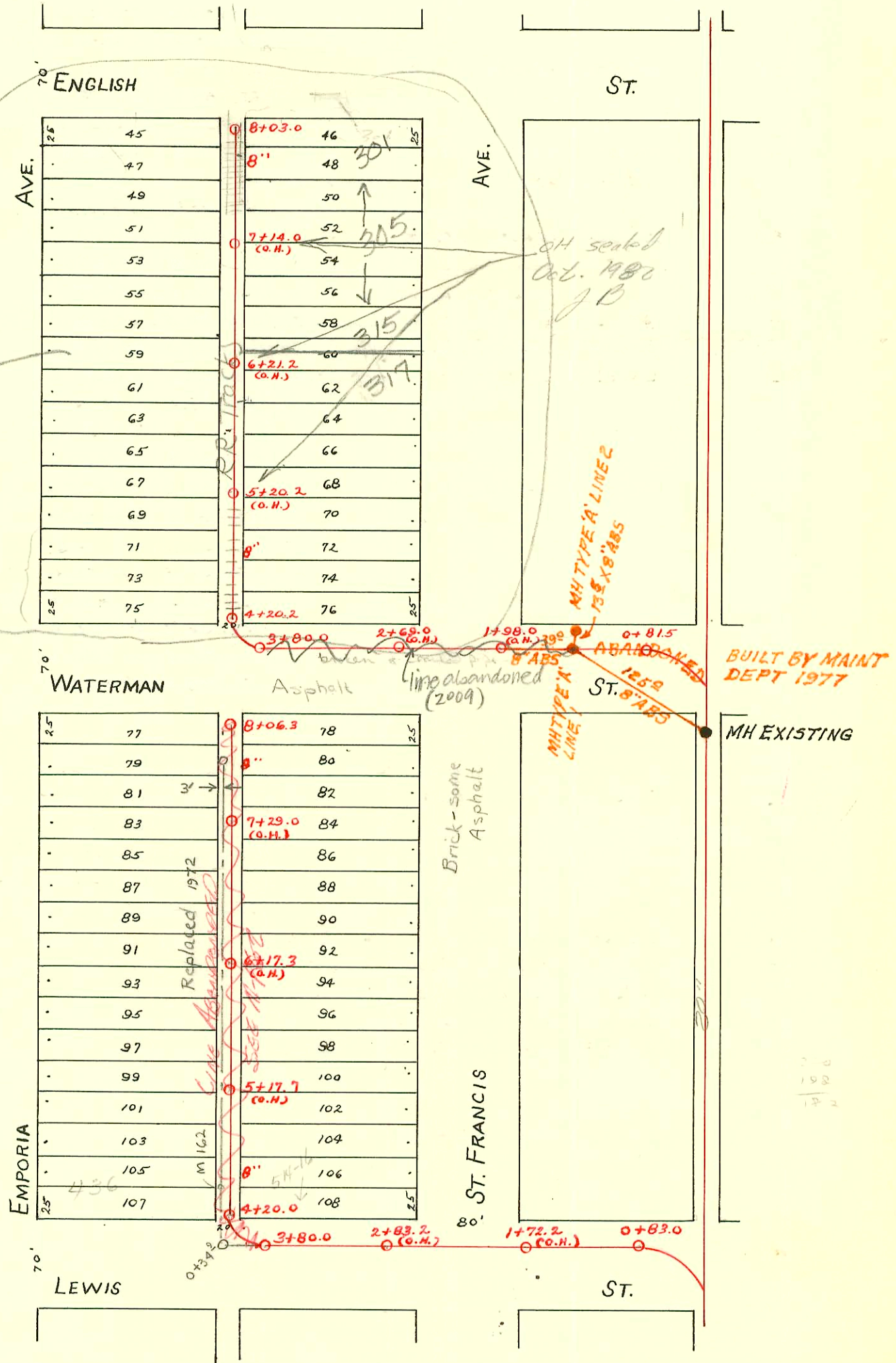

CONSTRUCTION RECORD							SERVICE RECORD					
STATION	ELEVATION		Depth	MANHOLE	4-INCH "Y" BRANCHES		No. of Permit		House Number		DATE OF PERMITS	
	Ground	Grade			North West	South East	North West	South East	North West	South East	North West	South East
8	109.09	104.54	4.55	8+03.0								
					7+93.0	7+91.0	#219	#977		303	4-20-17	6-5-19
					7+69.0	7+67.0	#464	#2003	01064	St. Francis	9-17-15	1-22-41
					7+44.0	7+42.0	#130	#02153		30157	3-9-14	5-17-17
					7+18.0	7+16.0	#477				9-22-15	
7	108.02	104.18	3.84									
					6+94.5	6+92.5		7280		305 S.		12-30-82
					6+68.0	6+66.0		#885		315		12-9-20
					6+45.5	6+43.5				St. Francis		
6	107.16	103.82	3.34									
					6+19.3	6+17.3	#314	#1010		317 S.	5-17-17	7-25-49
					5+94.5	5+92.5	#388	#8357		St. Francis	6-12-17	6-1-17
					5+68.0	5+66.0	#5676		330 S.	Emporia	8-23-51	
					5+43.0	5+41.0						
5	107.03	103.46	3.57									
					5+18.6	5+16.6	#314				5-17-17	
					4+85.6	4+83.6						
					4+63.6	4+61.6	#214			306 S.	11-3-05	
					4+48.2	4+39.1	#1234	#273	Emporia	342 S.	12-30-82	11-18-08
	107.19	103.17	4.02	4+20.2								
					4+07.3	4+13.4						
3	106.80	103.03	3.77	3+80.0								
2	108.81	102.38	6.43									
1+25	108.51	102.36	6.49	1+25.0								
0+00	108.36	102.01	6.40	0+81.5								
0	108.36	101.96	6.40	0+81.5								
D+00 LINE 2 = 1+25 LINE 1 OUT 102.73 D+13.5 LINE 2 102.85												
8	105.36	103.79	1.57	8+06.3	W	E						
					7+98.4	7+96.4				402 S.		
					7+72.0	7+70.0	#186	#406	Emporia		10-22-06	6-16-17
					7+58.3		#302				6-14-13	
					7+49.7	7+47.7		#1300		409 S.		12-3-25
7	105.63	103.51	2.12									
					7+19.2	7+17.2						
					6+99.0	6+97.0	#410	#217	400 E.S.		3-22-99	9-9-12
					6+74.5	6+72.5	#789		Emporia		7-16-25	5-31-14
					6+48.0	6+46.0						
					6+21.7	6+19.7						
6	105.23	103.23	2.00									
					5+97.0	5+95.0		#583		423 S.		5-27-25
					5+72.7	5+70.7				St. Francis		
					5+48.3	5+46.3		#926				5-20-19
					5+21.8	5+19.8		#7427		423 S.		2-21-56
5	104.35	102.95	1.40									
					4+97.5	4+95.5						
					4+73.5	4+71.5	#310	#1268		338 S.		10-11-01
					4+46.9	4+44.9	#908		Emporia			8-18-25
					4+28.5	4+26.5						
4	104.65	102.72	1.93	4+20.0								
3	104.61	102.61	2.00	3+80.0								
2	105.31	102.03	3.28									
1	106.60	101.71	4.89									
0	106.93	101.60	5.33	0+83.0								
										504 S.		6-20-84
										St. Francis		

See M-162

2003-01064 4/24/03 Northern Pipeline 301 S St Francis - 4" 40 PVC 1045 - 4" Preeco 130' N of 046 to 21.2 1045, 1 Fernco repair @ main 4" 40 PVC

91-120397 6-9-99 600 E Waterman - Interstate P/b - (MTH stub conn - 4" shub) 4" TRAP Installed

C 11380 - 410 S Emporia - 11-12-68 - Keith Willard - tap (6+92.3)

- #1087 - Top - 449 S. St. Francis - 9-22-43 - Robinson P/bq.
- #2537 - Top - 313 S. St. Francis - 12-26-45 - Frederick P/bq. Co.
- #761 - Top - 436 S. Emporia - 10-8-46 - Callison P/bq. Co.
- #560 - Used old connection - 337 S. St. Francis - 8-547 Shepherd P/bq. Co.
- diff # 3722 - 514-16 E Lewis - 6-29-65