

WEST SUB-MAIN "C" IN ALLEY NORTH OF DOUGLAS AVE. AND LAT. N.
 WEST SUB-MAIN "C" ON FIRST ST. AND LAT. N.
 S. S. No. 1-1889

Plat 9-50

TRAP AREA

- 2+15.5 6" Service East 4-23-84
- 6+06 6" Service West 4-23-84
- 5+99 6" Service East 4-23-84
- 5+74 4" Service West 4-24-84
- 5+07 6" Service West 4-24-84
- 4+00.5 6" Service West 4-24-84
- 1+30 6" Service East 5-3-84
- 0+99 6" Service East 5-3-84 201 Emporia *see Below*
- 0+40.7 6" Service West 5-7-84
- 0+41.7 6" Service West 5-7-84
- 3+28 6" Service East 5-9-84

See old sewer book, for info.
 on line replaced by these
 lines in 1926

2004-00090 112104 201 N Emporia Apex Plog
 6" PVC 1-6" WYE + 18" bend, 4-6" 45°

2001-01035-4/30/01-400 E 1ST STN -
 Bob Scott, Replaced 10' on low end
 WYE 41" N Tied to clauytic approx
 4' from main, Trap installed, 1422

Sewer Rehab & Mosley Relief Sewer
 Dist 1 & 20, North of Douglas
 468-80-990-80271-000-000-001
 Built By Stannard Const.
 Booked 7-31-85 From As Built

2+00 6" Service South 7-19-84
 0+38 6" Service South 7-20-84

95-113577 7-24-95 240 N Topeka - 20' N of 1118.0 (5408.0)
 95-130077 8-22-95 240 N Topeka - 18' S of 1118.0 (4122.0)

#8194 101-400 E Douglas - Central Air Cond. Co. Inc. 7-25-63
 7B 4599-201 71 Emporia Gray Bros 11-22-65 - Top (0768.5)
 50# C45850-115-119 71 Emporia - 7/19/74 - J.C. Lewis (1143)
 50. C47697-41618 E Douglas - 12-6-74 - J.C. Lewis (1152)

3173 - 111 N Emporia 4-24-81 Paul Johnson (30.6 S. of 2+36.3) (top 1155.7)
 14697-412 E Douglas Jack Stamp 9-16-85 - (2406)

99-20157-94-48577 41694 154 N Topeka - Redd, R. & R - 12.6' from 1117.4" sub 40" 4" trap & C.O.

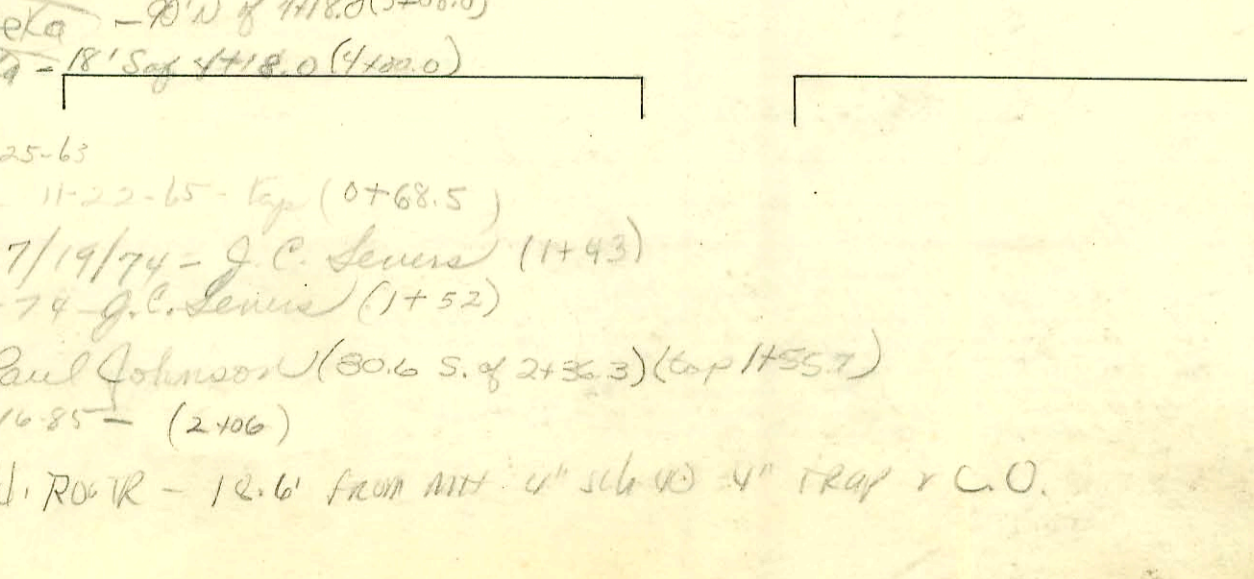
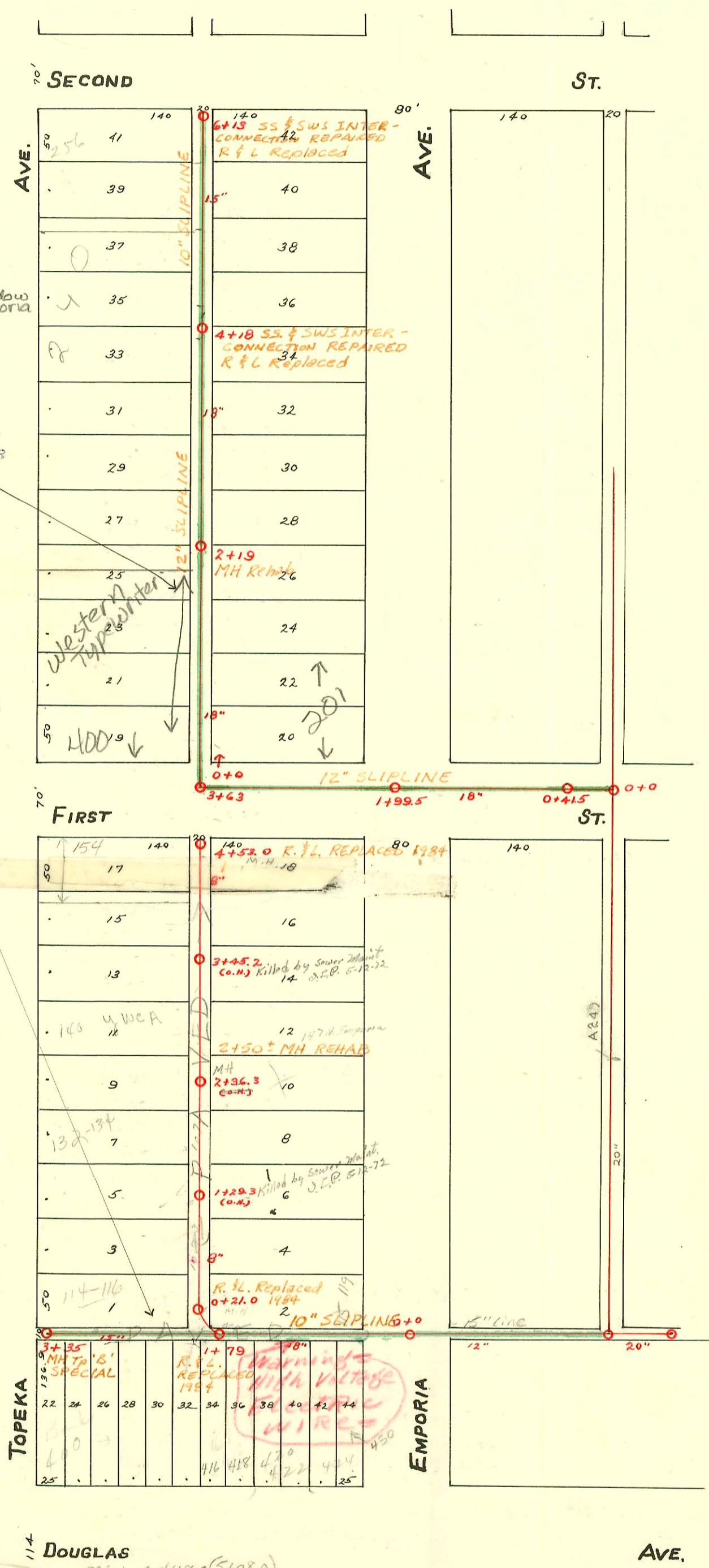

CONSTRUCTION RECORD

SERVICE RECORD

STATION	ELEVATION		Depth	MANHOLE	4-INCH "Y" BRANCHES		No. of Permit		House Number		DATE OF PERMITS	
	Ground	Grade			North West	South East	North West	South East	North West	South East	North West	South East
Line in First St.	0+0	112.13	104.60	7.53	0+0							
	1+0	112.14	104.70	7.44	0+41.5							
	2+0	112.06	104.80	7.26	1+99.5							
	3+0	111.50	104.90	6.60								
		110.90	104.96	5.94	3+63				400			
Line bet. Topeka & Emporia, 1st to 2nd	0+0	110.90	104.96	5.94	0+0	0+41.6	0+34.3	#2001-01035 640	402 E. R. 1st	See next pg	4-30-01	12-17-37
	1+0	111.20	105.06	6.14		0+61.5	0+59					
						0+86.4	0+84					
						1+09.6	1+07					
						1+22.5	1+29.8	Connected	Connected			
						1+32.5	1+55		Connected			
						1+57.5	1+79.4					
						1+82	2+02.2					
	2+0	111.76	105.16	6.60	2+19	2+05	2+15		connected			
						2+28.1	2+25.5	Connected	Connected			
						2+53.5	2+51					
						2+76	2+73.4	Connected	Connected			9-29-61
	3+0	112.06	105.26	6.80		3+01	2+98					
							3+18.2					
							3+26.2		connected			
						3+53.5	3+48.6					
						3+76.2	3+73.5					
						3+99.0	3+96.5	connected				
	4+0	112.50	105.36	7.14	4+18	4+27.5	4+22.2	connected				
	+18		out 105.37 in 105.50			4+45.2	4+47.6		connected			
						4+70.5	4+67.8		connected			
						4+96.5	4+93.9					
	5+0	112.62	105.58	7.04		5+06.9	5+17	connected	connected	440 N. 251 N.		
						5+22.1	5+40.2	connected	connected	Emporia		2-9-25
						5+42.7	5+66.4		connected			
	6+0	112.21	105.68	6.53		5+71.6	5+92	connected				
	+13		105.70		6+13	6+05.5	6+03					
Line bet. Topeka and Emporia, So. of 1st		110.47	106.01	4.46	4+53.0	4+42.6	4+40.6	#166	159 N. Emporia		1-31-60	12-1-94
	4	109.88	105.87	4.01		4+18.5	4+16.5	#139	159 N. Emporia		1-21-60	9-17-94
						3+94.0	3+92.0		159 N. Emporia		3-28-92	3-15-26
						3+67.6	3+65.6					
						3+44.0	3+42.0					
	3	109.05	105.57	3.48		3+19.3	3+17.3	#138	149-51 N. Emporia		5-6-59	3-14-00
						2+94.8	2+92.8					
						2+70.5	2+68.5					
						2+46.8	2+44.8	#138			4-9-69	10-26-91
	2	107.84	105.27	2.57	2+36.3	2+22.5	2+20.5	#49	140 N. Topeka		4-19-05	
						1+98.0	1+96.0	#860	136 N. Topeka		1-3-60	
						1+75.5	1+73.5	#45	134 N. Topeka		11-22-17	
						1+51.7	1+49.7	#267	126 N. Emporia		5-21-91	5-24-20
						1+25.5		#806			1-3-07	11-5-17
	1	108.33	104.97	3.36		1+01.0	1+23.5	#381	118 N. Topeka		12-4-59	6-15-05
							0+99.0	#637	123 N. Emporia		6-27-10	8-29-17
						0+74.8	0+72.8	#942				5-14-54
						0+51.2	0+49.2	B1564	116 N. Emporia		6-24-64	
	0	109.95	104.73	5.22	0+21.0	0+27.0	0+25.0					
Line in Alley N. of Douglas, Topeka to Emporia.	0+0	112.65	106.25	6.40	0+0		0+40	#70635	4300 E. Douglas			3-14-79
							0+63					
						0+99	0+86.3					
	1+0	112.09	106.35	5.74		1+39.8	1+06.6	#52137	424 E. Douglas		10/28/75	
							1+49.5	#61314	470-22 E. Doug		12-28-66	
	1+79	111.81	106.43 out 106.63 in	5.28	1+79		1+73					
							1+73					
	2+0	111.64	106.65	4.99		2+14.2	1+96.6					
							2+39.6					
						2+70	2+62.1					
	3+0	111.40	106.75	4.65		3+12.9	3+07.4					
							3+46.2					
	3+35	111.30	106.79	4.51	3+35							

Note: Storm Water Sewer immediately above Sanitary Sewer.

2026779-1267 Topeka - 12-6-18 at financing (2+53)

23623-134 N. Topeka - Al Henning - 4-7-71 (2+26.3)

#1704 Tap - 11-19-23

#626 wye set - 11-19-13 2+85.8 - Line bet. Topeka & Emporia, S. of 1st - E. wye

#121 Tap - 419 E. 2nd - 3-12-31 J.M. Connaughton

#310 Tap - 408 E. Douglas - 12-18-35 C.C. McLaughlin

#81 Used old connection - 114 N. Topeka - 5-28-47 Simmons Pibg. Co.

#322 Tap at 0+70 - 500 E. Douglas - 10-11-41 J.E. Lansdowne

#130 Used old connection - 143 N. Emporia - 1-2-47 Baker Pibg.

5128 (243 N. Emporia) 10-1-82 Al Henning 4418.0N

94-4857-7 - 154 N Topeka - 4544 - Riddi Root - R-18.6 53 M4 44540PVC

#12182 Lead off 114 N. Topeka Riddi Root - 27-60 (2+73)

16011 Lead off 6213 N. Emporia - 2-10-62

new 130 N Topeka - Randall Pibg. - 2-3-71 tap (3+41)

20C6676-4-9-77-4125 - Fort - Jim Morris - (0+10)