

# Plat 9-50

3<sup>rd</sup> St.

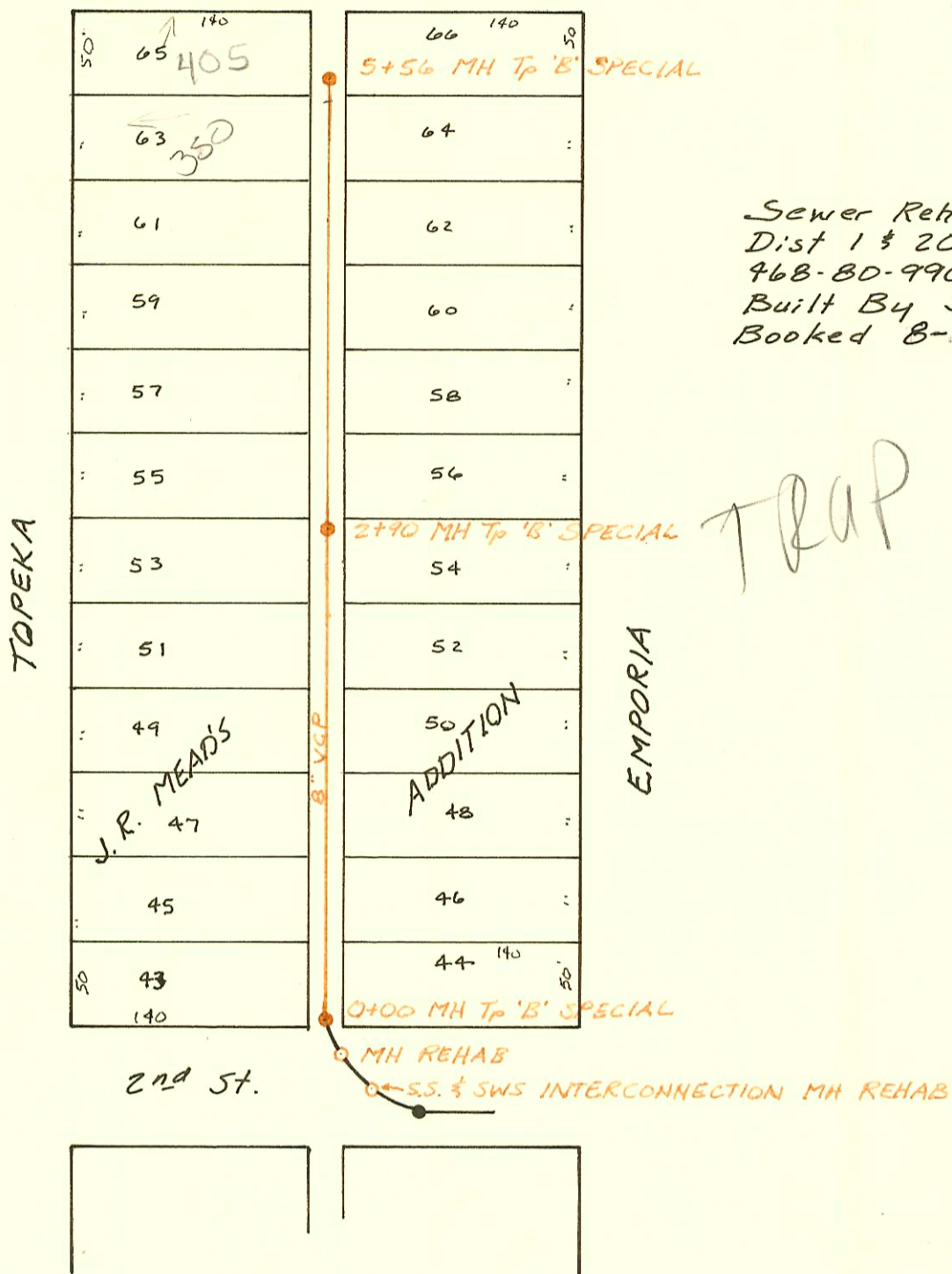

Sewer Rehab & Masley Relief Sewer  
 Dist 1 & 20, North of Douglas  
 968-80-990-80271-000-001  
 Built By Stannard Const.  
 Booked 8-9-85 from As Built

TRAP AREA



97.00473402x 4/1/1997 428 N Topeka - Ks Ditch - 4" sch 40 PVC - 94' S PMH  
 2-Twin C.O 1-TRAP 1- Wye for 2nd K.O.

Sub 2000-00314 2-4-2000 427 N EMPORIA

CONSTRUCTION RECORD

SERVICE RECORD

STATION	ELEVATION		Depth	MANHOLE	4-INCH "Y" BRANCHES		No. of Permit		House Number		DATE OF PERMITS	
	Ground	Grade			North West	South East	North West	South East	North West	South East	North West	South East
				4 + 44.0								
4	113.41	109.66	3.75		4 + 37.0	4 + 39.0	0.7				7-14-72	
	113.20	109.48	3.72		4 + 11.1	4 + 13.1	#33588	79	414 E	403 N Emporia	4-12-00	2-17-31
					3 + 86.8	3 + 88.8						
					3 + 62.0	3 + 64.0						
3	112.36	109.08	3.28		3 + 37.3	3 + 39.3	#923		405 N Emporia		10-28-26	2-27-99
					3 + 12.7	3 + 14.7	#4874		404 N Topeka	419 N Emporia	10-25-61	8-21-64
					2 + 88.6	2 + 90.6	#18288					11-13-23
					2 + 64.0	2 + 66.0	#17430		420 N Topeka		4-22-94	
2	112.49	108.68	3.81		2 + 39.7	2 + 41.7	#345				4-7-25	
					2 + 15.7	2 + 17.7	#145				11-20-90	
					1 + 90.7	1 + 92.7			427 N Emporia			5-24-29
					1 + 66.0	1 + 68.0	#2349		424 N Topeka		10-17-24	6-11-08
					1 + 41.1	1 + 43.1						
1	112.34	108.28	4.06		1 + 16.8	1 + 18.8	#23405		435 N Emporia		3-23-71	7-25-92
					0 + 92.0	0 + 94.0	#80		439 N Emporia			5-13-07
					0 + 67.6	0 + 69.6						5-30-00
					0 + 44.9	0 + 46.9						
0	111.98	107.98	4.00	0 + 24.7	0 + 28.4	0 + 30.4	#83	#469	445 N Emporia		7-29-91	8-2-18
	112.00	108.50	3.50	5 + 23.5	5 + 19.5	5 + 27.0	#22808		405 E Central		6-3-92	
5	112.13	108.40	3.73		4 + 99.3	4 + 75.3	#15				1-18-94	
					4 + 51.2	4 + 30.6						
					4 + 30.6	4 + 05.8						
4	112.49	108.00	4.49		3 + 87.4	3 + 57.0	#18884		411 E Central		4-17-70	
	111.98	107.88	4.10	3 + 71.4	3 + 32.6	3 + 07.9	#18622		415 E Central		7-18-91	10-10-73
					2 + 83.4	2 + 59.6	#B-798		447 N Emporia		6-26-00	10-21-63
3	111.86	107.60	4.26		2 + 37.0	1 + 39.0					7-23-01	
					1 + 16.8	1 + 14.3	#103		450 N Emporia		3-28-16	6-27-73
2	111.63	107.20	4.43		0 + 94.7	0 + 72.7	#39765		442 N Emporia		5-14-14	
					0 + 72.7	0 + 50.0						
1	111.98	106.80	5.18		0 + 27.4	9 + 99.0					6-24-04	
0	112.09	106.50	5.59	0 + 23.5	9 + 83.0	9 + 81.0						
10	113.06	109.20	3.86	10 + 02.0	9 + 58.7	9 + 56.7	#100		421 E Emporia		10-26-72	7-9-65
					9 + 34.5	9 + 32.5			335 N Emporia		4-26-00	5-22-90
9	113.28	108.80	4.48		9 + 10.3	9 + 08.3					8-8-03	
					8 + 79.3	8 + 85.8						
					8 + 63.5	8 + 61.5						
					8 + 39.7	8 + 37.7						
8	112.77	108.40	4.37		8 + 15.3	8 + 13.3	#428		340 N Topeka		7-12-09	
					7 + 91.2	7 + 89.2	#101		336 N Topeka		4-25-94	
					7 + 67.4	7 + 65.4	#89		349 N Emporia		6-2-05	
					7 + 43.3	7 + 41.3	#69		328 N Topeka		4-14-08	
7	112.58	118.00	4.58	7 + 12.7	7 + 18.9	7 + 16.9	#102		334 N Topeka		3-17-15	
					6 + 94.7	6 + 92.7	#91		322 N Topeka		5-25-07	10-27-00
					6 + 70.5	6 + 68.5						7-9-81
					6 + 46.8	6 + 44.8						3-15-76
6	112.70	107.60	5.10		6 + 22.6	6 + 20.6	#228	#193	324 N Topeka	31971 Emporia	10-13-08	8-29-06
					5 + 98.7	5 + 96.7						
					5 + 74.3	5 + 72.3	#1243		308 N Topeka		8-22-23	
					5 + 50.1	5 + 48.1						
					5 + 26.0	5 + 24.0						
5	113.16	107.20	5.96		5 + 01.2	4 + 99.2	#5383		402 E Topeka		10-19-67	
					4 + 77.0	4 + 75.0	#5986		245 N Topeka		9-29-51	
					4 + 52.8	4 + 50.8	#162		302 N Topeka	418 E Emporia	12-15-03	9-5-46
4	112.74	106.89	5.85	4 + 22.8	4 + 28.5	4 + 26.5	#609		402 E Topeka		11-7-67	
3	111.51	106.54	4.97	3 + 36.4								
2	111.34	106.00	5.34									
1	110.15	105.60	4.55									
0	110.32	105.31	5.01	0 + 38.6								

C 29531 - 357 N. Emporia - Seal off - at Henning - 12/17/71 (9+71) + 37' East  
 C 20680 - 417-419 E 3rd Seal off - at Henning 8-25-70 (9+75) + 39' East  
 #1613 - Top - 443 N. Emporia - 6-2-39 - W.O. Harrison  
 #1683 - Top - 445 N. Emporia - 6-27-39 - W.O. Harrison (2+80.4)  
 #2870 - Top - 430 1/2 N. Topeka - 11-15-40 - Harley Kiggs  
 #1245 - Private line - 435 1/2 N. Emporia - A.K. Kime - 3-23-42  
 #636 - 315 N. Emporia - 9-9-46 - J.E. Lansdowne - Used old connection  
 #283 - Private line & Top - 402 E. 2nd - 1-28-52 - Davidson P/bq.  
 #B4025 Seal off - 347 N. Emporia - J.C. Sears - 8-26-65  
 #B5179 - Seal off - 316 N. Topeka - 3-3-66 - al Henning  
 C 20070 - Seal off - 346 N. Topeka - 7-10-70 - al Henning (8+85)  
 (House in record also sealed off with this record.)  
 #5764 Top - 6' in 8" 354 N. Topeka - Redstone 9-9-57  
 C 25282 - 433 N. Emporia - al Henning - 7-6-91 (435 N. Emp)  
 C 54186 - Seal off - E. Jones 323 N. Emporia - 2-15-76 (6+96.7) 141' long 44' dia  
 C - 56074 - Seal off - 339 N. Emporia -  
 #704 710 (320 N. Topeka) Henning 12-3-82  
 #7165 Seal off - Emporia Henning 4-22-87  
 8995 (447 N. Emporia) 8-15-83 - al Henning 371.4 E (2125 N)