

MAIN "C" FROM ALLEY BETWEEN TOPEKA AND EMPORIA TO 17TH ST.
LAT. SOUTH FROM MAIN "C" ON SEVENTEENTH ST. IN ALLEY EAST OF BROADWAY AVE.
S.S. No. 1 - 1889

Plat 9-41

TRAP AREA

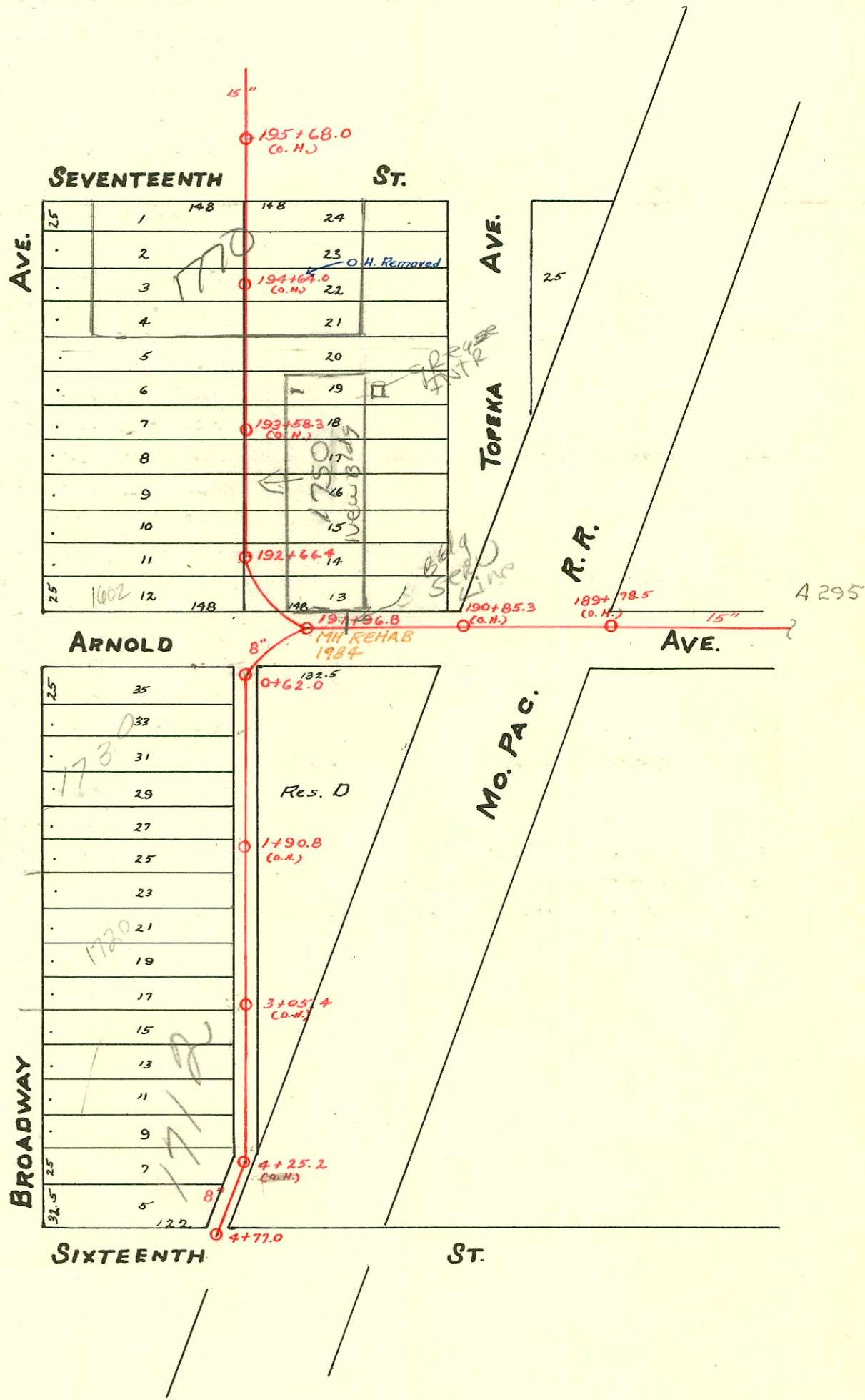

CONSTRUCTION RECORD

SERVICE RECORD

STATION	ELEVATION		Depth	MANHOLE	4-INCH "Y" BRANCHES		No. of Permit		House Number		DATE OF PERMITS	
	Ground	Grade			North West	South East	North West	South East	North West	South East	North West	South East
	119.00	116.20	2.80	4+77.0								
					4+75.2			12007		1700 N Broadway		9-13-84
					4+55.2					1712 N Broadway		7-31-85
4	119.07	116.06	3.01		4+30.2			14356		1702 N Broadway		11-18-21
	119.14	116.00	3.14		4+05.5			#11A1		1720 N Broadway		5-27-63
					3+80.6					1720 N Broadway		5-27-63
					3+56.0			C37739		1716 N Broadway		5-27-63
					3+32.1	3+34.1		#17181		1720 N Broadway		10-5-22
3	119.70	115.75	3.95		3+08.3	3+10.3				1720 N Broadway		3-27-73
					2+84.0	2+86.0		#1302		1720 N Broadway		12-19-79
					2+59.5	2+61.5		C37939		1720 N Broadway		1-22-09
					2+36.2	2+38.2				1720 N Broadway		1-22-09
2	120.67	115.50	5.17		2+12.3	2+14.3		C75782		1720 N Broadway		1-22-09
					1+87.0	1+89.0		#13413		1720 N Broadway		
					1+63.0	1+65.0		#341		1730 N Broadway		
					1+39.0	1+41.0						
1	120.79	115.25	5.54		1+15.0	1+17.0		#1265		1730 N Broadway		10-6-19
					0+91.0	0+93.0						
0	120.84	115.15	5.69	0+62.0	0+65.0	0+67.0						
					195+90.5	195+88.5						
					195+68.0(O.H.)							
					195+66.5	195+64.5						
					195+42.2	195+40.2						
195	122.44	115.25	7.19		195+17.5	195+15.5						
					194+83.0	194+81.0						
					194+68.0	194+66.0						
					194+44.8	194+42.8						
194	122.04	115.15	6.89		194+20.0	194+18.0		#1704		317 E 17th		12-12-22
					193+95.7	193+93.7						
					193+71.9	193+69.0						
					193+47.5	193+45.5						
193	122.12	115.05	7.07		192+23.0	193+21.0		#1270		1746 N Broadway		5-13-31
					192+98.3	192+96.3		#1404		1741 N Topeka		10-23-22
					192+74.0	192+72.0		#2				1-4-35
	121.84	114.95	6.89	192+66.4	192+58.4					1730 N Broadway		5-3-09
					192+50.0	192+48.0		#243		1747 N Topeka		11-28-79
					192+21.0	192+19.0		#76		1730 N Broadway		5-8-07
192	120.91	114.68	6.13	194+96.8				#1310				10-9-22
191	120.61	114.59	6.02									
190	120.52	114.49	6.03									
189	121.37	114.39	6.98	189+78.5(O.H.)								

C 26336-333 Arnold 8-10-71 top (1+58)
 C 26337-333 Arnold 8-10-71 top (2+07)
 C 26335-333 Arnold 8-10-71 top (1+12.6)
 #1262 - Top - 9-27-22
 #248 - Top - 3-28-22
 #262 - Top - 1770 N Broadway (International Harvester Co.) 11-4-35 - Simmons Plbg. Co.)
 #272 - 1702 N Broadway - T-11-36 - R. La Foy - Used old connection.
 S.O. 26335-1718 N. Broadway - 10/12/72 - J.C. Lewis - (3+37)