

MAIN "D" FROM DEWEY ST. (N.) TO ENGLISH ST.
S.S. No. 1 - 1889

Plat 9-53

RECONSTRUCT SANITARY SEWER NO. 1+20
PROJ. NO. 468-81996 (630541)
BUILT BY W.B. CARTER CO.
BOOKED 4-28-95 FROM AS BUILTS

TRAP AREA

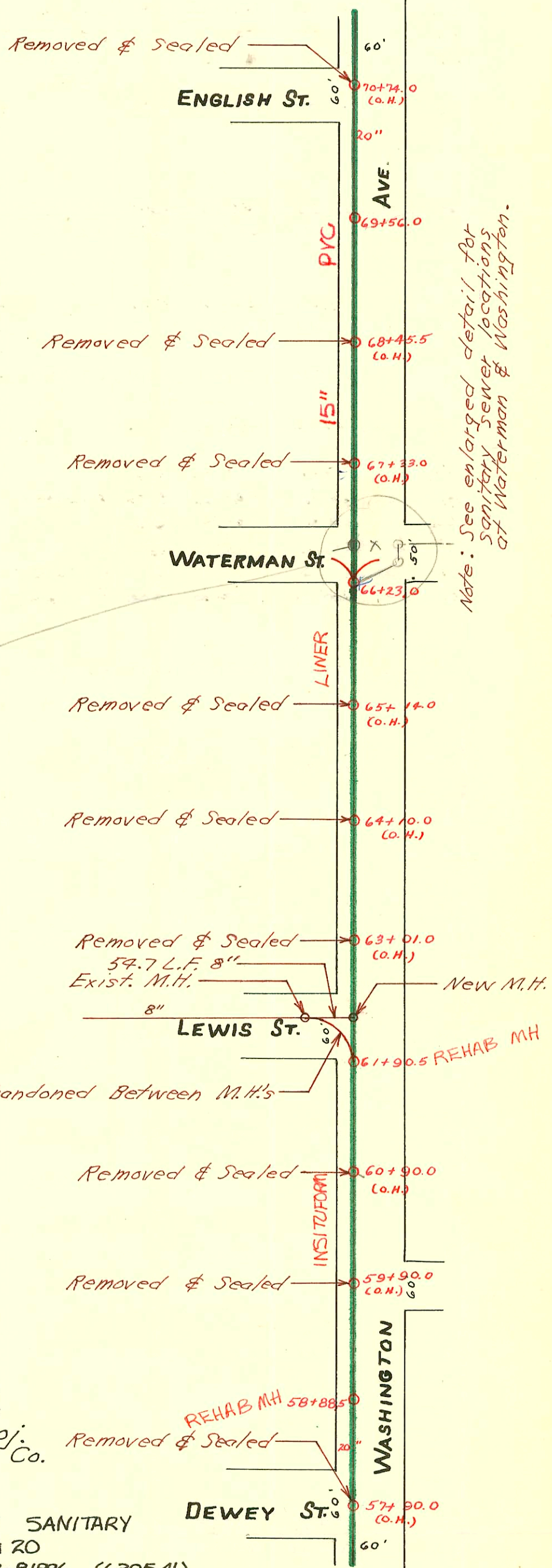
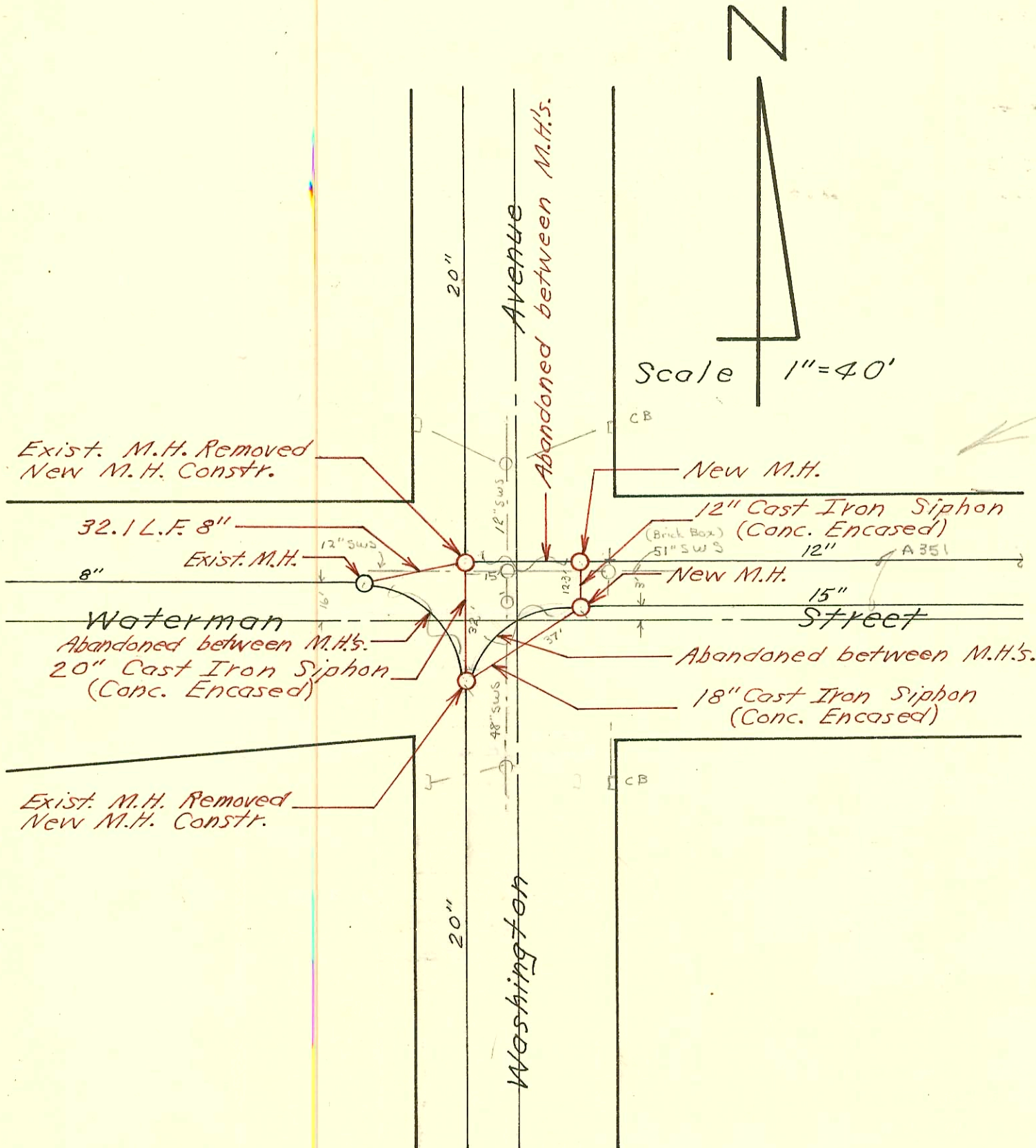

Note: See enlarged detail for sanitary sewer locations at Waterman & Washington.

Note: New sanitary sewer construction shown on this page was constructed in conjunction with Incidental Drainage on Washington Ave. from N.L. Kellogg to S.L. Douglas, Proj. No. C 19-85. Contractor W.B. Carter Constr. Co. Booked Nov. 1970.

RECONNECTIONS

STATION	ADDRESS	DIRECTION
65+15.1	307 S. Washington	West
64+16.4	319 S. Washington	West
63+68.7	321 S. Washington	West
64+17.1	411 S. Washington	West
60+11.1	423 S. Washington	West
59+15.5	427 S. Washington	West
68+35	No Address	West
67+13	No Address	West

RECONSTRUCT SANITARY SEWER NO. 1+20
PROJ. NO. 468-81996 (630541)
BUILT BY INSITUFORM PLAINS, INC.
BOOKED 5-16-94 FROM AS BUILTS

CONSTRUCTION RECORD						SERVICE RECORD						
STATION	ELEVATION		Depth	MANHOLE	4-INCH "Y" BRANCHES		No. of Permit		House Number		DATE OF PERMITS	
	Ground	Grade			North West	South East	North West	South East	North West	South East	North West	South East
70	107.53	100.42	7.11	70+74.0(O.H.)								
69	107.33	100.32	7.01	69+56.0								
68	107.48	100.22	7.26	68+45.5(O.H.)								
67	107.59	100.12	7.47	67+33.0(O.H.) 66+23.0	67+23		#500		221 S. Washington		8-21-14	
66	107.46	100.02	7.46		66+07.0 65+82.0 65+57.0 65+32.0							
65	107.95	99.92	8.03		65+07.0 64+82.0 64+55.0 64+34.0		#189		321 S. Washington		2-16-04	
64	108.48	99.82	8.66		64+07.0 63+82.0 63+57.0 63+32.0 63+08.0		#258 #1558		319 S. Washington 321 S. Washington		7-25-61 2-24-59 Trailer 11-16-22	
63	109.29	99.72	9.57		62+82.0							
62	108.84	99.62	9.22		62+57.0		#1102		415 S. Washington		7-24-23	
61	108.80	99.52	9.28	61+90.5								
60	108.46	99.42	9.04									
59	108.29	99.32	8.97									
58	108.54	99.22	9.32	58+88.5								
57	108.78	99.12	9.66	57+90.0(O.H.)								

#308 - 4-22-20
 Tap - 267 S. Washington - 2-9-28 - Simmons Pkg.
 Tap - 305 S. Washington - 7-22-36 - Ripstra Pkg.
 Tap - 401 S. Washington - 4-12-40 - W.W. Fry
 Tap - 427 S. Washington - 12-23-46 - Pray Bros.
 #1989 - Tap - 423 S. Washington - 5-8-47 - Davidson Pkg. Co.
 #4266 - Tap - 231 S. Rock Island - 4-3-51 - Thompson Pkg. Co.