

WEST SUB-MAIN "D" ON WATERMAN ST. AND LAT. N. ON ROCK ISLAND
 AVE. AND WEST SUB-MAIN "D" IN ALLEY SOUTH OF DOUGLAS AVE.
 AND LAT. W. AND TWO LAT'S SOUTH.

A 347

S.S. No. 1 - 1889.

TRAP AREA

Plat 9-53

Reconst. Portion W. Sub. D. S.S. #1
 W.B. Carter - Contr.
 BK. 37 - Proj. No. C22-72
 Booked Sept. 8, 1952.

1989 S.S. Reconst. Phs II
 468-82011 (725002)
 Built By Insituform Plains
 Booked 10-16-90 from Plan

DOUGLAS AVE.

AVE.

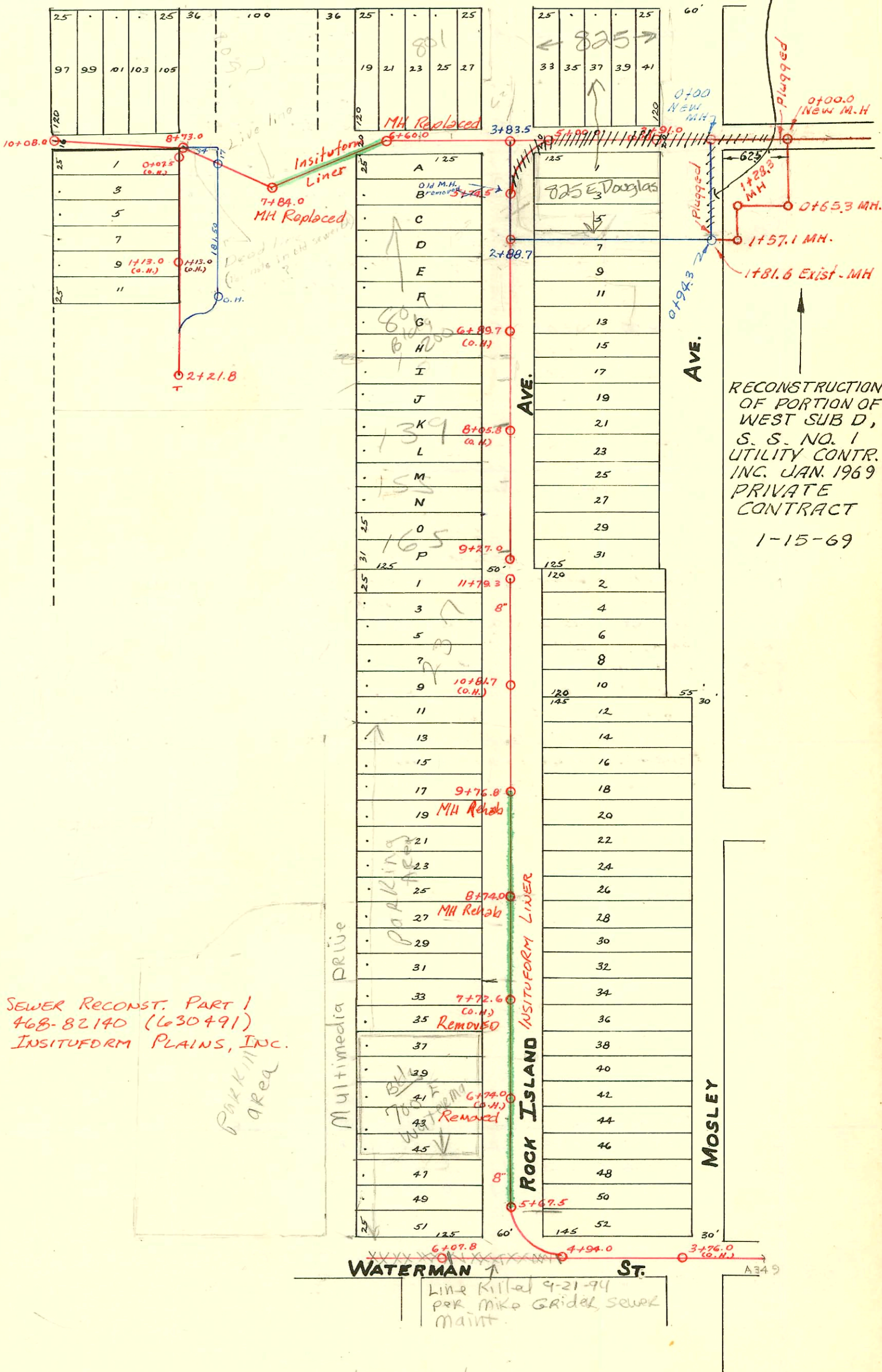

RECONSTRUCTION
 OF PORTION OF
 WEST SUB D,
 S. S. NO. 1
 UTILITY CONTR.
 INC. JAN. 1969
 PRIVATE
 CONTRACT
 1-15-69

1991 SAN. SEWER RECONST. PART I
 PROJ. NO. 468-82140 (630491)
 BUILT BY INSITUFORM PLAINS, INC.

94-573-7 F11-94 700 E Waterman N/C
 - 4" PVC 40' - Tap - 42' N (6+59.5) 4" trap installed
 Central Mechanical, Paved street cut - 1/4" p/d shallow

CONSTRUCTION RECORD						SERVICE RECORD						
STATION	ELEVATION		Depth	MANHOLE	4-INCH "Y" BRANCHES		No. of Permit		House Number		DATE OF PERMITS	
	Ground	Grade			North West	South East	North West	South East	North West	South East	North West	South East
5	109.56	103.10	6.46	5+74.5 (M.H. removed)	5+85.0	5+83.0						
6	109.55	103.18	6.37	New M.H. 2+88.7	6+09.0 6+32.8 6+56.2	6+07.0 6+30.8 6+54.2	#119	#3	115 (2) 123 8.5 Rock Island		2-19-88 12-15-33	1-9-03
7	109.41	103.48	5.93	city Tap 7+17	6+80.0 7+03.8 7+27.4 7+50.8 7+74.3 7+97.3	6+78.0 7+01.5 7+25.4 7+48.8 7+72.3 7+95.3	2000- 02076 #1126 #359 #341	Frisco Freight Depot	801 E DOUGLAS 133 S. Rock Island 187 S. Rock Island W. B. Smith's Rock Island		9/20/00	1-9-03
8	109.57	103.78	5.79		8+22.2 8+46.3 8+70.2 8+94.6	8+20.2 8+44.3 8+68.2 8+92.6						
9	109.19	104.08	5.11		9+19.3	9+17.3	B1354		155 S. Rock Island		6-3-64	
<p>Reconst. Portion of W. Sub. D, S.S. No. 1. - Benefit Dist. includes lots 33, 35, 37, 39, 41 Douglas Ave. & lots 1, 3 & 5 and the North 5 feet of lot 7, Masley Ave, All in W. B. Smith's Addn.</p>												
0	109.9	102.43	7.5	0+00								
1	109.8	102.53	7.3	0+94.3								
2	109.8	102.63	7.2		4" SCH 40 1+76.7		2000- 02340		825 E Douglas		10-25-00	
3	110.3	102.72	7.6	2+88.7	No Wye's							
	110.2	102.74	7.5									
	110.2	102.82	7.4	3+83.5								
<p>Change in 8" sewer indicated by blue lines. 8' East of old M.H. (8+73) - 6 in Y North. 10 1/2' " " " " " - 6 in Y South. 25 1/2' " " " " " - 6 in Y North. Ran the new line East from above M.H. 34 ft. - then South on 1/4 bend 17 ft and put in new M.H. at intersection of this line with old line. 57' South of new M.H. - 6 in Y East 59 1/2' " " " " - 6 in Y West 117' " " " " - 6 in Y West or 4 1/2 ft North of new O.H. New O.H. is 12 1/2 ft. South of new M.H. " " is 10 1/2 ft. North of North side of William St, extended From which point put in a curve west and connected with old line by a reverse curve 45 ft. North of "T".</p>												
<p>RECONSTRUCTION OF PORTION OF WEST SUB. D, S. S. NO. 1</p>												
0+00	110.3	102.26	8.0	0+00 ²								
	110.3	102.36	7.9	0+65 ³								
1+00	110.0	102.42	7.6									
	109.5	102.46	7.0	1+28 ³								
	110.2	102.49	7.7	1+57 ¹								
1+81 ⁶	110.2	102.52	7.7									
1+81 ⁶	End 8" V.C.P.			Exist. M.H.								
<p>SWR 2000-02339 10/25/00 825 E Douglas (Press Room Remodel - The Fagan Co.) SWR 2000-02340 10/25/00 825 E Douglas (Press Room Remodel) The Fagan Co. See above 4" SCH 40, Preco - 1 TWIN CO, 1V45 112' E MH 2+88.7 (1+76.7) 12254 701 E Douglas 10-17-84 Rockland (0-00) add. conn. MH to 5' (0-00) #10976 701 E Douglas 5-22-84 Oak Rockland - MH taps (0-00) 98-1977-7 2-10-98 801 E Douglas (AKA 811 E Douglas) - A Plus Hwy - S/O 69' E of MH With 6x4 Fernco clamp + 4' PVC Solid Cap (Note this line hit by KGB, D.L. determined it was a dead line)</p>												
<p>12986 Tap 167 S. Rock Island May 10 60 (7195.8)</p>												

CONSTRUCTION RECORD							SERVICE RECORD					
STATION	ELEVATION		Depth	MANHOLE	4-INCH "Y" BRANCHES		No. of Permit		House Number		DATE OF PERMITS	
	Ground	Grade			North West	South East	North West	South East	North West	South East	North West	South East
2	110.32	105.38	4.94	2 + 21.8	2 + 02.0	2 + 01.0		?				8-7-01
					1 + 79.3	1 + 77.3		?		(Main Station) 751 E. Douglas		5-10-02
					1 + 54.3	1 + 52.3		264900				2-3-78
1	111.40	105.08	6.32		1 + 31.2	1 + 29.2						
					1 + 07.3	1 + 05.3						
					0 + 82.3	0 + 81.3						
					0 + 59.9	0 + 57.9						
					0 + 34.0	0 + 32.0						
0	111.16	104.80	6.36	0 + 07.5 (O.H.)	0 + 10.5	0 + 08.5						
10	111.68	104.76	6.92	10 + 08.0								
					9 + 81.0							
					9 + 57.0							
9	111.62	104.46	7.16		9 + 33.5		#1 17432 ?		705 E. Douglas 311 Douglas			1-2-95
					9 + 09.5							5-31-98
					8 + 83.7							12-11-86 David Howell
	111.42	104.40	7.02	8 + 73.0								
					8 + 58.0							
					8 + 35.0							
8					8 + 00.0		#756		809 E. Douglas			12-2-09
					7 + 87.5							
	110.78	103.76	5.91	7 + 84.0								
7	109.67	103.51	6.16		7 + 73.7	7 + 75.7	#570					9-9-09
					6 + 60.0							
					6 + 42.6		#570					9-9-09
6	110.20	103.12	7.08		6 + 20.2		#570 1977		801.5 E. Douglas Rock Island 115 S. Rock Island			9-9-09
					5 + 93.4		72					1-9-03
					5 + 68.6	5 + 64.7	#97	#2649	Revised			8-1-90
5	109.84	102.87	6.97	5 + 00.0								2-2-46
					4 + 93.4		#548		817 E. Douglas			6-24-21
					4 + 69.3							
					4 + 45.0							
4	108.51	102.62	5.89		4 + 19.8							
					3 + 93.0							
3	108.67	102.37	6.30	3 + 91.0 (O.H.)								
					11 + 79.3							
					11 + 75.3	11 + 77.3						
					11 + 50.8	11 + 52.8						
					11 + 26.8	11 + 28.8						
11	109.69	105.31	4.38		11 + 02.2	11 + 04.2	?	#815		125 S. Masley		8-16-01
					10 + 78.0	10 + 80.0						10-21-46
					10 + 53.7	10 + 55.7						
					10 + 26.3	10 + 28.3						
10	109.84	105.01	4.83		10 + 05.3	10 + 07.3						
					9 + 76.8	9 + 83.0		#50		RR Co.		4-5-06
					9 + 59.0	9 + 61.0		#204				3-15-04
					9 + 35.0	9 + 37.0		?				4-15-01
9	110.04	104.71	5.33		9 + 10.5	9 + 12.5						
					8 + 89.6	8 + 91.6						
					8 + 74.0							
					8 + 62.0	8 + 64.0						
					8 + 37.5	8 + 39.5						
8	110.16	104.41	5.75		8 + 13.6	8 + 15.6						
					7 + 89.3	7 + 91.3	#200	#1740	Grant of right to use for R.R. Street	Frisco R.R. Street		10-18-07
					7 + 65.2	7 + 67.2						3-10-48
					7 + 39.0	7 + 41.0						
7	110.10	104.11	5.98		7 + 14.6	7 + 16.6						
					6 + 92.2	6 + 92.2						
					6 + 66.5	6 + 68.5	#69		345 S. Rock Island United Rock Island			5-13-05
					6 + 41.5	6 + 43.5						
6	109.81	103.81	6.00		6 + 20.0	6 + 22.0						
					5 + 95.3	5 + 97.3						
					5 + 72.0	5 + 74.0	#171		No Record			7-25-93
5	109.76	103.72	6.04	5 + 67.5								
6	109.88	104.14	5.74	6 + 07.8	6 + 02.8		#248	Sash & Durr Co.				1-15-01
5	110.17	103.54	6.63		5 + 76.5	5 + 74.5	#373					6-21-02
4	110.17	103.48	6.69	4 + 94.0								
3	109.83	102.34	7.49	3 + 76.0 (O.H.)								

CONT. ON NEXT PAGE.

#1666 - Tap - 12-5-22
 #300 - Wye - 237 S. Rock Island - 3-22-56 - Pray Bros.
 #301 - Wye - 237 S. Rock Island - 3-22-56 - Pray Bros.
 #2913 - Tap - 12-16-24 - Brodie
 #1191 - 8-29-29 - Long Pibg. Co.
 #1410 - 10-3-29 - Long Pibg. Co.
 #1120 - Private line - 701 E. Douglas - 10-3-38 - Chester Davidson
 Rec. # 51656 - Tap - 701 E. Douglas - 2-12-57 - Kendall Pibg.
 #6428 - Tap - 825 E. Douglas - 9-14-53 - Davidson Pibg.
 #2409 - Tap - 159 S. Rock Island - 11-9-45 - Ripstra Pibg.
 #4266 - Tap - 231 S. Rock Island - 4-3-51 - Thompson Pibg. Co.
 #4018 - 6 on 8 wye - 825 E. Douglas - 2-4-53 - Davidson Pibg. Co.

#12986 - tap 167 S. Rock Island - Pray Bros. 7-12-60
 #14589 809 E. Douglas - Howell 8-27-95 (9466)
 #93-1482-7 245 S. Rock Island 1/27/93 - 5/6 125 feet
 North of M.H. (6+92.5)
 #93-1484-7 245 S Rock Island 1/27/93 canceled - fee + transfer to #93-1458-7 on 7/4/93
 #93-1485-7 245 S. Rock Island 1/27/93 - permit not needed transfer to #93-1461-7 on 2/4/93
 #93-1481-7 245 S. Rock Island 1/27/93 - permit not needed transfer to 93-1459-7 on 2/18/93

A

address changed
to 800 E. Waterman
6/3/94

94-573-7 7-11-94 700 E Waterman (Multimedia Cable Bldg) UIC-

- 93-29965-7 12-1-93 ⁴¹⁰ 245 S. Rock Island - Henning - 5/0 - 6" Cast iron line sealed off at EPL and 12 ft south of MH # 9176.8 (9+64.8) - No alley cut
- 93-29964-7 12-1-93 ⁴¹⁰ 245 S. Rock Island - Henning - 5/0 - 6" Cast iron line sealed off at EPL and 27 ft north of MH # 8774.0 (9+01.0) - No alley cut
- 93-29975-7 12-1-93 ⁴¹⁰ 245 S. Rock Island - Henning - 5/0 - 6" Clay tile line sealed off at EPL and 9 ft south of MH # 5467.5 (5+58.5) - No alley cut
- 93-22736-7 8-26-93 ⁴¹⁰ 245 S. Rock Island - Henning - 5/0 - 6" Cast iron line sealed off at bsmt wall (NPL) and 35 ft west of EPL