

WEST SUB-MAIN "D" IN ALLEY SOUTH OF SECOND ST. AND LAT. NORTH
S.S. No. 1 - 1889

Plat 9-50

Line abandoned here
to new MH per
project thru system
planning area
NO INFO

TRAP AREA

2002-00713 - 315102 - 325' Head McCullough
30 85's of mt 10+29.6 (9+44.5)
2002-00698 314-02 325' N Head slot
McCullough (9+74.6)
55's and 85's of mt
2002-00699 314-02 705' Head slot
McCullough MH 10+29.6 (12+05.6)

- (Coleman Bldg) S/O
SEP Below
- 3+46.7 6" Service South 4-25-84
 - 3+44.0 4" Service South 4-25-84
 - 2+13.0 4" Service South 4-30-84
 - 7+56.8 6" Service West 4-25-84
 - 8+48.8 6" Service East 4-25-84
 - 8+50.8 6" Service East 4-25-84
 - (5+47) 6" Service East 4-26-84
 - 13+20.4 6" Service East 4-24-84
- (Coleman) S/O
SEP Below

Sewer Rehab & Mosley Relief Sewer
Dist 1 & 20, North of Douglas
468-80-990-80271-000-000-001
Built By Stannard Const.
Booked 8-6-85 From As Built

SANITARY SEWER IMPROVEMENT IN
CONNECTION WITH PAVING MOORE ST. - 1ST TO 2ND
PROJ. NO. 472-82486 (762674)
BUILT BY W. B. CARTER CONST. CO.
BOOKED 12-5-95 AS PER PLAN

RECONNECTIONS

STATION	ADDRESS	DIRECTION
3+85		West
4+33		West
4+59		West
6+17		East
6+28		West
2+39		West
1+93		West
1+25		West
0+42		West

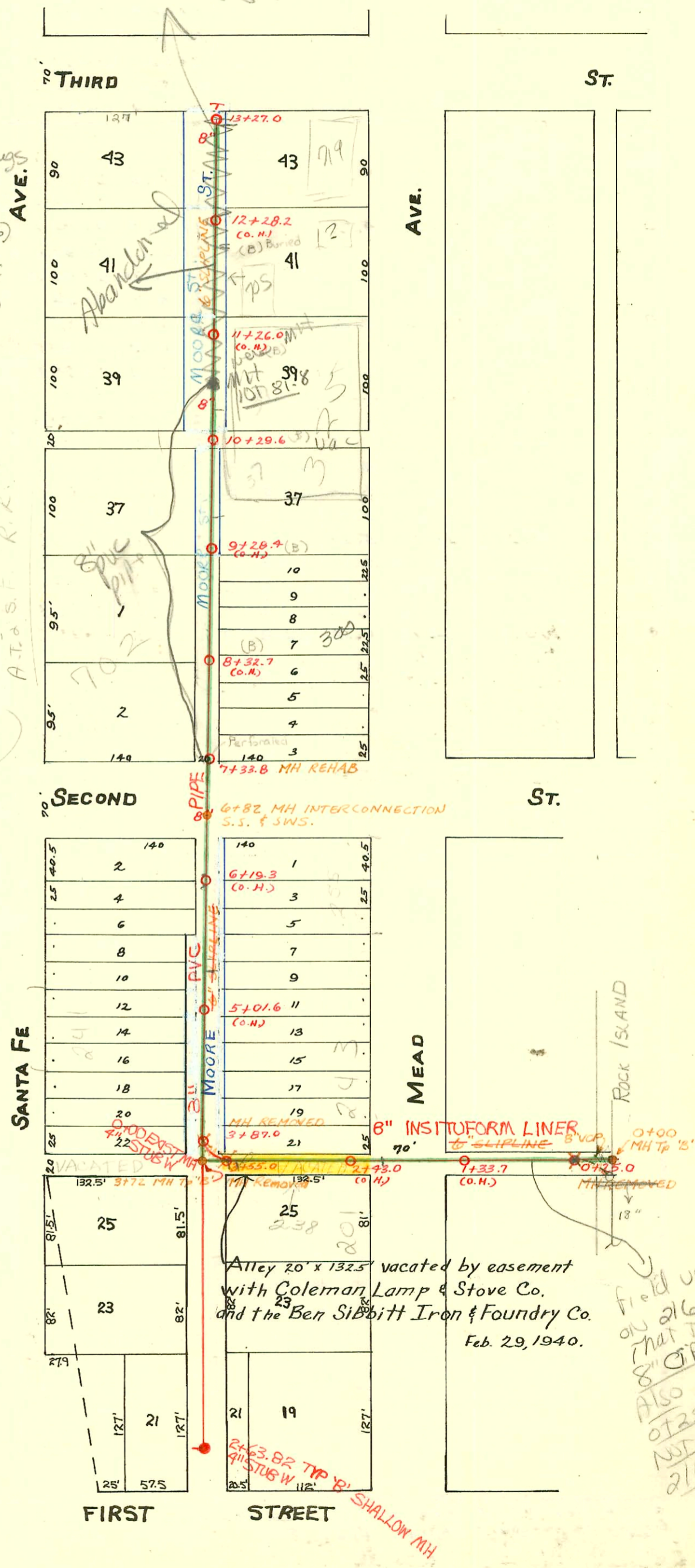

field verified
on 2/6/02
that this is
8" CIPP pipe
Also MH
0725 was
NOT removed
2/6/02
BA

CONSTRUCTION RECORD

SERVICE RECORD

STATION	ELEVATION		Depth	MANHOLE	4-INCH "Y" BRANCHES		No. of Permit		House Number		DATE OF PERMITS	
	Ground	Grade			North West	South East	North West	South East	North West	South East	North West	South East
				13+27.0								
13	110.93	106.97	3.96		13+06.3	13+04.3						
					12+81.3	12+79.3						
					12+57.0	12+55.0						
					12+32.6	12+30.6						
12	110.39	106.72	3.67		12+08.0	12+06.0						
					11+83.0	11+81.0						
					11+58.5	11+56.5						
					11+34.6	11+32.6						
11	110.25	106.47	3.78		11+11.0	11+08.0		#2380		341 N. Mead		10-22-24
					10+84.6	10+82.6						
					10+60.0	10+58.0		#2039		335 N. Mead		9-8-24
				10+29.6	10+35.6	10+33.6						
10	110.25	106.22	4.03		10+11.0	10+09.0						
					9+86.0	9+84.0						
					9+61.5	9+59.5		#47		Mead		4-10-93
					9+37.0	9+35.0						
9	110.10	105.97	4.13		9+12.7	9+10.7						
					8+87.8	8+85.8						
					8+63.0	8+61.0		#86		no record		2-27-11
					8+39.0	8+37.0		#202		Western Iron Foundry		2-8-43
8	109.79	105.72	4.97		8+14.5	8+12.5		#685		no record		9-9-20
					7+99.5	7+87.5		#270		Western Iron Foundry		1-11-07
					7+79.0	7+62.4		17497	17498	305-7-11-13		12-14-86
7	110.54	105.47	5.07	7+33.8	7+56.3	7+37.7		#106		303 N. Mead		5-29-08
					6+41.0	6+39.0						
6	111.17	105.22	5.95		6+15.7	6+13.7		#314	#2	250 N. Mead	256 Moore St.	5-31-10
					5+90.8	5+88.8						1-4-37
					5+66.0	5+64.0		#1341		240 Moore St.		12-26-28
					5+42.0	5+40.0						
5	110.34	104.97	5.37		5+16.8	5+14.8						
					4+90.8	4+88.8						
					4+67.0	4+65.0						
					4+42.4	4+40.4		#212	#1001	241 Moore	231 N. Mead	3-18-26
4	109.82	104.72	5.10		4+17.5	4+15.5						9-11-25
	110.17	104.68	5.59	3+87.0	3+92.3	3+90.3		#502		217-245 Moore		8-15-18
	109.89	104.50	5.39	3+55.0								
3	111.06	104.47	6.59			3+50.5						
2	110.37	104.22	6.15			2+82.5						
1	109.67	103.87	5.70									
0	109.68	103.78	5.90	0+25.0								

Sanitary Sewer Improvement In Connection With Paving Moore - 1ST to 2ND

0+00 110.58 104.70 OUT 5.9 0+00 4" W 105.13
110.58 104.80 IN 5.8

1+00 110.60 105.10 5.5

2+00 110.50 105.41 5.1
110.37 105.60 4.8 2+63.72 4" W 105.93

N/C 300 N Mead, Bldg A - SWR 2002-02037 - Boardman

N/C 353 N Mead - SWR 2002-03119-1118102 - Com'l Mech - 6" stub E, 6x4 Reducer, 4H45, 4" SCH40

GI 353 N Mead - SWR 2002-03120-1118102 - Com'l Mech - 4x2 Santee, 2H45, 2 cleanouts

Tap #22928 - 238 Moore - N/C Hanner - 2-16-71 (3+41.6)

Top - Coleman Lamp Co. Warehouse - 9-22-26
#3089 - Top - 249 Moore - 2-6-41 - Simmons P/bq. Co.
#1084 - 230 N. Santa Fe - 2-25-42 - Simmons P/bq. Co. = Tap
#1930 - 702 E. 2ND - 3-6-45 - Moore Robinson Tap
#2399 - Top - 239 N. Mead - 11-7-45 - Simmons P/bq. Co.
#1963 - Top - 317 N. Mead - 5-6-47 - Howard Shephard P/bq.
#4391 - Top - 702 E. 2ND - 3-9-53 - Jensen P/bq. Co.

91-38199-7-12/10/91 325 N Mead - Bldg. West - (Tap 55' S of MH)
93-26056-7 10/5/93 201-243 N Mead (Coleman Co) - 7/6-193 ft N of MH - 4" Clay
93-26055-7 10/5/93 201-243 N Mead (") - 5/60 3+46.7-4" Clay
93-26054-7 10/5/93 201-243 N Mead (") - 5/6 2+3+44.0-4" Clay
93-26053-7 10/5/93 201-243 N Mead (") - 5/6 (213 ft West of MH) 4" SDR 35